

**Antero Resources
Well No. Makar 1H**

Antero Resources Corporation

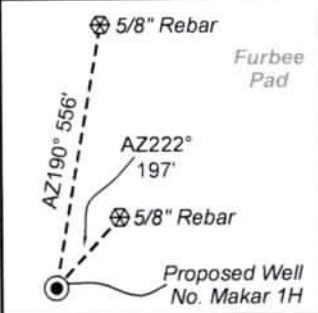

Well Location References (NTS)



I, the undersigned, hereby certify that this plat is correct to the best of my knowledge and belief and shows all the information required by law and the rules issued and prescribed by the Department of Environmental Protection.

Bradley D. Miller
Bradley D. Miller, P.S. 2167



Wellhead Layout (NTS)

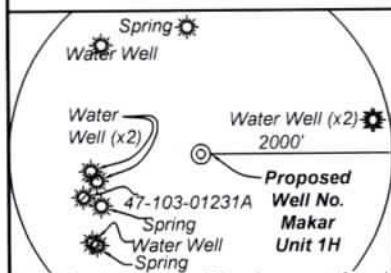
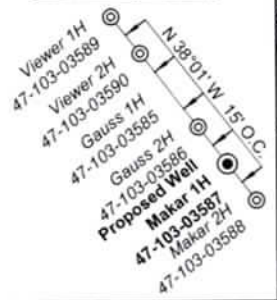

Note: 6 water wells and 3 springs were found within 2000' of proposed well. No occupied dwellings or buildings 2,500 square feet or larger used to house or shelter dairy cattle or poultry husbandry are located within 625' of the center of the well pad.

Notes
West Virginia Coordinate System of 1927, North Zone based upon Differential GPS Measurements
Well No. Makar Unit 1H Top Hole coordinates are
N: 387,179.39' Latitude 39°33'23.42"
E: 1,652,931.18' Longitude 80°43'51.47"
Bottom Hole coordinates are
N: 404,833.00' Latitude 39°36'17.46"
E: 1,649,760.94' Longitude 80°44'35.06"
UTM Zone 17, NAD 1983
Top Hole Coordinates Bottom Hole Coordinates
N: 4,378,579.038m N: 4,383,941.209
E: 523,128.136m E: 522,072.707m
Plat orientation and corner and well references are based upon the grid north meridian.
Well location references are based upon the magnetic meridian.

Notes
Well No. Makar Unit 1H UTM Zone 17, NAD 1927
Top Hole Coordinates
N: 14,364,672.54'
E: 1,716,247.96'
Point of Entry Coordinates
N: 14,365,751.42'
E: 1,718,603.82'
Bottom Hole Coordinates
N: 14,382,264.88'
E: 1,712,784.62'

Bearing	Dist.
L1 S 66°38' W	1,879.6'
L2 S 89°58' W	1,943.8'
L3 N 84°48' E	1,644.3'
L4 N 89°39' E	1,670.8'
L5 N 66°21' E	2,592.0'

FILE NO: 53-34-G-23
DRAWING NO: Makar Unit 1H Well Plat
SCALE: 1" = 2000'
MINIMUM DEGREE OF ACCURACY: Submeter
PROVEN SOURCE OF ELEVATION: WVDOT, Harrisville, WV

**STATE OF WEST VIRGINIA
DEPARTMENT OF ENVIRONMENTAL PROTECTION
OIL AND GAS DIVISION**

DATE: September 6 2023
OPERATOR'S WELL NO. Makar Unit 1H
API WELL NO
47 - 103 - 03587
STATE COUNTY PERMIT

WELL TYPE: OIL GAS LIQUID INJECTION WASTE DISPOSAL
(IF GAS) PRODUCTION: STORAGE DEEP SHALLOW
LOCATION: ELEVATION: As-Built 1211' WATERSHED: Fishing Creek QUADRANGLE: Pine Grove
DISTRICT: Green COUNTY: Wayne
SURFACE OWNER: Antero Resources Corp. ACREAGE: 58.1
ROYALTY OWNER: James Allen Sell LEASE NO: ACREAGE: 58.1
PROPOSED WORK: DRILL CONVERT DRILL DEEPER FRACTURE OR STIMULATE PLUG OFF OLD FORMATION
 PERFORATE NEW FORMATION OTHER PHYSICAL CHANGE IN WELL (SPECIFY) BHL MOD 7,500' TVD
 PLUG AND ABANDON CLEAN OUT AND REPLUG TARGET FORMATION: Marcellus Shale ESTIMATED DEPTH: 28,700' MD

WELL OPERATOR: Antero Resources Corporation DESIGNATED AGENT: Kevin Ellis
ADDRESS: 1615 Wynkoop Street ADDRESS: 535 White Oaks Blvd.
Denver, CO 80202 Bridgeport, WV 26330

**Antero Resources
Well No. Makar 1H**

Antero Resources Corporation

Leases	
A	James Allen Sell
B	William R. Stalnaker
C	Tribune Resources Minerals, LLC
D	Marilyn Halley Seeley
E	Tribune Resources Minerals, LLC
F	Marcella K. Harrison
G	Linda Darlene Straight
H	CSX Transportation, Inc.
I	WVDNR
J	Jenkins Miller
K	Antero Minerals, LLC
L	Antero Minerals, LLC
M	Antero Minerals, LLC
N	Antero Minerals, LLC
O	Antero Minerals, LLC

Leases	
P	Lynn P. Newton
Q	Antero Minerals, LLC
R	Chesapeake Appalachia, LLC
S	Chesapeake Appalachia, LLC
T	DDE, Inc.
U	BRC Minerals, LP & BRC Appalachian Minerals, LLC
V	Shiben Estates, Inc.
W	Nancy B. Hatfield, et al
X	Cylde B. Snider
Y	Deborah Kay Clark
Z	Chesapeake Appalachia, LLC
AA	Elizabeth P. Ormer
AB	Donzel A. Hornbeck
AC	Elizabeth P. Ormer



RECEIVED
Office of Oil and Gas
SEP 21 2023
WV Department of
Environmental Protection

FILE NO: 53-34-G-23
DRAWING NO: Makar Unit 1H Well Plat
SCALE: 1" = 2000'
MINIMUM DEGREE OF ACCURACY:
Submeter
PROVEN SOURCE OF ELEVATION:
WVDOT, Harrisville, WV

STATE OF WEST VIRGINIA
DEPARTMENT OF ENVIRONMENTAL PROTECTION
OIL AND GAS DIVISION

DATE: September 6 2023
OPERATOR'S WELL NO. Makar Unit 1H
API WELL NO
47 — 103 — 03587
STATE COUNTY PERMIT

WELL TYPE: OIL GAS LIQUID INJECTION WASTE DISPOSAL
(IF GAS) PRODUCTION: STORAGE DEEP SHALLOW

LOCATION: ELEVATION: As-Built 1211' WATERSHED: Fishing Creek QUADRANGLE: Pine Grove
DISTRICT: Green COUNTY: WV# 10/06/2023
SURFACE OWNER: Antero Resources Corp ACREAGE: 58.1
ROYALTY OWNER: James Allen Sell LEASE NO: _____ ACREAGE: 58.1
PROPOSED WORK: DRILL CONVERT DRILL DEEPER FRACTURE OR STIMULATE PLUG OFF OLD FORMATION
 PERFORATE NEW FORMATION OTHER PHYSICAL CHANGE IN WELL (SPECIFY) BHL MOD 7,500' TVD
 PLUG AND ABANDON CLEAN OUT AND REPLUG TARGET FORMATION: Marcellus Shale ESTIMATED DEPTH: 28,700' MD

WELL OPERATOR: Antero Resources Corporation DESIGNATED AGENT: Kevin Ellis
ADDRESS: 1615 Wynkoop Street ADDRESS: 535 White Oaks Blvd.
Denver, CO 80202 Bridgeport, WV 26330

**Antero Resources
Well No. Makar 1H**

Antero Resources Corporation

Page 3 of 3



ID	TM-Par	Owner	Bk/Pg	Acres
1	17-12	Antero Resources Corp.	483/888	58.10
2	17-1	Antero Resources Corp	483/888	15.35
3	17-60	Ross Bucher	411/765	79.00
4	13-71	Charles R. & Kay L. Blair	387/577	63.11
5	17-14	Bradford Highley	386/607	18.53
6	17-14.2	Michael & Tammy Lemasters	384/10	2.18
7	17-2	Clarence & Carol Lancaster	287/357	0.50
8	17-3	Bradford Highley	386/607	17.00
9	17-5	Coastal Forest Resources	444/105	90.00
10	17-4	James Straight	223/193	10.8
11	13-72	Straight Cemetery	---	0.45
12	17-3.1	Bradford D. Highley	386/607	1.00
13	13-71.1	Clarence L. & Carol J. Lancaster	387/266	19.19
14	13-78	Sebastian, Jr. & Marcella Harrison	281/94	25.37
15	13-73	James Straight, et al	WB67/427	14.60
16	13-74	Linda D. Straight	WB67/427	0.29
17	13-65.4	Raye Anne Lloyd	445/660	2.99
18	xx-xx	WV State Road Commission	162/497	0.90
19	13-65	Raye Anne Lloyd	445/660	18.01
20	30-59	James D. Glasscock II	377/180	1.09
21	30-23.1	Michael A. McDiffitt	447/102	2.06
22	30-55	James D. Glasscock II	377/180	0.81
23	30-58	James D. Glasscock II	377/180	0.47
24	30-54	James D. Glasscock II	377/180	0.41
25	30-57	Dwain R. & Dena L. Brown	286/736	0.91
26	30-23	Charles R. & Kay Blair	312/585	1.29
27	30-23.2	Charles R. & Kay L. Blair	305/372	1.00
28	30-56	Charles R. Blair	362/606	0.60
29	30-53	Lantz Cemetery	---	0.67
30	30-52	Clinton W. & Karen S. Harris	266/268	0.35
31	13-64	Loraine Highley	WB81/258	5.64
32	30-41	Clinton W. & Karen S. Harris	244/413	0.50
33	30-51	Wayne Morrison	366/58	1.00
34	30-40	Donald W. Harris	439/418	0.36
35	30-39	Donald W. Harris	439/418	0.66
36	30-38.1	Melissa Carter & Theresa Jones	423/283	0.50
37	30-38	William Stephen & Trudy J. Thomas	379/206	0.97
38	30-21	Robert Dennis Lawson	326/512	1.00
39	30-20	Esther R. Coen	433/68	1.00
40	30-37	Martin Carl & Sandra L. Bucher	342/568	0.52
41	30-33	James D. & Florence L. Eddy	354/320	0.85
42	30-31	Donna D. Williams	420/381	0.07
43	30-33.1	Donna D. Williams	420/381	0.09
44	30-33.2	Temple M. & Glenda D. Jackson	249/271	0.09
45	30-32	Temple M. & Glenda D. Jackson	249/271	0.42
46	30-50	Forrest L. & Anna Jane Tennant	228/278	0.22
47	30-49	Forrest L. & Anna Jane Tennant	218/4	0.45
48	30-29	Chad A. Pittman	397/351	1.01
49	30-28	Flora L. Trader, et al	WB74/931	0.91
50	30-30	Temple & Glenda D. Jackson	261/482	0.33
51	30-30.2	Donna D. Williams	420/381	0.03
52	30-30.1	Donna D. Williams	420/381	0.08
53	30-34	Richard W. & Connie J. Rine	294/308	0.24
54	30-35.1	Columbia Gas Transmission Corporation	263/164	0.05
55	30-36	Bayer Heritage Federal	442/478	0.26
56	30-35	Everett M. & Tresa A. Rine	354/510	0.20
57	30-19	Zachary C. Propst	431/280	1.0
58	30-17	Laura A. Hicks	439/363	0.15
59	30-18	Laura A. Hicks	439/363	0.37
60	30-16	Thomas R. & Paula C. Loy	393/683	0.77
61	30-27	Gary Hayes, et al	420/626	0.46
62	30-26	Richard W. & Connie J. Rine	294/308	0.20
63	30-25	Edward E. Martin Jr. & Violet Lorraine Martin	428/427	0.69
64	30-24	Edward E. Martin Jr. & Violet Lorraine Martin	428/427	0.23

ID	TM-Par	Owner	Bk/Pg	Acres
65	30-47	David L. Cunningham	WB42/436	0.75
66	30-46	David L. & Freda V. Cunningham	283/252	0.34
67	30-45	Gary B. & Pauline Hayes, et al	420/626	0.48
68	30-44	Gary B. & Pauline Hayes, et al	420/626	0.41
69	30-42	Reader Vol. Fire Dept. Inc.	261/307	0.34
70	30-43	Reader Vol. Fire Dept. Inc.	280/326	0.10
71	30-15	Reva E. Shanholtzer	WB44/164	0.73
72	30-14.1	Reva E. Shanholtzer	WB44/164	0.25
73	30-13	Kathy L. Wright	WB75/465	4.74
74	30-14	Kathy L. Wright	428/931	0.18
75	30-13.1	Joshua R. Wright	370/130	1.53
76	30-12	Kenneth R. & Charlene Ice	319/352	1.97
77	13-33	Ryan R. Bucher	426/768	1.79
78	13-33.11	Richard D. & Jacqueline M. Bucher	372/601	2.00
79	30-6.2	James C. & Corinna L. Tennant	373/178	1.18
80	30-6.2	James K. Tennant	417/208	0.38
81	30-6.1	Franklin D. & L. Marlene Tennant	417/205	0.44
82	30-11	Michael & Patricia A. Leek	AP98/638	0.05
83	30-10	Eric & Estella Hayes	409/390	1.25
84	30-9	Jerry D. & Joyce Martin	339/379	0.85
85	30-9.1	Jerry D. & Joyce Martin	339/379	0.57
86	30-5	Matthew C. Harris	442/183	0.61
87	30-5.2	Travis C. Ice & Mandy Barker	391/275	0.30
88	30-5.1	Travis C. Ice & Mandy Barker	391/275	0.25
89	30-5.3	Michael D. Lloyd	431/490	0.45
90	30-4.1	Michael D. Lloyd	431/490	0.43
91	30-4.5	Travis C. & Amanda J. Ice	395/346	0.32
92	30-4.4	Donna J. Titus	372/558	1.64
93	30-4.3	Donna J. Titus	372/558	0.17
94	30-4.2	Donna J. Titus	372/558	0.19
95	30-4	Marsha Derby	423/472	0.23
96	30-5.4	Marsha Derby	423/472	0.03
97	30-8	Robert J. Yeager	310/433	1.25
98	30-7	Jerry Lee & Karen Beryl Mason	365/533	1.25
99	30-3.2	Michael Miller, Sr.	361/143	0.33
100	30-3	Phyllis L. Willey	WB41/389	0.59
101	30-3.1	Phyllis L. Willey	WB41/389	0.83
102	30-2	Wallace E. & Daisy M. Kendall	289/476	1.75
103	13-24.2	Jerry Lee & Karen Beryl Mason	365/533	0.03
104	13-24.1	Jerry Lee & Karen Beryl Mason	235/9	3.10
105	30-1.5	Robert C. & Heidi M. Brown	428/14	1.75
106	13-32.3	Board of Education	282/414	12.39
107	13-32	Robert C. & Heidi M. Brown	428/14	0.45
108	13-32.2	Howard D. & Clara M. Bucher	367/144	34.02
109	13-31	Richard D. & Jacqueline Bucher	433/361	0.47
110	13-32.2	Wetzel County Board of Education	368/49	0.01
111	13-32.1	Richard D. & Jacqueline M. Bucher	367/530	0.20
112	13-32.2	Richard D. & Jacqueline Bucher	329/595	0.19
113	13-32.1	Richard D. & Jacqueline Bucher	332/167	0.27
114	13-30	Richard D. & Jacqueline Bucher	433/361	0.34
115	13-24.3	William R. & Denise Poling	311/70	0.97
116	13-29	Howard D. & Clara M. Bucher	367/144	0.17
117	13-24.7	Jerry L. & Karen B. Mason	367/79	0.91
118	13-24.6	Jerry L. & Karen B. Mason	367/74	0.35
119	13-24.5	Marilyn K. Daugherty	MS89/328	0.45
120	13-24.9	Nila E. Nice	431/653	0.37
121	13-24	Howard D. & Clara M. Bucher	367/144	34.02
122	13-25	Wayne & Brenda Balwanz	440/693	12.15
123	13-25.2	Diane K. Howell	416/682	10.20
124	13-14	Ronald S. Anderson	399/387	32.80
125	13-7	WSD Properties LLC	441/793	162.00
126	13-13	Linda M. Headley	385/209	85.50
127	8-41	Nancy Hatfield	267/370	60.00
128	8-28	Nancy B. Hatfield	474/481	449.48
129	8-23	Debra Kay Fuharty, et al	368/561	28.04
130	8-18	Carlton L. Hornbeck	320/3	0.24
131	3-37	Carlton J. Hornbeck	250/263	118.00
132	8-6	Carlton J. Hornbeck	250/263	3.30
133	8-5	Charles J. Jr. & Robin D. Stillwagoner	367/460	37.87
134	8-7	Carlton J. Horbeck	259/335	0.25
135	3-36	Donzel A. Hornbeck	459/560	35.00
136	3-35	Richard Hornbeck, et al	483/191	19.50
137	3-27	Ronald E. Wade	433/785	100.00

FILE NO: 53-34-G-23
 DRAWING NO: Makar Unit 1H Well Plat
 SCALE: 1" = 2000'
 MINIMUM DEGREE OF ACCURACY:
 Submeter
 PROVEN SOURCE OF ELEVATION:
 WVDOT, Harrisville, WV

STATE OF WEST VIRGINIA
 DEPARTMENT OF ENVIRONMENTAL PROTECTION
OIL AND GAS DIVISION

DATE: September 6 2023
 OPERATOR'S WELL NO. Makar Unit 1H
 API WELL NO
 47 - 103 - 03587
 STATE COUNTY PERMIT

WELL TYPE: OIL GAS LIQUID INJECTION WASTE DISPOSAL
 (IF GAS) PRODUCTION: STORAGE DEEP SHALLOW
 LOCATION: ELEVATION: As-Built 1211' WATERSHED: Fishing Creek QUADRANGLE: Pine Grove
 DISTRICT: Green COUNTY: Wayne
 SURFACE OWNER: Antero Resources Corp ACREAGE: 58.1
 ROYALTY OWNER: James Allen Sell LEASE NO: ACREAGE: 58.1
 PROPOSED WORK: DRILL CONVERT DRILL DEEPER FRACTURE OR STIMULATE PLUG OFF OLD FORMATION
 PERFORATE NEW FORMATION OTHER PHYSICAL CHANGE IN WELL (SPECIFY) BHL MOD 7,500' TVD
 PLUG AND ABANDON CLEAN OUT AND REPLUG TARGET FORMATION: Marcellus Shale ESTIMATED DEPTH: 28,700' MD

WELL OPERATOR: Antero Resources Corporation DESIGNATED AGENT: Kevin Ellis
 ADDRESS: 1615 Wynkoop Street ADDRESS: 535 White Oaks Blvd.
 Denver, CO 80202 Bridgeport, WV 26330