

LATITUDE 39°35'00"

7,709'

LATITUDE 39°37'30" 4,976' TO BOTTOM HOLE

Antero Resources Corporation Well No. Sprouse #1H

AS DRILLED DATA: WELL 1H TOP HOLE INFORMATION: N: 386,952ft E: 1,628,100ft LAT: 39°33'17.69" LON: 80°49'08.42" BOTTOM HOLE INFORMATION: N: 403,902ft E: 1,619,336ft LAT: 39°36'03.91" LON: 80°51'03.57" WEST VIRGINIA COORDINATE SYSTEM OF 1927 NORTH ZONE. ZONE WAS DERIVED FROM MEASUREMENTS TAKEN WITH TRIMBLE GEOXT SUBMETER MAPPING GRADE GPS UNIT. PLAT ORIENTATION, CORNER, AND WELL REFERENCE TIE LINES ARE BASED ON GRID NORTH.

(NAD) 83 (UTM) ZONE 17 COORDS: WELL 1H TOP HOLE INFORMATION: N: 4,378,383m E: 515,564m BOTTOM HOLE INFORMATION: N: 4,383,502m E: 512,808m

(NAD) 27 (UTM) ZONE 17 COORDS: WELL 1H TOP HOLE INFORMATION: N: 14,364,030ft E: 1,691,433ft POINT OF ENTRY INFORMATION: N: 14,362,472ft E: 1,688,760ft BOTTOM HOLE INFORMATION: N: 14,380,826ft E: 1,682,389ft

WV NORTH ZONE GRID NORTH

8,711' TO BOTTOM HOLE

10,352'

LONGITUDE 80°50'00"

LONGITUDE 80°47'30"

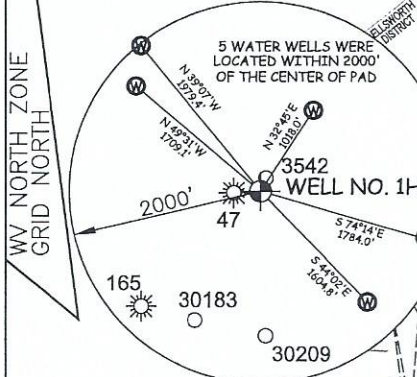
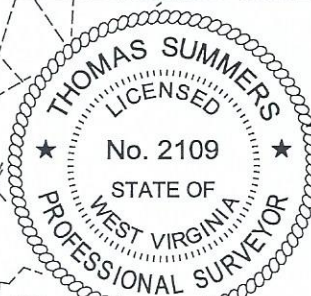

Table listing landowners and their addresses. Columns include owner name, address, and phone number. Owners include Barbara McAdams, Jacob Morgan, M.B. Investments, etc.



NOTE: 1. NO OCCUPIED DWELLINGS OR BUILDINGS TWO THOUSAND FIVE HUNDRED (2,500) SQUARE FEET OR LARGER USED TO HOUSE OR SHELTER DAIRY CATTLE OR POULTRY HUSBANDRY ARE LOCATED WITHIN SIX HUNDRED TWENTY-FIVE (625) FEET OF THE CENTER OF THE WELL PAD. 2. TOP HOLE DATA SHOWN HEREON WAS PROVIDED BY ANTERO RESOURCES CORPORATION. 3. AS DRILLED DATA WAS PROVIDED BY ANTERO RESOURCES CORPORATION. 4. WLS IS NOT CERTIFYING THE DATA AND INFORMATION PROVIDED LISTED IN NOTES 2 AND 3, ONLY THE RELATIONSHIP TO THE DATA AND INFORMATION PROVIDED TO THE LEASE BOUNDARIES. 5. WLS IS BY NO MEANS RESPONSIBLE FOR ANY ERRORS OR INACCURACIES WITH THE DATA AND INFORMATION THAT HAS BEEN PROVIDED.



- List of mineral rights owners and their interests, including BRC Appalachian Minerals I, LLC, Cedar Run Mineral Holdings LLC, Marcella Sarson Mineral Trust, etc.

I THE UNDERSIGNED, HEREBY CERTIFY THAT THIS PLAT IS CORRECT TO THE BEST OF MY KNOWLEDGE AND BELIEF AND SHOWS ALL THE INFORMATION REQUIRED BY LAW AND THE RULES ISSUED AND PERSCRIBED BY THE DEPARTMENT OF ENVIRONMENTAL PROTECTION.



STATE OF WEST VIRGINIA, DIVISION OF ENVIRONMENTAL PROTECTION, OFFICE OF OIL AND GAS

WILLOW LAND SURVEYING PLLC 220 MASONIC AVE. PENNSBORO WEST VIRGINIA 26415

Form fields for JOB # 21-011WA, DRAWING # SPROUSE1HAD, SCALE 1" = 2000', MINIMUM DEGREE OF ACCURACY SUBMETER, PROVEN SOURCE OF ELEV. SUBMETER MAPPING GRADE GPS, STATE OF WEST VIRGINIA DEPARTMENT OF ENERGY DIVISION OF OIL AND GAS

LEGEND: Surface Owner Boundary Lines +/-, Interior Surface Tracts +/-, Proposed Well Path, As Drilled Well Path. Includes signature of Thomas Summers and dates 07/15/24.

WELL TYPE: OIL GAS X LIQUID INJECTION WASTE DISPOSAL (IF "GAS") PRODUCTION X STORAGE DEEP SHALLOW X LOCATION: ELEVATION AS BUILT - 1250.0' WATERSHED FISHING CREEK QUADRANGLE PORTER FALLS 7.5' DISTRICT GREEN COUNTY WETZEL SURFACE OWNER HAROLD S. & CALANTHA A. YOST ACREAGE 50 ACRES +/- OIL & GAS ROYALTY OWNER MARY E. MIDCAP LEASE ACREAGE 50 ACRES+ PROPOSED WORK: DRILL CONVERT DRILL DEEPER REDRILL FRACTURE OR STIMULATE PLUG OFF OLD FORMATION PERFORATE NEW FORMATION OTHER PHYSICAL CHANGE IN WELL (SPECIFY) AS DRILLED PLUG & ABANDON CLEAN OUT & REPLUG TARGET FORMATION MARCELLUS ESTIMATED DEPTH 6,731' TVD 27,543' MD WELL OPERATOR ANTERO RESOURCES CORP. DESIGNATED AGENT KEVIN ELLIS ADDRESS 1615 WYNKOOP ST. DENVER, CO 80202 ADDRESS 535 WHITE OAK BLVD. BRIDGEPORT, WV 26330

08/16/2024

COUNTY NAME PERMIT