

LATITUDE 39°35'00"

7,695'

LATITUDE 39°37'30"

2,789' TO BOTTOM HOLE

7,116' TO BOTTOM HOLE

10,395'

LONGITUDE 80°50'00"

LONGITUDE 80°47'30"

Antero Resources Corporation
Well No. Tulo #1H

AS DRILLED DATA:
WELL 1H TOP HOLE INFORMATION:
N: 386,909ft E: 1,628,114ft
LAT: 39°33'17.26" LON: 80°49'08.24"
BOTTOM HOLE INFORMATION:
N: 405,463ft E: 1,621,545ft
LAT: 39°36'19.67" LON: 80°50'35.64"
WEST VIRGINIA COORDINATE SYSTEM OF 1927 NORTH ZONE. ZONE WAS DERIVED FROM MEASUREMENTS TAKEN WITH TRIMBLE GEOXT SUBMETER MAPPING GRADE GPS UNIT. PLAT ORIENTATION, CORNER, AND WELL REFERENCE TIE LINES ARE BASED ON GRID NORTH.

(NAD) 83 (UTM) ZONE 17 COORDS:
WELL 1H TOP HOLE INFORMATION:
N: 4,378,370m E: 515,569m
BOTTOM HOLE INFORMATION:
N: 4,383,990m E: 513,473m

(NAD) 27 (UTM) ZONE 17 COORDS:
WELL 1H TOP HOLE INFORMATION:
N: 14,363,988ft E: 1,691,447ft
POINT OF ENTRY INFORMATION:
N: 14,363,258ft E: 1,691,079ft
BOTTOM HOLE INFORMATION:
N: 14,382,424ft E: 1,684,572ft

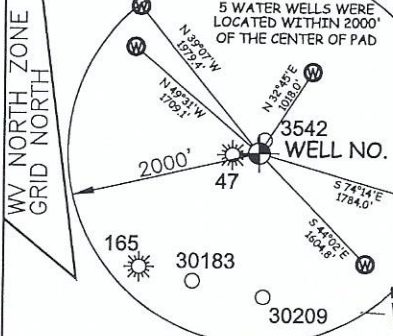
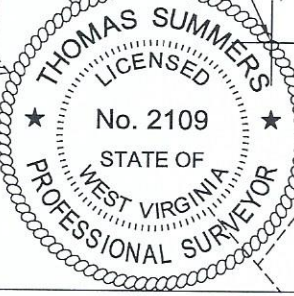

Table listing landowners and their addresses, organized by district: Magnolia District - Wetzel County, Green District - Wetzel County, Ellsworth District - Tyler County, and Green District - Tyler County.



NOTICE
1. NO OCCUPIED DWELLINGS OR BUILDINGS TWO THOUSAND FIVE HUNDRED (2,500) SQUARE FEET OR LARGER USED TO HOUSE OR SHELTER DAIRY CATTLE OR POULTRY HUSBANDRY ARE LOCATED WITHIN SIX HUNDRED TWENTY-FIVE (625) FEET OF THE CENTER OF THE WELL PAD.
2. TOP HOLE DATA SHOWN HEREON WAS PROVIDED BY ANTERO RESOURCES CORPORATION.
3. AS DRILLED DATA WAS PROVIDED BY ANTERO RESOURCES CORPORATION.
4. WLS IS NOT CERTIFYING THE DATA AND INFORMATION PROVIDED LISTED IN NOTES 2 AND 3, ONLY THE RELATIONSHIP TO THE LEASE BOUNDARIES.
5. WLS IS BY NO MEANS RESPONSIBLE FOR ANY ERRORS OR INACCURACIES WITH THE DATA AND INFORMATION THAT HAS BEEN PROVIDED.

Table listing mineral interests and owners, including names like M.B. Investments, Chesapeake Appalachia, LLC, and various individuals.

I THE UNDERSIGNED, HEREBY CERTIFY THAT THIS PLAT IS CORRECT TO THE BEST OF MY KNOWLEDGE AND BELIEF AND SHOWS ALL THE INFORMATION REQUIRED BY LAW AND THE RULES ISSUED AND PERSCRIBED BY THE DEPARTMENT OF ENVIRONMENTAL PROTECTION.



STATE OF WEST VIRGINIA, DIVISION OF ENVIRONMENTAL PROTECTION, OFFICE OF OIL AND GAS
WILLOW LAND SURVEYING PLLC
220 MASONIC AVE. PENNSBORO WEST VIRGINIA 26415

JOB # 21-011WA
DRAWING # TULO1HAD
SCALE 1" = 2000'
MINIMUM DEGREE OF ACCURACY SUBMETER
PROVEN SOURCE OF ELEV. SUBMETER MAPPING GRADE GPS
STATE OF WEST VIRGINIA DEPARTMENT OF ENERGY DIVISION OF OIL AND GAS

LEGEND
--- Surface Owner Boundary Lines +/-
--- Interior Surface Tracts +/-
--- Proposed Well Path
--- As Drilled Well Path
THOMAS SUMMERS P.S. 2109
DATE 07/15/24
OPERATOR'S WELL# TULO UNIT#1H
47 - 103 - 03602
STATE COUNTY PERMIT

WELL TYPE: OIL GAS X LIQUID INJECTION WASTE DISPOSAL
(IF "GAS") PRODUCTION X STORAGE DEEP SHALLOW X
LOCATION: ELEVATION AS BUILT - 1250.0' WATERSHED FISHING CREEK QUADRANGLE PORTER FALLS 7.5' DISTRICT GREEN COUNTY WETZEL
SURFACE OWNER ANTERO RESOURCES CORPORATION ACREAGE 50 ACRES +/-
OIL & GAS ROYALTY OWNER MARY E. MIDCAP LEASE ACREAGE 50 ACRES +/-
PROPOSED WORK: DRILL CONVERT DRILL DEEPER REDRILL FRACTURE OR STIMULATE
PLUG OFF OLD FORMATION PERFORATE NEW FORMATION OTHER PHYSICAL CHANGE IN WELL (SPECIFY) AS DRILLED
TARGET FORMATION MARCELLUS PLUG & ABANDON CLEAN OUT & REPLUG
WELL OPERATOR ANTERO RESOURCES CORP. ESTIMATED DEPTH 6,780' TVD 27,629' MD
ADDRESS 1615 WYNKOOP ST. ADDRESS 535 WHITE OAK BLVD.
FORM WW-6 DENVER, CO 80202 BRIDGEPORT, WV 26330

08/16/2024

COUNTY NAME PERMIT

Handwritten signature or initials.