

Note: No water wells were found within 2000' of proposed well. No occupied dwellings or buildings 2,500 square feet or larger used to house or shelter dairy cattle or poultry husbandry are located within 625' of the center of the well pad.

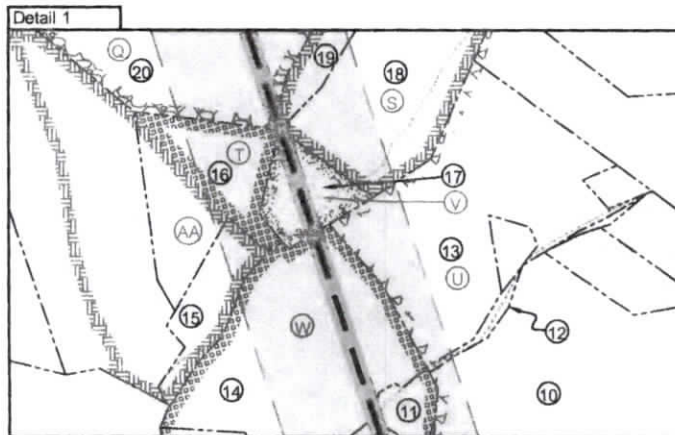

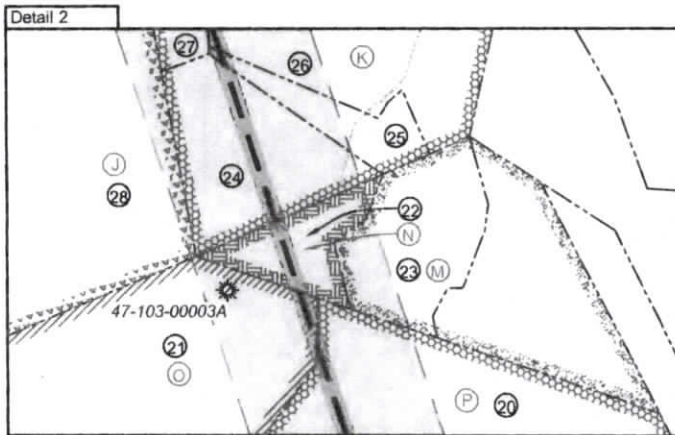

Leases	
A	Sylvia Jean Highley
B	Belinda K. Harrison
C	Coastal Forest Resources Company
F	Jay. H. Renner
G	Venable Royalty, LTD, et al
I	Piney Holdings, Inc.
J	Shiben Estates, Inc
K	Chesapeake Appalachia, LLC
M	Acropolis, Inc.
N	Chesapeake Appalachia, LLC
O	Russell T. Powell
P	Acropolis, Inc.
Q	Acropolis, Inc.
S	Esther Ruth Coen
T	Acropolis, Inc.
U	Stephen H. Stocker
V	Chesapeake Appalachia, LLC
W	Antero Minerals, LLC
X	Antero Minerals, LLC
Z	Jenkins Miller
AA	Antero Minerals, LLC



ID	TM-Par	Owner	Bk/Pg	Acres
1	13-83	Michelle L. Igleheart	493/370	58.00
2	14-34	Thelma Deaton	493/482	41.00
3	14-19	Dallison Lumber Company	357/267	51.50
4	13-40	Kenneth E. & Vicky A. VanDyne	357/204	42.33
5	13-34	Kenneth E. & Vicky A. VanDyne	357/204	14.50
6	13-26.7	John M. & Stanley D. Pittman	458/837	55.00
7	13-26	John M. & Stanley D. Pittman	458/837	30.52
8	13-15.2	Blue Racer Midstream, LLC	452/546	22.59
9	13-26.6	Stanley & Mary Jo Pittman	284/657	27.38
10	13-17	Laura Ann Slater	423/93	90.00
11	13-15.1	Blue Racer Midstream, LLC	452/546	2.41
12	13-16	Blue Racer Midstream, LLC	452/542	1.00
13	13-10	Blue Racer Midstream, LLC	452/542	25.99
14	13-15	Blue Racer Midstream, LLC	452/542	22.59
15	13-9.1	Karen Sue Bassett & Terry E. Roberts	339/469	4.63
16	13-9	Richard W. Roberts & Justin W. Roberts	394/528	11.7
17	9-60.2	Coen Holdings LLC	492/815	7.33
18	9-60	Coen Holdings LLC	492/815	14.58
19	9-60.1	Coen Holdings LLC	492/815	8.42
20	9-42	WSD Properties LLC	441/793	149.00
21	9-41	WSD Properties LLC	441/793	48.00
22	9-29	Richard David Hornbeck	334/514	7.50
23	9-30	Richard David Hornbeck	334/514	15.25
24	9-28	Richard David Hornbeck	334/514	18.75
25	9-30	Richard David Hornbeck	334/514	15.25
26	9-15	Keith A. Milhoan	407/375	45.25
27	9-14	Timothy S. Harrison	408/280	25.05
28	8-28	Teresa Ann Ice	494/650	449.48
29	9-4.1	Belinda Harrison	493/544	5.50
30	8-8	Belinda Harrison	493/544	38.75
31	4-43	Donzel A. & Rebecca L. Hopmbeck	346/373	35.3
32	3-38	Julie Marie Lemons	493/298	39.80
33	3-29	Linda Kaye Gordon	482/473	26.00
34	3-39	Timothy Scott Harrison	493/300	25.25
35	3-28	Richard D. Hornbeck	483/191	120.00
36	19-34	Christenson Family Trust	439/373	99.00
37	21-1	Olga Lucile Nolan et al	157/348	14.30
38	3-23	Timothy Scott Harrison	470/754	25.50

FILE NO: 126-34-G-18
DRAWING NO: Marma Unit 1H Well Plat
SCALE: 1" = 2000'
MINIMUM DEGREE OF ACCURACY:
Submeter
PROVEN SOURCE OF ELEVATION:
WVDOT, Harrisville, WV



DATE: December 19 2024
OPERATOR'S WELL NO. Marma Unit 1H
API WELL NO
47 - 103 - 03698
STATE COUNTY PERMIT

WELL TYPE: OIL GAS LIQUID INJECTION WASTE DISPOSAL
(IF GAS) PRODUCTION: STORAGE DEEP SHALLOW

LOCATION: ELEVATION: As-Built 1,248 WATERSHED: Fishing Creek QUADRANGLE: Pine Grove
DISTRICT: Green COUNTY: Wetzel

SURFACE OWNER: Dallison Lumber Company ACREAGE: 51.50
ROYALTY OWNER: Jenkins Miller LEASE NO: ACREAGE: 200

PROPOSED WORK: DRILL CONVERT DRILL DEEPER FRACTURE OR STIMULATE PLUG OFF OLD FORMATION
 PERFORATE NEW FORMATION OTHER PHYSICAL CHANGE IN WELL (SPECIFY) BHL MOD 7,200' TVD
 PLUG AND ABANDON CLEAN OUT AND REPLUG TARGET FORMATION: Marcellus Shale ESTIMATED DEPTH: 25,700' MD

WELL OPERATOR: Antero Resources Corporation DESIGNATED AGENT: Kevin Ellis
ADDRESS: 1615 Wynkoop Street ADDRESS: 535 White Oaks Blvd.
Denver, CO 80202 Bridgeport, WV 26330