

4710303728

Topo Quad: Big Run 7.5'

Scale: 1" = 1000'

County: Wetzel

Date: January 30, 2025

District: Grant

Project No: 352-18-M-23

Water

Big 177 Well Pad

5 Potential Water Sources within 2500'

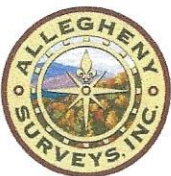
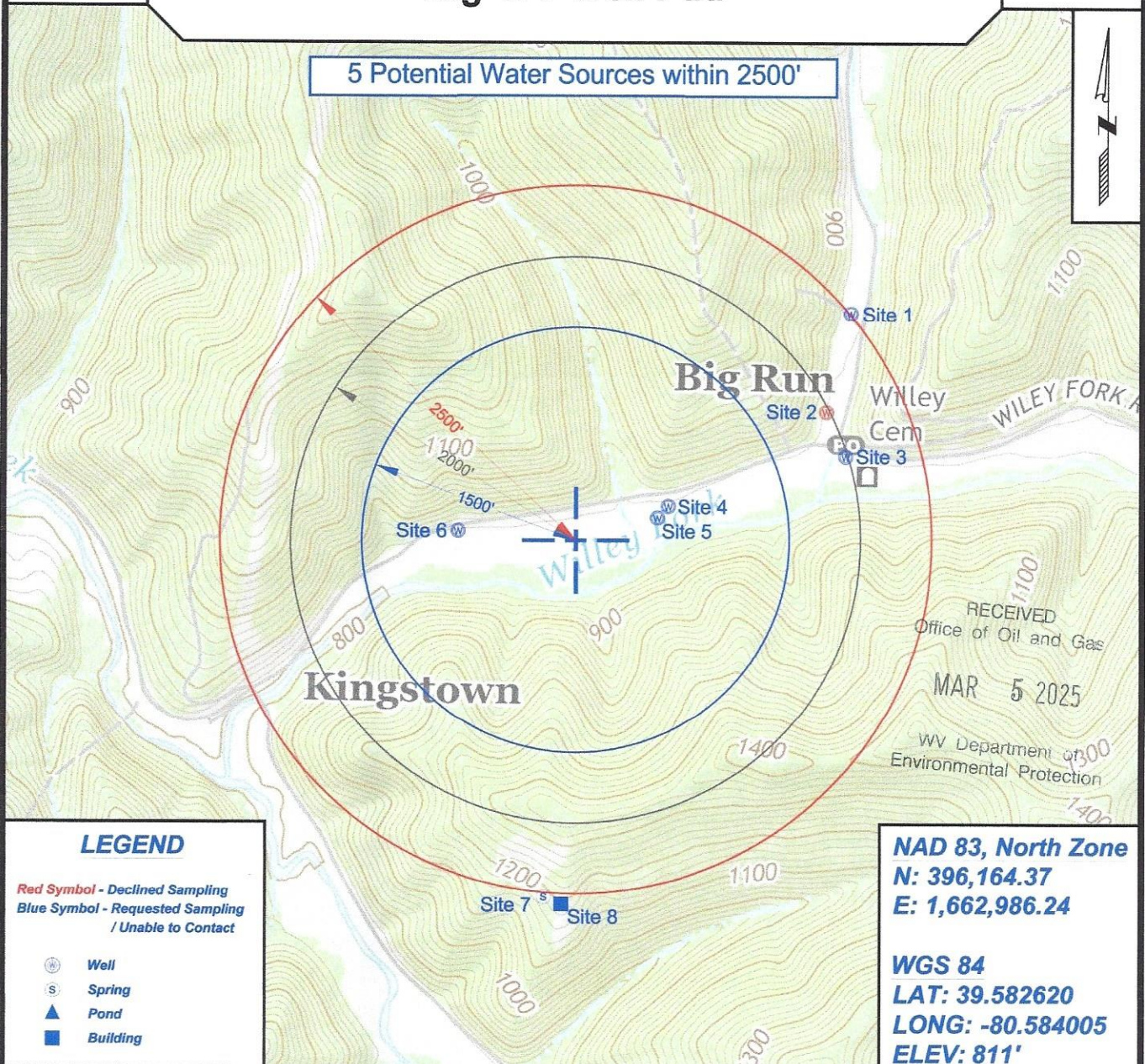

SURVEYING AND MAPPING SERVICES PERFORMED BY:

ALLEGHENY SURVEYS, INC.

1-800-482-8606
237 Birch River Road
Birch River, WV 26610
PH: (304) 649-8606
FAX: (304) 649-8608

PREPARED FOR:

EQT Production Company

400 Woodcliff Drive
Canonsburg, PA 15317

04/11/2025

TH: 222' LAT: 39-35-00

TH: 269' LON: 80-35-00

Big 177 110H
Big 177
EQT Production Company

GRID NORTH

- Proposed Gas Well
- Located Corner, as noted
- Surface Tract Lines
- - - Reference Line
- - - District Line
- Lease Boundary
- Creek or Drain
- ⑤ WV County Route
- ⑤ WV State Route

(●) Denotes Location of Well on United States Topographic Maps

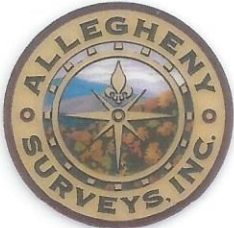

I, the undersigned, hereby certify that this plat is correct to the best of my knowledge and belief and shows all the information required by law and the regulations issued and prescribed by the Department of Environmental Protection.

P.S. 2092

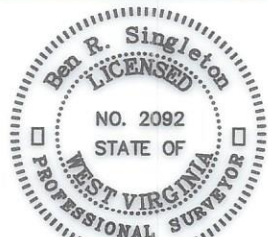

SEAL

FILE NO: 352-23

DRAWING NO: Big 177 110H

SCALE: 1" = 1000'

MINIMUM DEGREE OF ACCURACY:
1:2500PROVEN SOURCE OF ELEVATION:
NGS CORS Station

STATE OF WEST VIRGINIA
DEPARTMENT OF ENVIRONMENTAL PROTECTION
OIL AND GAS DIVISION

DATE: February 20 20 25

OPERATOR'S WELL NO.: Big 177 110H

API WELL NO

47 - 103 - 03728 HCA
STATE COUNTY PERMIT

WELL TYPE: ☐ OIL ☒ GAS ☐ LIQUID INJECTION ☐ WASTE DISPOSAL
(IF GAS) PRODUCTION: ☐ STORAGE ☐ DEEP ☒ SHALLOW

LOCATION: ELEVATION: 810.5' WATERSHED Willey Fork of North Fork Fishing Creek QUADRANGLE: Big Run

DISTRICT: Grant COUNTY: Wetzel

SURFACE OWNER: Coastal Forest Resources Company

ACREAGE: 217.19

ROYALTY OWNER: Coastal Forest Resources Company, et al.

LEASE NO: 121095000

ACREAGE: 300

PROPOSED WORK: ☒ DRILL ☐ CONVERT ☐ DRILL DEEPER ☒ FRACTURE OR STIMULATE ☐ PLUG OFF OLD FORMATION
☐ PERFORATE NEW FORMATION ☐ OTHER PHYSICAL CHANGE IN WELL (SPECIFY)

☐ PLUG AND ABANDON ☐ CLEAN OUT AND REPLUG TARGET FORMATION: Marcellus ESTIMATED DEPTH: 6849'

WELL OPERATOR: EQT Production Company

DESIGNATED AGENT: Joseph C. Mallow

ADDRESS: 400 Woodcliff Drive

ADDRESS: 427 Midstate Drive

Canonsburg, PA 15317

Clarksburg, WV 26301

Big 177 110H
Big 177
EQT Production Company

Tract I.D.	Tax/Map No.	Parcel No.	County	District	Surface Tract Owner	Acres
1	13	6	Wetzel	Grant	Coastal Forest Resources Company	217.19
2	8	18	Wetzel	Grant	Coastal Forest Resources Company	337
3	8	23.2	Wetzel	Grant	James L. Dulaney	43.19
4	8	35	Wetzel	Grant	John D. Parks	15.5
5	8	66	Wetzel	Grant	EQM Gathering OPO LLC	0.418
6	8	65	Wetzel	Grant	Ikey Joe & Tina M. Willey	2.15
7	8	36	Wetzel	Grant	James L. & Karen Dulaney	14.1
8	8	37	Wetzel	Grant	James L. & Karen Dulaney	14.1
9	8	43	Wetzel	Grant	Judy K. Utt	3.25
10	8	45	Wetzel	Grant	Dale K. Dulaney	9.828
11	13	7	Wetzel	Grant	Mansel Lee McDiffitt, et al.	51.8
12	13	15	Wetzel	Grant	Robert Scott & Alfred Bryan Cble	27.75
13	13	13	Wetzel	Grant	Linda L. Dunn	67.5
14	13	12	Wetzel	Grant	Leslie Lydick & Susan Miracle	15.02
15	13	4.3	Wetzel	Grant	Jeffrey L. & Beth Willey	3.35
16	13	6.1	Wetzel	Grant	Coastal Forest Resources Company	55.06
17	8	34	Wetzel	Grant	Hallie M. & Paul E. Hardbarger	54.01
48	13	14	Wetzel	Grant	Linda L. Dunn	12.5

Well References

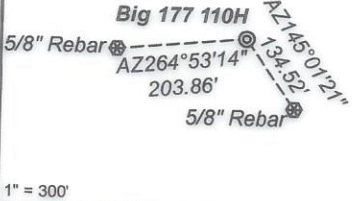

Notes:

Big 177 110H coordinates are
NAD 27 N: 396,118.56 E: 1,694,392.10
NAD 27 Lat: 39.582513 Long: -80.584310
NAD 83 UTM N: 4,381,513.64 E: 535,714.43
Big 177 110H Landing Point coordinates are
NAD 27 N: 394,623.63 E: 1,694,719.81
NAD 27 Lat: 39.578419 Long: -80.583083
NAD 83 UTM N: 4,389,565.04 E: 541,506.54
West Virginia Coordinate system of 1927 (North Zone)
based upon Differential GPS Measurements.
Plat orientation, corner and well ties are based upon
the grid north meridian.
Well location references are based upon the grid north
meridian.
UTM coordinates are NAD83, Zone 17, Meters.

Big 177



Lease No.	Owner	Acres
121095000	Coastal Forest Resources Company, et al.	300

