

Topo Quad: Hundred
County: Wetzel
District: Church

Scale: 1"=1000'
Date: August 30, 2024
Project NO: _____

MR.SKILLING WELL PAD

Water

20 Potential Water Sources Within 2500'

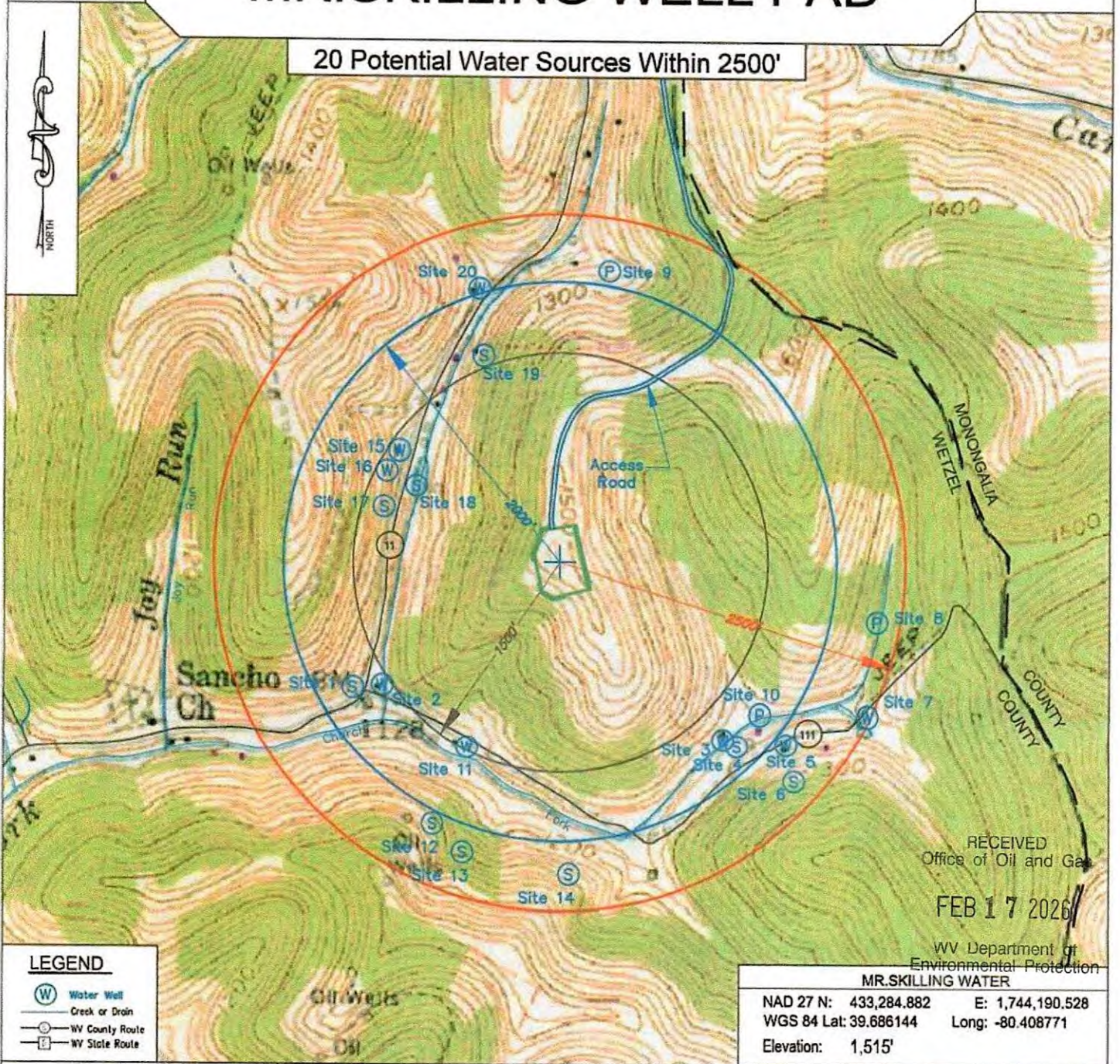

RECEIVED
Office of Oil and Gas
FEB 17 2026

WV Department of
Environmental Protection



Keystone Consultants, LLC
32 East Main Street
Carnegie, PA 15106
412 278-2100

Prepared For:
EQT Production Company
400 Woodcliff Drive
Canonsburg, PA 15317



03/27/2026

Mr Skilling 1H
Mr Skilling
EQT Production Company

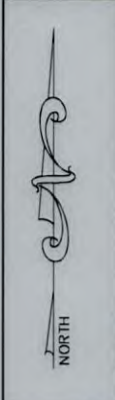

LONGITUDE 80° 25' 00"
 LONGITUDE 80° 22' 30"
 BH: 9.840'
 TH: 7.885'

NOTES ON SURVEY

1. COORDINATES SYSTEM IS UTM, NAD 83 DATUM, ZONE 17, U.S. FOOT AND WELL COORDINATES ESTABLISHED USING SURVEY GRADE GPS.
2. SURFACE AND ROYALTY OWNER INFORMATION AND THEIR BOUNDARIES SHOWN HEREON WERE PLOTTED FROM DEEDS AND/OR TAX PARCEL MAPS PROVIDED BY CLIENT AND FIELD LOCATIONS.
3. THIS PLAT DOES NOT REPRESENT A BOUNDARY SURVEY OF THE PARCELS SHOWN HEREON.
4. NO DWELLINGS AND BUILDINGS WITHIN 625 FEET OF PROPOSED OF CENTER OF PAD.
5. NO WATER WELLS OR DEVELOPED SPRINGS WITHIN 250 FEET OF PROPOSED WELL.
6. NO PERENNIAL STREAMS, LAKES, PONDS, RESERVOIRS OR WETLANDS WITHIN 100 FEET OF THE LIMITS OF DISTURBANCE.
7. NO NATURALLY PRODUCING TROUT STREAM WITHIN 300 FEET OF LIMITS OF DISTURBANCE.

LEGEND

- Active Well Location
- Plugged Well Location
- Abandoned Well
- Surface Tract Identification
- Proposed Gas Well
- Located Corner, as noted
- Surface Tract Lines (Surveyed)
- Surface Tract Lines (Tax Map)
- Reference Line
- Lease Boundary
- Creek or Drain
- WV County Route
- WV State Route

() Denotes Location of Well on United States Topographic Maps



I, the undersigned, hereby certify that this plat is correct to the best of my knowledge and belief and shows all the information required by law and the regulations issued and prescribed by the Department of Environmental Protection.

L. L. S. 2394
L. L. S. 2394



FILE NO: _____
 DRAWING NO: _____
 SCALE: 1" = 2000'
 MINIMUM DEGREE OF ACCURACY: 1:2500
 PROVEN SOURCE OF ELEVATION: NGS CORS Station

STATE OF WEST VIRGINIA
 DEPARTMENT OF ENVIRONMENTAL PROTECTION
 OIL AND GAS DIVISION

DATE: OCTOBER 28 20 25
 OPERATORS WELL NO: Mr Skilling 1H
 API WELL NO: 47 - 103 - 03826
 STATE COUNTY PERMIT

WELL TYPE: OIL GAS LIQUID INJECTION WASTE DISPOSAL
 (IF GAS) PRODUCTION: STORAGE DEEP SHALLOW
 LOCATION ELEVATION: 1491' WATERSHED: West Virginia Fork Fish Creek QUADRANGLE: Hundred
 DISTRICT: Church COUNTY: Wetzel
 SURFACE OWNER: EQT Production Company and Wolfpen Knob Development Co ACREAGE: 58.7 ±
 ROYALTY OWNER: Sarah Anne Magnotti, et al. LEASE NO: 124459000 ACREAGE: 162.00 ±
 PROPOSED WORK: DRILL CONVERT DRILL DEEPER FRACTURE OR STIMULATE PLUG OFF OLD FORMATION
 PERFORATE NEW FORMATION OTHER PHYSICAL CHANGE IN WELL (SPECIFY)
 PLUG AND ABANDON CLEAN OUT AND REPLUG TARGET FORMATION: Marcellus ESTIMATED DEPTH: 7,972'

WELL OPERATOR: EQT Production Company DESIGNATED AGENT: Joseph C Mallow
 ADDRESS: 2200 Energy Drive ADDRESS: 427 Midstate Drive
 Canonsburg, PA 15317 Clarksburg, WV 26301

03/27/2026

Mr Skilling 1H
Mr Skilling
EQT Production Company

Tract ID.	Tax Map No.	Parcel No.	County	District	Surface Tract Owner	Acres
1	5	48.0	Wetzel	Church	EQT Production Company and Wolfpen Knob Development Co	58.70
2	5	20.1	Wetzel	Church	EQT Production Company	8.87
3	5	20.0	Wetzel	Church	Tyler W Tedrow	63.43
4	5	19.0	Wetzel	Church	Michael E Baker	50.00
5	5	46.3	Wetzel	Church	Jerry & Debra L Hostutler	27.58
6	5	42.1	Wetzel	Church	Sancho Church of Christ Truste	0.64
7	5	42.0	Wetzel	Church	Sancho Church of Christ	2.00
8	5	43.1	Wetzel	Church	Danny L & Karen Sue Tennant	8.57
9	5	41.0	Wetzel	Church	Albert B II & Linda S Yost	20.20
10	8	15.0	Wetzel	Church	Brian J & Melissa D Bartrug & Bryan Dale & Karen Sue Tustin	37.33
11	8	14.2	Wetzel	Church	William D & Alyssa W Henderson	0.62
12	8	13.0	Wetzel	Church	Christopher Varner	0.75
13	8	6.0	Wetzel	Church	Christopher Varner	15.60

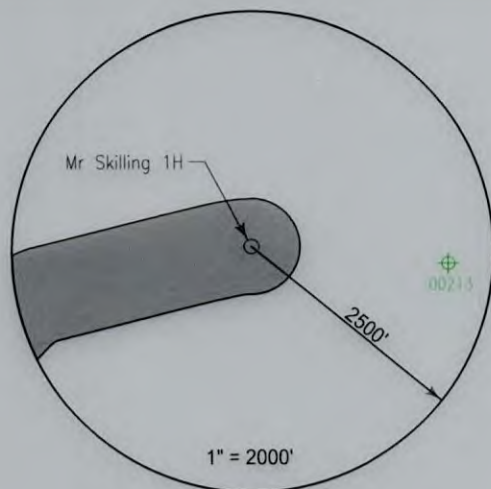

Lease	Owner	Acres
124459000	Sarah Anne Magnotti, et al Robert L Lemmon, et al	162 ac
229415004	Barbara Jean Huggins, et al	72.3375 ac
215638002	Michael E. Baker, et al.	50 ac
175061000	OXY USA Inc., et al.	36.494 ac of 31,151.581 ac
298947000	Sancho Church of Christ	0.624 ac
294015001	Edward Daniel Kuhn and Jessica Lee Kuhn	2 ac
286045001	Albert B. Yost II, et al.	20.2125 ac
261283000	AMP V, LP	37.5 ac
216505001	Shiben Estates, Inc. et al	66 ac

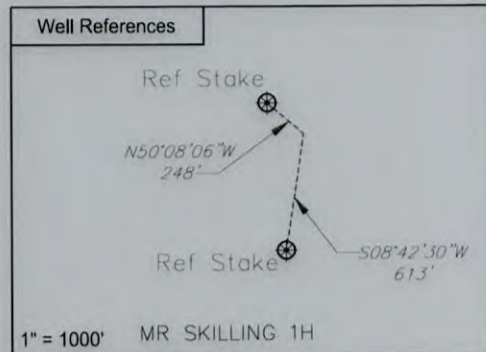

Notes:
MR SKILLING 1H coordinates are
NAD 27 N: 433,484.470 E: 1,744,200.892
NAD 27 Lat: 39.686611 Long: -80.408940
NAD 83 UTM N: 4,393,151.164 E: 550,699.763

MR SKILLING 1H Bottom Hole coordinates are
NAD 27 N: 431,576.200 E: 1,739,397.835
NAD 27 Lat: 39.681237 Long: -80.425936
NAD 83 UTM N: 4,392,545.36 E: 549,246.138

West Virginia Coordinates system of 1927 (North Zone) based upon Differential GPS Measurements
Plat orientation, Corner and well ties are based upon the grid north meridian
Well location references are based upon the grid north meridian.
UTM coordinates are NAD83, Zone 17, Meters.

MR SKILLING PAD

- MR SKILLING 1H
- MR SKILLING 3H
- MR SKILLING 5H
- MR SKILLING 7H
- MR SKILLING 9H
- MR SKILLING 11H
- MR SKILLING 13H
- MR SKILLING 15H

MR SKILLING 31H 103-03683



I, the undersigned, hereby certify that this plat is correct to the best of my knowledge and belief and shows all the information required by law and the regulations issued and prescribed by the Department of Environmental Protection.

L.L. S. 2394
L. L. S. 2394



FILE NO:
DRAWING NO:
SCALE: 1" = 1000'
MINIMUM DEGREE OF ACCURACY:
1:2500
PROVEN SOURCE OF ELEVATION:
NGS CORS Station



DATE: OCTOBER 28 20 25
OPERATORS WELL NO: Mr Skilling 1H
API WELL NO
47 - 103 - 03826
STATE COUNTY PERMIT

WELL TYPE: OIL GAS LIQUID INJECTION WASTE DISPOSAL
(IF GAS) PRODUCTION: STORAGE DEEP SHALLOW
LOCATION ELEVATION: 1491' WATERSHED: West Virginia Fork Fish Creek QUADRANGLE: Hundred
DISTRICT: Church COUNTY: Wetzel
SURFACE OWNER: EQT Production Company and Wolfpen Knob Development Co ACREAGE: 58.7 ±
ROYALTY OWNER: Sarah Anne Magnotti, et al. LEASE NO: 124459000 ACREAGE: 162.00 ±
PROPOSED WORK: DRILL CONVERT DRILL DEEPER FRACTURE OR STIMULATE PLUG OFF OLD FORMATION
 PERFORATE NEW FORMATION OTHER PHYSICAL CHANGE IN WELL (SPECIFY)
 PLUG AND ABANDON CLEAN OUT AND REPLUG TARGET FORMATION: Marcellus ESTIMATED DEPTH: 7,972'

WELL OPERATOR: EQT Production Company DESIGNATED AGENT: Joseph C Mallow
ADDRESS: 2200 Energy Drive ADDRESS: 427 Midstate Drive
Canonsburg, PA 15317 Clarksburg, WV 26301

03/27/2026