

39° 45' 00"

Latitude

80° 30' 00"

Longitude

 2.125
 .24w

Topo Location

7.5' Loc. _____ 15' Loc. _____
 _____ (calc.) _____

Company Pitts d WV Gas

Farm Amos Jolliffee #2267

15' Quad _____
(sec.)

7.5' Quad Littleton

District Clay

WELL LOCATION PLAT

County 103 Permit 30010

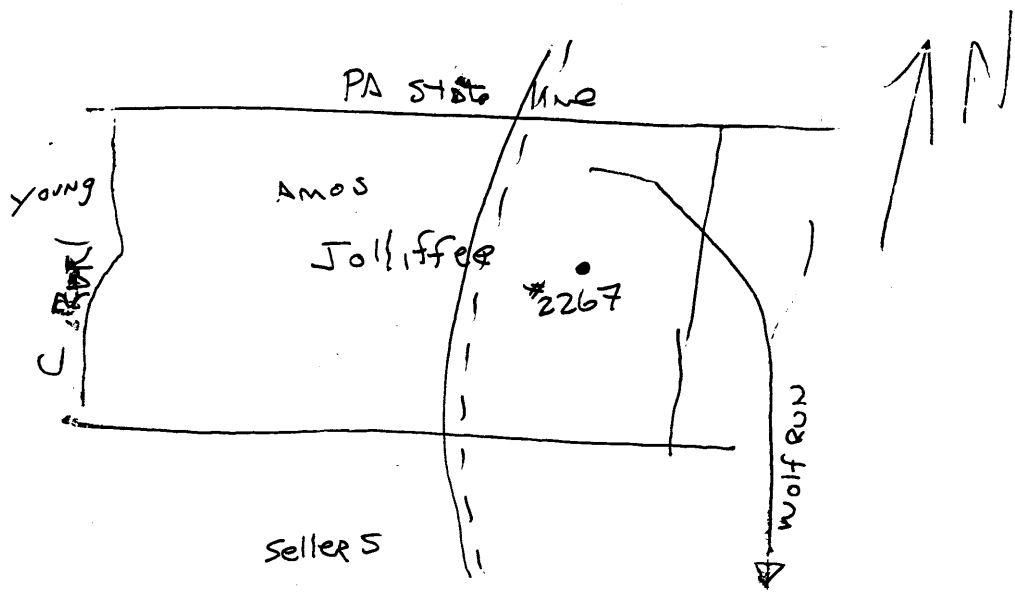

Clay District, Wetzel County, W. Va.

By Pittsburgh & W. Va. Gas Co., 435 Sixth Ave., Pittsburgh, Pa.

Abandoned under permit Wet-10.

On 109 acres, surface owned by Geo. M. Lenley, Littleton, W. Va.,
and $\frac{1}{2}$ minerals by Geo. M. Lenley, Littleton, W. Va., and $\frac{1}{2}$ by
Amos Jolliffe, Uniontown, W. Va.

Well completed July 20, 1909.

$\frac{3}{4}$ " casing, 1630'; 2" tubing, 1960'.

One Keester well packer, $8\frac{1}{2}$ x 4, set at 1960'.

Coal was encountered at 1056-1061 and 1170-1177'.

Abandonment reported to Dept. of Mines Sept. 16, 1929.

Well was not shot. Producing hole. (Gas?)

Record to RST from Mrs. Griffith Sept. 10, 1938.

	Top.	Bottom.	Thickness.
Clay, yellow	0	25	25
Lime, white, hard	25	100	75
Slate, black	100	125	25
Lime, white, hard	125	275	150
Slate, black, soft	275	525	250
Lime, white, soft	525	600	75
Slate and Sh.	600	700	100
Lime, white	700	1000	300
Slate, black	1000	1056	56
Mapletown (Sewickley) Coal, black	1056	1061	5
Lime, white	1061	1156	95
Slate, black	1156	1170	14
Pittsburgh Coal, black	1170	1177	7
Lime, white, hard	1177	1227	50
Red rock, soft	1227	1267	40
Slate, white, soft	1267	1327	60
Red rock cave	1327	1417	90
Lime, grit, hard	1417	1487	70
Slate, white, soft	1487	1547	60
Red rock	1547	1577	30
Lime, white, hard	1577	1630	53
Big Dunkard Sand	1630	1670	40
Slate and Sh.	1670	1896	226
Sand (water, 1921')	1896	2021	125
Sl. & Sh.	2021	2041	20
Salt Sand (gas, 2051')	2041	2260	219
Red rock	2260	2272	12
Little Lime	2272	2300	28
Slate, black	2300	2340	40
Big Lime	2340	2410	70
Big Injun Sand	2410	2635	225
Lime and Sh.	2635	2685	50
Slate, white	2685	2760	75
Lime, hard	2760	2800	40
Sl. & Sh.	2800	2875	75
Sl. & Sh.	2875	2925	50
Shells, hard	2925	2955	30
Lime & Sh., hard	2955	3000	45
Slate, black	3000	3025	25
Lime, white, hard	3025	3045	20
Slate, white, soft	3045	3085	40
Slate & Sh.	3085	3135	50

AMOS JOLLIFFE ET UX NO. 2267 WELL (Continued).

	Top.	Bottom.	Thickness.
Slate, black	3135	- 3160	25
50-Ft. Sand, hard	3160	- 3184	24
Slate, white, soft	3184	- 3210	26
Stray Sand	3210	- 3230	20
Break	3230	- 3240	10
Gordon Sand, hard	3240	- 3265	25
Slate, white	3265	- 3290	35
Fourth Sand	3290	- 3302	12
Slate, black	3302	- 3367	65
Fifth Sand	3367	- 3371	4
Slate, black, soft	3371	- 3506	135
Total depth		3506	