

Latitude

Longitude

+
 2.71s
 2.17w

Topo Location

7.5' Loc. _____ 15' Loc. _____
 _____ (calc.) _____

Company Pitts + WV Gas Co

Farm H E Gorby # 1853

15' Quad _____
(sec.)

7.5' Quad Hundred

District Clay

WELL LOCATION PLAT

County 103 **Permit** 30013

Clay cist

30013

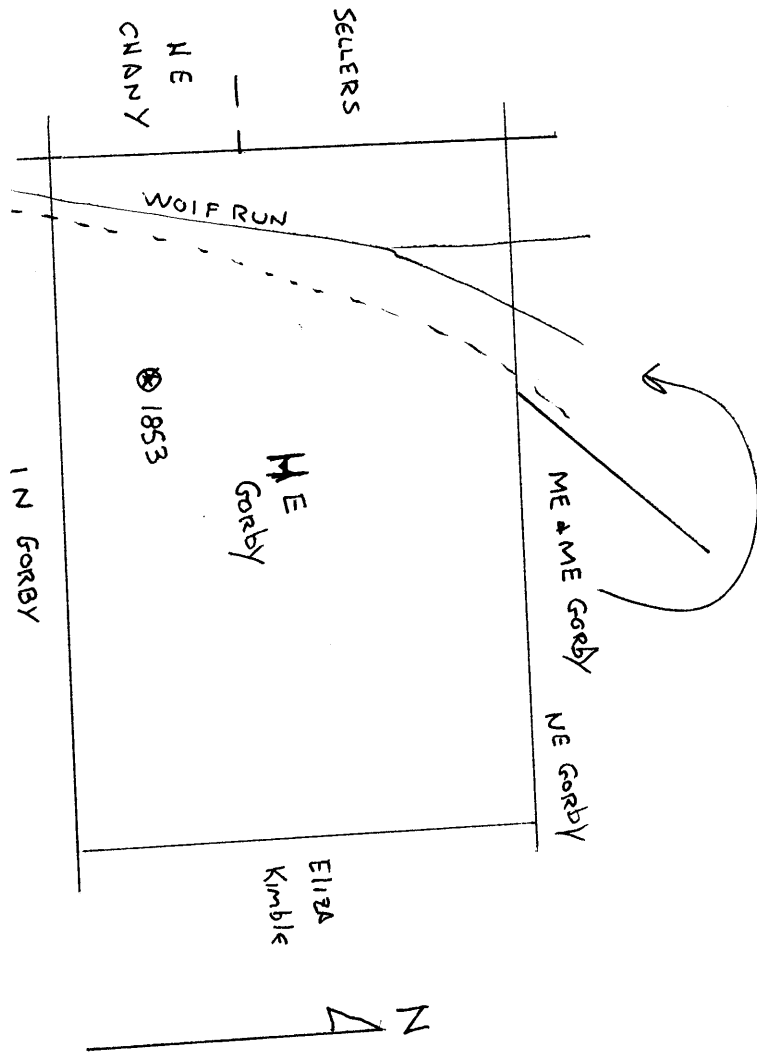

Clay District, Wetzel County, W. Va.

By Pittsburgh & W. Va. Gas Co., 435 Sixth Ave., Pittsburgh, Pa.

Abandoned under permit Wet-13.

On 1.85 acres, surface owned by M. E. Gorby, Littleton, W. Va., and minerals by: Gorby probably owns oil and gas rights; Lewis Hoy, W. W. Sayers, Waynesburg, Pa., owns coal rights.

Well completed July 22, 1905.

Elevation, 1176' L.

10" casing, 244'; 8 $\frac{1}{2}$ " , 1354'; 6 $\frac{3}{4}$ " , 2136'; 2" tubing, 2213'.Hook wall packer, 6 $\frac{3}{4}$ " x 2, set at 2142'.

2" casing perforated at 2142-2213'.

Coal was encountered at 650-656, 775-782, and 894-904; and 430-433'.

Located June 23, 1905; completed, July 22, 1905; producing gas, well in Big Injun Sand. Well was not shot.

Abandonment reported to Dept. of Mines Jan. 11, 1930.

Record to RCT from Mrs. Griffith Sept. 10, 1938.

	Top.	Bottom.	Thickness.
Native coal	430	- 433	3
Fairview Coal (Uniontown)	650	- 656	6
Mapletown (Sewickley)	775	- 782	7
Pittsburgh Coal	990	- 1000	10
Sand	1014	- 1074	60
Red rock	1080	- 1090	10
Red rock, soft	1090	- 1095	5
Red rock	1110	- 1125	15
Red rock, soft	1175	- 1230	55
Lime	1230	- 1236	6
Red rock	1236	- 1312	76
Little Dunkard Sand	1312	- 1337	25
Lime	1337	- 1380	43
Big Dunkard Sand	1380	- 1420	40
Sl. & Sh.	1420	- 1650	230
Gas Sand (gas, 1665')	1650	- 1789	139
Slate	1789	- 1799	10
Salt Sand	1799	- 1848	49
Slate	1848	- 1880	32
Salt Sand	1880	- 1910	30
Slate	1910	- 1925	15
Maxton Sand	1925	- 1965	40
Slate	1965	- 2055	90
Red rock	2055	- 2075	20
Big Lime	2075	- 2140	65
Big Injun Sand (gas, 2154')	2140	- 2403	263
Sl. & Sh.	2403	- 2563	160
Slate	2563	- 2623	60
Lime & Sh.	2623	- 2763	140
Sl. & Sh.	2763	- 2813	50
Red rock & Sh.	2813	- 2868	55
50-Ft. Sh.	2868	- 2893	25
Shells	2893	- 2943	50
Gordon Stray Sand (show gas, 2977')	2974	- 2989	15
Gordon Sand	2991	- 3004	13
Fourth Sand	3037	- 3053	16
Lime & Sh.	3053	- 3096	43
Sl. & Sh.	3096	- 3191	95
Total depth			3191