

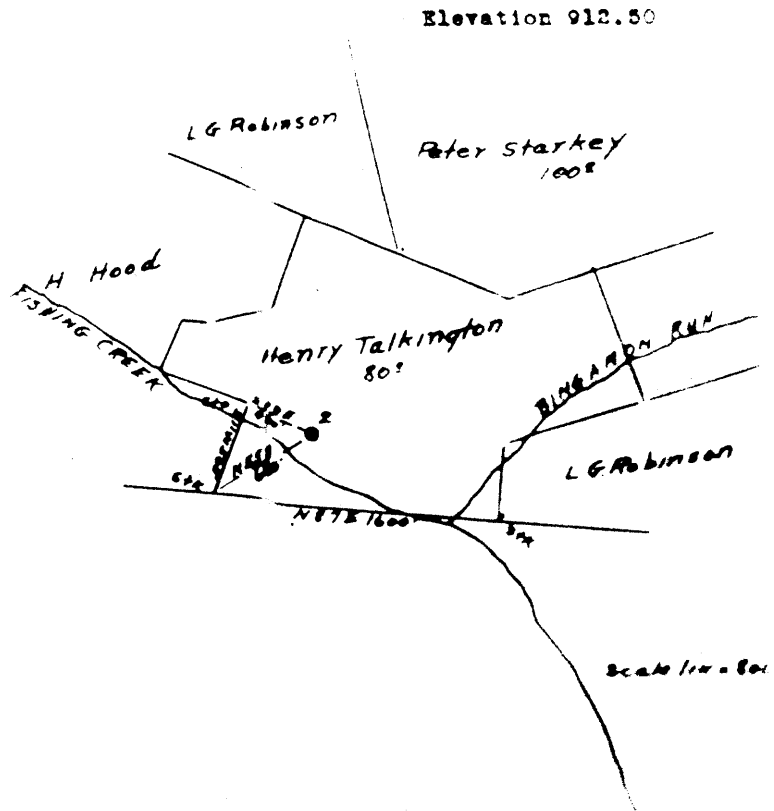

36019

I hereby certify that this map is correct and shows all the information to the best of my knowledge and belief as required by the all and see section of the mining laws of West Virginia.

Frank Goodwin  
Engineer



Grant District, Wetzel County, W. Va.

By North Penn Oil Co., Box 1255, Pittsburgh, Pa.

Abandoned under permit Wet-19.

On 30 acres, surface owned by Robinson Improvement Co., The Plains, Va., and oil and gas by Robinson Improvement Co., The Plains, Va., and coal by H. Harzog et al., Gainesville, Fla.

Elevation, 912.50' B.

32" wood conductor; 10" casing, 454'; 3 1/2", 1315'; 6", 2161'.

Coal was encountered at 763-770'.

Abandonment reported to Dept. of Mines April 30, 1930.

Well was shot at.....?

Salt water at 2125'.

Oil well. Record to NCT from Mrs. Griffith Sept. 10, 1938.

	Top.	Bottom.
Conductor	0	32
Pittsburgh Coal	763	770
Dunkard Sand	1175	1196
Salt Sand	1625	1710
Pencil Cove	1935	1944
Big Line	1944	2047
Big Injun Sand (water, 2125')	2047	2141
31-Ft. Sand	2490	2520
Gantz Sand	2600	2640
50-Ft. Sand	2732	2756
Stray Sand	2814	2839
Gordon Sand (oil, 2860')	2857	.....
Total depth		2870