

30025
Center Dist

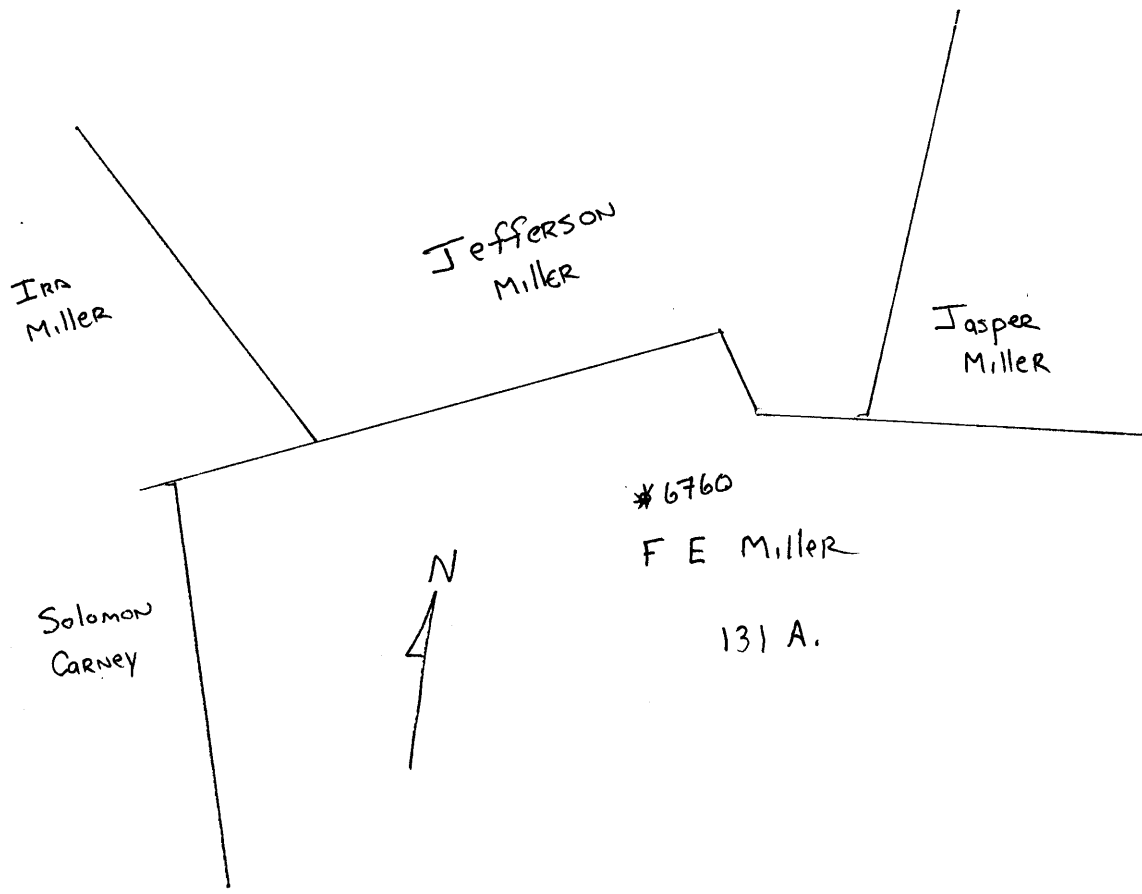

Center District, Wetzel County, W. Va.
 By Hope Natural Gas Co., 445 W. Main St., Clarksburg, W. Va.
 On 131 acres, surface owned by F. E. Miller, Silver Hill, W. Va.;
 owner of mineral rights, unknown. *Ab. R. 25-A-*
 Drilled prior to June 1, 1929.
 Elevation, 1353' L.
 10" casing, 622'; 8 1/4", 1560'.
 Coal was encountered at 1148-1154 and 1244-1249'.
 Abandonment reported to Dept. of Mines Oct. 22, 1930.
 Fresh water at 65'; salt water at 1244'.
 No record of formations overlying the coal seams.
 Water at 65', and 1244'.
 Record to 1602' filed with Dept. of Mines.
 Record below 1602 to 3294' in pencil by J.G.

	Top.	Bottom.
Mapletown (Sewickley) Coal	1145	- 1151
Pittsburgh Coal	1244	- 1249
Little Dunkard Sand (8 1/4" casing, 1560')	1575	- 1602
Sand	1640	- 1683
Big Dunkard Sand	1760	- 1787
Gas Sand	1888	- 1930
1st Salt Sand	1990	- 2022
2nd Salt Sand	2130	- 2167
Maxton Sand	2289	- 2325
Sand	2333	- 2348
Big Lime	2380	- 2437
Big Injun Sand (gas, 21/10 W. in 1" at 2515-2525')	2437	- 2670
Gordon Stray Sand	3263	- 3279
Gordon Sand (7 gals. oil in 8 hrs.) (Break in Gordon, 3290-3294')	3284	- 3297