

Latitude

Longitude



2.05s
.87w

Topo Location

7.5' Loc. _____ 15' Loc. _____
 (calc.) _____

Company South Penn Oil Co

Farm H L Smith #50

15' Quad _____
(sec.)

7.5' Quad Big Run

District GRANT

WELL LOCATION PLAT

County 103 **Permit** 30032

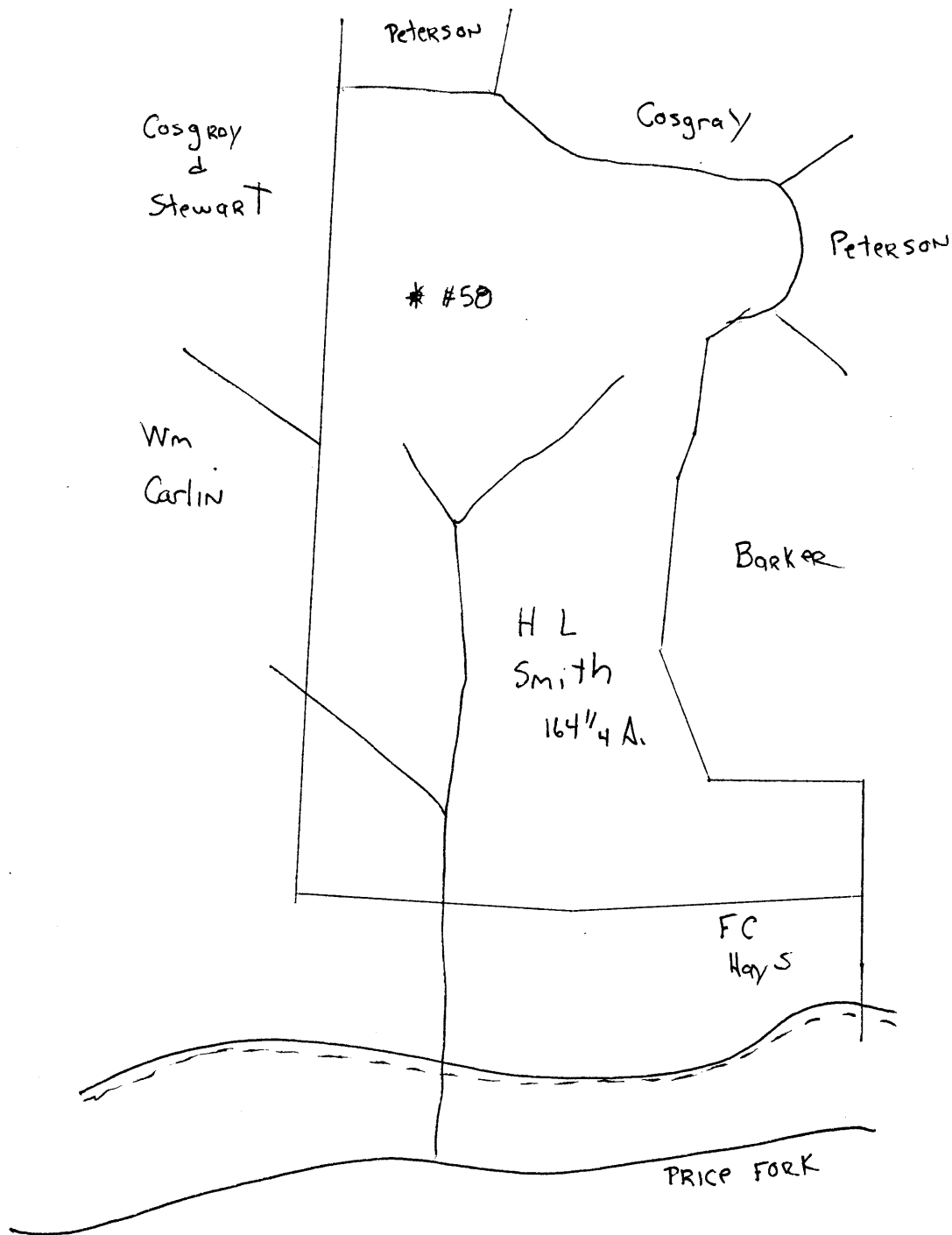

WET-32-A

Grant District, Wetsel County, W. Va.

By South Penn Oil Co., P. O. Drawer 1255, Pittsburgh, Pa.

On 16 $\frac{1}{4}$ acres, surface and mineral rights owned by H. Laurie
Smith, 300 Law Bldg., Richmond, Va.

Elevation, 1045'.

(NOTE by J.G.: Either location or elevation is wrong).

10" casing, 461' 3"; 8 $\frac{1}{2}$ ", 1335' 7"; 6-5/8", 2097' 9"; 5-3/16",
2627' 4".

Coal was encountered at 825-832'.

Abandonment reported to Dept. of Mines Jan. 15, 1931.

Well was shot in Gordon Sand.

Oil well.

	Top.	Bottom.
Conductor	0	16
Pittsburgh Coal	825	832
Little Dunkard Sand	1155	1175
Gas Sand	1485	1535
1st Salt Sand	1630	1680
2nd Salt Sand	1770	1830
Pencil Cave	2060	2070
Big Lime	2070	2126
Big Injun Sand (gas show, 2140')	2126	2310
50-Ft. Sand	2630	2640
30-Ft. Sand	2790	2798
Stray Sand	2865	2897
Gordon Sand (oil, 2939-2942')	2936	
Total depth		2950