

Latitude

39° 32' 30"

80° 35' 00"

st.
77s
m.f.
71w

Longitude

Topo Location

7.5' Loc. _____ 15' Loc. _____
_____ (calc.) _____

Company Standard Pipe & Supply Co
Farm AL Wyatt #2
15' Quad _____
(sec.) _____
7.5' Quad Big Run
District Grant

WELL LOCATION PLAT

County 103 Permit 30069

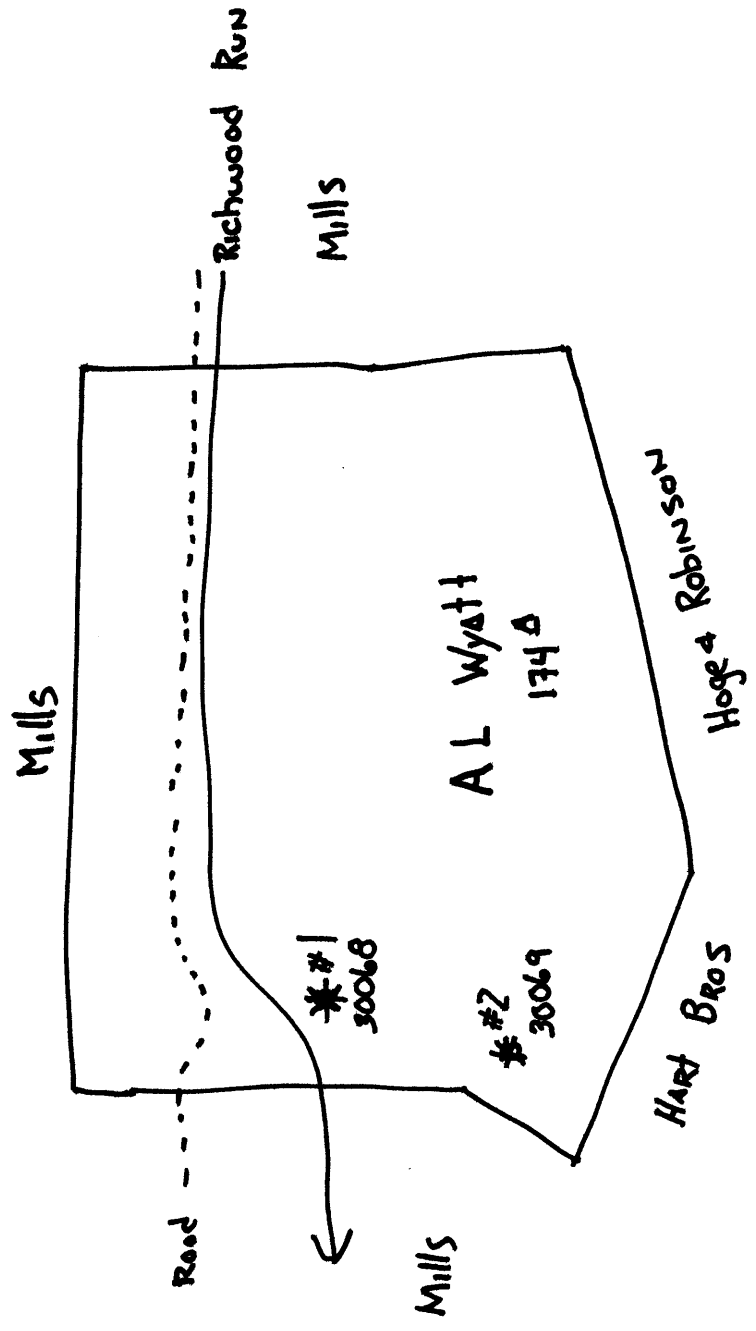

Grant District, Wetzel County, W. Va.

By The Standard Pipe & Supply Co., Marietta, Ohio. (H.H. Beren).

Abandoned under permit Wet-69.

On 1 $\frac{3}{4}$ acres, on Richwood Run; surface and minerals owned by

A. L. Wyatt, Jacksonburg, W. Va.

Elevation, 1043.4' L.

16" conductor, 16'; 6 $\frac{3}{8}$ " casing, 2050'.

Coal was encountered at 790'.

Abandonment reported to Dept. of Mines Nov. 16, 1931.

Record to ROT from Mrs. Griffith Sept. 10, 1938.

	Top.	Bottom.
Pittsburgh Coal	790	- ...
Cow Run Sand, 2nd	1320	-
Third Salt Sand	1700	-
Marton Sand	1980	-
Big Line	2045	-
Big Injun Sand	2085	- 2285
Gordon Sand	2890	-
Total depth		2925