

39°30'00"

80°30'00"

Latitude

Longitude

+ 2.56s
1.30w

Topo Location

7.5' Loc. _____ 15' Loc. _____
_____ (calc.) _____

Company South Penn Oil

Farm Paddy Ice # 5

15' Quad _____
(sec.)

7.5' Quad Folsom

District GRANT

WELL LOCATION PLAT

County 103 **Permit** 30097

30097
~~CHUTE~~
GRANT

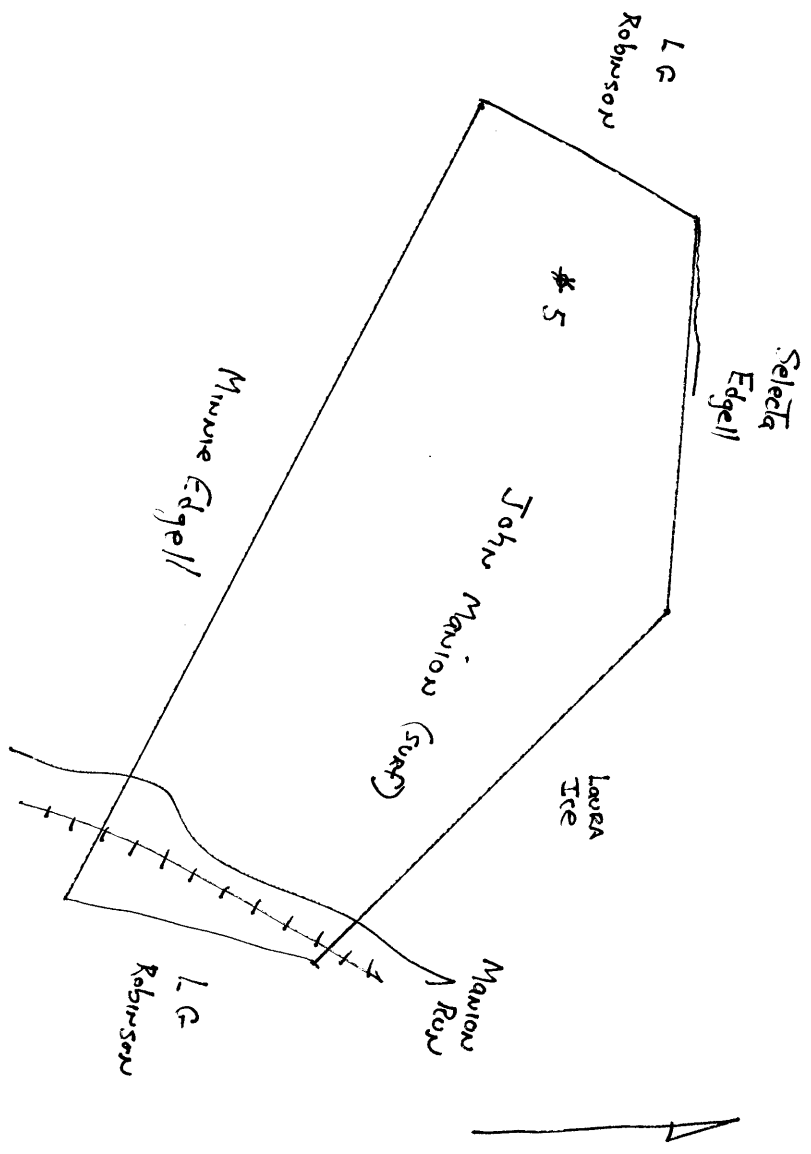

Grant District, Wetzel County, W. Va.
 By South Penn Oil Co., Drawer 1255, Pittsburgh, Pa.
 On 50 acres, surface owned by John Manion, Folsom, W. Va., and
 mineral rights by Minnie Morgan, Extrm., et al., New Martins-
 ville, W. Va.

Elevation, 1316.7' L.

16' conductor; 10" casing, 265'; 8 $\frac{1}{4}$ " 1656'; 6-5/8" 2584';
 5-3/16" 2774'.

Coal was encountered at 1156-1160'.

Liners: 167 ft. of 4 $\frac{1}{2}$ x 4".

Abandonment reported to Dept. of Mines Nov. 30, 1932.

Well was shot Nov. 6, 1905, with 20 qts.; and in Gordon,
 Jan. 9, 1923, with 30 qts.

Producing hole.

	Top.	Bottom.
Wood conductor	0	16
Pittsburgh Coal	1156	1160
Little Dunkard Sand	1530	1550
Big Dunkard Sand	1635	1665
Salt Sand	2060	2165
Maxton Sand	2300	2355
Pencil Cave	2355	2365
Big Lime	2365	2435
Big Injun Sand	2435	2530
50-Ft. Sand	3015	3040
30-Ft. Sand	3150	3170
Stray Sand (gas, 3194')	3175	3230
Gordon Sand (oil, 3240')	3240	3258
Total depth		3264

NET-97-A