

**Latitude**

**Longitude**

1.34s  
.03w

**Topo Location**

7.5' Loc. \_\_\_\_\_ 15' Loc. \_\_\_\_\_  
\_\_\_\_\_ (calc.) \_\_\_\_\_

**Company** RA Marshall & Co

**Farm** JD Snodgrass #1

**15' Quad** \_\_\_\_\_  
(sec.)

**7.5' Quad** Big Run

**District** Grant

**WELL LOCATION PLAT**

**County** 103 **Permit** 30138

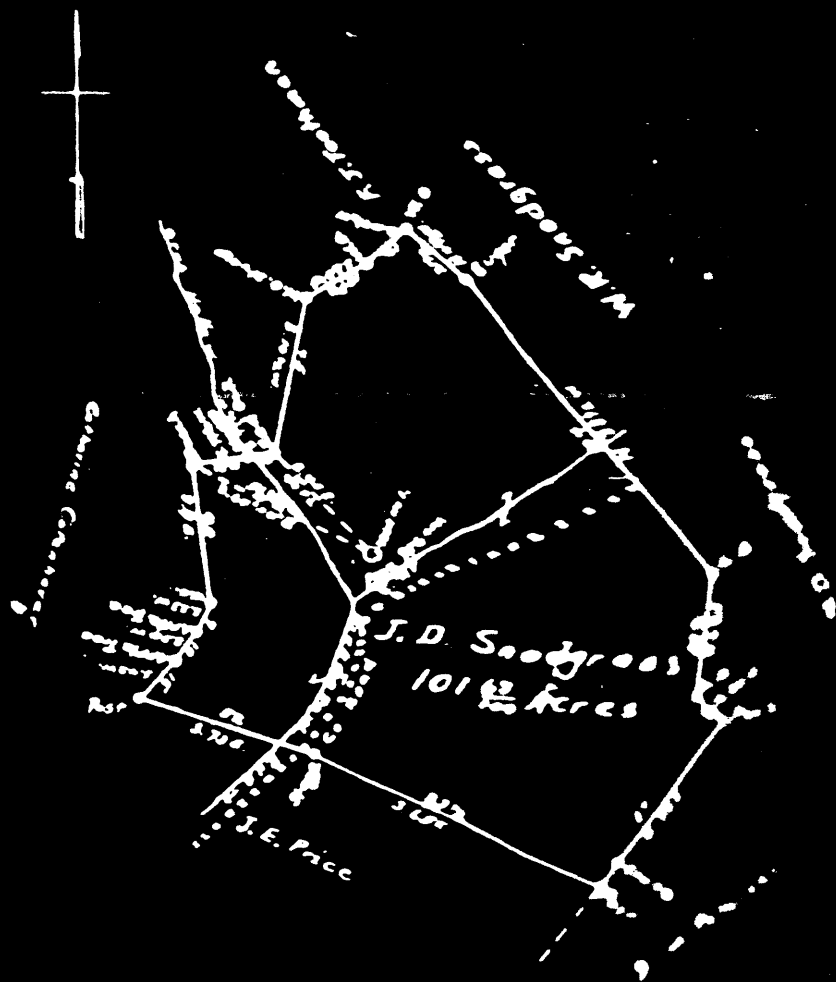

Scale 1 inch = 40 Rods.

Engineer's Certificate

I, the undersigned, hereby certify that this map is a true and correct copy of the original map and shows all the information to the best of my knowledge and belief as furnished by the oil and gas section of the Mining Laws of this State.

*Prof. Earl*

Acknowledged before me a Notary Public

----- this 20<sup>th</sup> day of October 1911

My Commission expires June 27, 1914. *E. G. Johnson*

West Virginia.

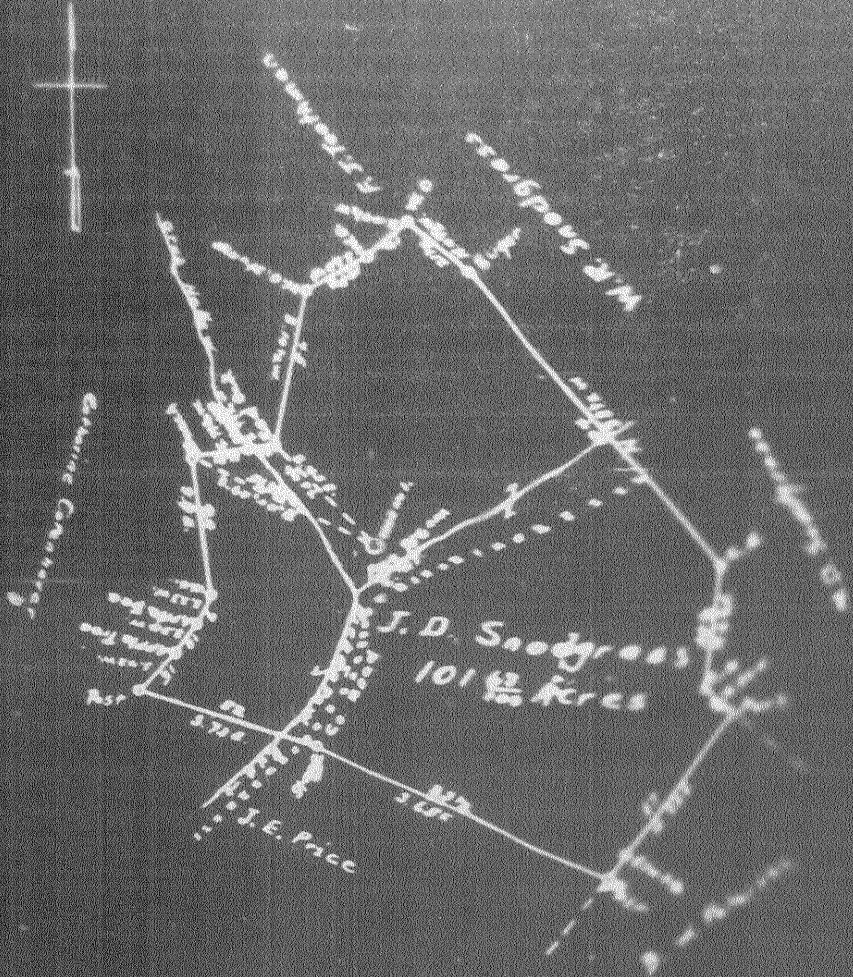

Scale 1 inch = 40 Rods.

Engineer's Certificate

I, the undersigned, hereby certify that this map as shown above shows all the information to the best of my knowledge and belief obtained by the oil and gas section of the Mining Lands of West Virginia.

*Prof. [Signature]*

Acknowledged before me a Notary Public  
this 20<sup>th</sup> day of October 1906

My commission expires Jan 21 - 1908 *[Signature]*

J. D. SNODGRASS NO. 1 WELL.

No. 435 O.F.-Wetzel.

W-138-A

Grant District, Wetzel County, W. Va.

By R. A. Marshall & Co., Butler, Pa. (Box 921).

On 101.63 acres, on Pickenpangh Run; surface owned by W. R.

Snodgrass, Route 1, Smithfield, W. Va., and mineral rights

by C. A. Snodgrass Estate, Mannington, W. Va.

Elevation, 956' E.

1 1/2" conductor, 16'; 10" casing, 450'; 8 1/2", 1295'; 6-5/8", 2010'.

Coal was encountered at 775'.

Abandonment report to Dept. of Mines not dated, but filed 11-12-1934.

Well was not shot.

Salt water at 2162'.

Oil well.

	Top.	Bottom.
Pittsburgh Coal, black	775	
Big <sup>4</sup> / <sub>n</sub> Jun Sand (oil, 2077 and 2159'; water, 2162')	2077	
Total depth		2170