

Latitude

+

.63s
.33w

Longitude

Topo Location

7.5' Loc. _____ 15' Loc. _____
_____ (calc.) _____

Company Arthur Mackey

Farm JR PARR #5303

15' Quad _____
(sec.)

7.5' Quad PINE GROVE

District GREEN

WELL LOCATION PLAT

County 103 **Permit** 30184

MARION
MASON

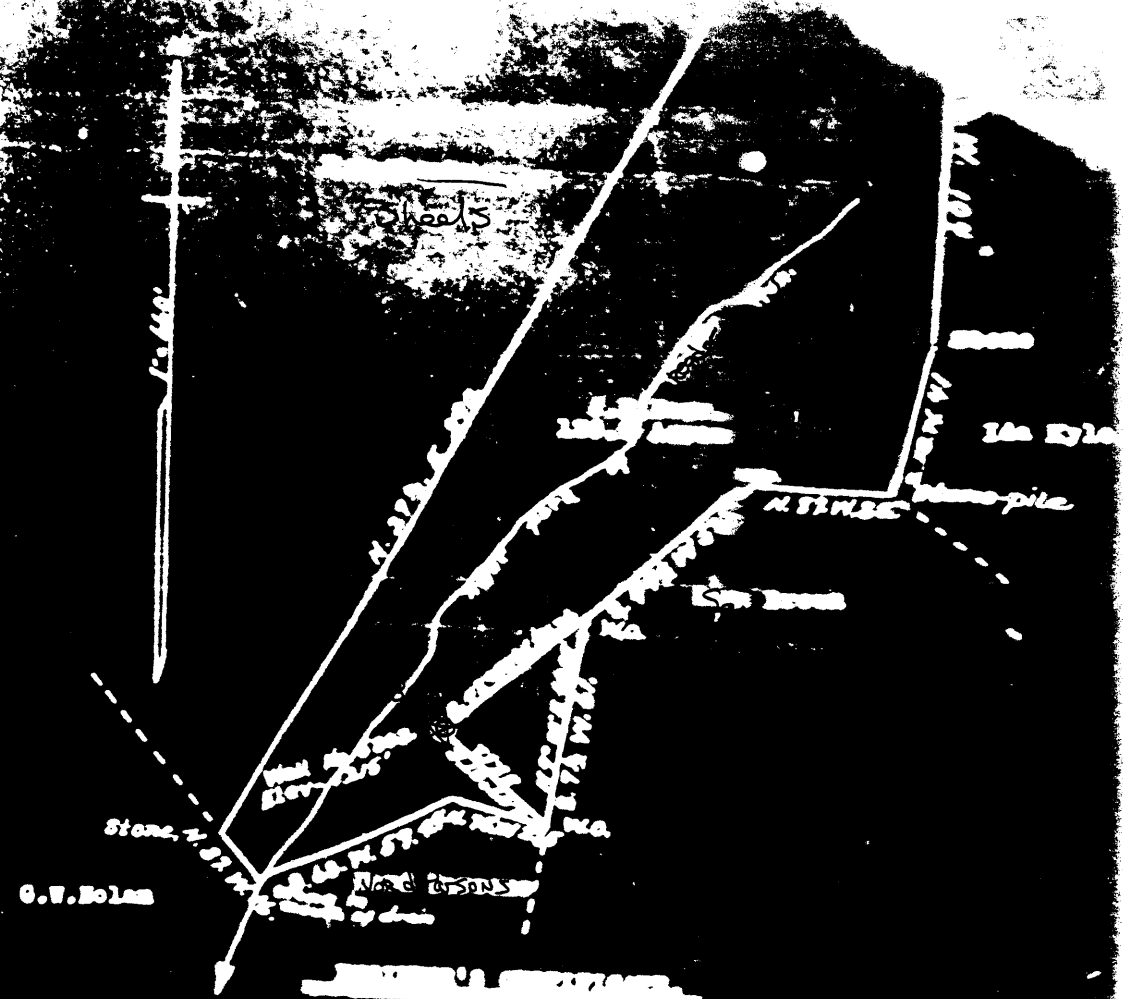

O.W. Nolan

I, the undersigned hereby certify that this map is correct and shows all the information on the basis of my knowledge and belief, acquired by me and the members of the mining laws of West Virginia.

Arthur Headly
 Registrar, W. Va.

30184

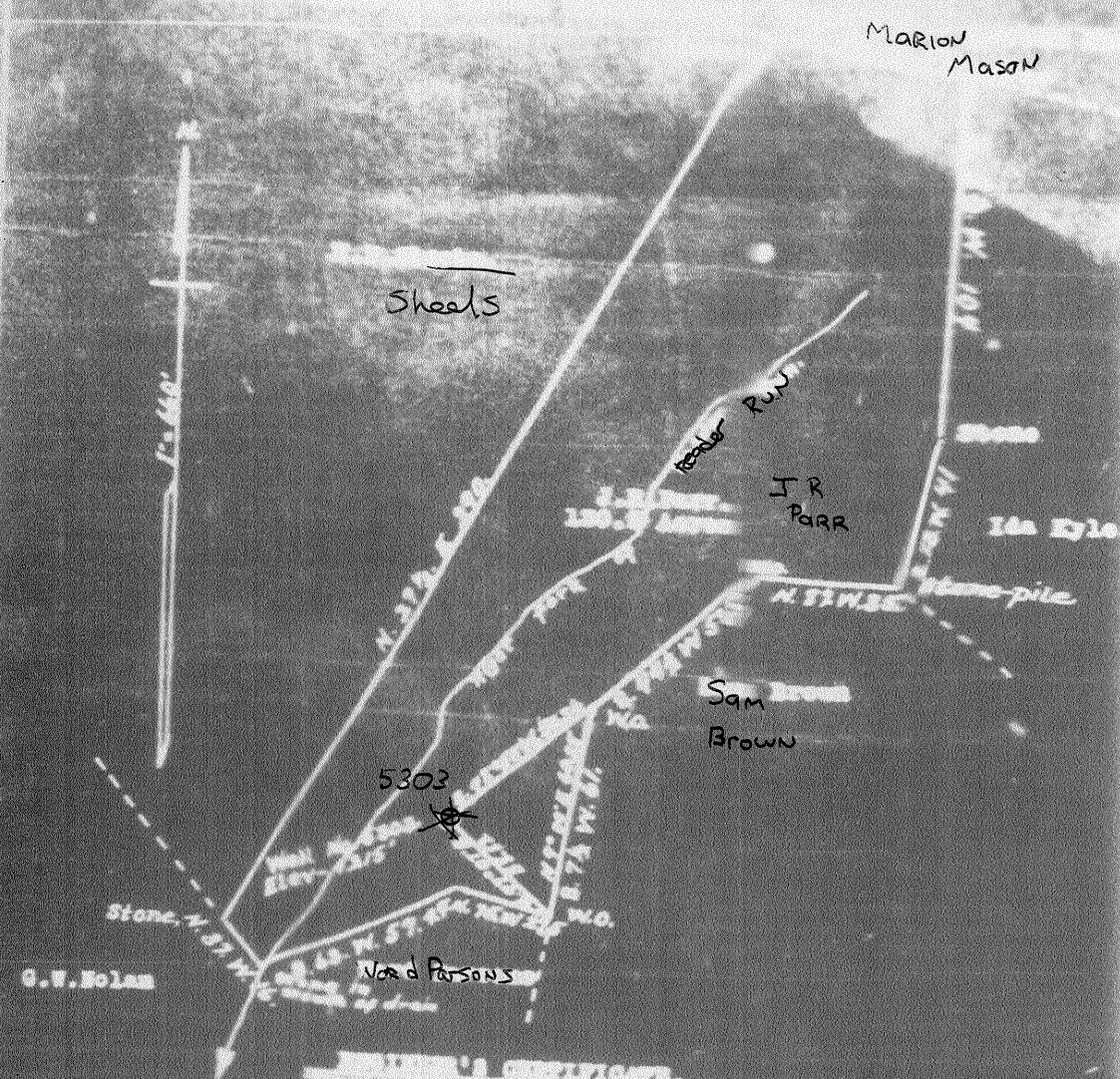

I, the undersigned hereby certify that this map is correct and shows all the information on the basis of my knowledge and belief, required by the coal and gas sections of the mining laws of West Virginia.

A. J. Hendley
 Surveyor
 Fairview, W. Va.

Green District, Wetzel County, W. Va.

By Arthur Mackey, Marietta, Ohio.

On 130.5 acres.

Elevation, 1215' B.

10" casing, 411'; 8 $\frac{1}{2}$ ", 1429'; 6 $\frac{3}{8}$ ", 2138'.

Coal was encountered at 407-417 and 915-917'.

Abandonment reported to Dept. of Mines Nov. 30, 1935.

Gas well.

NET-184A

	Top.	Bottom.	Thickness.
Mapletown -(Sensibility) Coal	407	- 417	10
Pittsburgh Coal	915	- 917	2
Little Dunkard Sand	1290	- 1310	20
Big Dunkard Sand	1429	- 1479	50
Gas Sand	1497	- 1527	30
Salt Sand	1740	- 1795	55
Salt Sand	1865	- 1930	65
Maxton Sand (gas, 2000')	1960	- 2010	50
Big Lime	2085	- 2140	55
Big Injun Sand (gas, 2142 and 2215')	2140	- 2386	246
Squaw Sand	2525	- 2536	11
Gantz Sand	2560	- 2586	26
Boulder Sand	2715	- 2723	8
50-Ft. Sand	2785	- 2810	25
Gordon Stray Sand (gas, 2968')	2958	- 2971	13
Gordon Sand (gas, 2989')	2972	- 3000	28
Total depth			3113