

39° 30' 00"

Latitude

80° 30' 00"

Longitude

1.85s  
37w

**Topo Location**

7.5' Loc. \_\_\_\_\_ 15' Loc. \_\_\_\_\_  
\_\_\_\_\_ (calc.) \_\_\_\_\_

Company South Penn Nat Gas

Farm Genuine Robinson #5

15' Quad \_\_\_\_\_  
(sec.)

7.5' Quad Folsom

District Grant

**WELL LOCATION PLAT**

County 103 Permit 366A

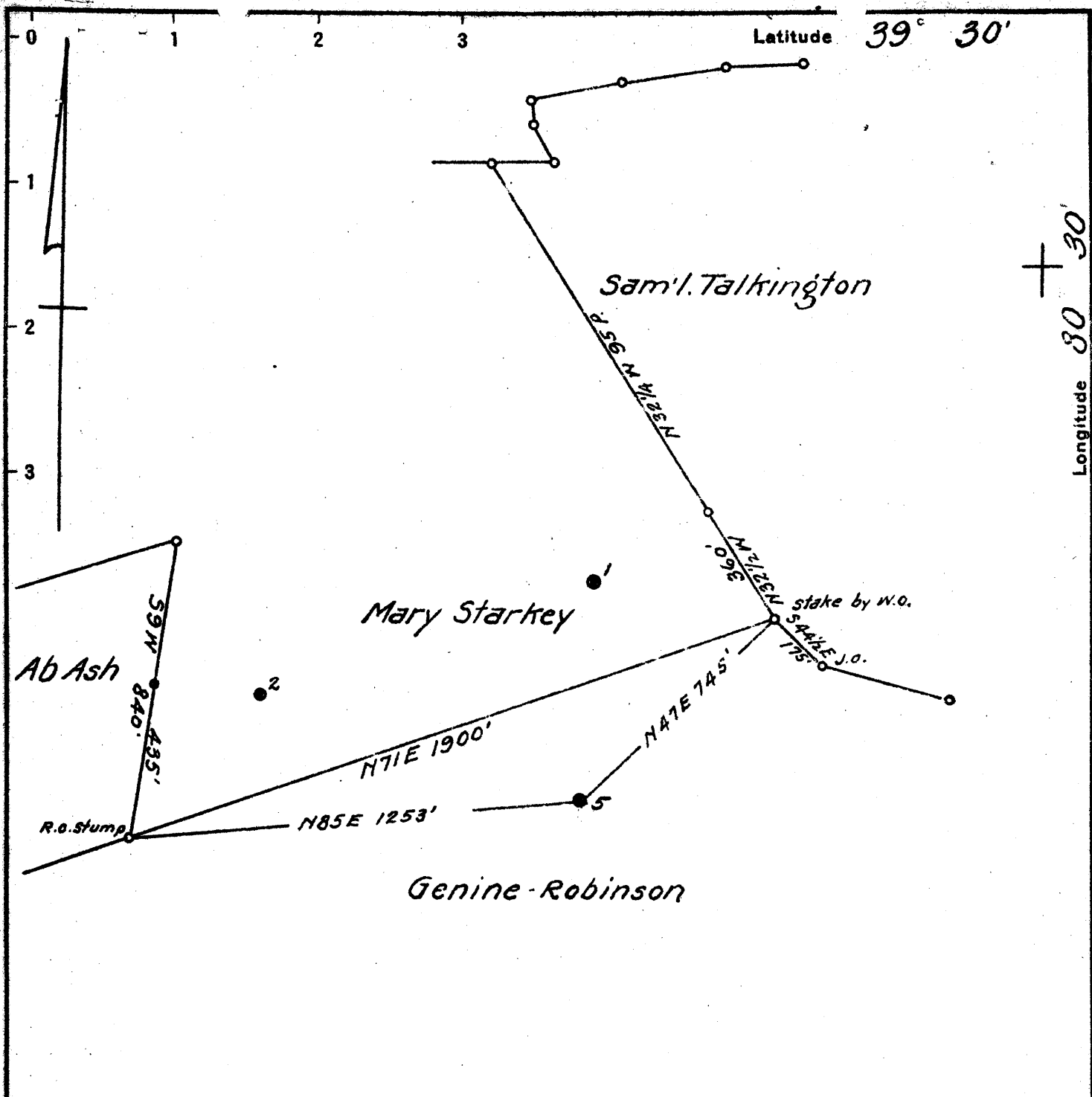

Coal & Surface:  
 Robinson Improvement Co.  
 The Plains, Va.

0.33 W  
 174 1.79

New Location...   
 Drill Deeper...   
 Abandonment...

AUG 12 1941

N 2 E 6-7

Company South Penn Natural Gas Co.  
 Address Parkersburg, W. Va.  
 Farm Genine Robinson  
 Tract \_\_\_\_\_ Acres 2600 Lease No. 46809  
 Well (Farm) No. 5 Serial No. \_\_\_\_\_  
 Elevation (Spirit Level) 1229.00  
 Quadrangle Centerpoint  
 County Wetzel District Grant  
 Engineer Emmon Haines  
 Engineer's Registration No. \_\_\_\_\_  
 File No. \_\_\_\_\_ Drawing No. \_\_\_\_\_  
 Date May 27, 1941 Scale 1" = 400'

STATE OF WEST VIRGINIA  
 DEPARTMENT OF MINES  
 OIL AND GAS DIVISION  
 CHARLESTON

WELL LOCATION MAP  
 FILE NO. WET-366A

+ Denotes location of well on United States Topographic Maps, scale 1 to 62,500, latitude and longitude lines being represented by border lines as shown.  
 - Denotes one inch spaces on border line of original tracing.

STATE OF WEST VIRGINIA  
DEPARTMENT OF MINES  
OIL AND GAS DIVISION

851

WELL RECORD

Permit No. 365-A

Oil or Gas Well OIL  
(Kind)

Company South Penn Natural Gas Company  
Address Union Trust Bldg. Parkersburg, W. Va.  
Farm Genine Robinson Acres 2600  
Location (waters) - - -  
Well No. 5 Elev. 1229'  
District Grant County Wetzel  
The surface of tract is owned in fee by Robinson Improvement Company Address The Plains, Va.  
Mineral rights are owned by Robinson Improvement Co. Address The Plains, Va.  
Drilling commenced June 3, 1902  
Drilling completed Nov. 27, 1902  
Date shot See below Depth of shot --  
Open Flow /10ths Water in -- Inch  
/10ths Merc. in -- Inch  
Volume -- Cu. Ft.  
Rock Pressure -- lbs. -- hrs.  
Oil 2 (?) bbls., 1st 24 hrs.  
Fresh water - feet - feet  
Salt water - feet - feet

Casing and Tubing	Used in Drilling	Left in Well	Packers
Size			
16			Kind of Packer <u>-</u>
13			<u>-</u>
	<u>490 (Pulled)</u>		Size of <u>-</u>
8 1/4	<u>1557'</u>		<u>-</u>
6 1/2	<u>2022'</u>		Depth set <u>-</u>
5 3/16	<u>2500'</u>		<u>-</u>
3			Perf. top <u>-</u>
2			Perf. bottom <u>-</u>
Liners Used			Perf. top <u>-</u>
<u>Cond.</u>	<u>16'</u>		Perf. bottom <u>-</u>

CASING CEMENTED - SIZE - No. Ft. - Date -  
COAL WAS ENCOUNTERED AT 1090 FEET 60 INCHES  
- FEET - INCHES - FEET - INCHES  
- FEET - INCHES - FEET - INCHES

Formation	Color	Hard or Soft	Top	Bottom	Oil, Gas or Water	Depth Found	Remarks
Pittsburgh Coal			1090	1095			
Dunkard Sand			1420	1540			
Salt Sand			1960	2126			
Pencil Cave			2285	2390			
Big Lime			2290	2370			
Big Injun Sand			2370	2480			
Thirty Foot Sand (Gantz ?)			2600	2620			
Fifty Foot Sand			2950	2970			
Thirty Foot Sand			3000	3025			
Stray Sand			3129	3170			
Gordon Sand			3182		<u>Oil</u>	<u>3144</u>	
<b>Total Depth</b>				<b>3200</b>			

SHOT RECORD:

Aug. 11 - 1903 20 Qt.  
Feb. 9 - 1909 - -  
Mar. 13-1911 30 Qt.  
Mar. 18-1940 40 Qt.

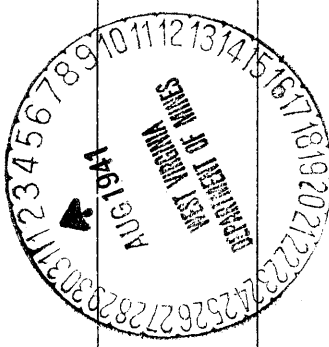

Formation	Color	Hard or Soft	Top	Bottom	Oil, Gas or Water	Depth Found	Remarks

Date **July 31,**

**41**

19.....

APPROVED **SOUTH PENN NATURAL GAS COMPANY**, Owner

By *Elton Young* Land Agent

(Title)