

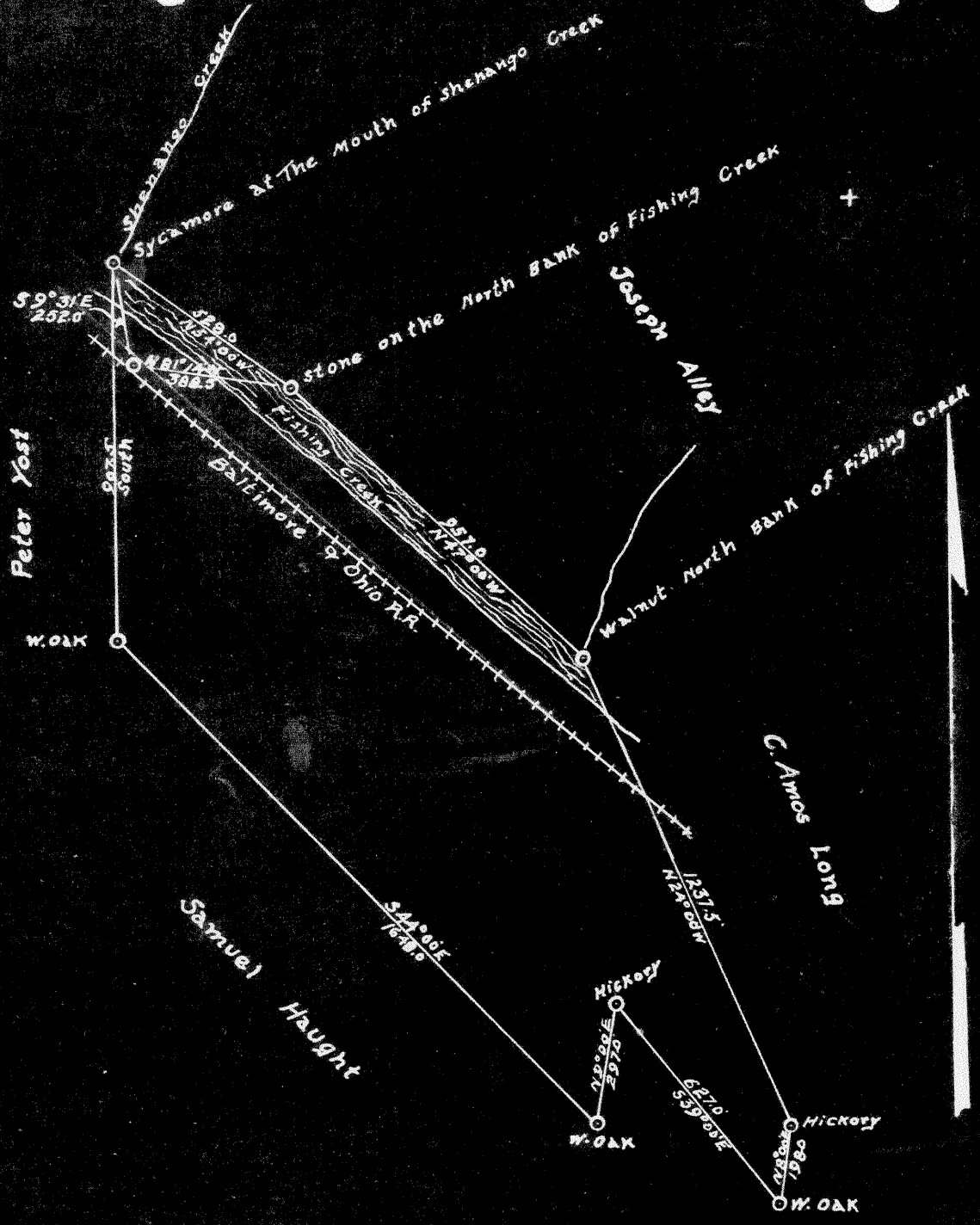

Latitude 39°35'

Longitude 80°40'



1,36 S  
1,60 W

Abandonment - X

Company George Eagon & Daniel Henthorn  
 Address New Martinsville W.Va.  
 Farm C. Amos Long  
 Tract \_\_\_\_\_ Acres 38.5 Lease No. \_\_\_\_\_  
 Well (Farm) No. one Serial No. \_\_\_\_\_  
 Elevation 6910'  
 Quadrangle Littleton  
 County Wetzel District Green  
 Engineer G. L. McIntire  
 Engineer's Registration No. 1187  
 File No. \_\_\_\_\_ Drawing No. \_\_\_\_\_  
 Date DEC. 2, 1948 Scale 1" = 400'

STATE OF WEST VIRGINIA  
 DEPARTMENT OF MINES  
 OIL AND GAS DIVISION  
 CHARLESTON

WELL LOCATION MAP  
 FILE NO. WET-759-A

+ Denotes location of well on United States Topographic Maps, scale 1 to 62,500. latitude and longitude lines being represented by border lines as shown.

- Denotes one inch spaces on border line of original tracing