

39° 42' 30"

Latitude

80° 27' 30"

Longitude



1.60s
.74w

Topo Location

7.5' Loc. _____ 15' Loc. _____
 (calculated) _____

Company Carnegie Nat Gas

Farm FM ANDERSON #3-1268

15' Quad _____
(sec.)

7.5' Quad Hundred

District Church

WELL LOCATION PLAT

County 103 Permit 30888

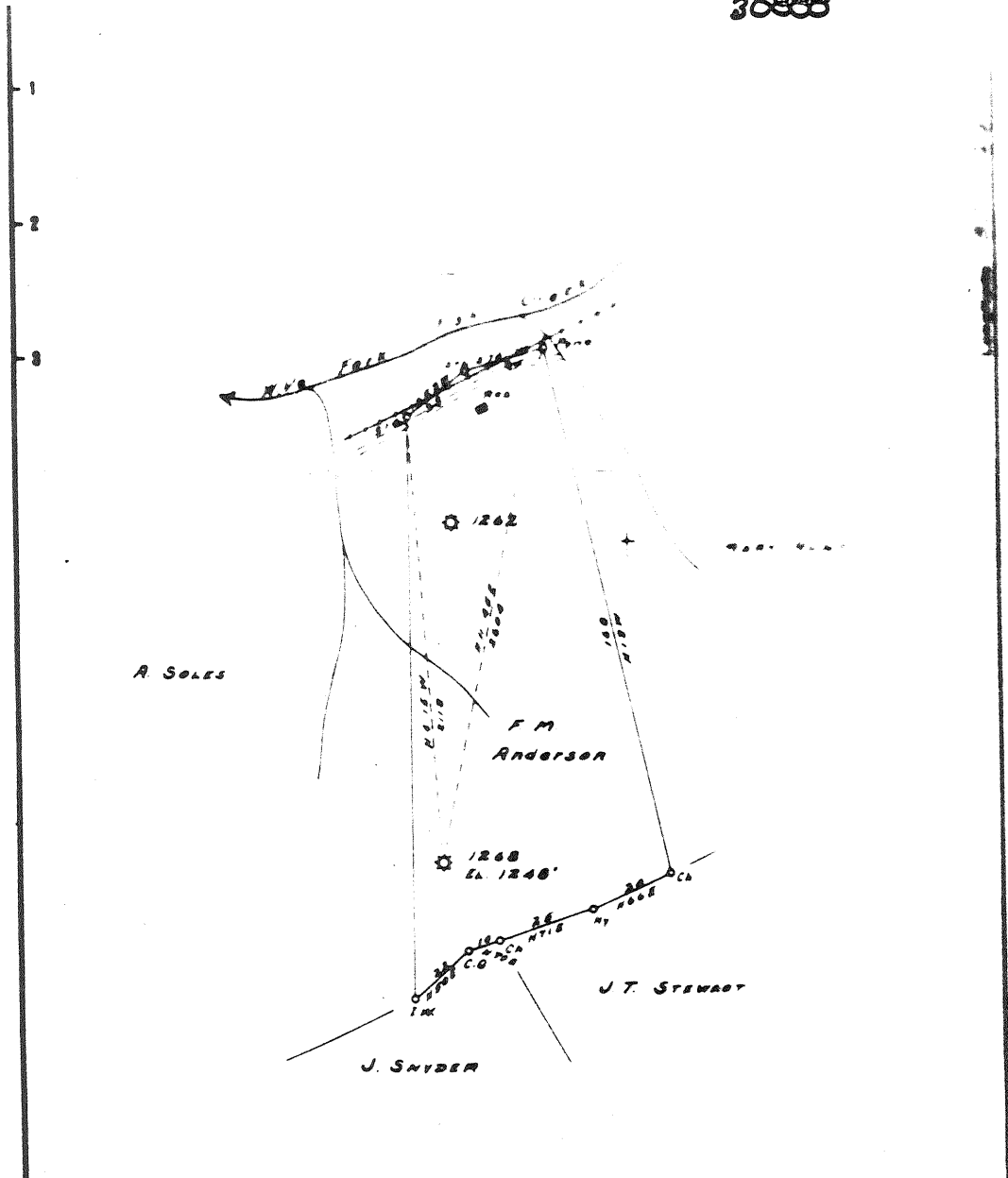

New Location
 Drill Deeper
 Abandonment

Company	<u>CARNegie NATURAL GAS</u>	
Address	<u>PITTSBURGH, PA.</u>	
Farm	<u>F.M. ANDERSON</u>	
Tract	Acres <u>65</u>	Lease No. <u>E 2046-72</u>
Well (Farm) No.	<u>J</u>	Serial No. <u>E 1268</u>
Elevation (Spirit Level)	<u>1240'</u>	

STATE OF WEST VIRGINIA
 DEPARTMENT OF MINES
 OIL AND GAS DIVISION
 CHARLESTON

WELL LOCATION MAP
 FILE NO. WCC-888



1319

STATE OF WEST VIRGINIA
DEPARTMENT OF MINES
OIL AND GAS DIVISION

WELL RECORD

Oil or Gas Well GAS

Permit No. 888-A

WELL TO BE ABANDONED

(KIND)

Company CARNEGIE NATURAL GAS COMPANY
Address 1015 Frick Bldg., PITTSBURGH, PA.
Farm F. M. ANDERSON Acres 60
Location (waters) West Virginia Fork of Fish Creek
Well No. 3-1268 Elev. 1248
District CHURCH County WETZEL
The surface of tract is owned in fee by F. M. ANDERSON
Address HUNDRED, W.VA.
Mineral rights are owned by F. M. ANDERSON
Address HUNDRED, W.VA.
Drilling commenced 10-7-24
Drilling completed 10-29-24
Date Shot From _____ To _____
With _____
Open Flow 6 /10ths Water in _____ 2 Inch
/10ths Merc. in _____ Inch
Volume 116,000 Cu. Ft.
Rock Pressure _____ lbs. _____ hrs.
Oil _____ bbls., 1st 24 hrs.
Fresh water _____ feet _____ feet
Salt water _____ feet _____ feet

Casing and Tubing	Used in Drilling	Left in Well	Packers
Size			Kind of Packer
16			
13			
10			Size of
8 1/4	109	109	
6 5/8	931	931	Depth set
5 3/16			
3			Perf. top
2			Perf. bottom
Liners Used			Perf. top
			Perf. bottom

CASING CEMENTED _____ SIZE _____ No. Ft. _____ Date _____

COAL WAS ENCOUNTERED AT 620 FEET INCHES
842 FEET INCHES 956 FEET INCHES
_____ FEET _____ INCHES _____ FEET _____ INCHES

Formation	Color	Hard or Soft	Top	Bottom	Oil, Gas or Water	Depth Found	Remarks
Waynesburg Coal			620	623			
Mapleton Coal	<i>(concretion)</i>		842	848			
Pittsburgh Coal			956	963	Gas	958	
Murphy Sand			1109	1127	Gas	1112-1114	
Red Rock Cave			1127	1137			
Hurry-Up Sand			1258	1264			
TOTAL DEPTH				1268			

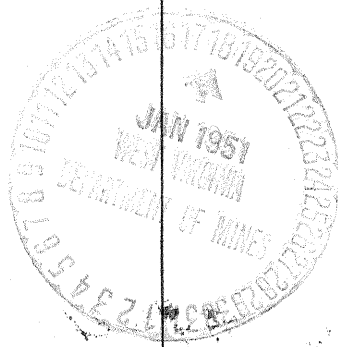

Formation	Color	Hard or Soft	Top	Bottom	Oil, Gas or Water	Depth Found	Remarks

Date JAN. 16, 1951

APPROVED CARNEGIE NATURAL GAS COMPANY, Owner

By B. N. Archer
(Title) Land Agent.

F. M. ANDERSON NO. 3 (1268) WELL.

Wet - ~~7099~~ - A ^{888A}

Church District, Wetzel County, W. Va.
Br Carnegie Natural Gas Co., 1015 Frick Bldg., Pittsburgh, Pa.
Abandoned under permit Wet-.....-A?
On 60 acres, on W. Va. Fork of Fish Creek.
Elevation, 1248' L.
Surface and minerals owned by F. M. Anderson, Hundred, W. Va.
Drilling commenced Oct. 7, 1924; completed Oct. 29, 1924.
Open flow, 6/10ths W. in 2".
Volume, 116,000 cu. ft.
8 1/2" casing, 109'; 6 5/8", 931'; all left in.
Coal was encountered at 620-623, 842-848, and 956-963'.
Gas well. Record to Dept. of Mines dated Jan. 16, 1951.
Record to RCT from Mrs. Griffith Feb. 23, 1951. Old File No. 1319.

	Top.	Bottom.
Waynesburg Coal	620	- 623
Mapletown (Sewickley) Coal	842	- 848
Pittsburgh Coal (gas, 958')	956	- 963
Murphy Sand (gas, 1112-1114')	1109	- 1127
Red rock cave	1127	- 1137
Hurry-up Sand	1258	- 1264
Total depth		1268