

39°32'30"

Latitude

+ .36s  
.88w

80°35'00"

Longitude

**Topo Location**

7.5' Loc. \_\_\_\_\_ 15' Loc. \_\_\_\_\_  
\_\_\_\_\_ (calc.) \_\_\_\_\_

Company Valley Steel Prods

Farm John Mills #9

15' Quad \_\_\_\_\_  
(sec.)

7.5' Quad Big Run

District Grant

**WELL LOCATION PLAT**

County 103 Permit 30938

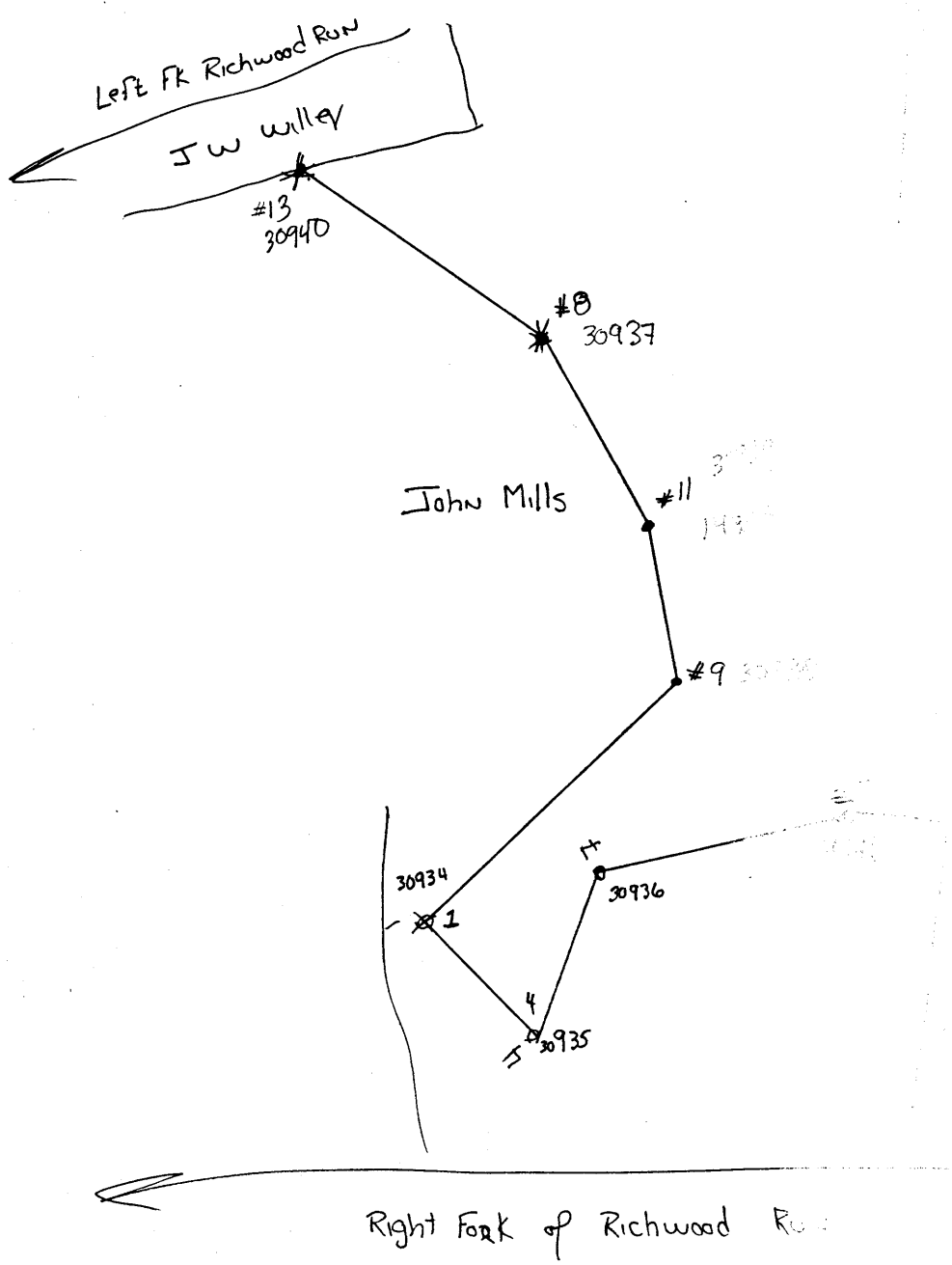



STATE OF WEST VIRGINIA  
DEPARTMENT OF MINES  
OIL AND GAS DIVISION

1365

WELL RECORD

Permit No. 938-A Oil or Gas Well X (KIND)

Company Valley Steel Products Co.  
 Address St. Louis, Mo.  
 Farm John Mills Acres 1488  
 Location (waters) Right & Left Fork Richwood Run Size  
 Well No. 9 Eley 1350  
 District Grant County Wetzel  
 The surface of tract is owned in fee by \_\_\_\_\_  
 Address \_\_\_\_\_  
 Mineral rights are owned by \_\_\_\_\_  
 Address Nov. 5, 1919  
 Drilling commenced \_\_\_\_\_  
 Drilling completed \_\_\_\_\_  
 Date Shot \_\_\_\_\_ From \_\_\_\_\_ To \_\_\_\_\_  
 With \_\_\_\_\_  
 Open Flow \_\_\_\_\_ /10ths Water in \_\_\_\_\_ Inch  
 \_\_\_\_\_ /10ths Merc. in \_\_\_\_\_ Inch  
 Volume \_\_\_\_\_ Cu. Ft.  
 Rock Pressure \_\_\_\_\_ lbs. \_\_\_\_\_ hrs.  
 Oil \_\_\_\_\_ bbls., 1st 24 hrs.  
 Fresh water \_\_\_\_\_ feet \_\_\_\_\_ feet  
 Salt water \_\_\_\_\_ feet \_\_\_\_\_ feet

Casing and Tubing	Used in Drilling	Left in Well	Packers
16			Kind of Packer _____
13			Size of _____
10			Depth set _____
8 1/4	2100	2100	Perf. top _____
6 5/8	2200	2200	Perf. bottom _____
5 3/16	Casing set on hook		Perf. top _____
3	wall packer.		Perf. bottom _____
2			Perf. top _____
Liners Used			Perf. bottom _____

CASING CEMENTED \_\_\_\_\_ SIZE \_\_\_\_\_ No. Ft. \_\_\_\_\_ Date \_\_\_\_\_

COAL WAS ENCOUNTERED AT \_\_\_\_\_ FEET \_\_\_\_\_ INCHES  
 \_\_\_\_\_ FEET \_\_\_\_\_ INCHES FEET \_\_\_\_\_ INCHES  
 \_\_\_\_\_ FEET \_\_\_\_\_ INCHES FEET \_\_\_\_\_ INCHES

Formation	Color	Hard or Soft	Top	Bottom	Oil, Gas or Water	Depth Found	Remarks
<del>Conductor</del>							
Native Coal			585	589			
Pittsburgh Coal			1042	1050			
Cave			1240	1408			
<del>Murphy Sand</del>							
1st Cow Run			1408	1438			
2nd Cow Run			1495	1502			
<del>Sea Sand</del>							
1st Salt Sand			1590	1620			
2nd Salt Sand			1793	1833			
3rd Salt Sand			1908	1935			
Maxon			2097	2107			
Red Rock			2160	2205			
<del>Big Line</del>							
Red Shell & Sand			2205	2225			
<del>Keener Sand</del>							
Dark showing more sand			2225	2230			
<del>Pay sand</del>							
Hard white sand			2230	2242			
Injun Sand							
Fine show of gas			2242	2245			Fine show of gas
<del>Squaw</del>							
Oil and gas			2245	2249			Oil and gas
<del>Berea</del>							
Very hard			2249	2251			
Quit in sand							

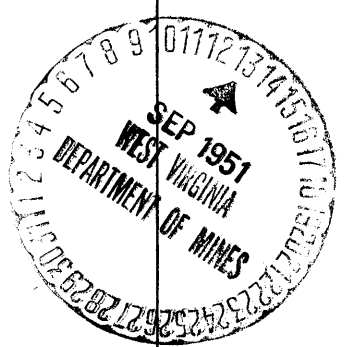

JAN 6 1952