

39° 27' 30"

**Latitude**

155  
1.70w

80° 32' 30"

**Longitude**

**Topo Location**

7.5' Loc. \_\_\_\_\_ 15' Loc. \_\_\_\_\_  
(calc.) \_\_\_\_\_

**Company** Hope Natural Gas Co

**Farm** BA Starkey # 1916

**15' Quad** \_\_\_\_\_  
(sec.)

**7.5' Quad** Folsom

**District** GRANT

**WELL LOCATION PLAT**

**County** 103 **Permit** 30951

30951  
Grant

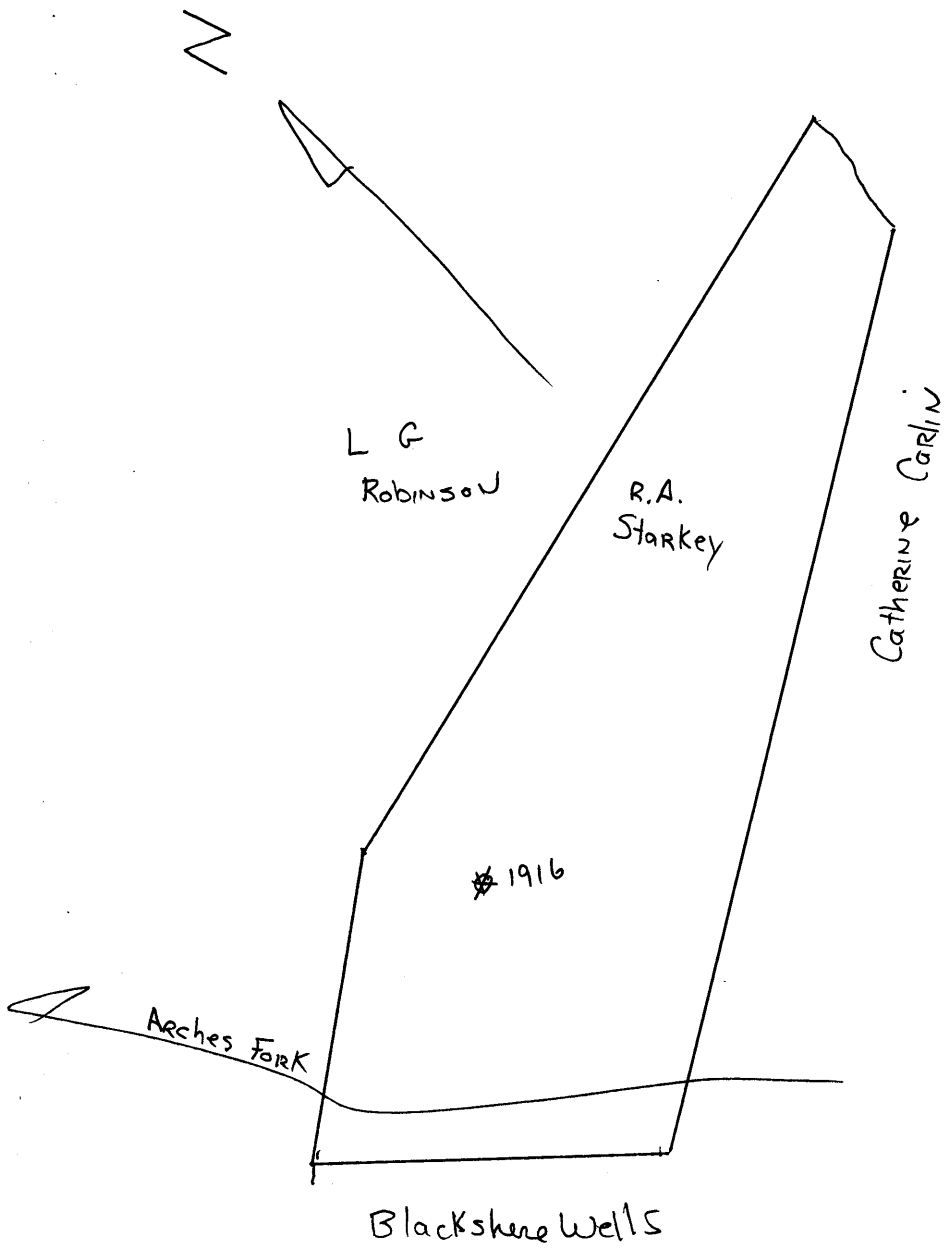



STATE OF WEST VIRGINIA  
DEPARTMENT OF MINES  
OIL AND GAS DIVISION

1368

WELL RECORD

Permit No. 951-A Other Gas Well \_\_\_\_\_ (KIND)

Company Hope Natural Gas Company.  
 Address 445 West Main St. Clarksburg, W. Va.  
 Farm B.A. Starkey Acres 28 1/2  
 Location (waters) \_\_\_\_\_  
 Well No. 1916 Elev. 957  
 District Grant County Wetzel  
 The surface of tract is owned in fee by \_\_\_\_\_  
 Address \_\_\_\_\_  
 Mineral rights are owned by \_\_\_\_\_  
 Address \_\_\_\_\_  
 Drilling commenced Oct. 14, 1910  
 Drilling completed \_\_\_\_\_  
 Date Shot \_\_\_\_\_ From \_\_\_\_\_ To \_\_\_\_\_  
 With \_\_\_\_\_  
 Open Flow \_\_\_\_\_ /10ths Water in \_\_\_\_\_ Inch  
 \_\_\_\_\_ /10ths Merc. in \_\_\_\_\_ Inch  
 Volume \_\_\_\_\_ Cu. Ft.  
 Rock Pressure \_\_\_\_\_ lbs. \_\_\_\_\_ hrs.  
 Oil \_\_\_\_\_ bbls., 1st 24 hrs.  
 Fresh water none recorded feet \_\_\_\_\_ feet  
 Salt water none recorded feet \_\_\_\_\_ feet

Casing and Tubing	Used in Drilling	Left in Well	Packers
Size			Kind of Packer
16			
13			
10		<b>Pulled</b>	Size of
8 1/4		<b>Pulled</b>	
6 5/8	<b>2150</b>	<b>2150</b>	Depth set
5 3/16			
3			Perf. top
2	<b>2975</b>	<b>2975</b>	Perf. bottom
Liners Used			Perf. top
			Perf. bottom

CASING CEMENTED **NOT** SIZE \_\_\_\_\_ No. Ft. \_\_\_\_\_ Date \_\_\_\_\_  
 COAL WAS ENCOUNTERED AT **635** FEET **120 Est** INCHES  
 \_\_\_\_\_ FEET \_\_\_\_\_ INCHES FEET \_\_\_\_\_ INCHES  
 \_\_\_\_\_ FEET \_\_\_\_\_ INCHES FEET \_\_\_\_\_ INCHES

Formation	Color	Hard or Soft	Top	Bottom	Oil, Gas or Water	Depth Found	Remarks
Pittsburgh Coal			635	645 Est.			
Dunkard			1138	1198 Est			
Salt sand			1328	1748 Est			
Big Injun			1972	2117 Est.			
Gorden			2727	2735	gas	2729	
Total depth				2977			

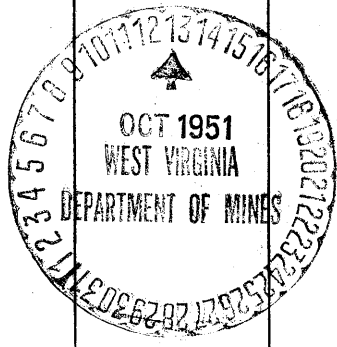

JAN 16 1952

