

39°45'00"

Latitude

80°25'00"

Longitude

+

2.42s  
2.14w

**Topo Location**

7.5' Loc. \_\_\_\_\_ 15' Loc. \_\_\_\_\_  
\_\_\_\_\_ (calc.) \_\_\_\_\_

**Company** HW Bissett et al

**Farm** George Kuhn #2

**15' Quad** \_\_\_\_\_  
**(sec.)**

**7.5' Quad** Hundred

**District** Church

**WELL LOCATION PLAT**

**County** 103 **Permit** 30954

30953  
30954

Church

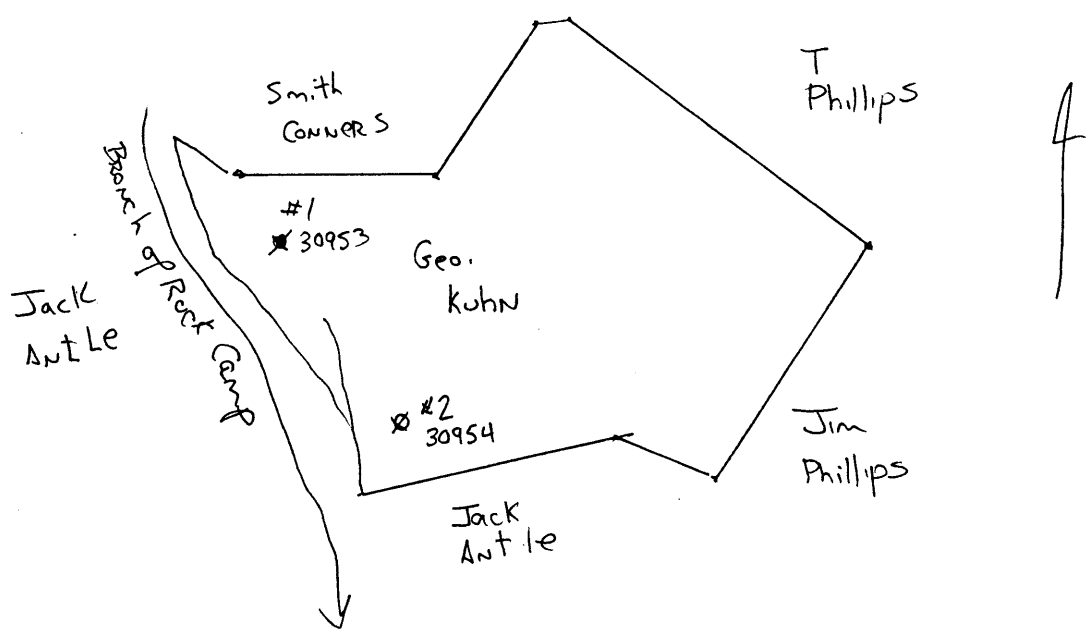



1371

STATE OF WEST VIRGINIA  
DEPARTMENT OF MINES  
OIL AND GAS DIVISION

WELL RECORD

Permit No. 954-A

Oil or Gas Well X (KIND)

Company M. W. Bissett et al  
 Address Deep Valley, Pa.  
 Farm Geo. Kuhn Acres 57  
 Location (waters) \_\_\_\_\_  
 Well No. 2 Elev. 1185  
 District Church County Wetzel  
 The surface of tract is owned in fee by Estella Belch,  
Route No.1 Address Garrison, Pa.  
 Mineral rights are owned by Everett F. Moore  
Moundsville Address W.Va.  
 Drilling commenced No Record  
 Drilling completed " " \_\_\_\_\_  
 Date Shot \_\_\_\_\_ From \_\_\_\_\_ To \_\_\_\_\_  
 With \_\_\_\_\_

Casing and Tubing	Used in Drilling	Left in Well	Packers
Size			
16			Kind of Packer _____
13			
10	154	154	Size of _____
8 1/4	1280	1280	
6 5/8	1470	1470	Depth set _____
5 3/16	2350	2350	
3			Perf. top _____
2			Perf. bottom _____
Liners Used _____			Perf. top _____
			Perf. bottom _____

Open Flow \_\_\_\_\_ /10ths Water in \_\_\_\_\_ Inch  
 \_\_\_\_\_ /10ths Merc. in \_\_\_\_\_ Inch  
 Volume \_\_\_\_\_ Cu. Ft.  
 Rock Pressure \_\_\_\_\_ lbs. \_\_\_\_\_ hrs.  
 Oil \_\_\_\_\_ bbls., 1st 24 hrs.  
 Fresh water \_\_\_\_\_ feet \_\_\_\_\_ feet  
 Salt water \_\_\_\_\_ feet \_\_\_\_\_ feet

CASING CEMENTED \_\_\_\_\_ SIZE \_\_\_\_\_ No. Ft. \_\_\_\_\_ Date \_\_\_\_\_

COAL WAS ENCOUNTERED AT 825 FEET 36 INCHES  
935 FEET 84 INCHES FEET INCHES  
 FEET INCHES FEET INCHES

Formation	Color	Hard or Soft	Top	Bottom	Oil, Gas or Water	Depth Found	Remarks
Mapletown Coal			825	828			
Pittsburgh Coal			935	942			
Murphy Sand			1145	1165			
Big Dunkard Sand			1460	1556			
Gas Sand			1570	1609			
Salt Sand			1835	1877			
Big Lime			2120	2180			
Big Injun			2180	2435			
30 Foot			2800	2835			
50 Foot			2944	2974			
Gordon Sand			2993				
Oil			3004				
Total Depth				3011			



MAY 21 1952