



STATE OF WEST VIRGINIA
DEPARTMENT OF MINES

RECEIVED
FEB 13 1973
OIL & GAS DIVISION
DEPT. OF MINES

Oil and Gas Division

OIL AND GAS WELL PERMIT APPLICATION

TO THE DEPARTMENT OF MINES,
Charleston, W. Va.

DATE October 17, 1972

Surface Owner Earl Campbell

Company Halbert & Prough

Address Mount Zion, West Virginia

Address 317 Bank of Commerce Building, Abaline, Texas

Mineral Owner Earl Campbell

Farm E. J. Campbell Acres 36.25

Address Mount Zion, West Virginia

Location (waters) Little Kanawha River

Coal Owner _____

Well No. 2 Elevation 809

Address _____

District Spring Creek County Wirt

Coal Operator _____

Quadrangle Spencer

Address _____

THIS PERMIT MUST BE POSTED AT THE WELL SITE
All provisions being in accordance with Chapter 22, of the W. Va. Code, the location is hereby approved for Drilling. This permit shall expire if operations have not commenced by 6-13-73.

Inspector to be notified
Mr. Fred Burdette
Box 190
Cyceron Rt. Wirt, W. Va. 25185
PH: 984-9263

Deputy Director - Oil & Gas Division

GENTLEMEN:

The undersigned well operator is entitled to drill upon the above named farm or tract of land for oil and gas, having fee title thereto, (or as the case may be) under grant or lease dated September 8, 1972, by Earl Campbell made to Halbert & Prough and recorded on the _____ day of _____ 19____, in _____ County, Book _____ Page _____

NEW WELL _____ DRILL DEEPER _____ REDRILL _____ FRACTURE OR STIMULATE
_____ OIL AND GAS WELL ORIGINALLY DRILLED BEFORE JUNE 5, 1969.

The enclosed plat was prepared by a registered engineer or licensed land surveyor and all coal owners and/or operators have been notified as of the above date.

The above named coal owners and/or operator are hereby notified that any objection they wish to make, or are required to make by Section 3 of the Code, must be received by, or filed with the Department of Mines within ten (10) days. *

Copies of this notice and the enclosed plat were mailed by registered mail, or delivered to the above named coal operators or coal owners at their above shown respective address _____ day _____ before, or on the same day with the mailing or delivery of this copy to the Department of Mines at Charleston, West Virginia.

Very truly yours,
(Sign Name) A. T. Halbert
Well Operator

Address of Well Operator
317 Bank of Commerce Building Street
Abaline City or Town
Texas State
01/26/2024

*SECTION 3 If no objections are filed or found by the Department of mines, within said period of ten days from the receipt of notice and plat by the department of mines, to said proposed location, the department shall forthwith issue to the well operator a permit reciting the filing of such plat, that no objections have been made by the coal operators or found thereto by the department and that the same is approved and the well operator authorized to proceed.

BOND DRILL

Wv-621 PERMIT NUMBER

THIS IS AN ESTIMATE ONLY
ACTUAL INFORMATION WILL BE SUBMITTED ON OG-10 UPON COMPLETION

PROPOSED WORK ORDER TO X DRILL _____ DEEPEN _____ FRACTURE-STIMULATE _____
 DRILLING CONTRACTOR: (If Known) _____ RESPONSIBLE AGENT: _____
 NAME F.W.A. Drilling Company NAME A. T. Halbert
 ADDRESS Elkview, West Virginia ADDRESS 317 Bank of Commerce, Abaline, Tex
 TELEPHONE 965-5201 TELEPHONE 915-673-4656
 ESTIMATED DEPTH OF COMPLETED WELL: 2300' ROTARY X CABLE TOOLS _____
 PROPOSED GEOLOGICAL FORMATION: Injun Sand
 TYPE OF WELL: OIL _____ GAS _____ COMB. X STORAGE _____ DISPOSAL _____
 RECYCLING _____ WATER FLOOD _____ OTHER _____

TENTATIVE CASING PROGRAM:

CASING AND TUBING SIZE	USED FOR DRILLING	LEFT IN WELL	CEMENT FILL UP OR SACKS - CUBIC FT.
20 - 16			
13 - 10			
9 - 5/8			
8 - 5/8 200'	8 5/8"	200'	100 sacks cement
7			
5 1/2			
4 1/2 2300'	4 1/2"	2300'	100 sacks cement
3			Perf. Top
2			Perf. Bottom
Liners			Perf. Top
			Perf. Bottom

APPROXIMATE FRESH WATER DEPTHS 125 FEET SALT WATER 1100 FEET
 APPROXIMATE COAL DEPTHS _____
 IS COAL BEING MINED IN THE AREA? No BY WHOM? _____

TO DRILL:

SUBMIT FIVE (5) COPIES OF OG - 1, \$100.00 PERMIT FEE, PERFORMANCE BOND AND PERMANENT COPY OF PLAT.

TO DRILL DEEPER OR REDRILL:

SUBMIT FIVE (5) COPIES OF OG - 1, SHOWING ORIGINAL PERMIT NUMBER AND PERFORMANCE BOND. ON WELLS DRILLED PRIOR TO 1929, A PERMANENT COPY OF THE PLAT AND THE ORIGINAL WELL RECORD MUST ALSO BE SUBMITTED.

TO FRACTURE - STIMULATE:

OIL AND/OR GAS WELL ORIGINALLY DRILLED BEFORE JUNE 5, 1929, FIVE (5) COPIES OG - 1, PERFORMANCE BOND, PERMANENT PLAT AND ORIGINAL WELL RECORD.

OIL AND/OR GAS WELL ORIGINALLY DRILLED ON AND/OR AFTER JUNE 5, 1929, FIVE COPIES OG - 1, SHOWING ORIGINAL PERMIT NUMBER, AND PERFORMANCE BOND.

Required forms must be filed within ninety (90) days of completion for bond release. Inspector to be notified twenty-four (24) hours in advance.

The following waiver must be completed by the coal operator if the permit is to be issued within ten days of receipt thereof.

WAIVER: I the undersigned, Agent for _____ Coal Company, Owner or Operator of the coal under this lease have examined and place on our mine maps this proposed well location.

We the _____ Coal Company have no objections to said well being drilled at this location, providing operator has complied with all rules and regulations in Articles 4, 5, and 7, Chapter 22 of the West Virginia Code.

 For Coal Company

 Official Title

01/26/2024

A10

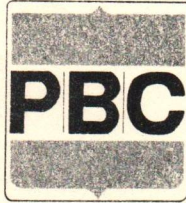

RECEIVED

OCT 28 1975

OIL & GAS DIVISION
DEPT. OF MINES

PATTERSON, BELL & CRANE COMPANY

October 23, 1975

Mr. Robert L. Dodd, Director
Oil & Gas Division, Department of Mines
1204 Kanawha Boulevard, East
Charleston, West Virginia

RE: INTERSTATE DRILLING, INC.

Dear Mr. Dodd:

Permission is granted to add to Interstate Drilling, Inc., blanket bond the following wells which were originally under the name of Halbert & Prough.

<u>PERMIT NO.</u>	<u>WELL NAME</u>	<u>COUNTY</u>	<u>DISTRICT</u>
CAL-2509	Mary Davis	Calhoun	Sheridan
GIL-2263	W. H. Simmons #2	Gilmer	Troy
GIL-2264	W. H. Simmons #3	Gilmer	Troy
GIL-2265	Gut Simmons	Gilmer	Troy
GIL-2272	W. H. Simmons #4	Gilmer	Troy
GIL-2274	Bennett Heirs #1	Gilmer	Troy
GIL-2275	Bennett Heirs #2	Gilmer	Troy
GIL-2277	Dora Heckert #1	Gilmer	Troy
GIL-2279	Simmons-West #1	Gilmer	Troy
GIL-2314	Newlon-Goff	Gilmer	Troy
LEW-1885	Russell Woofter #1	Lewis	Freemans Creek
LEW-1886	Russell Woofter #2	Lewis	Freemans Creek
LEW-1887	Russell Woofter # H&P1	Lewis	Freemans Creek
LEW-1888	Russell Woofter #1B	Lewis	Freemans Creek
LEW-1890	Dale W. Groves #1	Lewis	Freemans Creek
LEW-1956	Dale W. Groves #2	Lewis	Freemans Creek
LEW-1962	Russell Woofter #3	Lewis	Freemans Creek
WIR-604	E. J. Campbell No. 1	Wirt	Spring Creek
WIR-621	E. J. Campbell No. 2	Wirt	Spring Creek
WIR-630	Warren Campbell No. 1	Wirt	Spring Creek
WIR-636	Jewel Boyce No. 1	Wirt	Burnings Springs
WIR-638	Campbell-DePue 1A	Wirt	Burnings Springs
WIR-639	Gordon Cooper No. 3	Wirt	Spring Creek

Very truly yours
UNITED STATES FIDELITY & GUARANTY COMPANY

E. D. Ziegler
Attorney-in-Fact

EDZ:rc

01/26/2024

A-11



State of West Virginia

Department of Mines
Oil and Gas Division

Charleston 25305

November 19, 1975

E & B Insurance Agency
212 Court Street
Spencer, W.Va. 25276

Attn: Richard H. Brumbaugh

In Re: Halbert & Prough
Single Bonds

Dear Mr. Brumbaugh:

Enclosed are the following single bonds for Halbert & Prough, 317 Bank of Commerce Building, Abilene, Texas 79604. All of these wells have been transferred to: Interstate Drilling, Inc., 1527 Skyline Road, Charleston, W.Va.

- Bond # 621065 dated 8-13-73 (CAL-2509 - Mary Davis # 1)
- Bond # 618384 dated 10-17-72 (GIL-2263 - W.H. Simmons # 2)
- Bond # 618383 dated 10-17-72 (GIL-2264 - W. H. Simmons # 3)
- Bond # 618387 dated 10-27-72 (GIL-2265 - Guy Simmons # 1)
- Bond # 618389 dated 11-3-72 (GIL-2272 - W. H. Simmons # 4)
- Bond # 618390 dated 11-13-72 (GIL-2274 - Bennett Hrs. # 1)
- Bond # 618391 dated 11-13-72 (GIL-2275 - Bennett Hrs. # 2)
- Bond # 618392 dated 11-20-72 (GIL-2277) - Dora Heckert # 1)
- Bond # 618397 dated 12-4-72 (GIL-2279 - Simmons-West # 1)
- Bond # 618398 dated 12-4-72 (LEW-1885 - Russell Woofter # 1)
- Bond # 618403 dated 12-29-72 (LEW-1886 - Russell Woofter # 2)
- Bond # 618404 dated 1-5-73 (LEW-1887 - Russell Woofter - H & P # 1)
- Bond # 618406 dated 1-17-73 (LEW-1888 - H & P # 1-B)
- Bond # 618409 dated 1-26-73 (LEW-1890 - Dale W. Groves # 1)
- Bond # 634382 dated 4-5-74 (Dale W. Groves # 2) LEW-1956
- Bond # 634388 dated 5-30-74 (LEW-1962 - Russell Woofter # 3)
- Bond # 618382 dated 10-6-72 (WIRT-604 - J. E. Campbell # 1)
- Bond # 618385 dated 10-17-72 (WIRT-621 - E. J. Campbell # 2)
- Bond # 618439 dated 5-24-73 (WIRT-630 - Warren Campbell # 1)
- Bond # 612063 dated 7-31-73 (WIRT-639 - Campbell-DePue-Woodring # 1)

The following bonds have been released:

- Bond # 618425 dated 3-30-73 (GIL-2314 - Newlon & Goff # 1) Released-8-6-75
- Bond # 621057 dated 7-13-73 (WIRT-636 - Jewel Boyce # 1) Released - 11-4-75
- Bond # 621061 dated 7-26-73 (WIRT-638 - Campell - DePue # 1) Released -11-4-75

Very truly yours
Robert L. Dodd
Robert L. Dodd

01/26/2024



RECEIVED

APR 11 1974

STATE OF WEST VIRGINIA
DEPARTMENT OF MINES
Oil and Gas Division

OIL & GAS DIVISION
DEPT. OF MINES

WELL RECORD

Rotary Oil _____
Cable _____ Gas _____
Recycling _____ Comb.
Water Flood _____ Storage _____
Disposal _____ (Kind)

Quadrangle Spencer

Permit No. Wir-621

Company <u>Halbert & Prough</u>	Casing and Tubing	Used in Drilling	Left in Well	Cement fill up Cu. ft. (Sks.)
Address <u>Abilene, Texas</u>				
Farm <u>J. E. Campbell</u> Acres <u>36.25</u>				
Location (waters) <u>Island Run - Little Kanawha River</u>				
Well No. <u>Two (2)</u> Elev. <u>818 KB</u>	Size			
District <u>Spring Creek</u> County <u>Wirt</u>	20-16			
The surface of tract is owned in fee by <u>J. E. Campbell</u>	Cond.			
Address <u>Mt. Zion, W. Va.</u>	13-10"			
Mineral rights are owned by <u>Earl Campbell</u>	9 5/8			
Address <u>Mt. Zion, W. Va.</u>	8 5/8	203	203	to surface
Drilling Commenced <u>2/12/73</u>	7			
Drilling Completed <u>2/15/73</u>	5 1/2			
Initial open flow <u>None taken</u> ft. _____ bbls.	4 1/2	1750'	1750'	130 sx.
Final production <u>200 m</u> cu. ft. per day <u>2</u> bbls.	3			
Well open <u>24</u> hrs. before test <u>750</u> RP.	2			
Well treatment details:	Liners Used			

Attach copy of cementing record.

Well perforated 1722' to 1766' 10 holes
Sand fracture 30,000 lb 10/40 sand 550 bbl. water 600 Gal 15% Reg. acid

Coal was encountered at None Feet _____ Inches
Fresh water _____ Feet _____ Salt Water _____ Feet _____
Producing Sand Big Injun Depth _____

Formation	Color	Hard or Soft	Top Feet	Bottom Feet	Oil, Gas or Water	* Remarks
Soil			0	10		
Shale & Sand & Red Rock			10	918		
Sand			918	944		
Shale - Sandy			944	1014		
Sand			1014	1198		
Shale			1198	1410		
Sand			1410	1540		
Shale			1540	1564		
Little Lime - Pencil Cave			1564	1607		
Big Lime			1607	1722		
Big Injun			1722	1766		
Shale			1766	1838		
				1838 TOTAL DEPTH		

01/26/2024

(over)

* Indicates Electric Log tops in the remarks section.

Formation	Color	Hard or Soft	Top Feet	Bottom Feet	Oil, Gas or Water	* Remarks

01/26/2024

Date April 10, 1974

APPROVED Halbert & Pray, Owner

By H. V. Jassell, apt.
(Title)

STATE OF WEST VIRGINIA
DEPARTMENT OF MINES
OIL AND GAS WELLS DIVISION

RECEIVED

FEB 21 1973

OIL & GAS DIVISION
DEPT. OF MINES

INSPECTOR'S WELL REPORT

Permit No. WIRT-621

Oil or Gas Well Gas
(KIND)

Company <u>Halbert & Prough</u>	CASING AND TUBING	USED IN DRILLING	LEFT IN WELL	PACKERS
Address <u>317 Bank of Commerce, Abaline, Texas</u>	Size			
Farm <u>E. J. Campbell</u>	16			Kind of Packer
Well No. <u>2</u>	13			
District <u>Spring Creek</u> County <u>Wirt</u>	10			Size of
Drilling commenced <u>2/12/73</u>	8 7/8 <u>8 5/8</u> 206			Depth set
Drilling completed _____ Total depth _____	6 5/8			
Date shot _____ Depth of shot _____	5 3/16			Perf. top
Initial open flow _____ /10ths Water in _____ Inch	3			Perf. bottom
Open flow after tubing _____ /10ths Merc. in _____ Inch	2			Perf. top
Volume _____ Cu. Ft.	Liners Used			Perf. bottom
Rock pressure _____ lbs. _____ hrs.	CASING CEMENTED _____ SIZE _____ No. FT. _____ Date _____			
Oil _____ bbls., 1st 24 hrs.	NAME OF SERVICE COMPANY			
Fresh water _____ feet _____ feet	COAL WAS ENCOUNTERED AT _____ FEET _____ INCHES			
Salt water _____ feet _____ feet	_____ FEET _____ INCHES _____ FEET _____ INCHES			
	_____ FEET _____ INCHES _____ FEET _____ INCHES			

Drillers' Names _____

Remarks:

Drilling at 1140 ft. F W A Rotary drilling Contractor.
8 5/8 ft. of 206 pipe cemented to surface.

2/15/73
DATE

Fred Burdette
DISTRICT WELLS INSPECTOR
01/26/2024

STATE OF WEST VIRGINIA
 DEPARTMENT OF MINES
 OIL AND GAS WELLS DIVISION
INSPECTOR'S PLUGGING REPORT

Permit No. _____ Well No. _____

COMPANY _____ ADDRESS _____

FARM _____ DISTRICT _____ COUNTY _____

Filling Material Used _____

Liner	Location	Amount	Packer	Location	
PLUGS USED AND DEPTH PLACED			BRIDGES	CASING AND TUBING	
CEMENT-THICKNESS	WOOD-SIZE	LEAD	CONSTRUCTION-LOCATION	RECOVERED	SIZE LOST

Drillers' Names _____

Remarks: _____

_____ I hereby certify I visited the above well on this date.
DATE

STATE OF WEST VIRGINIA
DEPARTMENT OF MINES
OIL AND GAS WELLS DIVISION

RECEIVED
OCT 27 1982
OIL AND GAS DIVISION
WEST VIRGINIA DEPARTMENT OF MINES

INSPECTOR'S WELL REPORT

Permit No. 105-621

Oil or Gas Well
(KIND)

Company Inheritate
~~HATBERT + PROUGH~~

Address _____

Farm E. J. CAMPBELL

Well No. 2

District SPRING CREEK County WIRT

Drilling commenced _____

Drilling completed _____ Total depth _____

Date shot _____ Depth of shot _____

Initial open flow _____ /10ths Water in _____ Inch

Open flow after tubing _____ /10ths Merc. in _____ Inch

Volume _____ Cu. Ft.

Rock pressure _____ lbs. _____ hrs.

Oil _____ bbls., 1st 24 hrs.

Fresh water _____ feet _____ feet

Salt water _____ feet _____ feet

CASING AND TUBING	USED IN DRILLING	LEFT IN WELL	PACKERS
Size			
16			Kind of Packer _____
13			
10			Size of _____
8 1/4			
6 3/8			Depth set _____
5 3/16			
3			Perf. top _____
2			Perf. bottom _____
Liners Used			Perf. top _____
			Perf. bottom _____

CASING CEMENTED _____ SIZE _____ No. FT. _____ Date _____

NAME OF SERVICE COMPANY _____

COAL WAS ENCOUNTERED AT _____ FEET _____ INCHES

_____ FEET _____ INCHES _____ FEET _____ INCHES

_____ FEET _____ INCHES _____ FEET _____ INCHES

Drillers' Names _____

Remarks: _____

O. K. TO RELEASE

10-22-82

DATE

10/20/82 01/26/2024

DISTRICT WELL INSPECTOR

STATE OF WEST VIRGINIA
DEPARTMENT OF MINES
OIL AND GAS WELLS DIVISION
INSPECTOR'S PLUGGING REPORT

Permit No. _____ Well No. _____

COMPANY _____ ADDRESS _____

FARM _____ DISTRICT _____ COUNTY _____

Filling Material Used _____

Liner			Location	Amount	Packer	Location		
PLUGS USED AND DEPTH PLACED			BRIDGES			CASING AND TUBING		
CEMENT-THICKNESS	WOOD-SIZE	LEAD	CONSTRUCTION-LOCATION			RECOVERED	SIZE	LOST

Drillers' Names _____

Remarks: _____

_____ I hereby certify I visited the above well on this date.

DATE

01/26/2024

DISTRICT WELL INSPECTOR



State of West Virginia

Department of Mines
Oil and Gas Division

Charleston 25305

THEODORE M. STREIT
ADMINISTRATOR

WALTER N. MILLER
DIRECTOR

November 19, 1982

Interstate Drilling, Inc.
Route 2, Box 213
Weston, W. Va. 26452

IN RE: PERMIT NO. 47-105-621
FARM E. J. Campbell
WELL NO. 2
DISTRICT Spring Creek
COUNTY Wirt

Gentlemen:

The final inspection report for the above described well has been received in this office. Only the column checked below applies.

The well designated by the above permit number has been released under your Blanket Bond.

Please return the enclosed cancelled single bond which covered the well designated by the above permit number to the surety company who executed said bond in your behalf, in order that they may give you credit on your records.

XXXXX Your well record was received and reclamation requirements approved. In accordance with Chapter 22, Article 4, Section 2, the above captioned well will remain under bond coverage for life of the well.

Very truly yours,

Theodore M. Streit

MS:rl

1.0 API well number: (If not available, leave blank. 14 digits.)	<u>47-105-621</u>			
2.0 Type of determination being sought: (Use the codes found on the front of this form.)	<u>108</u> Section of NGPA	_____ Category Code		
3.0 Depth of the deepest completion location: (Only needed if sections 103 or 107 in 2.0 above.)	_____ feet			
4.0 Name, address and code number of applicant: (35 letters per line maximum. If code number not available, leave blank.)	<u>Interstate Drilling INC</u> Name <u>500 COMM ST.</u> Street <u>Charleston WV 25301</u> City State Zip Code		<u>007917</u> Seller Code	
5.0 Location of this well: [Complete (a) or (b).] (a) For onshore wells (35 letters maximum for field name.)	<u>CRESTON</u> Field Name <u>WIRT</u> County		<u>WV</u> State	
(b) For OCS wells:	Area Name _____ Block Number _____ Date of Lease: _____ Mo. Day Yr. OCS Lease Number _____			
(c) Name and identification number of this well: (35 letters and digits maximum.)	<u>Campbell 2 47-105-621</u>			
(d) If code 4 or 5 in 2.0 above, name of the reservoir: (35 letters maximum.)	_____			
6.0 (a) Name and code number of the purchaser: (35 letters and digits maximum. If code number not available, leave blank.)	<u>Columbia Gas Trans Co</u> Name		<u>004030</u> Buyer Code	
(b) Date of the contract:	<u>5 21 74</u> Mo. Day Yr.			
(c) Estimated annual production:	<u>6.823</u> MMcf.			
7.0 Contract price: (As of filing date. Complete to 3 decimal places.)	(a) Base Price (\$/MMBTU) <u>2.264</u> 2.243	(b) Tax <u>0.210</u>	(c) All Other Prices [Indicate (+) or (-).] _____	(d) Total of (a), (b) and (c) <u>2474</u> 2453
8.0 Maximum lawful rate: (As of filing date. Complete to 3 decimal places.)	<u>2264</u> 2.243	<u>0.210</u>	_____	<u>2474</u> 2453
9.0 Person responsible for this application:	<u>H.V. JARRELL</u> Name <u>See Trans</u> Title <u>H.V. Jarrell</u> Signature <u>2-5-79</u> Date Application is Completed <u>343-0179</u> Phone Number			
Agency Use Only Date Received by Juris. Agency _____ Date Received by FERC _____				

WELL NUMBER: INTERSTATE DRILLING INC. 023090
 FIRST PURCHASER: COLUMBIA GAS TRANSMISSION Corp. 004030
 OTHER: _____

*Quarrier on Section 108, struffer well
 P. [Signature]*

W. Va. Department of Mines, Oil & Gas Division
 WELL DETERMINATION FILE NUMBER
790216-108-105-0621
 Use Above File Number on all Communications
 Relating to Determination of this Well

CHECK EACH ITEM AS COMPLETE OR NOTE WHAT IS MISSING

- ITEM NO. _____
- 1 FERC-121 Items not completed - Line No. _____
 - 2 IV-1 - Agent H.V. JARRELL
 - 3 IV-2 - Well Permit
 - 4 IV-5 - Well Plat
 - 5 IV-35 - Well Record Drilling Recapping _____
 - 6 IV-36 - Gas-Oil Tests. Gas Only 18.7 Was Oil Producing at .18 Ratio _____
 - 7 IV-39 - Annual Production 12 ^{mo.} ~~years~~
 - 8 IV-40 - 90 Day Production 92 Days off line: _____
 - 9 IV-48 - Application for Certification. Complete?
 - 10 - 17 IV Form #51 - 52 - 53 - 54 - 55 - 56 - 57 - 58. Complete Affidavit Signed
 - 18 - 28 Other: Survey _____ Logs _____ Geological Charts _____ Structure Map _____
 1:4000 Map _____ Well Valuations _____ Gas Analyses _____
 - (5) Date Commenced: 2-12-73
2-15-73 drilled Recapped _____
Frac Date:
 - (5) Production Depth: 1722-1766
 - (5) Production Formation: Big Injun
 - (5) Final Open Flow:
Initial Production: 200 MCF
 - (5) Final Rock Pressure:
750#
 - (6) Other Gas Test: _____
 - (7) Avg. Daily Gas from Annual Production: Gas- $\frac{(6823)}{365} = 18.7 \text{ mcf}$ Oil- $\frac{(56)}{29} = 1.9 \text{ bbls.}$
 - (8) Avg. Daily Gas from 90-day cont. w/1-120 days $\frac{(1454)}{92} = 15.8 \text{ mcf}$ Oil- $.2 \text{ bbls.}$
 - (8) Line Pressure: 32 - 35# PSIG from Daily Report
 - (5) Oil Production: From Completion Report _____
 - (17) Does lease inventory indicate extended recovery being done: no
 - (17) Is affidavit signed? Notarized?

01/26/2024

Official well record with the Department contains the submitted information: yes
 Additional information: _____ Does computer program contain: _____

SR Am

STATE OF WEST VIRGINIA
DEPARTMENT OF MINES, OIL AND GAS DIVISION

Date 2-6 1978
Operator's Well No. 18
API Well No. 47 - 105 - 620
State County Permit

WELL CLASSIFICATION FORM
STRIPPER GAS WELL
NGPA Section 108

WELL OPERATOR Interstate Drilling
ADDRESS 500 Commerce Sq
CHARLESTON WVA 25301
GAS PURCHASER Col Gas Trans Co.
ADDRESS 1700 MacCorkle Av. SE
CHARLESTON, WVA.

DESIGNATED AGENT H.V. JARRELL
ADDRESS 1527 Skyline Road
CHARLESTON WVA 25301
LOCATION: Elevation 818
Watershed Little Kanawha River
Dist. S.C. County Wirt Quad SPENCE
Gas Purchase Contract No. 020336
Meter Chart Code 616376-1-1
Date of Contract 5-21-74

* * * * *

Provide a complete inventory of the lease and production equipment used for the well for the previous 24 months or, if less than 24 months, the period the well has been in production. Include a complete list of equipment or processes used in connection with recognized enhanced recovery techniques during completion or production. (Attach separate sheets, if necessary.)

@CHRISTMAS TREE
Separator
pumping unit
7-100 bbl tanks

List all records reasonably available to you which contain information relevant to a determination of eligibility (including production records, B&O Tax Records and royalty payment records) and indicate the location of such records:

Complete Well Records available at
Interstate Drilling Inc
500 Commerce Square
CHARLESTON, WVA 25301

Describe the search made of any records listed above:

Records used to answer all questions asked
By Qualification Forms.

Are you aware of any other information which would tend to be inconsistent with the information specified above? Yes No . If yes, indicate the type and source of the information.

AFFIDAVIT

I, H. V. Jarrell, having been first sworn according to law, state that I have caused to be made a diligent search of those records hereinbefore indicated in the manner herein described, that the information contained in this document is true and accurate and that on the basis of the records and examinations hereinbefore described, and to the best of my information, knowledge and belief, the well for which this certification is sought qualifies as a stripper well.

H. V. Jarrell

STATE OF WEST VIRGINIA,

COUNTY OF Kanawha, TO WIT:

I, June D. Holbrook, a Notary Public in and for the state and county aforesaid, do certify that H. V. Jarrell, whose name is signed to the writing above, bearing date the 6th day of February, 1979, has acknowledged the same before me, in my county aforesaid.

Given under my hand and official seal this 6th day of February, 1979.

My term of office expires on the 13th day of January, 1987.

June D. Holbrook
Notary Public

[NOTARIAL SEAL]

01/26/2024

DEPARTMENT - MINES
DIVISION - OIL AND GAS

47-105-621

FARM 1 E. J. Campbell #2

ANNUAL REPORT OF MONTHLY PRODUCTION-1978
GAS VOLUMES IN MFC @ 14.73
OIL IN BARRELS @ 60 DEGREES
OPERATOR *Whitcomb, Billing, etc* ID # 18

REPORT NO. CCA101P1 PG 00002
CURRENT DATE - 12/19/78
REPORT DATE - 12/19/78

GAS MFC	COUNTY, <i>Wit</i>							AVG. FLOW PRESSURE							SHUT-IN PRESSURE							TOTAL
	J-0	F-0	M-0	A-0	M-0	J-0	J-0	J-0	J-0	A-0	S-0	0-0	N-0	D-0	56.39	OIL	GAS					
704	559	620	420	823	636	606	458	35	543	612	341	501	682	56.39	29	56.39	682					
OIL BBL	J-0	F-0	M-0	A-0	M-0	J-0	J-0	J-0	A-0	S-0	0-0	N-0	D-0	56.39	OIL	GAS	TOTAL					
DAYS ONLINE	29	30	31	30	31	27	30	30	30	31	31	28	35	29								

01/26/2024

FEB 4 1978

2/13/73 CEM

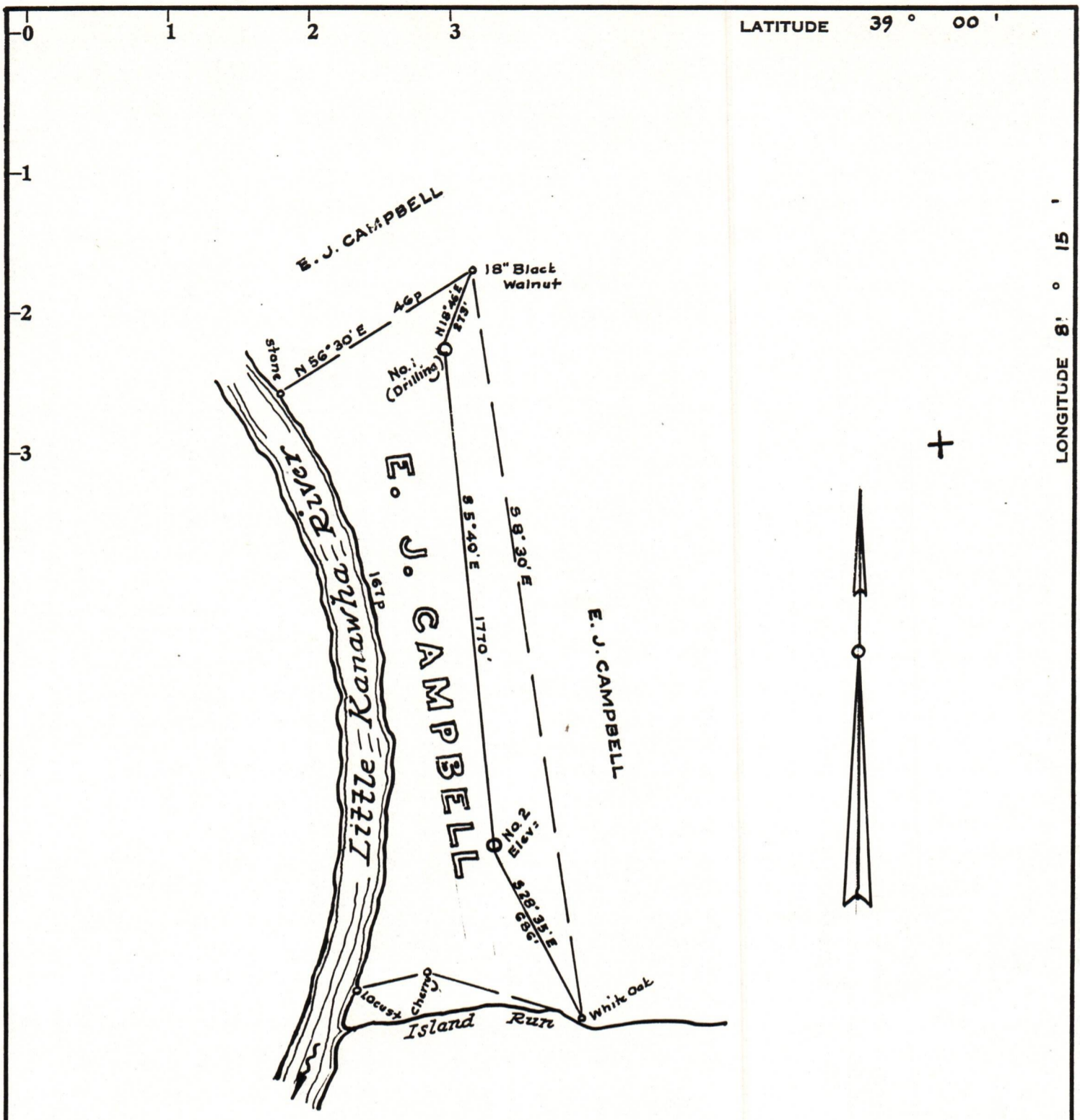

Minimum Error of Closure 1 in 200'

Source of Elevation U.S.G.S. B.M. at Creston = 701'

- Fracture.....
- New Location.....
- Drill Deeper.....
- Abandonment.....

I, the undersigned, hereby certify that this map is correct to the best of my knowledge and belief and shows all the information required by paragraph 6 of the rules and regulations of the oil and gas section of the mining laws of West Virginia.

Signed: [Signature]
Squares: N S E W

Map No.

Company HALBERT AND PROUGH
 Address 317 Bank of Commerce Bldg., Abilene, Texas
 Farm E. J. Campbell
 Tract _____ Acres 36.25 Lease No. _____
 Well (Farm) No. Two Serial No. _____
 Elevation (Spirit Level) 809'
 Quadrangle Spencer
 County Wirt District Spring Creek
 Engineer [Signature]
 Engineer's Registration No. 1227
 File No. _____ Drawing No. _____
 Date October 12, 1972 Scale 1" = 30p = 495'

STATE OF WEST VIRGINIA
DEPARTMENT OF MINES
OIL AND GAS DIVISION
CHARLESTON

WELL LOCATION MAP

FILE NO. Wirt-02 01/26/2024

+ Denotes location of well on United States Topographic Maps, scale 1 to 62,500, latitude and longitude lines being represented by border lines as shown.
- Denotes one inch spaces on border line of original tracing.

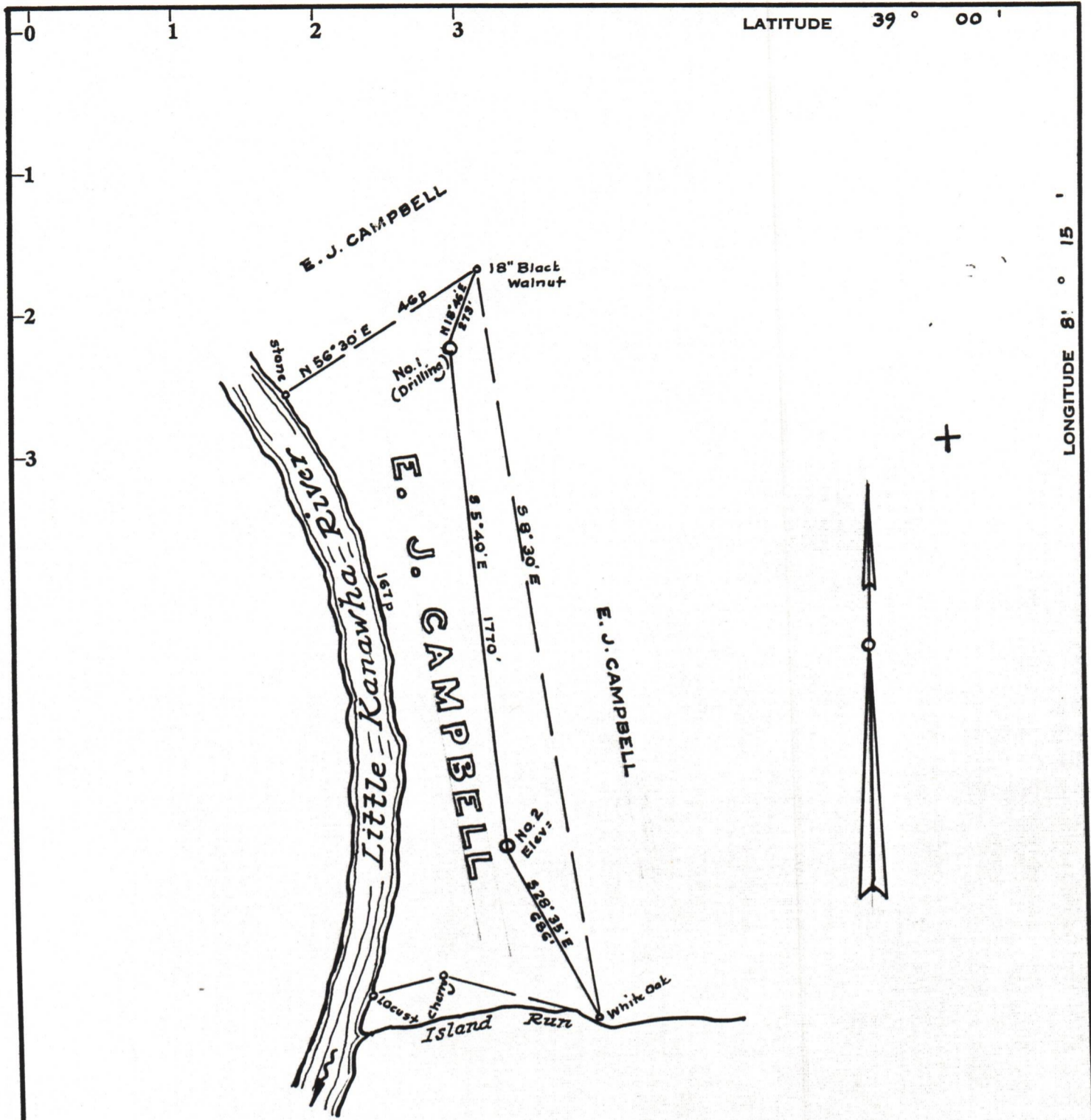

Minimum Error of Closure 1 in 200'

Source of Elevation U.S.G.S.B.M.at Creston = 701'

I, the undersigned, hereby certify that this map is correct to the best of my knowledge and belief and shows all the information required by paragraph 6 of the rules and regulations of the oil and gas section of the mining laws of West Virginia.

- Fracture.....
- New Location.....
- Drill Deeper.....
- Abandonment.....

Signed: [Signature]
Squares: N S E W

Map No. _____

Company **HALBERT AND PROUGH**
 Address 317 Bank of Commerce Bldg., Abilene, Texas
 Farm E. J. Campbell
 Tract _____ Acres 36.25 Lease No. _____
 Well (Farm) No. Two Serial No. _____
 Elevation (Spirit Level) 809'
 Quadrangle Spencer
 County Wirt District Spring Creek
 Engineer [Signature]
 Engineer's Registration No. 1227
 File No. _____ Drawing No. _____
 Date October 12, 1972 Scale 1" = 30 p = 495'

STATE OF WEST VIRGINIA
DEPARTMENT OF MINES
OIL AND GAS DIVISION
CHARLESTON

WELL LOCATION MAP

FILE NO. Wir-621

01/26/2024

+ Denotes location of well on United States Topographic Maps, scale 1 to 62,500, latitude and longitude lines being represented by border lines as shown.

- Denotes one inch spaces on border line of original tracing.