

B-2

STATE OF WEST VIRGINIA
DEPARTMENT OF MINES
OIL AND GAS WELLS DIVISION

RECEIVED

MAY 10 1973

OIL & GAS DIVISION
DEPT. OF MINES

INSPECTOR'S WELL REPORT

Permit No. WIR-627

Oil or Gas Well GAS
(KIND)

Company <u>ALVIN G. ROWES</u> <u>ROUTE 405</u>	CASING AND TUBING	USED IN DRILLING	LEFT IN WELL	PACKERS
	Address <u>414 MADISON AVE, N.Y., N.Y.</u>	Size		
Farm <u>P.L. DEPUE</u>	16			
Well No. <u>4</u>	13			Size of
District <u>SPRING CREEK</u> County <u>WIRT</u>	10			
Drilling commenced <u>5-2-73</u>	8 1/4 <u>CEM</u>	<u>204</u>	<u>204</u>	Depth set
Drilling completed <u>5-4-73</u> ^{LOG 1941} Total depth <u>1990</u>	6 5/8			
Date shot <u>5-8-73</u> ^{DATE} Depth of shot <u>1919</u> ^{DATE}	5 3/16			
Initial open flow _____/10ths Water in _____ Inch	3 <u>4 1/2"</u>		<u>1919</u>	Perf. top
Open flow after tubing _____/10ths Merc. in _____ Inch	2			Perf. bottom
Volume _____ Cu. Ft.	Liners Used			Perf. top
Rock pressure _____ lbs. _____ hrs.				Perf. bottom
Oil _____ bbls., 1st 24 hrs.	<u>75 SPS - 8 7/8" - 204 - 5-3-73</u> <u>100 SPS. 4 1/2" SIZE 1919 No. FT. 5573 Date</u>			
Fresh water <u>NONE</u> feet _____ feet	NAME OF SERVICE COMPANY <u>HOWELL</u>			
Salt water <u>1200</u> ^{ROAD AMT.} feet _____ feet	COAL WAS ENCOUNTERED AT <u>NONE</u> FEET _____ INCHES			
	_____ FEET _____ INCHES _____ FEET _____ INCHES			
	_____ FEET _____ INCHES _____ FEET _____ INCHES			

Drillers' Names L. MORRIS - J. HADDOX - B. MENDON

G.L. HAUGHTY - SCOF - 1907 - A.I.M.

Remarks: WELL FRACTURED 5-8-73 - HOWELL

5-8-73

DATE

R. C. Holliday

DISTRICT WELL INSPECTOR

01/26/2024

STATE OF WEST VIRGINIA
DEPARTMENT OF MINES
OIL AND GAS WELLS DIVISION

INSPECTOR'S PLUGGING REPORT

Permit No. _____ Well No. _____

COMPANY _____ ADDRESS _____

FARM _____ DISTRICT _____ COUNTY _____

Filling Material Used _____

Liner	Location	Amount	Packer	Location		
PLUGS USED AND DEPTH PLACED			BRIDGES	CASING AND TUBING		
CEMENT-THICKNESS	WOOD-SIZE	LEAD	CONSTRUCTION-LOCATION	RECOVERED	SIZE	LOST

Drillers' Names _____

Remarks: _____

_____ I hereby certify I visited the above well on this date.

DATE

06-11-A
1-73

DATE ISSUED 4-19-73 COMMENCED 5-2-73 COMPLETED 5-4-73
 QUAD SPENCE, NE DIST. SANDS, CREEK ELEV. 700 PERMIT 617
 FARM P. L. UERVE LOCATION LAKEVIEW WELL #
 OPERATOR RENZ'S PUMPS AGENT DALLAS P. BALL
 ADDRESS 5127 E 409 ADDRESS PHSDS, W. VA 26101
 TEL. NO. NOT GIVEN TEL. NO. 428-8551
 CONTRACTOR MAUNT DRG. CO. DRILLER B. BENDAL
 EST. DEPTH 2500' FORMATION SHY TYPE RIG ROT

CASING			CEMENT		WATER		COAL	
TEN.	ACT.	SIZE	TEN.	ACT.	EXP.	ACT.	EXP.	ACT.
<u>200</u>	<u>204</u>	<u>4 1/2</u>	<u>100</u>	<u>75</u>	<u>150</u>	<u>0</u>	<u>0</u>	<u>0</u>
<u>2500</u>	<u>1914</u>	<u>4 1/2</u>	<u>100</u>	<u>100</u>				
					<u>900</u>	<u>1200</u>		

DATE	REMARKS
<u>5-2-73</u>	<u>COMM. DRILL</u>
<u>5-2</u>	<u>CEM. 8 3/4" - 204' - 75' SHS. DOWN</u>
<u>5-3</u>	<u>DRG. AT 365'</u>
<u>5-9-73</u>	<u>WELL COMP. TO PERM. LTD. - DRG. (194)</u>
<u>5-9-73</u>	<u>CEM. 1904' - 4 1/2" - DANWELL</u>
<u>5-8-73</u>	<u>FRAC. WELL - ROV.</u>
	<u>PERF. 1702' - 1801' - 20 HOLES</u>
	<u>WATER RESOURCES DIV. - FOLEY & SANDY</u>
	<u>NOTIFIED 5-2-73.</u>
<u>7-11-73</u>	<u>WELL RELEASED.</u>
	<u>Harry G. Kelly, Insp.</u>

B-11

STATE OF WEST VIRGINIA
DEPARTMENT OF MINES
OIL AND GAS WELLS DIVISION

RECEIVED
JUL 16 1973

INSPECTOR'S WELL REPORT

OIL & GAS DIVISION
DEPT. OF MINES

Permit No. WIA-627

Oil or Gas Well F
(KIND)

Company <u>ARVIN G. POWES</u> <u>SUITE 406, 424 MADISON AVE,</u>	CASING AND TUBING	USED IN DRILLING	LEFT IN WELL	PACKERS
	Address <u>NEW YORK, NY</u>	Size		
Farm <u>P.L. DEWEE, JR.</u>	16			
Well No. <u>4</u>	13			Size of
District <u>SPRING GREEN</u> County <u>WIRT</u>	10			
Drilling commenced	8 1/4			Depth set
Drilling completed	6 5/8			
Date shot	5 3/16			Perf. top
Initial open flow	3			Perf. bottom
Open flow after tubing	2			Perf. top
Volume	Liners Used			Perf. bottom
Rock pressure	CASING CEMENTED _____ SIZE _____ No. FT. _____ Date _____			
Oil	NAME OF SERVICE COMPANY _____			
Fresh water	COAL WAS ENCOUNTERED AT _____ FEET _____ INCHES			
Salt water	_____ FEET _____ INCHES _____ FEET _____ INCHES			
	_____ FEET _____ INCHES _____ FEET _____ INCHES			

Drillers' Names _____

Remarks: ON INSPECTION, THIS WELL MAY BE RELEASED

7-11-73
DATE

Henry A. Holliday
DISTRICT INSPECTOR

01/26/2024

B-12



State of West Virginia

Department of Mines

Oil and Gas Division

Charleston 25305

July 17, 1973

Alvin Rowes
Suite 405
825 Madison Avenue
N. Y. N. Y. 10017

In Re: Permit No. WIRT-627
Farm P. L. DePue
Well No. 4
District Spring Creek
County Wirt

Gentlemen:

The final inspection report for the well which is described above has been received in this office. Only the column checked below applies.

 The bond covering the well designated by the above permit number has been released under your Blanket Bond.

~~XXXXX~~ Please return the enclosed cancelled bond which covered the well designated by the above permit number to the Surety Company who executed said bond in your behalf, in order that they may give you credit on their records.

Very truly yours,

Deputy Director
Oil and Gas Division

RLD/cc

Enclosure: 1 Bond

01/26/2024

RECEIVED
 N/AUG 14 1979
 OIL & GAS DIVISION
 DEPT. OF MINES

1.0 API well number: (If not available, leave blank. 14 digits.)	47-105-0627			
2.0 Type of determination being sought: (Use the codes found on the front of this form.)	108 Section of NGPA		N/A Category Code	
3.0 Depth of the deepest completion location: (Only needed if sections 103 or 107 in 2.0 above.)	N/A			
4.0 Name, address and code number of applicant: (35 letters per line maximum. If code number not available, leave blank.)	Seminole Oil & Gas Corp., c/o Hays & Com., Agent Name _____ Seller Code _____ P.O. Box 590 Street _____ City Spencer State WV Zip Code 25276			
5.0 Location of this well: [Complete (a) or (b).] (a) For onshore wells (35 letters maximum for field name.)	N/A Field Name _____ Wirt County _____ State WV			
(b) For OCS wells:	N/A Area Name _____ Block Number _____ Date of Lease: _____ Mo. Day Yr. OCS Lease Number _____			
(c) Name and identification number of this well: (35 letters and digits maximum.)	P.L. DePue #4			
(d) If code 4 or 5 in 2.0 above, name of the reservoir: (35 letters maximum.)	N/A			
6.0 (a) Name and code number of the purchaser: (35 letters and digits maximum. If code number not available, leave blank.)	Consolidated Gas Supply Corporation Name _____ Buyer Code _____			
(b) Date of the contract:	11 21 66 5 Mo. Day Yr.			
(c) Estimated annual production:	12 MMcf.			
	(a) Base Price (\$/MMBTU)	(b) Tax	(c) All Other Prices [Indicate (+) or (-).]	(d) Total of (a), (b) and (c)
7.0 Contract price: (As of filing date. Complete to 3 decimal places.)	2.400	---	---	2.400
8.0 Maximum lawful rate: (As of filing date. Complete to 3 decimal places.)	2.400	---	---	2.400
9.0 Person responsible for this application:	Hays and Company Agent Name _____ Title _____ Signature _____ 8-10-79 (304) 927-2650 Date Application is Completed Phone Number			

Agency Use Only
 Date Received by Juris. Agency
 AUG 14 1979
 Date Received by FERC

PARTICIPANTS:

DATE:

FEB 04 1980

BUYER-SELLER CO

WELL OPERATOR: Seminole Oil & Gas Corp.

N/A

FIRST PURCHASER: Consolidated Gas Supply Corp.

004228

OTHER: _____

Qualified Section 108, stripper well
Part 11

W. Va. Department of Mines, Oil & Gas Division
 WELL DETERMINATION FILE NUMBER
790814-108-105-0627
 Use Above File Number on all Communications
 Relating to Determination of this Well

CHECK EACH ITEM AS COMPLETE OR NOTE WHAT IS MISSING

ITEM NO.

- 1 FERC-121 Items not completed - Line No. _____
- 2 IV-1 - Agent George Gainer
- 3 IV-2 - Well Permit _____
- 4 IV-6 - Well Plat
- 5 IV-35- Well Record Drilling Deepening _____
- 6 IV-36- Gas-Oil Test: Gas Only _____ Was Oil Produced? _____ Ratio _____
- 7 IV-39- Annual Production 2 years - 4 mos.
- 8 IV-40- 90 day Production 90 Days off Line: _____
- 9 IV-48- Application for Certification. Complete?
- 10 - 17 IV Form #51 - 52 - 53 - 54 - 55 - 56 - 57 - 58. Complete Affidavit Signed
- 18 - 28 Other: Survey _____ Logs _____ Geological Charts _____ Structure Map _____
 1:4000 Map _____ Well Tabulations _____ Gas Analyses _____
- (5) Date commenced: 5-3-73
 Date Completed: 5-4-73 Deepened _____
- (5) Production Depth: 1800-1827
- (5) Production Formation: Big Injun
- (5) Final OPEN FLOW:
 Initial Potential: 1,870 MCF
- (5) ~~After~~ FRAC R.P. ~~Initial~~: 600-60 hrs.
- (6) Other Gas Test: _____
- (7) Avg. Daily Gas from Annual Production: $\frac{12032}{365} = 32.9 \text{ MCF}; \frac{21.12}{365} = .05$
- (8) Avg. Daily Gas from 90-day ending w/1-120 days: $\frac{2273}{90} = 25 \text{ MCF}; \text{No Oil}$
- (8) Line Pressure: N/A PSIG from Daily Report _____
- (5) Oil Production: NO From Completion Report _____
- (10-17) Does lease inventory indicate enhanced recovery being done? 01/26/2024
- (10-17) Is affidavit signed? Notarized?

Does official well record with the Department confirm the submitted information? Yes

Additional Information _____ Does computer program confirm? _____

Was Determination Objected to? _____ By Whom? _____

JAK

Date August 10 19 79

STATE OF WEST VIRGINIA
DEPARTMENT OF MINES, OIL AND GAS DIVISION

Operator's Well No. 4
API Well No. 47 State 105 County 0627 Permit

WELL CLASSIFICATION FORM

STRIPPER GAS WELL
NGPA Section 108

DESIGNATED AGENT Hays and Company, Inc.

ADDRESS P.O. Box 590
Spencer, WV 25276

LOCATION: Elevation 907

Watershed Little Kanawha River

Spring Dist. Creek County Wirt Quad Spencer

Gas Purchase Contract No. 3098

Meter Chart Code 7157

Date of Contract 12-16-65

WELL OPERATOR Seminole Oil & Gas

ADDRESS P.O. Bxo 590

Spencer, WV 25276

GAS PURCHASER Consolidated Gas Suply

ADDRESS 445 West Main Street

Clarksburg, WV 26301

* * * * *

Provide a complete inventory of the lease and production equipment used for the well for the previous 24 months or, if less than 24 months, the period the well has been in production. Include a complete list of equipment or processes used in connection with recognized enhanced recovery techniques during completion or production. (Attach separate sheets, if necessary):

Standard Production Equipment

List all records reasonably available to you which contain information relevant to a determination of eligibility (including production records, B&O Tax Records and royalty payment records) and indicate the location of such records:

All located at Hays and Company, of Spencer, WV 25276:

- Production Records
- Tax Records
- Royalty Payment Records

01/26/2024

Describe the search made of any records listed above:

All records reviewed

Are you aware of any other information which would tend to be inconsistent with the information specified above? Yes No . If yes, indicate the type and source of the information.

AFFIDAVIT

I, George Gainer, having been first sworn according to law, state that I have caused to be made a diligent search of those records hereinbefore indicated in the manner herein described, that the information contained in this document is true and accurate and that on the basis of the records and examinations hereinbefore described, and to the best of my information, knowledge and belief, the well for which this certification is sought qualifies as a stripper well.

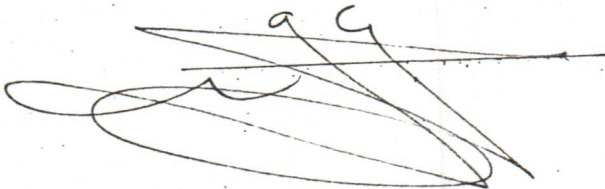

STATE OF WEST VIRGINIA,
COUNTY OF Roane, TO WIT:

I, Norma Cooper, a Notary Public in and for the state and county aforesaid, do certify that George Gainer, whose name is signed to the writing above, bearing date the 10th day of August, 19 79, has acknowledged the same before me, in my county aforesaid. Given under my hand and official seal this 10th day of August, 19 79. My term of office expires on the 29th day of March, 19 87.

Norma Cooper
Notary Public 01/26/2024

[NOTARIAL SEAL]

IV-39-WC

STATE OF WEST VIRGINIA
DEPARTMENT - MINES
DIVISION - OIL AND GAS

YEAR 1978

OPERATOR Seminole Oil & Gas Corporation

REPORT OF MONTHLY PRODUCTION
GAS VOLUMES IN MCF @ 14.73
OIL IN BARRELS @ 60 DEGREES

REPORT DATE

August 10, 1979

01/26/2024

API	FARM	P.L.	DePue	COUNTY	Wirt	AVG. FLOW PRESSURE	SHUT-IN PRESSURE	TOTALS					
GAS MCF	776	472	1205	1615	892	1197	959 992 1121 920 897 987	12032					
OIL BBL	J-	F-	21.12	M-	A-	S-	O-	N-	D-	21.12			
DAYS ON LINE													
YEAR	1977												
API	47-105-0626	FARM	P.L. DePue	COUNTY	Wirt	AVG. FLOW PRESSURE	SHUT-IN PRESSURE	TOTALS					
GAS MCF	1027	1027	1027	1477	1106	1351	1082 1152 1207 1015 1048 1162	13681					
OIL BBL	J-	F-	M-	A-	M-	J-	J-	A-	S-	O-	N-	D-	12.32
DAYS ON LINE													

SUMMARIZATION SCHEDULE
Section 271.804 (b)

In accordance with Section 271.804 (b) please list all other wells which are to be used in determining this well classification under Part 271 Subpart H.

API NUMBERS

- 47-105-0625
- 47-105-0626

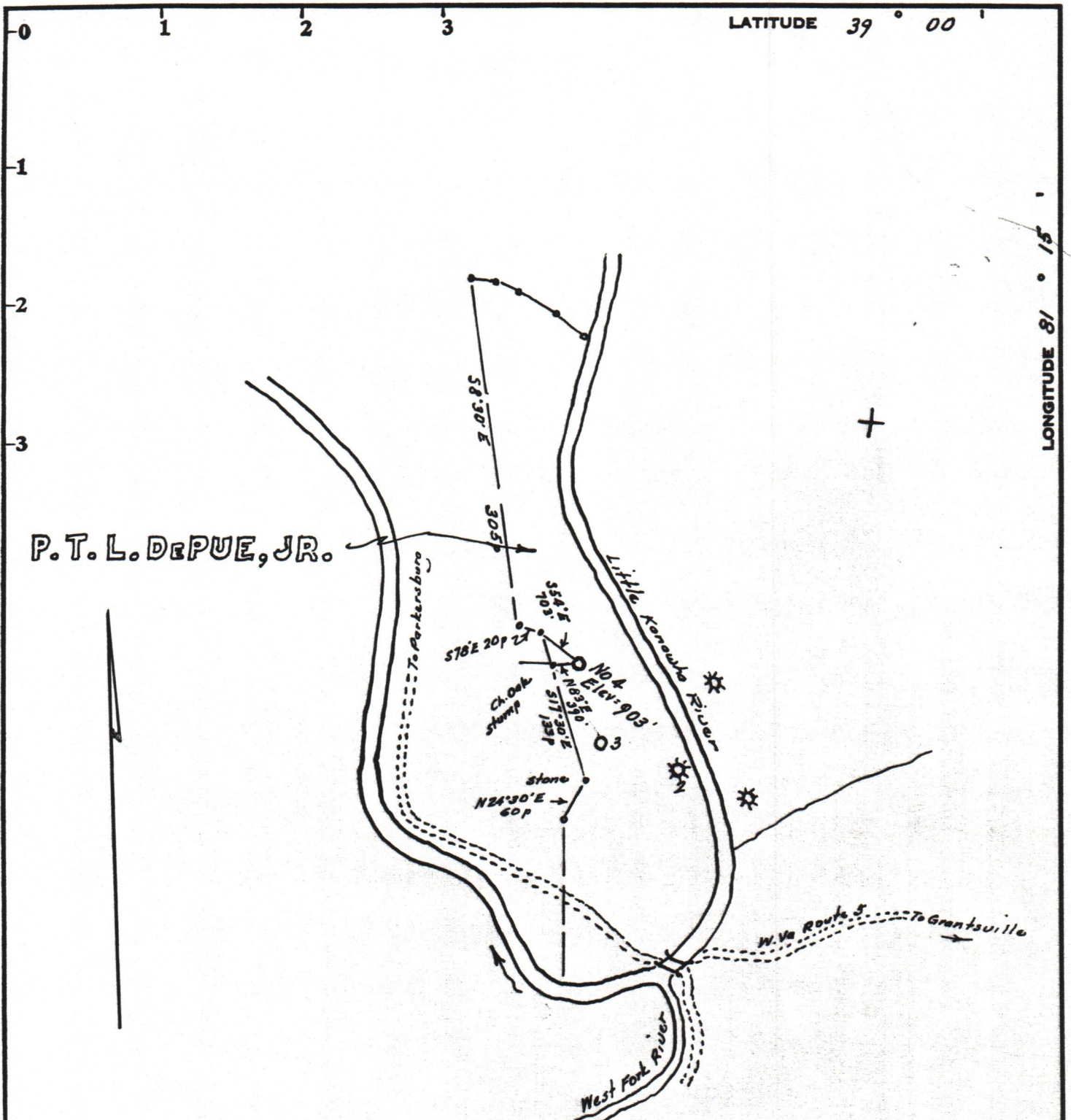

Minimum Error of Closure 1 in 200'
 Source of Elevation Elev. Well No. 1 = 671

- Fracture.....
- New Location.....
- Drill Deeper.....
- Abandonment.....

I, the undersigned, hereby certify that this map is correct to the best of my knowledge and belief and shows all the information required by paragraph 6 of the rules and regulations of the oil and gas section of the mining laws of West Virginia.

Signed: [Signature]
 Map No. _____ Squares: N S E W

Company ALVIN ROWES
 Address P.O. Box 388, Parkersburg West Va.
 Farm P.T.L. DePue, Jr.
 Tract _____ Acres 283 Lease No. _____
 Well (Farm) No. Three Serial No. _____
 Elevation (Spirit Level) 903'
 Quadrangle Spencer
 County Wirt District Spring Creek
 Engineer [Signature]
 Engineer's Registration No. 1227
 File No. _____ Drawing No. _____
 Date April 4, 1973 Scale 1" = 2000'

STATE OF WEST VIRGINIA
 DEPARTMENT OF MINES
 OIL AND GAS DIVISION
 CHARLESTON

WELL LOCATION MAP

FILE NO. WIR-627
 01/26/2024

+ Denotes location of well on United States Topographic Maps, scale 1 to 62,500, latitude and longitude lines being represented by border lines as shown.

— Denotes one inch spaces on border line of original tracing. 47-105

A1



STATE OF WEST VIRGINIA
DEPARTMENT OF MINES

RECEIVED

APR 19 1973 - CEN

OIL & GAS DIVISION
DEPT. OF MINES

Oil and Gas Division

OIL AND GAS WELL PERMIT APPLICATION

TO THE DEPARTMENT OF MINES,
Charleston, W. Va.

DATE April 19, 1973

Surface Owner P. L. DePue
Address Creston, W. Va.
Mineral Owner P. L. DePue
Address Creston, W. Va.
Coal Owner _____
Address _____
Coal Operator _____
Address _____

Company Alvin G. Rowes
Address Suite 405
424 Madison Avenue, New York, N.Y.
Farm DePue Acres 124 1/2 of 283
Location (waters) Little Kanawha
Well No. Four Elevation 900'
District Spring Creek County Wirt
Quadrangle Spencer Northeast

THIS PERMIT MUST BE POSTED AT THE WELL SITE

All provisions being in accordance with Chapter 22, of the W. Va. Code, the location is hereby approved for Drilling. This permit shall expire if operations have not commenced by 8/19/73.

INSPECTOR TO BE NOTIFIED Mr. Lang
Holliday
Box 221 PH: 354-6731
Grantville
W.V. 26147

Deputy Director - Oil & Gas Division

GENTLEMEN:

The undersigned well operator is entitled to drill upon the above named farm or tract of land for oil and gas, having fee title thereto, (or as the case may be) under grant or lease dated March 15, 19 73 by R. L. Dunbar made to _____ and recorded on the _____ day of _____ 19____, in _____ County, Book _____ Page _____
 NEW WELL _____ DRILL DEEPER _____ REDRILL _____ FRACTURE OR STIMULATE _____
OIL AND GAS WELL ORIGINALLY DRILLED BEFORE JUNE 5, 1969.

The enclosed plat was prepared by a registered engineer or licensed land surveyor and all coal owners and/or operators have been notified as of the above date.

The above named coal owners and/or operator are hereby notified that any objection they wish to make, or are required to make by Section 3 of the Code, must be received by, or filed with the Department of Mines within ten (10) days. *

Copies of this notice and the enclosed plat were mailed by registered mail, or delivered to the above named coal operators or coal owners at their above shown respective address _____ day _____ before, or on the same day with the mailing or delivery of this copy to the Department of Mines at Charleston, West Virginia.

Very truly yours,
(Sign Name) Dallas B Bell
Well Operator

Address of Well Operator Route No. 5, Box 171A Street
Parkersburg City or Town
West Virginia 26101 State

01/26/2024

*SECTION 3 If no objections are filed or found by the Department of mines, within said period of ten days from the receipt of notice and plat by the department of mines, to said proposed location, the department shall forthwith issue to the well operator a permit reciting the filing of such plat, that no objections have been made by the coal operators or found thereto by the department and that the same is approved and the well operator authorized to proceed.

BOND DRILL

Wirt-627 PERMIT NUMBER

THIS IS AN ESTIMATE ONLY
ACTUAL INFORMATION WILL BE SUBMITTED ON OG-10 UPON COMPLETION

PROPOSED WORK ORDER TO DRILL _____ DEEPEN _____ FRACTURE-STIMULATE _____
 DRILLING CONTRACTOR: (If Known) _____ RESPONSIBLE AGENT: _____
 NAME Haight Drilling Company NAME Dallas R. Ball
 ADDRESS Smithville, W. Va. ADDRESS Parkersburg, W. Va.
 TELEPHONE 477-2222 TELEPHONE 428-8551
 ESTIMATED DEPTH OF COMPLETED WELL: 2000' ROTARY CABLE TOOLS _____
 PROPOSED GEOLOGICAL FORMATION: Big Injun
 TYPE OF WELL: OIL _____ GAS _____ COMB. STORAGE _____ DISPOSAL _____
 RECYCLING _____ WATER FLOOD _____ OTHER _____

TENTATIVE CASING PROGRAM:

CASING AND TUBING SIZE	USED FOR DRILLING	LEFT IN WELL	CEMENT FILL UP OR SACKS - CUBIC FT.
20 - 16			
13 - 10			
9 - 5/8			
8 - 5/8 200'	8 5/8"	200'	100 sacks cement
7			
5 1/2			
4 1/2 2000'	4 1/2"	2000'	100 sacks cement
3			Perf. Top
2			Perf. Bottom
Liners			Perf. Top
			Perf. Bottom

APPROXIMATE FRESH WATER DEPTHS 150 FEET SALT WATER 1200 FEET
 APPROXIMATE COAL DEPTHS _____ , _____
 IS COAL BEING MINED IN THE AREA? _____ BY WHOM? _____

TO DRILL:

SUBMIT FIVE (5) COPIES OF OG - 1, \$100.00 PERMIT FEE, PERFORMANCE BOND AND PERMANENT COPY OF PLAT.

TO DRILL DEEPER OR REDRILL:

SUBMIT FIVE (5) COPIES OF OG - 1, SHOWING ORIGINAL PERMIT NUMBER AND PERFORMANCE BOND. ON WELLS DRILLED PRIOR TO 1929, A PERMANENT COPY OF THE PLAT AND THE ORIGINAL WELL RECORD MUST ALSO BE SUBMITTED.

TO FRACTURE - STIMULATE:

OIL AND/OR GAS WELL ORIGINALLY DRILLED BEFORE JUNE 5, 1929, FIVE (5) COPIES OG - 1, PERFORMANCE BOND, PERMANENT PLAT AND ORIGINAL WELL RECORD.

OIL AND/OR GAS WELL ORIGINALLY DRILLED ON AND/OR AFTER JUNE 5, 1929, FIVE COPIES OG - 1, SHOWING ORIGINAL PERMIT NUMBER, AND PERFORMANCE BOND.

Required forms must be filed within ninety (90) days of completion for bond release. Inspector to be notified twenty-four (24) hours in advance.

The following waiver must be completed by the coal operator if the permit is to be issued within ten days of receipt thereof.

WAIVER: I the undersigned, Agent for _____ Coal Company, Owner or Operator of _____ under this lease have examined and place on our mine maps this proposed well location.

We the _____ Coal Company have no objections to said well being drilled at this location, providing operator has complied with all rules and regulations in Articles 4, 5, and 7, Chapter 22 of the West Virginia Code.

 For Coal Company

 Official Title

STATE OF WEST VIRGINIA
DEPARTMENT OF MINES, OIL AND GAS DIVISION

A-7

DESIGNATION OF AGENT BY WELL OWNER OR OPERATOR

Operator Owner Seminole Oil & Gas Company

Address c/o Hays and Company, Inc. P.O. Box 590
Spencer, WV 25276

Pursuant to the provisions of Code § 22-4-1k, and subject to the requirements of Regulation 01, the undersigned hereby designates the following person to be the agent of the undersigned for the purpose of receiving process, notices, orders and other communications which may be issued under Chapter of the Code of West Virginia;

Designated Agent Hays and Company, Inc.
Address P.O. Box 590
Spencer, WV 25276
Telephone (304) 927-2650

The undersigned represents that said designated agent is a bona fide resident of the State of West Virginia, and has agreed to accept the designation. This designation applies to the following wells:

- all wells owned or operated by the undersigned in West Virginia
- the wells listed below (Use space below or reverse side or attach list)

COMPLETE AS APPLICABLE]

The undersigned is hereby recording an existing designation of agent made prior to the initial adoption of Form IV-1.

The undersigned is proposing to own or operate wells in West Virginia for the first time, so that this designation should also be considered the registration by the undersigned with the Deputy Director.

The undersigned has owned and operated a well or wells in West Virginia since the year 19___, but has not heretofore appointed a designated agent.

This designation substitutes a new designated agent for the undersigned, who has owned or operated a well or wells in West Virginia since the year 19___. The present designated agent of the undersigned, who will continue as such, if he is able, until this new designation has been approved, is--

Agent being replaced _____
Address _____

Seminole Oil & Gas Company
Well Owner or Operator

By: _____
Its: Hays and Company, Inc. 04/26/2024
George Gainer, Treasurer

ACCEPTED this March 30, 1979
Hays and Company, Inc.

(Signature of designated agent)
George Gainer, Treasurer
I, Norma Cooper, Notary Public, subscribed and sworn to before me this 30 day of March, 19 79.
My commission expires March 29, 19 87



RECEIVED

JUL 5 1973

STATE OF WEST VIRGINIA
DEPARTMENT OF MINES

OIL & GAS DIVISION
DEPT. OF MINES

Oil and Gas Division

WELL RECORD

39-00
3-34
⑨

Quadrangle Spencer

Permit No. Wir-627

Rotary Oil _____
Cable _____ Gas G. NOLL
Recycling _____ Comb. _____
Water Flood _____ Storage _____
Disposal _____ (Kind)

Company <u>Wade Oil Company</u>	Casing and Tubing	Used in Drilling	Left in Well	Cement fill up Cu. ft. (Sks.)
Address <u>New York, New York</u>	Size			
Farm <u>P. L. DePue</u> Acres <u>124½</u>	20-16			
Location (waters) <u>Little Kanawha River</u>	Cond.			
Well No. <u>Four (4)</u> Elev. <u>907 KB</u>	13-10"			
District <u>Spring Creek</u> County <u>Wirt</u>	9 5/8			
The surface of tract is owned in fee by _____	8 5/8	202	202	75 Sx.
<u>P. L. DePue</u>	7			
Address <u>Creston, West Virginia</u>	5 1/2			
Mineral rights are owned by <u>Same</u>	4 1/2	1914	1914	
Address _____	3			
Drilling Commenced <u>5/3/73</u>	2			
Drilling Completed <u>5/4/73</u>	Liners Used			
Initial open flow _____ cu. ft. _____ bbls.				
Final production <u>1,870,100</u> cu. ft. per day <u>0</u> bbls.				
Well open <u>60</u> hrs. before test <u>600</u> RP.				

Well treatment details: Attach copy of cementing record.
Fractured with 830 bbl. water, 3500 gal. acid, 30,000 Lbs. Sand

Coal was encountered at None Feet _____ Inches _____
Fresh water _____ Feet _____ Salt Water Maxton Feet 1620
Producing Sand Big Injun Depth 1800 - 1827

Formation	Color	Hard or Soft	Top Feet	Bottom Feet	Oil, Gas or Water	* Remarks
Soil			0	10		
Sand - Shale - Red Rock			10	1370		
Sand			1370	1392		
Shale			1392	1424		
Sand			1424	1518		
Shale			1518	1530		
Sand			1530	1650		
Little Lime - Pencil Cave			1650	1696		
Big Lime			1696	1798		
Big Injun			1798	1850		
Shale			1850	1941		
				1941		
						Salt Water 1620'
						1941 TOTAL DEPTH

01/26/2024

* Indicates Electric Log tops in the remarks section.

