



STATE OF WEST VIRGINIA  
DEPARTMENT OF MINES  
OIL AND GAS DIVISION

NOTICE OF PROPOSED LOCATION OF OIL AND GAS WELL

To THE DEPARTMENT OF MINES,  
Charleston, W. Va.

None  
COAL OPERATOR OR COAL OWNER

---

ADDRESS

---

COAL OPERATOR OR COAL OWNER

---

ADDRESS

---

OWNER OF MINERAL RIGHTS

---

ADDRESS

Ralph G. Fankhauser  
NAME OF WELL OPERATOR

---

Belleville, West Virginia  
COMPLETE ADDRESS

---

October 4, 19 51  
PROPOSED LOCATION

---

Grant Harris District

---

Jackson Wood County

---

Well No. 1 39° 10'  
81° 40'

---

Clyde Morlan Farm

GENTLEMEN:

The undersigned well operator is entitled to drill upon the above named farm or tract of land for oil and gas, having fee title thereto, (or as the case may be) under grant or lease dated August 22, 1951, made by Clyde Morlan, to Ralph G. Fankhauser, and recorded on the 25th day of August, 1951, in the office of the County Clerk for said County in Book No. 78, page No. 27.

The enclosed plat was prepared by a competent engineer and shows the proposed location of a well to be drilled for oil and gas by the undersigned well operator on the farm and in the Magisterial District and County above named, determined by survey and courses and distances from two permanent points, or land marks.

The undersigned well operator is informed and believes there are no coal operators operating beds of coal beneath said farm or tract of land on which said well is located, or within 500 feet of the boundaries of the same, who have mapped their workings and filed their maps as required by law, excepting the coal operators or coal owners (if any) above named as addressees.

The above named coal operators or coal owners (if any) are notified that any objections they may desire to make to such proposed location, or which they are required to make by Section 3 of said Code, if the drilling of a well at said proposed location will cause a dangerous condition in or about their respective coal mines, must be received by, or filed with the Department of Mines within ten\* days from the receipt of a copy of this notice and accompanying plat by said Department. Said coal operators are further notified that forms for use in making such objections will be furnished to them by the Department of Mines promptly on request and that all such objections must set forth as definitely as is reasonably possible the ground or grounds on which such objections are based and indicate the direction and distance the proposed location should be moved to overcome same.

(The next paragraph is to be completed only in Department's copy.)

Copies of this notice and the enclosed plat were mailed by registered mail, or delivered to the above named coal operators or coal owners at their above shown respective address \_\_\_\_\_ day \_\_\_\_\_ before, or on the same day with the mailing or delivery of this copy to the Department of Mines at Charleston, West Virginia.

Very truly yours,

Ralph G. Fankhauser  
WELL OPERATOR

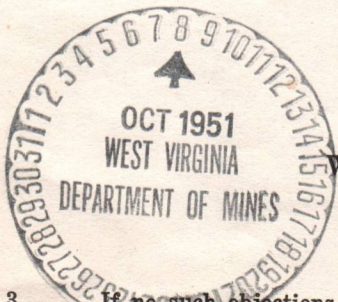

Address of Well Operator }

STREET

---

Belleville  
CITY OR TOWN

---

West Virginia  
STATE

12/15/2023

\*Section 3 . . . If no such objections be filed or be found by the department of mines, within said period of ten days from the receipt of said notice and plat by the department of mines, to said proposed location, the department shall forthwith issue to the well operator a drilling permit reciting the filing of such plat, that no objections have been made by the coal operators to the location, or found thereto by the department, and that the same is approved and the well operator authorized to proceed to drill at said location.

359



STATE OF WEST VIRGINIA  
DEPARTMENT OF MINES  
OIL AND GAS DIVISION

Woo-359

WELL RECORD

Oil or Gas Well Oil  
(KIND)

Permit No. Woo-359

Company Morlan Associates of Bellemeil  
 Address Bellemeil, W.Va  
 Farm Clyde Morlan Acres 67  
 Location (waters) Ohio River  
 Well No. 1-1 Elev.       
 District Harris County Wood  
 The surface of tract is owned in fee by       
 Address       
 Mineral rights are owned by       
 Address       
 Drilling commenced Nov. 17, 51  
 Drilling completed Dec 30, 51  
 Date Shot Jan 1, 52 From 3 pm To 4 am  
 With 60 qt dynamite  
 Open Flow      /10ths Water in      Inch  
     /10ths Merc. in      Inch  
 Volume 120 cu yd 2 hrs after shot Cu. Ft.  
 Rock Pressure      lbs.      hrs.  
 Oil not certain bbls., 1st 24 hrs.  
 Fresh water      feet      feet  
 Salt water      feet      feet

Casing and Tubing	Used in Drilling	Left in Well	Packers
Size			Kind of Packer
16			
13			
10	<u>495</u>		Size of
8 1/4	<u>1021</u>		
6%	<u>1364-1</u>	<u>1364-1</u>	Depth set
5 3/16			
3			Perf. top
<u>2 1/2</u>		<u>1425</u>	Perf. bottom
Liners Used			Perf. top
			Perf. bottom

CASING CEMENTED      SIZE      No. Ft.      Date     

COAL WAS ENCOUNTERED AT      FEET      INCHES  
     FEET      INCHES      FEET      INCHES  
     FEET      INCHES      FEET      INCHES

Formation	Color	Hard or Soft	Top	Bottom	Oil, Gas or Water	Depth Found	Remarks
Top Soil			0	18			
Sand			18	78			
Slate			78	88			
Lime			88	128			
Rock	Red -	—	128	138			
Slate Shells			138	180			
Lime			180	230			
Sand Pebb			230	275			
Slate Shells			275	365			
Sand little shell			365	435			
Rock	Red	—	435	465			
Lime Shells		—	465	470			
Sand		—	470	499			
Lime		—	499	520			
Slate	Red	—	520	537			
Rock	Red	—	537	550			
Slate Shells		—	550	560			
Rock	Red	—	560	590			
Slate Shells		—	590	617			
Rock	Red	—	617	638			
Slate Shells		—	638	658			
Rock	Red	—	658	673			
Lime		—	673	700			
Slate Shells		—	700	725			
Sand little Dark		—	725	742			
Slate		—	742	752			
Rock	Red	—	752	755			
Slate Shells		—	755	795			
Sand little Dark		—	795	858			
Slate Shells		—	858	910			

12 ft back  
is killing  
Sand  
1

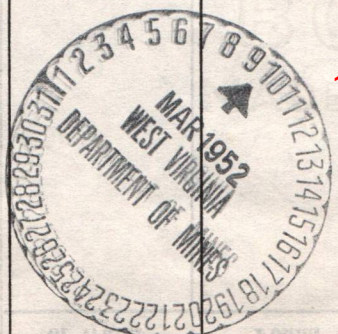

12/15/2023

Formation	Color	Hard or Soft	Top	Bottom	Oil, Gas or Water	Depth Found	Remarks
Time		910	930				
Slate	Black	930	963				3 ft
Gas sand		963	1013				Break w
Slate	Black	1013	1022				973, 978
Sand		1022	1100				
Slate shell		1100	1225				
Sand		1225	1320				Dilled
Slate		1320	1330				for pocket
Sand		1330	1335				to about
Slate		1335	1365				with powder
Sand		1365	1380				and found
Slate		1380	1385				in pocket
Big time		1385	1425				Total
Slate		1425	1546				depth
Time shell		1546	1554				1929 ft.
Slate shell		1554	1640				
Time		1640	1684				
Slate shell		1684	1875				
Shale		1875	1843				
Box cut		1843					



Dilled  
for pocket  
to about  
with powder  
and found  
in pocket  
  
Total  
depth  
1929 ft.

OIL AND GAS DIVISION  
DEPARTMENT OF MINES

Date March 2, 1932

APPROVED Royce G. Fambourne, Owner

By [Signature] (Title)



B-3

STATE OF WEST VIRGINIA  
DEPARTMENT OF MINES  
OIL AND GAS DIVISION

INSPECTOR'S PLUGGING REPORT

Permit No. Wood J 359 Well No. \_\_\_\_\_

COMPANY Ralph G. Frankhausen ADDRESS Belleville W. Va.

FARM Clyde Melan DISTRICT Stannis COUNTY Wood

Filling Material Used \_\_\_\_\_

Liner Location Amount Packer Location

PLUGS USED AND DEPTH PLACED			BRIDGES	CASING AND TUBING		
CEMENT-THICKNESS	WOOD-SIZE	LEAD	CONSTRUCTION-LOCATION	RECOVERED	SIZE	LOST
<i>I inspected this well Apr 22 - 1942</i>						
<i>I find there is 5 3/4" and 6 7/8" casing in well</i>						
<i>Also a string of 2" tubing. I did not see</i>						
<i>Mr. Frankhausen to get a report. His</i>						
<i>wife told me he had sent in the</i>						
<i>proper report.</i>						

Drillers' Names \_\_\_\_\_

Remarks: \_\_\_\_\_

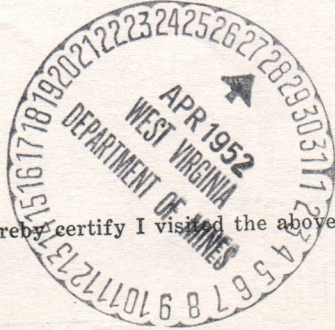

4/22-42  
DATE

I hereby certify I visited the above well on this date.

*W. Howard*

DISTRICT WELL INSPECTOR

12/15/2023

STATE OF WEST VIRGINIA  
DEPARTMENT OF MINES  
OIL AND GAS DIVISION

INSPECTOR'S WELL REPORT

Permit No. \_\_\_\_\_

Oil or Gas Well \_\_\_\_\_  
(KIND)

Company _____	CASING AND TUBING	USED IN DRILLING	LEFT IN WELL	PACKERS
Address _____	Size			
Farm _____	16			Kind of Packer _____
Well No. _____	13			
District _____ County _____	10			Size of _____
Drilling commenced _____	8 1/4			
Drilling completed _____ Total depth _____	6 5/8			Depth set _____
Date shot _____ Depth of shot _____	5 3/16			
Initial open flow _____ /10ths Water in _____ Inch	3			Perf. top _____
Open flow after tubing _____ /10ths Merc. in _____ Inch	2			Perf. bottom _____
Volume _____ Cu. Ft.	Liners Used			Perf. top _____
Rock pressure _____ lbs. _____ hrs.				Perf. bottom _____
Oil _____ bbls., 1st 24 hrs.				
Fresh water _____ feet _____ feet				
Salt water _____ feet _____ feet				

CASING CEMENTED \_\_\_\_\_ SIZE \_\_\_\_\_ No. FT. \_\_\_\_\_ Date \_\_\_\_\_

COAL WAS ENCOUNTERED AT \_\_\_\_\_ FEET \_\_\_\_\_ INCHES  
\_\_\_\_\_ FEET \_\_\_\_\_ INCHES \_\_\_\_\_ FEET \_\_\_\_\_ INCHES  
\_\_\_\_\_ FEET \_\_\_\_\_ INCHES \_\_\_\_\_ FEET \_\_\_\_\_ INCHES

Drillers' Names \_\_\_\_\_

Remarks: \_\_\_\_\_

DATE \_\_\_\_\_

DISTRICT WELL INSPECTOR  
12/15/2023

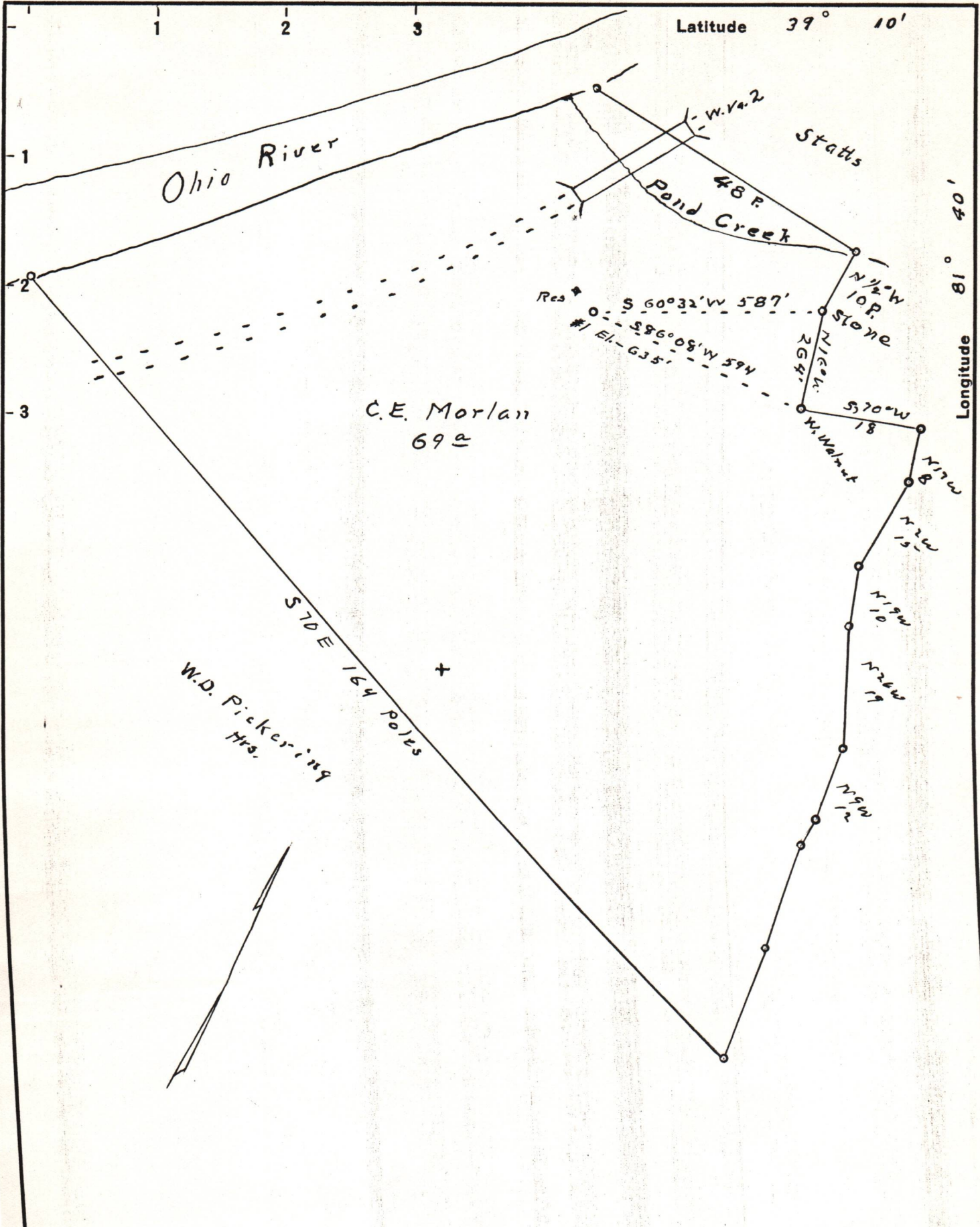

New Location..   
 Drill Deeper.....   
 Abandonment.....

Company R.G. Frankhouser  
 Address Bellville W.Va.  
 Farm C.E. Morlan  
 Tract \_\_\_\_\_ Acres 69 Lease No. \_\_\_\_\_  
 Well (Farm) No. 1 Serial No. \_\_\_\_\_  
 Elevation (Spirit Level) 635'  
 Quadrangle Bellville  
 County Wood District Harris  
 Engineer Robert R. Anderson  
 by J.E. Anderson  
 Engineer's Registration No. 296  
 File No. \_\_\_\_\_ Drawing No. \_\_\_\_\_  
 Date Oct 5 51 Scale 1 in = 20 poles

STATE OF WEST VIRGINIA  
 DEPARTMENT OF MINES  
 OIL AND GAS DIVISION  
 CHARLESTON

WELL LOCATION MAP  
 FILE NO. W00-359

12/15/2023

+ Denotes location of well on United States Topographic Maps, scale 1 to 62,500, latitude and longitude lines being represented by border lines as shown.  
 - Denotes one inch spaces on border line of original tracing.