

Latitude 39° 20' 00"

9700' SOUTH
2960' WEST

Longitude 81° 27' 30"

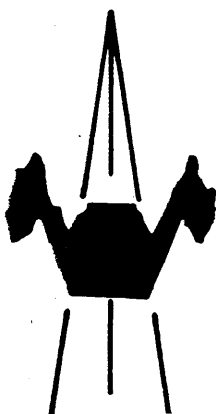
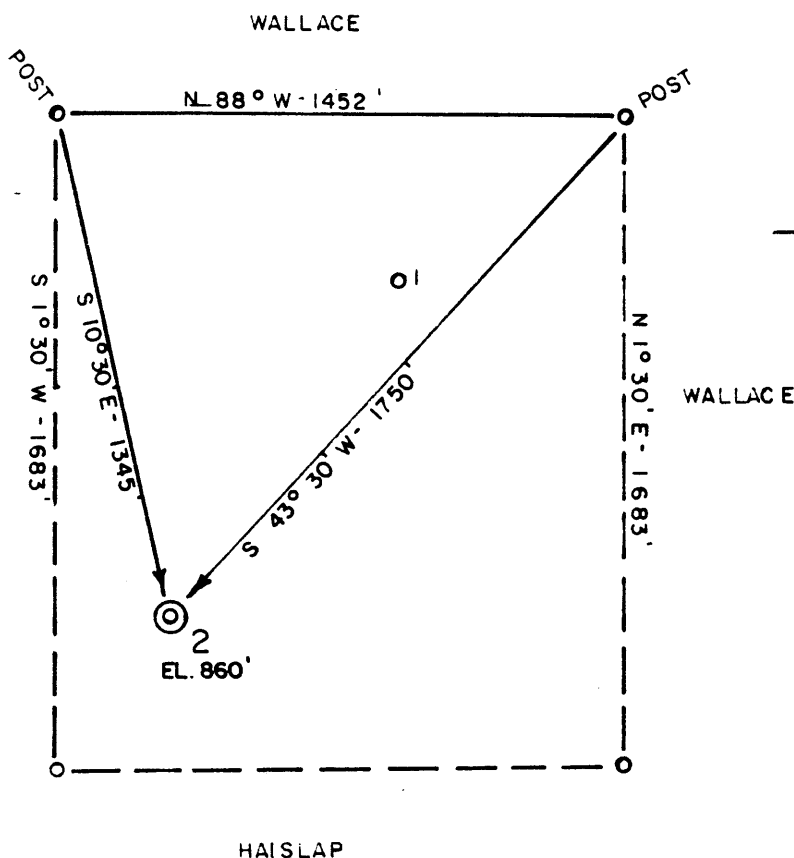
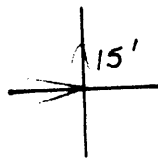

ACCURACY: 1' / 200'

- New Location
- Drill Deeper
- Abandonment
- Fracture
- Redrill
- Other

Formation GORDON
 Est. Depth 2800'

Oil
 Gas
 Other

Source of Elevation ROUTE 2 (791')

I, the undersigned, hereby certify that this map is correct to the best of my knowledge and belief and shows all the information required by paragraph 600 of the Code and regulations of the oil and gas section of the mining laws of West Virginia.

Chet Waterman

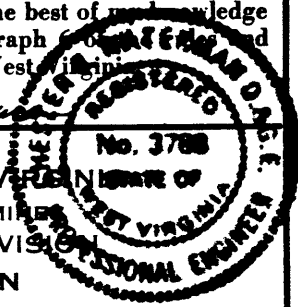

Company BEREA OIL & GAS CORPORATION
 Address BUFFALO, NY
 Surface Owner RICHARD CRAMLET
 Mineral Owner " "

STATE OF WEST VIRGINIA
 DEPARTMENT OF MINES
 OIL AND GAS DIVISION
 CHARLESTON

Well No. 2 Acres 56
 Elevation 860' MARIETTA 15'
 Quadrangle VALLEY MILLS Series 7.5
 County WOOD District UNION
 Date 4/25/80 Scale 1" = 500'

WELL LOCATION MAP

47 - 107 - 1010
 STATE COUNTY PERMIT

CANCELLED

+ Denotes location of well on United States Topographic Maps.

Engineer CHET WATERMAN 2800' GORDON
 Engineer's Registration No. 3788 File No. 80-26984

APR 23 1984

9700' SOUTH
2960' WEST

30'
25'
27'
81° 81°
Longitude

1.865
2.60W

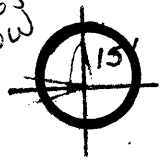

0.54W

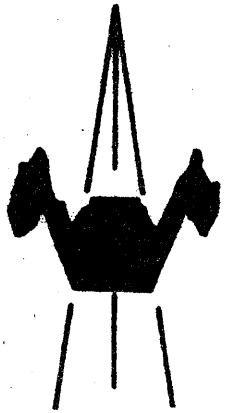
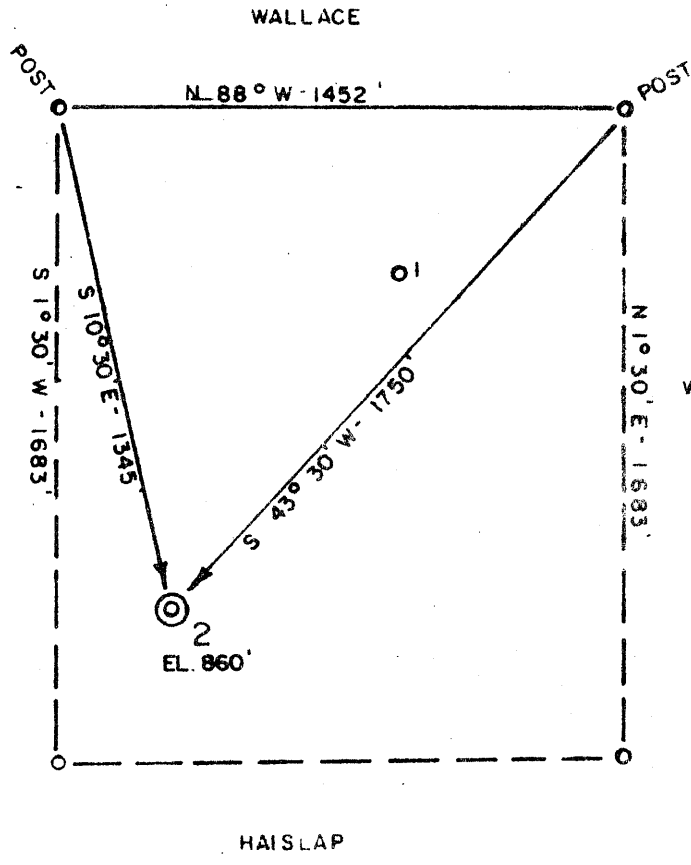

ACCURACY: 1' / 200'

New Location

Drill Deeper

Abandonment

Fracture

Redrill

Other

Formation GORDON Oil

Est. Depth 2800' Gas

Other

Source of Elevation ROUTE 2 (791')

I, the undersigned, hereby certify that this map is correct to the best of my knowledge and belief and shows all the information required by paragraph and regulations of the oil and gas section of the mining laws of West Virginia.

Company BEREA OIL & GAS CORPORATION

Address BUFFALO, NY

Surface Owner RICHARD CRAMLET

Mineral Owner " "

Well No. 2 Acres 56

Elevation 860' MARIETTA 15'

Quadrangle VALLEY MILLS Series 7.5 SW

County WOOD District UNION

Date 4/25/80 Scale 1" = 500'

STATE OF WEST VIRGINIA
DEPARTMENT OF MINES
OIL AND GAS DIVISION
CHARLESTON

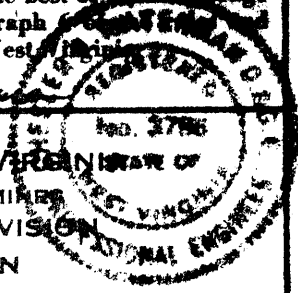

WELL LOCATION MAP

47 - 107 - 1010

STATE COUNTY PERMIT

+ Denotes location of well on United States Topographic Maps.

Engineer CHET WATERMAN 2800' GORDON

Engineer's Registration No. 3788 File No. 80-261

JUN 17 1980



STATE OF WEST VIRGINIA
DEPARTMENT OF MINES

APPROVED

APR 30 1980

Oil and Gas Division
OIL & GAS DIVISION
DEPT. OF MINES
OIL AND GAS WELL PERMIT APPLICATION

TO THE DEPARTMENT OF MINES,
Charleston, W. Va.

DATE April 30, 1980

Surface Owner Richard C. Cramlet Company Berea Oil & Gas Corp.
Address Rt. # 1, Box 185-C, Parkersburg, W. Va. Address See well operator below
Mineral Owner same Farm Cramlet Acres 56
Address _____ Location (waters) Five Mile Run
Coal Owner same Well No. 2 Elevation 860'
Address _____ District Union County Wood
Coal Operator same Quadrangle Valley Mills
Address _____

THIS PERMIT MUST BE POSTED AT THE WELL SITE

provisions being in accordance with Chapter 22, the W. Va. Code, the location is hereby approved for drilling. This permit shall expire if operations have not commenced by 1-13-81.

Robert H. [Signature]

Deputy Director - Oil & Gas Division

INSPECTOR
TO BE NOTIFIED Paul Goodnight
ADDRESS Smithville, W. Va.
PHONE 304-477-3660

GENTLEMEN:

The undersigned well operator is entitled to drill upon the above named farm or tract of land for oil and gas, having fee title thereto, (or as the case may be) under grant or lease dated April 16 1980 by Richard C. Cramlet made to Energy Unlimited, Inc. and recorded on the 17th day of April 1980 in Wood County, Book 736 Page 359

XX NEW WELL _____ DRILL DEEPER _____ REDRILL _____ FRACTURE OR STIMULATE
_____ OIL AND GAS WELL ORIGINALLY DRILLED BEFORE JUNE 5, 1969.

The enclosed plat was prepared by a registered engineer or licensed land surveyor and all coal owners and/or operators have been notified as of the above date.

The above named coal owners and/or operator are hereby notified that any objection they wish to make, or are required to make by Section 3 of the Code, must be received by, or filed with the Department of Mines within ten (10) days. *

Copies of this notice and the enclosed plat were mailed by registered mail, or delivered to the above named coal operators or coal owners at their above shown respective address _____ day _____ before, or on the same day with the mailing or delivery of this copy to the Department of Mines at Charleston, West Virginia.

PLEASE SUBMIT COPIES OF ALL GEOPHYSICAL LOGS DIRECTLY TO:

WEST VIRGINIA GEOLOGICAL AND ECONOMIC SURVEY
P. O. BOX 879
MORGANTOWN, WEST VIRGINIA 26505
AC-304 - 292-6331

Address of Well Operator

Very truly yours, Mark Schumacher
(Sign Name) Mark Schumacher
Well Operator
652 Empire Bank Building
Fourth & Main Streets
Street
Clarksburg
City or Town
W. Va.
State

*SECTION 3... If no objections are filed or found by the Department of mines, within said period of ten days from the receipt of notice and plat by the department of mines; to said proposed location, the department shall forthwith issue to the well operator a permit reciting the filing of such plat, that no objections have been made by the coal operators or found thereto by the department and that the same is approved and the well operator authorized to proceed.

BLANKET BOND

47-107-1010 PERMIT NUMBER

"I have read and understand the reclamation requirements as set forth in Chapter 22, Article 4, Section 12-b and will carry out the specified requirements."

Signed by _____

THIS IS AN ESTIMATE ONLY
ACTUAL INFORMATION WILL BE SUBMITTED ON OG-10 UPON COMPLETION

PROPOSED WORK ORDER TO XX DRILL _____ DEEPEN _____ FRACTURE-STIMULATE _____
 DRILLING CONTRACTOR: (If Known) _____ RESPONSIBLE AGENT: _____
 NAME _____ NAME Mark Schumacher
 ADDRESS _____ ADDRESS Clarksburg, W. Va.
 TELEPHONE _____ TELEPHONE 304-624-6429
 ESTIMATED DEPTH OF COMPLETED WELL: 2800' ROTARY XX CABLE TOOLS _____
 PROPOSED GEOLOGICAL FORMATION: Gordon
 TYPE OF WELL: OIL X GAS X COMB. X STORAGE _____ DISPOSAL _____
 RECYCLING _____ WATER FLOOD _____ OTHER _____

TENTATIVE CASING PROGRAM:

CASING AND TUBING SIZE	USED FOR DRILLING	LEFT IN WELL	CEMENT FILL UP OR SACKS - CUBIC FT.
20 - 16			
13 - 10			
9 - 5/8			
8 - 5/8 XX	250'	250'	Surface
7			
5 1/2			
4 1/2 XX	T. D.	T. D.	400'
3			Perf. Top
2			Perf. Bottom
Liners			Perf. Top
			Perf. Bottom

APPROXIMATE FRESH WATER DEPTHS 150 FEET _____ SALT WATER 1500 FEET _____
 APPROXIMATE COAL DEPTHS None
 IS COAL BEING MINED IN THE AREA? NO BY WHOM? _____

TO DRILL:

SUBMIT FIVE (5) COPIES OF OG - 1, \$100.00 PERMIT FEE, PERFORMANCE BOND AND PERMANENT COPY OF PLAT.

TO DRILL DEEPER OR REDRILL:

SUBMIT FIVE (5) COPIES OF OG - 1, SHOWING ORIGINAL PERMIT NUMBER AND PERFORMANCE BOND. ON WELLS DRILLED PRIOR TO 1929, A PERMANENT COPY OF THE PLAT AND THE ORIGINAL WELL RECORD MUST ALSO BE SUBMITTED.

TO FRACTURE - STIMULATE:

OIL AND/OR GAS WELL ORIGINALLY DRILLED BEFORE JUNE 5, 1929, FIVE (5) COPIES OG - 1, PERFORMANCE BOND, PERMANENT PLAT AND ORIGINAL WELL RECORD.

OIL AND/OR GAS WELL ORIGINALLY DRILLED ON AND/OR AFTER JUNE 5, 1929, FIVE COPIES OG - 1, SHOWING ORIGINAL PERMIT NUMBER, AND PERFORMANCE BOND.

Required forms must be filed within ninety (90) days of completion for bond release. Inspector to be notified twenty-four (24) hours in advance.

The following waiver must be completed by the coal operator if the permit is to be issued within ten days of receipt thereof.

WAIVER: I the undersigned, Agent for _____ Coal Company, Owner or Operator of the coal under this lease have examined and place on our mine maps this proposed well location.

We the _____ Coal Company have no objections to said well being drilled at this location, providing operator has complied with all rules and regulations in Articles 4, 5, and 7, Chapter 22 of the West Virginia Code.

For Coal Company

Official Title