

D 10-30-80

Latitude 39° 20' 00"

11,150' SOUTH
7200' WEST

Longitude 81° 20' 00"

2.125
1.37W
39 18 10
81 21 35

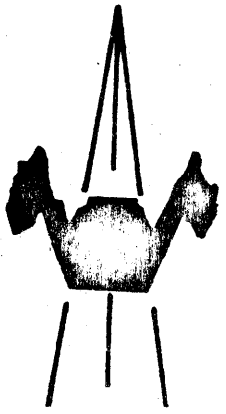
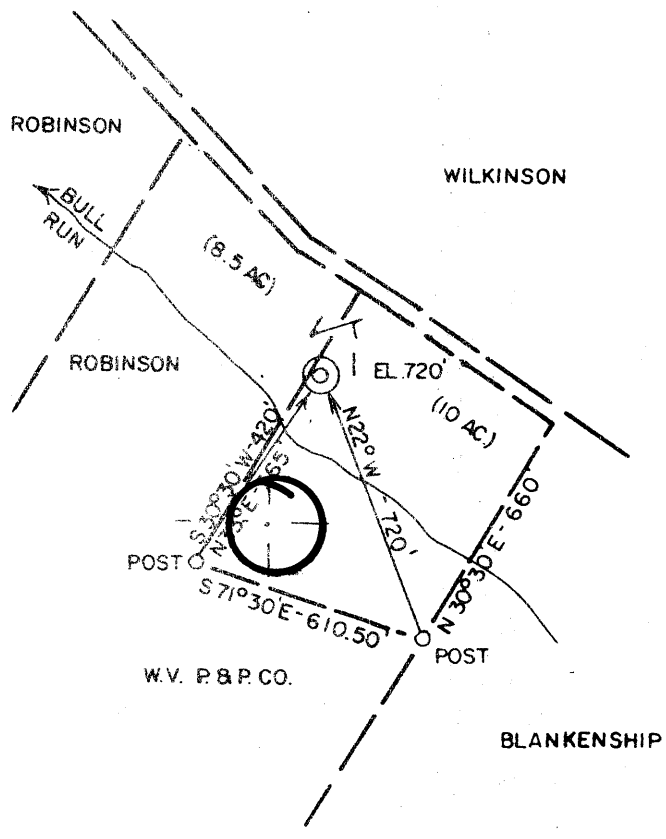

ACCURACY: 1" / 200'

- New Location
- Drill Deeper
- Abandonment
- Fracture
- Redrill
- Other

Formation SYCAMORE GRIT
Est. Depth 3998'

Oil
Gas
Other

Source of Elevation ROUTE 2 (791')

I, the undersigned, hereby certify that this map is correct to the best of my knowledge and belief and shows all the information required by paragraph 6 of the rules and regulations of the oil and gas section of the mining laws of West Virginia.

Chet Waterman

Company ENERGY UNLIMITED
 Address MARIETTA, OH
 Surface Owner E.L. ROBINSON (8.5 ac) E.D. STEPHENS (10 ac)
 Mineral Owner " " " " " " " " " "
 Well No. 1 Acres 18.50'
 Elevation 720' MARIETTA 15' SC
 Quadrangle WILLOW ISLAND Series 7.5'
 County WOOD District UNION
 Date 10/16/80 Scale 1" = 500'

STATE OF WEST VIRGINIA
DEPARTMENT OF MINES
OIL AND GAS DIVISION
CHARLESTON

WELL LOCATION MAP
47 - 107 - 1092
STATE COUNTY PERMIT

+ Denotes location of well on United States Topographic Maps.
 Engineer CHET WATERMAN NOV 25 1980
 Engineer's Registration No. 3788 File No. 80-621

DETAILS OF PERFORATED INTERVALS, FRACTURING OR STIMULATING, PHYSICAL CHANGE, ETC.

Fractured with 50,000# sand, 34,000 gals H2O, 130 mcf nitrogen, treated at 40 BPM and 1950' PSIG

WELL LOG

FORMATION	COLOR	HARD OR SOFT	TOP FEET	BOTTOM FEET	REMARKS Including indication of all fresh and salt water, coal, oil and gas
soil		soft	0'	0'	
shale		soft	10'	48'	
sand		hard	48'	67'	
shale		soft	67'	110'	
sand		hard	110'	133'	fresh water
shale		soft	133'	255'	
sand		hard	255'	308'	
shale		soft	308'	420'	
sand		hard	420'	465'	
shale		soft	465'	591'	
sand		hard	591'	623'	
shale		soft	623'	810'	
sand		hard	810'	845'	
shale		soft	845'	962'	
sand		hard	962'	985'	
shale		soft	985'	1170'	
sand		hard	1170'	1248'	
shale		soft	1248'	1270'	
sand		hard	1270'	1280'	
shale		soft	1280'	1304'	
sand		hard	1304'	1320'	
shale		soft	1320'	1430'	
Maxton		hard	1430'	1480'	salt water
shale		soft	1480'	1526'	
Keener		hard	1526'	1536'	salt water
Big Injun		hard	1536'	1706'	salt water
shale		soft	1706'	1724'	
Squaw		hard	1724'	1732'	
shale		soft	1732'	2094'	
Berea		hard	2094'	2112'	show gas & oil
shale		soft	2112'	2208'	
Gantz		soft	2208'	2214'	
shale		soft	2214'	2320'	
Thirty-foot		soft	2320'	2356'	
shale		soft	2356'	2460'	
Gordon		soft	2460'	2486'	show of gas
shale		soft	2486'	T. D.	T. D. 2631' <i>NEW-TD</i>

(Attach separate sheets as necessary)

Energy Unlimited, Inc
Well Operator
By: *[Signature]*
Date: 8/4/82

Note: Regulation 2.02(i) provides as follows:
"The term 'log' or 'well log' shall mean a systematic detailed geological record of all formations, including coal, encountered in the drilling of a well."



STATE OF WEST VIRGINIA
DEPARTMENT OF MINES

Oil and Gas Division

WELL RECORD

Quadrangle Willow Island

Permit No. #47-107-1092

Rotary X Oil _____
Cable _____ Gas _____
Recycling _____ Comb. X
Water Flood _____ Storage _____
Disposal _____ (Kind)

Company Energy Unlimited, Inc.
Address 427 Second St. Marietta, OH 45750
Farm C. Stephens/E. L. Robinson Acres 18.5
Location (waters) Bull Run
Well No. #1 Elev. 720'
District Union County Wood
The surface of tract is owned in fee by _____
same
Address _____
Mineral rights are owned by Same
Address _____
Drilling Commenced 5/25/81
Drilling Completed 6/20/81
Initial open flow _____ cu. ft. _____ bbls.
Final production 10M cu. ft. per day 4 bbls.
Well open 24 hrs. before test 450 RP.

Casing and Tubing	Used in Drilling	Left in Well	Cement fill up Cu. ft. (Sks.)
Size 20-16			
Cond. 13-10"			
9 5/8			
8 5/8		264	90 SX
7			
5 1/2			
4 1/2		2585.15	250 SX
3			
2			
Liners Used			

Well treatment details:

Attach copy of cementing record.

Fractured with 50,000# sand, 34,000 gals H2O, 130 Nitrogen at 40 BPM and 1950 PSIG

Coal was encountered at None Feet _____ Inches _____
Fresh water _____ Feet _____ Salt Water 1425' Feet _____
Producing Sand Berea Depth 2094' - 2110'

Formation	Color	Hard or Soft	Top Feet	Bottom Feet	Oil, Gas or Water	* Remarks
Sand			1425'	1490'	salt water	Maxton
Sand			1502'	1536'	salt water	Keener
Sand			1540'	1706'	salt water	Big Injun
Shaly Sand & Siltstone			2035'	3039'	little gas	Wells Stray
Sand & Shaly Sand	white	hard	2094'	2110'	fair show of oil & gas	
Shaly Sand			2208'	2213'	little gas	Berea Gantz
Siltstone & Sandy Shale			2330'	2344'	little gas	Thirty-foot
Siltstone & Shale	gray & brown	medium	2450'	2488'	show of gas	<u>Gordon</u>

RECEIVED

SEP 11 1981

OIL AND GAS DIVISION
WV DEPARTMENT OF MINES

SEP 28 1981

Formation	Color	Hard or Soft	Top Feet	Bottom Feet	Oil, Gas or Water	Remarks

Date 9-4 1981

APPROVED [Signature] Owner

By [Signature]



STATE OF WEST VIRGINIA
DEPARTMENT OF MINES

RECEIVED

OCT 29 1980

Oil and Gas Division

OIL & GAS DIVISION
DEPT. OF MINES

OIL AND GAS WELL PERMIT APPLICATION

TO THE DEPARTMENT OF MINES,
Charleston, W. Va.

Surface Owner Charles Stephens/E.L. Robinson
Address Route #1, Waverly, W. Va.
Mineral Owner Same
Address Same
Coal Owner Same
Address Same
Coal Operator None
Address _____

DATE October 28, 1980
Company Energy Unlimited, Inc.
Address 427 Second St., Marietta, Ohio
Farm Stephens/Robinson Acres 18.5
Location (waters) Bull Run
Well No. #1 Elevation 720'
District Union County Wood
Quadrangle Willow Island

THIS PERMIT MUST BE POSTED AT THE WELL SITE

All provisions being in accordance with Chapter 22,
of the W. Va. Code, the location is hereby approved
for drilling. This permit shall expire if
operations have not commenced by 6-30-81.

INSPECTOR
TO BE NOTIFIED Paul Goodnight
ADDRESS Smithville, West Virginia
PHONE 477-2455

J. E. Hurray
Deputy Director Oil & Gas Division

GENTLEMEN:

The undersigned well operator is entitled to drill upon the above named farm or tract of land for oil and gas, having fee title thereto, (or as the case may be) under grant or lease dated September 29 19 80 by Charles Stephens /E.L. Robinson made to Energy Unlimited, Inc. and recorded on the 3 rd day of October 19 80 in Wood County, Book 744/744 Page 703/701 respectively.

XX NEW WELL _____ DRILL DEEPER _____ REDRILL _____ FRACTURE OR STIMULATE
_____ OIL AND GAS WELL ORIGINALLY DRILLED BEFORE JUNE 5, 1969.

The enclosed plat was prepared by a registered engineer or licensed land surveyor and all coal owners and/or operators have been notified as of the above date.

The above named coal owners and/or operator are hereby notified that any objection they wish to make, or are required to make by Section 3 of the Code, must be received by, or filed with the Department of Mines within ten (10) days. *

Copies of this notice and the enclosed plat were mailed by registered mail, or delivered to the above named coal operators or coal owners at their above shown respective address _____ day _____ before, or on the same day with the mailing or delivery of this copy to the Department of Mines at Charleston, West Virginia.

Very truly yours, Douglas M. Galloway
(Sign Name) _____
Well Operator

PLEASE SUBMIT COPIES OF ALL
GEOPHYSICAL LOGS DIRECTLY TO:

WEST VIRGINIA GEOLOGICAL AND
ECONOMIC SURVEY
P. O. BOX 879
MORGANTOWN, WEST VIRGINIA 26505
AC-304 - 292-6331

Address
of
Well Operator

427 Second Street
Street
Marietta
City or Town
Ohio
State

*SECTION 3 If no objections are filed or found by the Department of mines, within said period of ten days from the receipt of notice and plat by the department of mines, to said proposed location, the department shall forthwith issue to the well operator a permit reciting the filing of such plat, that no objections have been made by the coal operators or found thereto by the department and that the same is approved and the well operator authorized to proceed.

47-107-1092

PERMIT NUMBER

"I have read and understand the reclamation requirements as set forth in Chapter 22, Article 4, Section 12-b and will carry out the specified requirements."

Signed by _____

Sumner

THIS IS AN ESTIMATE ONLY
ACTUAL INFORMATION WILL BE SUBMITTED ON OG-10 UPON COMPLETION

PROPOSED WORK ORDER TO XX DRILL _____ DEEPEN _____ FRACTURE-STIMULATE _____
 DRILLING CONTRACTOR: (If Known) _____ RESPONSIBLE AGENT: _____
 NAME NA _____ NAME David Clovis _____
 ADDRESS _____ ADDRESS Union Trust Bldg, Parkersburg, WVa _____
 TELEPHONE _____ TELEPHONE 485-4403 _____
 ESTIMATED DEPTH OF COMPLETED WELL: 4000' _____ ROTARY X _____ CABLE TOOLS _____
 PROPOSED GEOLOGICAL FORMATION: Sycamore Grit _____
 TYPE OF WELL: OIL X _____ GAS X _____ COMB. X _____ STORAGE _____ DISPOSAL _____
 RECYCLING _____ WATER FLOOD _____ OTHER _____

TENTATIVE CASING PROGRAM:

CASING AND TUBING SIZE	USED FOR DRILLING	LEFT IN WELL	CEMENT FILL UP OR SACKS - CUBIC FT.
20 - 16			
13 - 10			
9 - 5/8			
8 - 5/8 <u>XX</u>	250'	250'	<i>Conduit to Surface</i>
7			
5 1/2			
4 1/2 <u>XX</u>	TD	TD	1200' <i>or to reglets</i>
3			Perf. Top <i>of rule 15.01</i>
2			Perf. Bottom
Liners			Perf. Top
			Perf. Bottom

APPROXIMATE FRESH WATER DEPTHS 150 FEET _____ SALT WATER 1500' FEET _____
 APPROXIMATE COAL DEPTHS NA _____
 IS COAL BEING MINED IN THE AREA? No BY WHOM? _____

TO DRILL:
 SUBMIT FIVE (5) COPIES OF OG - 1, \$100.00 PERMIT FEE, PERFORMANCE BOND AND PERMANENT COPY OF PLAT.

TO DRILL DEEPER OR REDRILL:
 SUBMIT FIVE (5) COPIES OF OG - 1, SHOWING ORIGINAL PERMIT NUMBER AND PERFORMANCE BOND. ON WELLS DRILLED PRIOR TO 1929, A PERMANENT COPY OF THE PLAT AND THE ORIGINAL WELL RECORD MUST ALSO BE SUBMITTED.

TO FRACTURE - STIMULATE:
 OIL AND/OR GAS WELL ORIGINALLY DRILLED BEFORE JUNE 5, 1929, FIVE (5) COPIES OG - 1, PERFORMANCE BOND, PERMANENT PLAT AND ORIGINAL WELL RECORD.
 OIL AND/OR GAS WELL ORIGINALLY DRILLED ON AND/OR AFTER JUNE 5, 1929, FIVE COPIES OG - 1, SHOWING ORIGINAL PERMIT NUMBER, AND PERFORMANCE BOND.
 Required forms must be filed within ninety (90) days of completion for bond release. Inspector to be notified twenty-four (24) hours in advance.

The following waiver must be completed by the coal operator if the permit is to be issued within ten days of receipt thereof.

WAIVER: I the undersigned, Agent for _____ Coal Company, Owner or Operator of the coal under this lease have examined and place on our mine maps this proposed well location.
 We the _____ Coal Company have no objections to said well being drilled at this location, providing operator has complied with all rules and regulations in Articles 4, 5, and 7, Chapter 22 of the West Virginia Code.

 For Coal Company

 Official Title