

4,700' SOUTH
5,460' WEST

A TO 3 = S 59° E - 1650'
B TO 3 = N 63° 45' E - 2780'

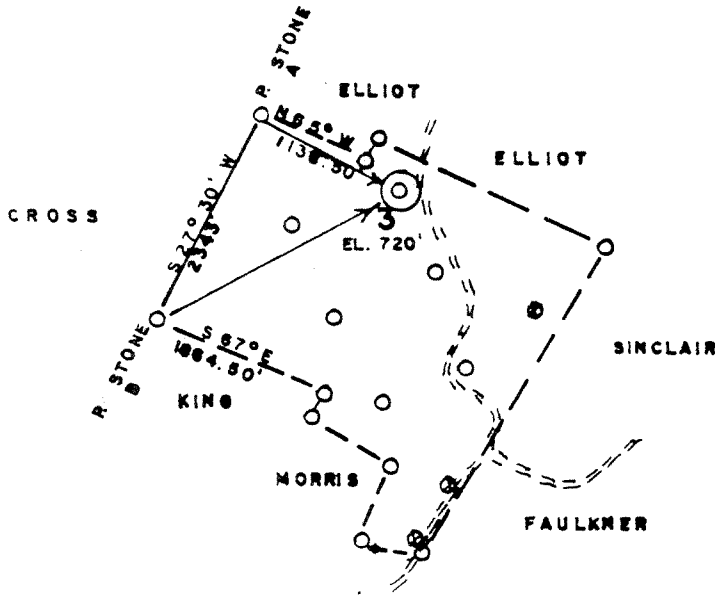

⊗ = OLD WELL
○ = PROPOSED WELL

ACCURACY: 1 / 200

New Location
Drill Deeper
Abandonment
Fracture
Redrill
Other

Formation GORDON
Est. Depth 2800'

Oil
Gas
Other

Source of Elevation ROAD INTERSECTIONS
I, the undersigned, hereby certify that this map is correct to the best of my knowledge and belief and shows all the information required by paragraph 6 of the Act and regulations of the oil and gas section of the mining laws of West Virginia.

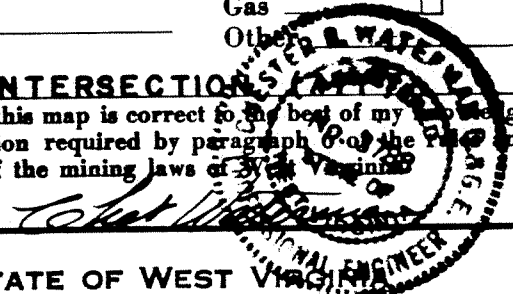

Company BEREA OIL & GAS CORP
Address CLARKSBURG, WV
Surface Owner P. J. CORBITT, JR.
Mineral Owner R. N. CORBITT HEIRS

STATE OF WEST VIRGINIA
DEPARTMENT OF MINES
OIL AND GAS DIVISION
CHARLESTON

Well No. 3 Acres 230.25
Elevation 720'
Quadrangle VALLEY MILLS Series 7.5
County WOOD District UNION
Date 12/4/80 Scale 1" = 2000'

WELL LOCATION MAP

47 - 107 - 1126
STATE COUNTY PERMIT

CANCELLED

+ Denotes location of well on United States Topographic Maps.
Engineer CHET WATERMAN 80-724
Engineer's Registration No. 3788 File No.

MAR 26 1984

de 1/5

Not Card CSD

Latitude 39° 20' 00"

4,700' SOUTH
5,460' WEST

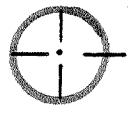
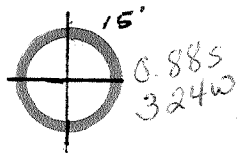

A TO 3 = S 59° E - 1650'
B TO 3 = N 63° 45' E - 2780'

Longitude 81° 22' 30"
81° 20'

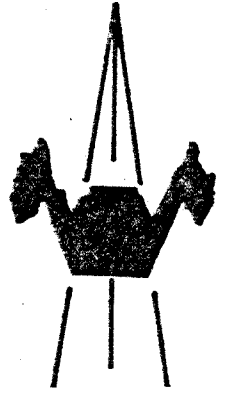
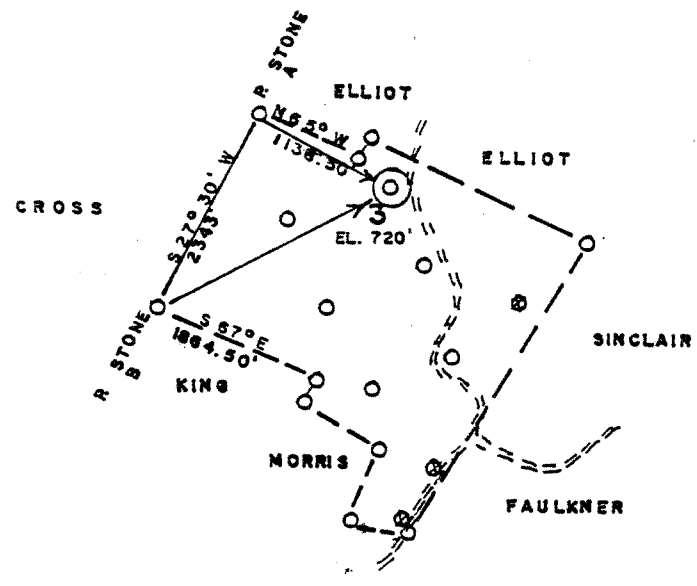

⊗ = OLD WELL
○ = PROPOSED WELL

ACCURACY: 1/200

New Location
Drill Deeper
Abandonment
Fracture
Redrill
Other

Formation GORDON
Est. Depth 2800'

Oil
Gas
Other

Source of Elevation ROAD INTERSECTION (771')
I, the undersigned, hereby certify that this map is correct to the best of my knowledge and belief and shows all the information required by paragraph 6 of the rules and regulations of the oil and gas section of the mining laws of West Virginia.

Chet Waterman

Company BEREA OIL & GAS CORP.
Address CLARKSBURG, WV
Surface Owner P. J. CORBITT, JR.
Mineral Owner R. N. CORBITT HEIRS
Well No. 3 Acres 230.25
Elevation 720'
Quadrangle VALLEY MILLS Series 7.5 *manetta 15' SC*
County WOOD District UNION
Date 12/4/80 Scale 1" = 2000'

STATE OF WEST VIRGINIA
DEPARTMENT OF MINES
OIL AND GAS DIVISION
CHARLESTON
WELL LOCATION MAP
47 - 107 - 1126
STATE COUNTY PERMIT
+ Denotes location of well on United States Topographic Maps.
Engineer CHET WATERMAN 80-724
Engineer's Registration No. 3788 File No.

JAN 26 1981



STATE OF WEST VIRGINIA
DEPARTMENT OF MINES

RECEIVED

JAN - 2 1981

Oil and Gas Division

OIL & GAS DIVISION
DEPT. OF MINES

OIL AND GAS WELL PERMIT APPLICATION

TO: THE DEPARTMENT OF MINES
Charleston, W. Va.

Surface Owner P. J. Corbitt, Jr.
Address Rt. 1, Waverly, WV 26184
Mineral Owner R. N. Corbitt Heirs
Address Rt. 1, Waverly, WV 26184
Coal Owner N/A
Address _____
Coal Operator N/A
Address _____

DATE December 24, 1980
Company Berea Oil and Gas Corporation
Address 652 Empire Bank Bldg., Clarksburg, WV 26301
Farm Corbitt Acres 230.25
Location (waters) Bull Run
Well No. 3 Elevation 720'
District Union County Wood
Quadrangle Valley Mills

THIS PERMIT MUST BE POSTED AT THE WELL SITE

provisions being in accordance with Chapter 22, the W. Va. Code, the location is hereby approved for drilling. This permit shall expire if operations have not commenced by 9-6-81.

INSPECTOR TO BE NOTIFIED Paul Goodnight
ADDRESS Smithville, WV 26178
PHONE 304/477-3660

J. J. Murray
Deputy Director Oil & Gas Division

GENTLEMEN:

The undersigned well operator is entitled to drill upon the above named farm or tract of land for oil and gas, having fee title therein (in the case may be) under grant or lease dated November 15, 1980 by H. D. Wells Oil & Gas Exploration & Dev., Inc. to Berea Oil & Gas Corp. and recorded on the 17th day of November 1980 in Wood County, Book 747 Page 206

NEW WELL DRILL-DEEPER REDRILL FRACTURE OR STIMULATE
OIL AND GAS WELL ORIGINALLY DRILLED BEFORE JUNE 5, 1969.

The enclosed plat was prepared by a registered engineer or licensed land surveyor and all coal owners and/or operators have been notified of the above date.

The above named coal owners and/or operator are hereby notified that any objection they wish to make, or are required to make by Section 3 of the Code, must be received by, or filed with the Department of Mines within ten (10) days.*

Copies of this notice and the enclosed plat were mailed by registered mail, or delivered to the above named coal operators or co-owners at their above shown respective address _____ day _____ before, or on the same day as the mailing or delivery of this copy to the Department of Mines at Charleston, West Virginia.

PLEASE RETURN COPIES OF ALL GEOPHYSICAL LOGS DIRECTLY TO:

WEST VIRGINIA GEOLOGICAL AND ECONOMIC SURVEY
P. O. BOX 379
MORGANTOWN, WEST VIRGINIA 26505
AC-304 - 292-5331

Very truly yours,

(Sign Name) M. V. Schwaner
Well Operator

Address of Well Operator

BEREA OIL AND GAS CORPORATION
652 Empire Bank Building
Street
Fourth & Main Streets
Clarksburg
City or Town
West Virginia 26301
State

*Should no objections are filed or found by the Department of mines, within said period of ten days from the receipt of notice and plat by the Department of mines, to said proposed location, the department shall forthwith issue to the well operator a permit reciting the filing of such plat, that no objections have been made by the coal operators or found thereto by the department and that the same is approved and the well operator authorized to proceed.

47-107-1126

PERMIT NUMBER

"I have read and understand the reclamation requirements as set forth in Chapter 22, Article 3, Section 12 b and will carry out the specified requirements."

Signed by M. V. Schwaner

SECRET BOND

THIS IS AN ESTIMATE ONLY
ACTUAL INFORMATION WILL BE SUBMITTED ON OG-10 UPON COMPLETION

PROPOSED WORK ORDER TO XX DRILL _____ DEEPEN _____ FRACTURE STIMULATE _____
 DRILLING CONTRACTOR: (If Known) _____ RESPONSIBLE AGENT _____
 NAME N/A _____ NAME Mark Schumacher _____
 ADDRESS _____ ADDRESS 652 Empire Bank Bldg., Clarksburg, WV _____
 TELEPHONE _____ TELEPHONE 304/624-6429 _____
 ESTIMATED DEPTH OF COMPLETED WELL: 2800' _____ ROTARY XX CABLE TOOLS _____
 PROPOSED GEOLOGICAL FORMATION: Gordon _____
 TYPE OF WELL: OIL X GAS _____ COMB X STORAGE _____ DISPOSAL _____
 RECYCLING _____ WATER FLOOD _____ OTHER _____

TENTATIVE CASING PROGRAM

CASING AND TUBING SIZE	USED FOR DRILLING	LEFT IN WELL	CEMENT FILL UP OR SACKS (CUBIC FT)
20" 16'			
13" 10'			
9" 5.5'			
8" 3.5' <u>XX</u>	250'	250'	Surface
7"			
5.5"			
4" <u>XX</u>	T.D.	T.D.	8" 100' or as reqd. by rule 15.01
3"			Perf. Top _____ Perf. Bottom _____
2"			Perf. Top _____ Perf. Bottom _____
1.5"			

APPROXIMATE FRESH WATER DEPTHS 150 FEET SALT WATER 1500 FEET

APPROXIMATE COAL DEPTHS None

IS COAL BEING MINED IN THE AREA? No BY WHOM? _____

TO DRILL:

SUBMIT FIVE (5) COPIES OF OG - 1, \$100.00 PERMIT FEE, PERFORMANCE BOND AND PERMANENT COPY OF PLAT.

TO DRILL DEEPER OR REDRILL:

SUBMIT FIVE (5) COPIES OF OG - 1, SHOWING ORIGINAL PERMIT NUMBER AND PERFORMANCE BOND. ON WELLS DRILLED PRIOR TO 1929, A PERMANENT COPY OF THE PLAT AND THE ORIGINAL WELL RECORD MUST ALSO BE SUBMITTED.

TO FRACTURE - STIMULATE:

OIL AND/OR GAS WELL ORIGINALLY DRILLED BEFORE JUNE 5, 1929, FIVE (5) COPIES OG - 1, PERFORMANCE BOND PERMANENT PLAT AND ORIGINAL WELL RECORD.

OIL AND/OR GAS WELL ORIGINALLY DRILLED ON AND/OR AFTER JUNE 5, 1929, FIVE COPIES OG - 1, SHOWING ORIGINAL PERMIT NUMBER AND PERFORMANCE BOND.

Required forms must be filed within ninety (90) days of completion for bond release. Inspector to be notified four (24) hours in advance.

The following waiver must be completed by the coal operator if the permit is to be issued within ten days of receipt thereof.

WAIVER: I the undersigned, Agent for _____ Coal Company, Owner or Operator of the coal under this lease have examined and place on our mine maps this proposed well location.

We the _____ Coal Company have no objections to said well being drilled at this location, providing operator has complied with all rules and regulations in Articles 4, 5, and 7, Chapter 22 of the West Virginia Code.

For Coal Company

Official Title