

Ch 1/5

Card CSD

Latitude 39° 20' 00"

6050' SOUTH
6090' WEST

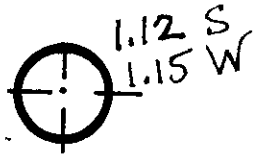
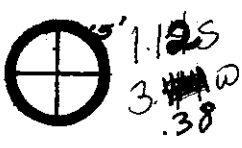

Longitude 81° 22' 30"
81° 20'

A TO B = S 18° E - 2270'
B TO S = S 87° 30' E - 1785'

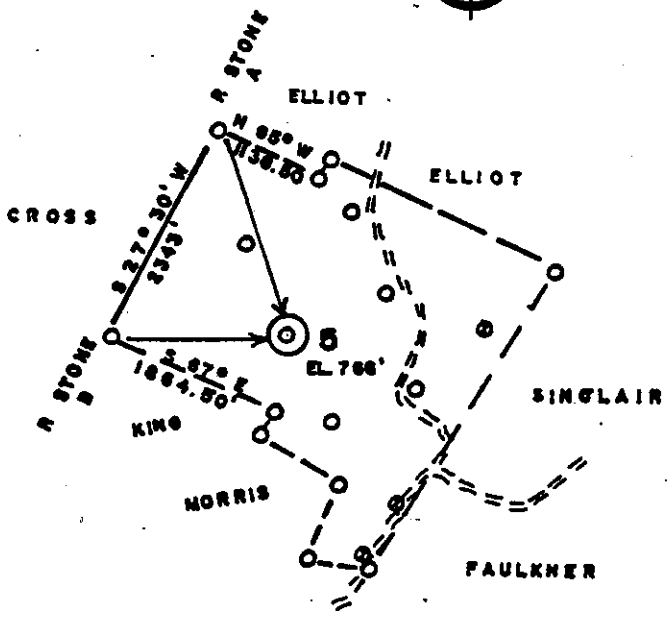

⊙ = OLD WELL
○ = PROPOSED WELL

ACCURACY: 1 / 200

New Location
Drill Deeper
Abandonment
Fracture
Redrill
Other

Formation GORDON Oil
Est. Depth 2800' Gas
Other

Source of Elevation ROAD INTERSECTION (771)
I, the undersigned, hereby certify that this map is correct to the best of my knowledge and belief and shows all the information required by paragraphs 6 of the Rules and regulations of the oil and gas section of the mining laws of West Virginia.

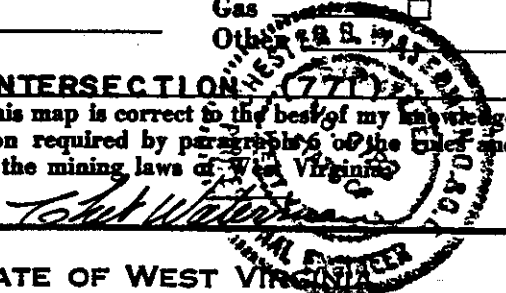

Company BEREA OIL & GAS CORP.
Address CLARKSBURG, WV
Surface Owner P. J. CORBITT, JR.
Mineral Owner R. N. CORBITT HEIRS
Well No. 5 Acres 230.25
Elevation 766' SC MT. 15'
Quadrangle VALLEY MILLS Series 7.5
County WOOD District UNION
Date 12/4/80 Scale 1" = 2000'

STATE OF WEST VIRGINIA
DEPARTMENT OF MINES,
OIL AND GAS DIVISION
CHARLESTON

WELL LOCATION MAP
47 - 107 - 1128-P
STATE COUNTY PERMIT

+ Denotes location of well on United States Topographic Maps.
Engineer CHET WATERMAN 80-726
Engineer's Registration No. 3788 File No.

FEB 24 1981

Ch 1/5

Latitude 39° 20' 00"

6050' SOUTH
6090' WEST

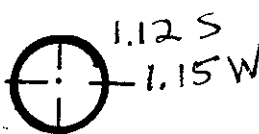
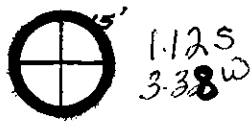

39 1900
81 2345

Longitude 81° 22' 30"
81° 20'

A TO B = S 18° E - 2270'
B TO C = S 87° 30' E - 1785'

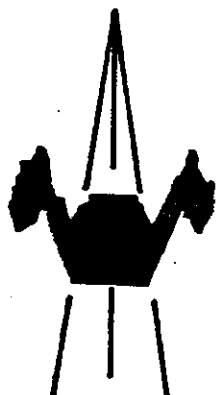
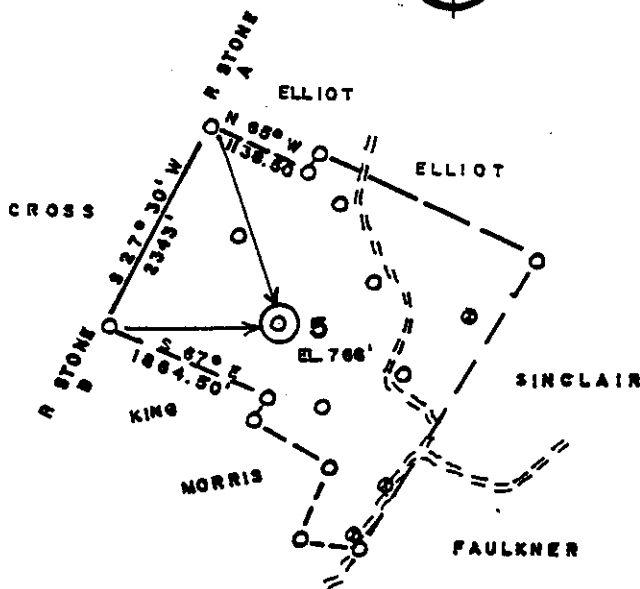

⊙ = OLD WELL
○ = PROPOSED WELL

ACCURACY: 1 / 200

New Location
 Drill Deeper
 Abandonment
 Fracture
 Redrill
 Other

Formation GORDON Oil
 Est. Depth 2800' Gas
 Other

Source of Elevation ROAD INTERSECTION (771)
 I, the undersigned, hereby certify that this map is correct to the best of my knowledge and belief and shows all the information required by paragraphs 6 of the rules and regulations of the oil and gas section of the mining laws of West Virginia.

Company BEREA OIL & GAS CORP.
 Address CLARKSBURG, WV
 Surface Owner P. J. CORBITT, JR.
 Mineral Owner R. N. CORBITT HEIRS
 Well No. 5 Acres 230.25
 Elevation 766'
 Quadrangle VALLEY MILLS Series Marion 15' 50'
 County WOOD District UNION
 Date 12/4/80 Scale 1" = 2000'

STATE OF WEST VIRGINIA
 DEPARTMENT OF MINES
 OIL AND GAS DIVISION
 CHARLESTON

WELL LOCATION MAP
47 - 107 - 1128 PVA
 STATE COUNTY PERMIT

+ Denotes location of well on United States Topographic Maps.
 Engineer CHET WATERMAN 80-726
 Engineer's Registration No. 3788 File No.

E-O Hendershot-Ogden (72)

JAN 26 1981



STATE OF WEST VIRGINIA
DEPARTMENT OF MINES

Oil and Gas Division
WELL RECORD

RECEIVED
FEB 17 1981
OIL & GAS DIV.
DEPT. OF MINES

Oil _____
Gas _____
Cable _____
Recycling _____ Comb. xxx
Water Flood _____ Storage _____
Disposal _____ (Kind) _____

Quadrangle Valley Mills

Permit No. 47-107-1128

Company Berea Oil & Gas Corp.
Address 652 Empire Bank Bldg. Clarksburg WV
Farm Corbitt Acres 230.25
Location (waters) Bull Run
Well No. 5 Elev. 766'
District Union County Wood

The surface of tract is owned in fee by P.J. Corbitt, Jr.
Address Rt. 1, Waverly, WV 26184

Mineral rights are owned by R.N. Corbitt Heirs
Address Rt. 1 Waverly, WV

Drilling Commenced 1/4/81
Drilling Completed 1/18/81
Initial open flow _____ cu. ft. _____ bbls.
Final production _____ cu. ft. per day _____ bbls.
Well open _____ hrs. before test _____ RP.

Well treatment details:

1/20/81 Well Plugged and Abandoned.

Casing and Tubing	Used in Drilling	Left in Well	Cement fill up Cu. ft. (Sks.)
Size 20-16			
Cond. 13-10"			
9 5/8			
8 5/8	272		
7			
5 1/2			
4 1/2	2650'	--	
3			
2			
Liners Used			

Attach copy of cementing record.

Coal was encountered at _____ Feet _____ Inches
Fresh water 40 Feet _____ Salt Water _____ Feet
Producing Sand _____ Depth _____

Formation	Color	Hard or Soft	Top Feet	Bottom Feet	Oil, Gas or Water	* Remarks
Sand and Shale			Surface	1186		
Injun			1186	1320		
Berea			1320	1487		
Sand and Shale			1487	1581		
Gordon ✓			1581	1725		
Sand and Shale			1725	2650		
	TD			2650		

Speckley →

off T.D. 1/20/81

1981

Formation	Color	Hard or Soft	Top Feet	Bottom Feet	Oil, Gas or Water	Remarks

Date February 13 1981

APPROVED Berea Oil & Gas Corp. Owner

By M. V. Schumacher, V.P.
(T112)



STATE OF WEST VIRGINIA
DEPARTMENT OF MINES

RECEIVED

JAN - 2 1981

Oil and Gas Division

OIL & GAS DIVISION
DEPT. OF MINES

OIL AND GAS WELL PERMIT APPLICATION

TO THE DEPARTMENT OF MINES,
Charleston, W. Va.

DATE December 24, 1980

Surface Owner P. J. Corbitt, Jr.
Address Rt. 1, Waverly, WV 26184
Mineral Owner R. N. Corbitt Heirs
Address Rt. 1, Waverly, WV 26184
Coal Owner N/A
Address _____
Coal Operator N/A

Company Berea Oil and Gas Corporation
Address 652 Empire Bank Bldg., Clarksburg, WV 26301
Farm Corbitt Acres 230.25
Location (waters) Bull Run
Well No. 5 Elevation 765'
District Union County Wood
Quadrangle Valley Mills

THIS PERMIT MUST BE POSTED AT THE WELL SITE

All provisions being in accordance with Chapter 22, of the W. Va. Code, the location is hereby approved for drilling. This permit shall expire if operations have not commenced by 9-6-81.

INSPECTOR
TO BE NOTIFIED Paul Goodnight
ADDRESS Smithville, WV 26178
PHONE 304/477-3660

J. M. Murray
Deputy Director Oil & Gas Division

GENTLEMEN:

The undersigned well operator is entitled to drill upon the above named farm or tract of land for oil and gas, having fee title thereon (or as the case may be) under grant or lease dated November 15 19 80 by H. D. Wells Oil & Gas Exploration & Dev. made to Berea Oil & Gas Corp. and recorded on the 17th day of November 19 80 in Wood County, Book 747 Page 206

NEW WELL DRILL DEEPER REDRILL FRACTURE OR STIMULATE
OIL AND GAS WELL ORIGINALLY DRILLED BEFORE JUNE 5, 1969.

The enclosed plat was prepared by a registered engineer or licensed land surveyor and all coal owners and/or operators have been notified of the above date.

The above named coal owners and/or operator are hereby notified that any objection they wish to make, or are required to make by Section 3 of the Code, must be received by, or filed with the Department of Mines within ten (10) days. *

Copies of this notice and the enclosed plat were mailed by registered mail, or delivered to the above named coal operators or coal owners at their above shown respective address _____ day _____ before, or on the same day with the mailing or delivery of this copy to the Department of Mines at Charleston, West Virginia.

Very truly yours,

(Sign Name) M. U. Schwocher
Well Operator
BEREA OIL AND GAS CORPORATION
652 Empire Bank Building
Street
Fourth & Main Streets
City or Town
Clarksburg
West Virginia 26301
State

PLEASE SUBMIT COPIES OF ALL
GEOPHYSICAL LOGS DIRECTLY TO:

WEST VIRGINIA GEOLOGICAL AND
ECONOMIC SURVEY
P. O. BOX 879
MORGANTOWN, WEST VIRGINIA 26505
AC-304 - 292-6331

Address
of
Well Operator

*SECTION 3. If no objections are filed or found by the Department of mines, within said period of ten days from the receipt of notice and plat by the department of mines, to said proposed location, the department shall forthwith issue to the well operator a permit reciting the filing of such plat, that no objections have been made by the coal operators or found thereto by the department and that the same is approved and the well operator authorized to proceed.

47-107-1128

PERMIT NUMBER

"I have read and understand the reclamation requirements as set forth in Chapter 22, Article 4, Section 12-b and will carry out the specified requirements."

Signed by M. U. Schwocher

BLANKET BOND

**THIS IS AN ESTIMATE ONLY
ACTUAL INFORMATION WILL BE SUBMITTED ON OG-10 UPON COMPLETION**

PROPOSED WORK ORDER TO XX DRILL _____ DEEPEN _____ FRACTURE STIMULATE _____
 DRILLING CONTRACTOR: (If Known) _____ RESPONSIBLE AGENT: _____
 NAME N/A _____ NAME Mark Schumacher _____
 ADDRESS _____ ADDRESS 652 Empire Bank Bldg., Clarksburg, WV _____
 TELEPHONE _____ TELEPHONE 304/624-6429 _____
 ESTIMATED DEPTH OF COMPLETED WELL: 2800' ROTARY XX CABLE TOOLS _____
 PROPOSED GEOLOGICAL FORMATION: Gordon _____
 TYPE OF WELL OIL X GAS X COMB. X STORAGE _____ DISPOSAL _____
 RECYCLING _____ WATER FLOOD _____ OTHER _____

TENTATIVE CASING PROGRAM:

CASING AND TUBING SIZE	USED FOR DRILLING	LEFT IN WELL	CEMENT FILL UP OR SACKS - CUBIC FT.
20 - 16			
13 - 10			
9 - 5/8			
8 - 5/8 <u>XX</u>	250'	250'	Surface
7			
5 1/2			
4 1/2 <u>XX</u>	T.D.	T.D.	800' or to depth of rule 15.01
3			Perf. Top
2			Perf. Bottom
1 1/2			Perf. Top
1			Perf. Bottom

APPROXIMATE FRESH WATER DEPTHS 150 FEET SALT WATER 1500 FEET
 APPROXIMATE COAL DEPTHS None
 IS COAL BEING MINED IN THE AREA? No BY WHOM? _____

TO DRILL:

SUBMIT FIVE (5) COPIES OF OG - 1, \$100.00 PERMIT FEE, PERFORMANCE BOND AND PERMANENT COPY OF PLAT.

TO DRILL DEEPER OR REDRILL:

SUBMIT FIVE (5) COPIES OF OG - 1, SHOWING ORIGINAL PERMIT NUMBER AND PERFORMANCE BOND. ON WELLS DRILLED PRIOR TO 1929, A PERMANENT COPY OF THE PLAT AND THE ORIGINAL WELL RECORD MUST ALSO BE SUBMITTED.

TO FRACTURE - STIMULATE:

OIL AND/OR GAS WELL ORIGINALLY DRILLED BEFORE JUNE 5, 1929, FIVE (5) COPIES OG - 1, PERFORMANCE BOND, PERMANENT PLAT AND ORIGINAL WELL RECORD.

OIL AND/OR GAS WELL ORIGINALLY DRILLED ON AND/OR AFTER JUNE 5, 1929, FIVE COPIES OG - 1, SHOWING ORIGINAL PERMIT NUMBER, AND PERFORMANCE BOND.

Required forms must be filed within ninety (90) days of completion for bond release. Inspector to be notified twenty four (24) hours in advance.

The following waiver must be completed by the coal operator if the permit is to be issued within ten days of receipt thereof.

WAIVER: I the undersigned, Agent for _____ Coal Company, Owner or Operator of the coal under this lease have examined and place on our mine maps this proposed well location.

We the _____ Coal Company have no objections to said well being drilled at this location, providing operator has complied with all rules and regulations in Articles 4, 5, and 7, Chapter 22 of the West Virginia Code.

For Coal Company

Official Title