

Latitude

37 32 30

0.245  
0.17w

0625  
7.5' loc  
102 7/16/1999

8145

Longitude

Topo Location

7.5' Loc. \_\_\_\_\_ 15' Loc. 3.125  
\_\_\_\_\_ (calc.) 0.17w

Company \_\_\_\_\_

Farm \_\_\_\_\_

15' Quad Gilbert SE  
(sec.) \_\_\_\_\_

7.5' Quad Gilbert  
\_\_\_\_\_

District \_\_\_\_\_

WELL LOCATION PLAT

County 109 Permit 16

DEEP WELL

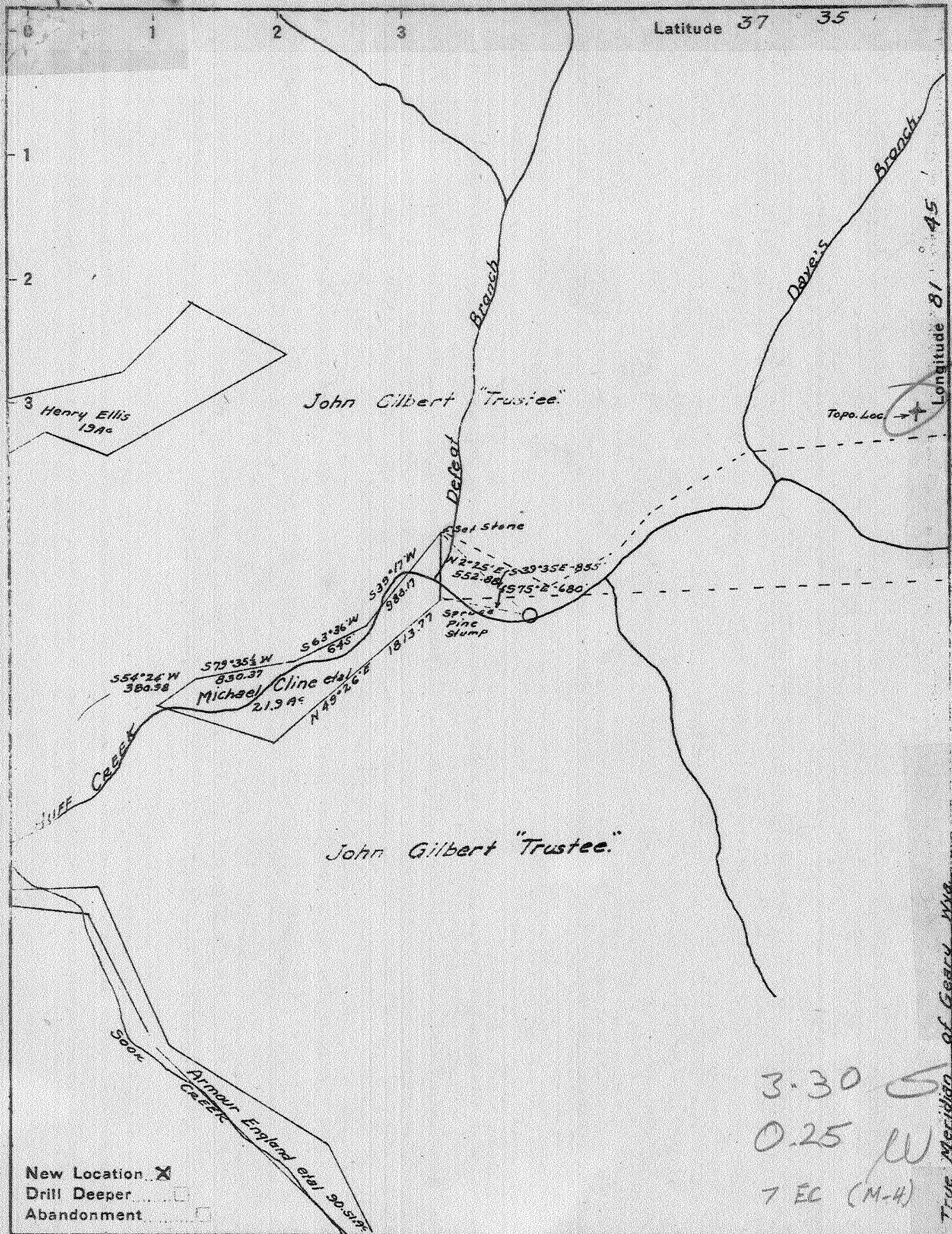

New Location  X  
 Drill Deeper   
 Abandonment

3.30 S  
 0.25 W  
 7 EC (M-H)

Company GODFREY L. CABOT INC  
 Address 900 UNION BLDG CHARLESTON WVA  
 Farm John Gilbert et al (Trustees)  
 Tract \_\_\_\_\_ Acres 16548 Lease No. \_\_\_\_\_  
 Well (Farm) No. 1 Serial No. 1068  
 Elevation (Spirit Level) 1158.0  
 Quadrangle Gilbert & SE. Gilbert 75'  
 County Wyoming District Huff Creek  
 Engineer Roy Boston  
 Engineer's Registration No. \_\_\_\_\_  
 File No. \_\_\_\_\_ Drawing No. \_\_\_\_\_  
 Date 9-15-42 Scale 1" = 1000'

STATE OF WEST VIRGINIA  
 DEPARTMENT OF MINES  
 OIL AND GAS DIVISION  
 CHARLESTON

WELL LOCATION MAP  
 FILE NO. Wyo-16

+ Denotes location of well on United States Topographic Maps, scale 1 to 62,500, latitude and longitude lines being represented by border lines as shown.  
 - Denotes one inch spaces on border line of original tracing.

Imperial Tracing Cloth  
 See Vol. XVI, p. 717  
 Samples 9-C (27-6002') Deep Well E

WEST VIRGINIA DEPARTMENT OF MINES  
OIL & GAS DIVISION  
W E L L R E C O R D

Permit No. Wyo 16  
Gilbert Quad.  
Company  
Address  
Farm  
Location  
Well No  
District  
Surface  
Mineral  
Commenced  
Completed  
Volume  
Not shot  
Fresh Water

Godfrey L. Cabot, Inc.  
Charleston, W.Va.  
John Gilbert Trustee      Acres 16.548  
#1 Ser. 1068      Elev. 1158'  
Huff Creek      Wyoming County  
Sept. 26, 1942  
April 15, 1943  
Dry Hole  
60' H.F.

Dry Hole  
CASING & TUBING

16      27  
13 3/8 273  
10 3/4 1239      Shoe  
8 5/8 2655      Shoe  
7      5770      Shoe &  
8 bags cement.  
Not tubed

Drift	0	27	Slate	2326	2350
Black Lime	27	60	Lime	2350	2370
Granite	60	70	Slate & Shells	2370	2535
Lime	70	92	Big Lime	2535	2889
Sand	92	145	Injun Sand	2889	2933
Lime	145	265	Slate & Shells	2933	3455
Sand	265	368	Brown Shale	3455	3472
Coal	368	370	Berea Sand	3472	3533
Sand	370	452	Slate & Shells	3533	4530
Slate	452	455	Hard Black Lime	4530	4700
Sand	455	460	Slate & Shells	4700	4800
Black Lime	460	466	Brown Slate	4800	5060
Sand	466	480	White Slate	5060	5390
Slate & Shells	480	505	Black Slate	5390	5670
Lime	505	510	Slate & Shells	5670	5747
Sand	510	525	Corniferous Lime	5747	5775
Sand Shells	525	551	Sand	5775	5787
Black Lime	551	564	Corniferous Lime	5787	5847
Sand	564	713	Sand & Lime(Oriskany ?)	5847	5862
Coal	713	715	Lime & Chert	5862	5905
Lime	715	722	Black Shale & Lime	5905	6002SLM
Slate & Shells	722	735	TOTAL DEPTH		6002
Lime	735	825			
Sand	825	950			
Lime	950	962	All sand dry below Berea Sand.		
Slate	962	967	SLM 2655'		
Lime	967	1006			
Gritty Lime	1006	1021	713-715 Probably coal and show of gas.		
Sand	1021	1032	No test.		
Coal	1032	1033			
Lime	1033	1035			
Sand	1035	1040			
Slate & Shells	1040	1065			
Lime	1065	1095			
Slate	1095	1105			
Sand	1105	1108			
Black Lime	1108	1150			
Gritty Lime	1150	1180			
Red Rock	1180	1283	Cave. Hart Gritty Lime.		
Slate & Shells	1283	1288	Cave. Red Rock 1283-88		
Red Rock	1288	1648			
Slate & Shells	1648	1675			
Sand	1675	1751			
Red Rock	1751	1804			
Slate & Shells	1804	1810			
Sand	1810	2014			
Red Rock	2014	2070	Gas 2025 No Test.		
Slate & Shells	2070	2110			
Lime	2110	2248			
Sand	2248	2278	Gas 3520. Show in Berea. No test.		
	2278	2326			

5747  
1158  
-----  
4589

5775  
1158  
-----  
4617

WEST VIRGINIA DEPARTMENT OF MINES  
OIL & GAS DIVISION  
W E L L R E C O R D

Permit No. WYO 16-R

Dry Hole

Company	Godfrey L. Cabot, Inc.		CASING & TUBING
Farm	John Gilbert, Trustee		
Well No.	1068 Elev. 1158	13	299 299
District	Huff Creek County - Wyoming	6"	1452 ---
Commenced	1/10/52		
Completed	5/10/52		
Date Shot	5/15/52 from 3471 to 3527		
With	230 Qts.		

Drift	0	27	Gritty Lime	1100	1263
Black Lime	27	60	Red Rock	1263	1268
Granite	60	70	Slate & Shells	1268	1648
Lime	70	92	Red Rock	1648	1675
Sand	92	145	Slate & Shells	1675	1751
Lime	145	265	Sand	1751	1804
Sand	265	368	Red Rock	1804	1810
Coal	368	370	Slate & Shells	1810	2014
Sand	370	452	Sand	2014	2070
Slate	452	455	Red Rock	2070	2110
Sand	455	460	Slate & Shells	2110	2248
Black Lime	460	466	Lime	2248	2278
Sand	466	480	Sand	2278	2326
Slate & Shells	480	505	Slate	2326	2350
Lime	505	510	Lime	2350	2370
Sand	510	525	Slate & Shells	2370	2535
Sand shells	525	551	Big Lime	2535	2889
Black Lime	551	564	Injun Sand	2889	2933
Sand	564	713	Slate & Shells	2933	3455
Coal	713	715	Brown Shale	3455	3472
Lime	715	722	Berea Sand	3472	3533
Slate & Shells	722	735	Slate & Shells	3533	
Lime	735	825	TOTAL DEPTH		3573
Sand	825	950			
Lime	950	962	Water 60'		
Slate	962	967	Gas 2025		
Lime	967	1006	Gas 3520 @ Mcf		
Gritty Lime	1006	1021			
Sand	1021	1032	Open Flow decreased to 39 Mcf. after		
Coal	1032	1035	cleaning out. Plugged and abandoned.		
Lime	1035	1040			
Sand	1040	1065			
Slate & Shells	1065	1095			
Lime	1095	1105			
Slate	1105	1108			
Sand	1108	1150			
Black Lime	1150	1180			