

5000'

NO KNOWN WATER WELLS WITHIN 1000'

LATITUDE 37°45'00"

TOPO LOCATION

LONGITUDE 81°25'00"

2200'

A. N59°35'04"E 989.864'
B. S56°46'35"W 995.414'
C. N25°18'46"W 48.960'
D. S76°53'28"E 1330.651'

WYOMING POCAHONTAS LAND CO., INC.
COORDINATES
137385.265
-66206.756

NORTH

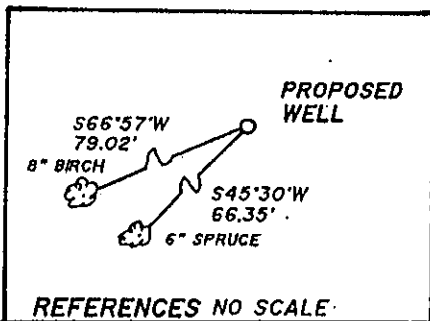
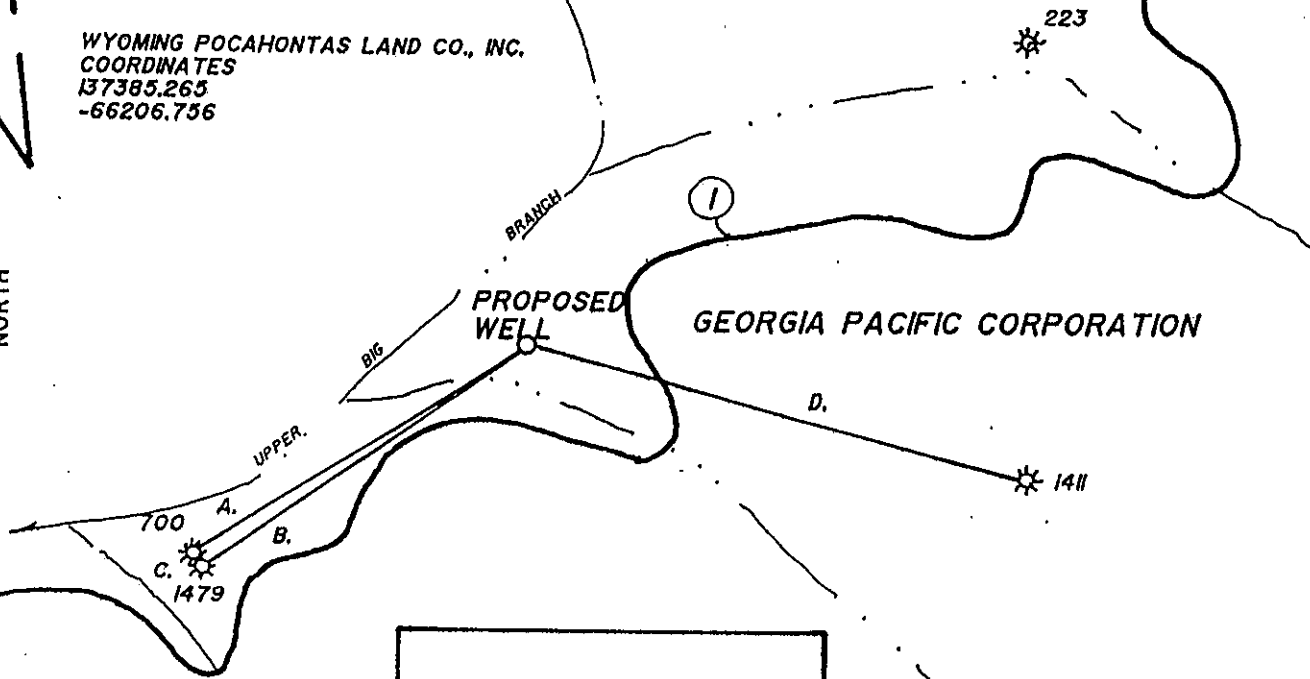

REFERENCES NO SCALE

FILE NO. _____
DRAWING NO. _____
SCALE 1"=500'
MINIMUM DEGREE OF ACCURACY 1/10000
PROVEN SOURCE OF ELEVATION USGS BM A-181
ELEVATION 1794

I THE UNDERSIGNED, HEREBY CERTIFY THAT THIS PLAT IS CORRECT TO THE BEST OF MY KNOWLEDGE AND BELIEF AND SHOWS ALL THE INFORMATION REQUIRED BY LAW AND THE REGULATIONS ISSUED AND PRESCRIBED BY THE DEPARTMENT OF MINES.
(SIGNED) [Signature]
R.P.E. _____ L.L.S. 736

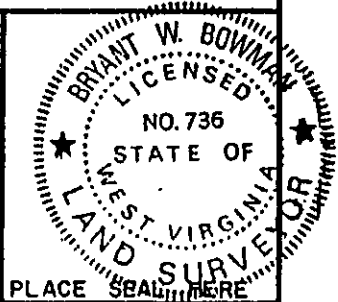

(+) DENOTES LOCATION OF WELL ON UNITED STATES TOPOGRAPHIC MAP



DATE JULY 06, 19 98
OPERATOR'S WELL NO. 53C
API WELL NO. 47-109-0754CP
STATE COUNTY PERMIT

FORM IV-6 WEST VIRGINIA
(8-78) DIVISION OF ENVIRONMENTAL PROTECTION
OFFICE OF OIL AND GAS
#10 McJUNKIN ROAD
NITRO, WEST VIRGINIA 25143-2506

WELL TYPE: OIL _____ GAS LIQUID INJECTION _____ WASTE DISPOSAL _____
(IF "GAS", PRODUCTION STORAGE _____ DEEP _____ SHALLOW _____
LOCATION: ELEVATION 2044 WATER SHED UPPER BIG BRANCH OF TROUGH FORK
DISTRICT SLAB FORK COUNTY WYOMING
QUADRANGLE MCGRAWS, WV 7.5'

SURFACE OWNER GEORGIA PACIFIC CORPORATION ACREAGE 30582±
OIL & GAS ROYALTY OWNER JAGUAR OIL & GAS CORPORATION LEASE ACREAGE 30582±
LEASE NO. _____

PROPOSED WORK: DRILL CONVERT _____ DRILL DEEPER _____ REDRILL _____ FRACTURE OR STIMULATE _____ PLUG OFF OLD FORMATION _____ PERFORATE NEW FORMATION _____ OTHER PHYSICAL CHANGE IN WELL (SPECIFY) _____

PLUG AND ABANDON _____ CLEAN OUT AND REPLUG _____
TARGET FORMATION Sewell, Beckley, Roca 5, 4 ESTIMATED DEPTH 1300'
WELL OPERATOR PENN VIRGINIA OIL & GAS CORP. DESIGNATED AGENT MR. HARRY JEWEL
ADDRESS 939 EXECUTIVE PARK BLVD, SUITE 300 ADDRESS PO BOX 460
KINGSPORT, TN 37660 RAVENCLIFF, WV 25913

WV 01754 P

NO KNOWN WATER WELLS
WITHIN 1000'

LATITUDE 37°45'00"

5000'

2200'

LONGITUDE 81°25'00"

- A. N59°35'04"E 989.864'
- B. S56°46'35"W 995.414'
- C. N25°18'46"W 48.960'
- D. S76°53'28"E 1330.651'

WYOMING POCAHONTAS LAND CO., INC.
COORDINATES
137385.265
-66206.756

0.405
0.94w
TOPO
LOCATION

223

1411

700

1479

PROPOSED WELL

GEORGIA PACIFIC CORPORATION

NORTH

BRANCH

BIG

UPPER

D.

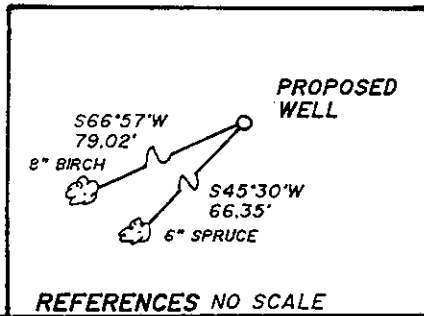

REFERENCES NO SCALE

FILE NO. _____
DRAWING NO. _____
SCALE 1"=500'
MINIMUM DEGREE OF ACCURACY 1/10000
PROVEN SOURCE OF ELEVATION USGS BM A-181
ELEVATION 1794

I THE UNDERSIGNED, HEREBY CERTIFY THAT THIS PLAT IS CORRECT TO THE BEST OF MY KNOWLEDGE AND BELIEF AND SHOWS ALL THE INFORMATION REQUIRED BY LAW AND THE REGULATIONS ISSUED AND PRESCRIBED BY THE DEPARTMENT OF MINES.

(SIGNED) [Signature]
B.P.E. _____ L.L.S. 736

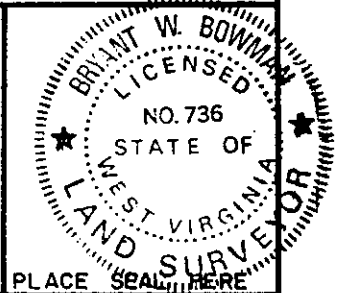

(+) DENOTES LOCATION OF WELL ON UNITED STATES TOPOGRAPHIC MAPS

FORM IV-6 WEST VIRGINIA
(8-78) DIVISION OF ENVIRONMENTAL PROTECTION
OFFICE OF OIL AND GAS
#10 McJUNKIN ROAD
NITRO, WEST VIRGINIA 25143-2506

DATE JULY 06, 19 98
OPERATOR'S WELL NO. 53C
API WELL NO.

47 - 109 - 0754C
STATE COUNTY PERMIT

WELL TYPE: OIL _____ GAS X LIQUID INJECTION _____ WASTE DISPOSAL _____
(IF "GAS", PRODUCTION X STORAGE _____ DEEP _____ SHALLOW _____
LOCATION: ELEVATION 2044 WATER SHED UPPER BIG BRANCH OF TROUGH FORK
DISTRICT SLAB FORK COUNTY WYOMING
QUADRANGLE MCGRAWS, WV 7.5'

SURFACE OWNER GEORGIA PACIFIC CORPORATION ACREAGE 30582±
OIL & GAS ROYALTY OWNER JAGUAR OIL & GAS CORPORATION LEASE ACREAGE 30582±
LEASE NO. _____

PROPOSED WORK: DRILL X CONVERT _____ DRILL DEEPER _____ REDRILL _____ FRACTURE OR STIMULATE _____ PLUG OFF OLD FORMATION _____ PERFORATE NEW FORMATION _____ OTHER PHYSICAL CHANGE IN WELL (SPECIFY) _____

PLUG AND ABANDON _____ CLEAN OUT AND REPLUG _____
TARGET FORMATION Sewell, Beckley, Poca 5, 4 ESTIMATED DEPTH 1300'
WELL OPERATOR PENN VIRGINIA OIL & GAS CORP. DESIGNATED AGENT MR. HARRY JEWEL
ADDRESS 999 EXECUTIVE PARK BLVD, SUITE 300 ADDRESS PO BOX 460
KINGSPORT, TN 37660 RAVENCLIFF, WV 25913

WYO 1754 C

WR-35

31-Jul-98
API # 47-109-01754 C

State of West Virginia
Division of Environmental Protection
Section of Oil and Gas

Reviewed: [Signature]

Well Operator's Report of Well Work

Farm name: GEORGIA PACIFIC CORP Operator Well No.: 53C

LOCATION: Elevation: 2,044.00 Quadrangle: MCGRAWS

District: SLAB FORK County: WYOMING
Latitude: 2200 Feet South of 37 Deg. 45Min. 0 Sec.
Longitude 5000 Feet West of 81 Deg. 25 Min. 0 Sec.

Company: PENN VIRGINIA OIL AND GAS
999 EXEC. PARK BLVD., STE. 300
KINGSPORT, TN 37660-0000

Casing & Tubing Size	Used in Drilling	Left in Well	Cement Fill Up Cu. Ft.
9 5/8"	21'	21'	0
7"	219"	219"	59
4 1/2"	1199'	1199'	189
2 3/8"		1130'	

Agent: HARRY JEWELL, III

Inspector: OFIE HELMICK
Permit Issued: 07/31/98
Well work Commenced: 10/28/98
Well work Completed: 12/23/98
Verbal Plugging
Permission granted on: _____
Rotary Cable _____ Rig
Total Depth (feet) 1218'
Fresh water depths (ft) 2" @ 45'

Salt water depths (ft) _____

Is coal being mined in area (Y/N)? N
Coal Depths (ft): 46-48, 69-70

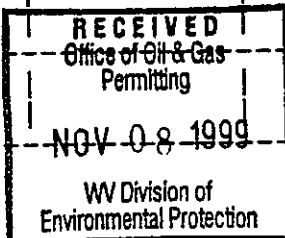

OPEN FLOW DATA

Sewell, U & L Beckley
Fire Creek, Poca 4 and

Producing formation Lower Poca 4 Coals Pay zone depth (ft) _____
 Gas: Initial open flow _____ MCF/d Oil: Initial open flow _____ Bbl/d
 Final open flow _____ MCF/d Final open flow _____ Bbl/d
 Time of open flow between initial and final tests _____ Hours
 Static rock Pressure N/A psig (surface pressure) after _____ Hours

Second producing formation _____ Pay zone depth (ft) _____
 Gas: Initial open flow _____ MCF/d Oil: Initial open flow _____ Bbl/d
 Final open flow _____ MCF/d Final open flow _____ Bbl/d
 Time of open flow between initial and final tests _____ Hours
 Static rock Pressure _____ psig (surface pressure) after _____ Hours

NOTE: ON BACK OF THIS FORM PUT THE FOLLOWING: 1). DETAILS OF PERFORATED INTERVALS, FRACTURING OR STIMULATING, PHYSICAL CHANGE, ETC. 2). THE WELL LOG WHICH IS A SYSTEMATIC DETAILED GEOLOGICAL RECORD OF ALL FORMATIONS, INCLUDING COAL ENCOUNTERED BY THE WELLBORE.

For: PENN VIRGINIA OIL AND GAS CORPORATION

By: William M. Ryan
Date: 11/3/99

NOV 13 1999

WYO 1754C

FORM WR-35R
(REVERSE)

PERMIT #: 47-109-01754 C
WELL#: 53C

DETAILS OF PERFORATIONS, FRACTURING, OR PHYSICAL CHANGE, ETC.

Stage 1	Poca 4 Coal Lower Poca 4 Coal	Perforated the Poca 4 Coal from 1052' to 1054' with 6 holes and the Lower Poca 4 Coal from 1084' to 1090' with 13 holes. Breakdown with 500 gallons of 7½% HCL acid and water. Treated with 359 bbls of water and 6847 lbs of 20/40 sand. ATR: 14 BPM ATP: 2550 psi ISIP: 1379 psi
Stage 2	Upper Beckley Coal Lower Beckley Coal Fire Creek Coal	Perforated the Upper Beckley Coal from 708' to 711' with 15 holes, the Lower Beckley Coal from 764' to 768' with 16 holes and the Fire Creek Coal from 809' to 812' with 15 holes. Breakdown with 1500 gallons of 7½% HCL acid and water. Treated with 536 bbls of water and 9000 lbs 20/40 sand. ATR: 15 BPM ATP: 2675 psi ISIP: 2230 psi
Stage 3	Sewell Coal	Perforated from 497' to 501' with 20 holes. Breakdown with 668 gallons of 7 ½% HCL acid and water. Treated with 351 bbls of water and 11,600 lbs of 20/40 sand. ATR: 14 BPM ATP: 2900 psi ISIP: 1920 psi

Install pump jack and pump water.

<u>FORMATIONS</u>	<u>TOP</u>	<u>BOTTOM</u>	<u>REMARKS</u>
Sand, Shale & Coal	0	90	
Sand	90	130	
Sand & Shale	130	310	
Sand	310	420	
Sand & Shale	420	497	
Coal - Sewell 543	497	500	
Sand & Shale	500	540	
Sand	540	699	
Sand & Shale	699	708	
Coal U. Beck - 547	708	710	
Sand & Shale	710	764	
Coal L. Beck - 549	764	767	
Sand & Shale	767	810	
Coal 550	810	811	
Sand & Shale	811	878	
Sand	878	952	
Shale	952	1002	
Coal	1002	1003	
Sand	1003	1037	
Shale	1037	1052	
Coal - Poca 4 (558)	1052	1054	
Shale	1054	1083	
Coal & Shale - L.P. (560)	1083	1089	
Sand	1089	1142	
Shale	1142	1218	No shows reported