

POCAHONTAS LAND CORPORATION

COORDINATES
271641804
1839936.622
WV SOUTH
NAD 27

A. N33°14'E 1760.307'
B. S31°22'40"W 6913.340'
C. N30°45'26"E 5154.220'

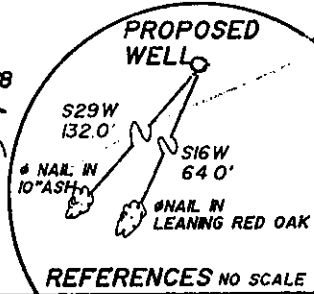

NO KNOWN WATER WELLS WITHIN 1500'

FILE NO. _____
DRAWING NO. _____
SCALE 1"=2000'
MINIMUM DEGREE OF ACCURACY 1:5000
PROVEN SOURCE OF ELEVATION COPPER PLUG IN ROCK ELEVATION 2754.83

I THE UNDERSIGNED, HEREBY CERTIFY THAT THIS PLAT IS CORRECT TO THE BEST OF MY KNOWLEDGE AND BELIEF AND SHOWS ALL THE INFORMATION REQUIRED BY LAW AND THE REGULATIONS ISSUED AND PRESCRIBED BY THE DEPARTMENT OF MINES.
(SIGNED) Suzanne D. Bowman
R.P.E. _____ L.L.S. 736

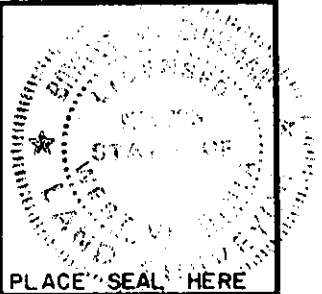

(+) DENOTES LOCATION OF WELL ON UNITED STATES TOPOGRAPHIC MAPS
FORM IV-6
(8-78)



DATE JANUARY 10 2001
OPERATOR'S WELL NO. LC-72C
API WELL NO. 47-109-01993C
STATE COUNTY PERMIT

Division of Environmental Protection
Office of Oil & Gas

WELL TYPE: OIL _____ GAS X LIQUID INJECTION _____ WASTE DISPOSAL _____
(IF "GAS", PRODUCTION X STORAGE _____ DEEP _____ SHALLOW _____)
LOCATION: ELEVATION 2895 WATER SHED TONEY FORK & CRANE FORK OF CLEAR FORK
DISTRICT OCEANA COUNTY WYOMING
QUADRANGLE MATHENY, WV 7.5'
SURFACE OWNER POCAHONTAS LAND CORPORATION ACREAGE 29500±
OIL & GAS ROYALTY OWNER PENN VIRGINIA OIL & GAS CORPORATION LEASE ACREAGE 29500±
LEASE NO. _____
PROPOSED WORK: DRILL X CONVERT _____ DRILL DEEPER _____ REDRILL _____ FRACTURE OR STIMULATE _____ PLUG OFF OLD FORMATION _____ PERFORATE NEW FORMATION _____ OTHER PHYSICAL CHANGE IN WELL (SPECIFY) _____
PLUG AND ABANDON _____ CLEAN OUT AND REPLUG _____
TARGET FORMATION Beckley Firecrest, POC 45443 ESTIMATED DEPTH 2900
WELL OPERATOR PENN VIRGINIA OIL & GAS CORP. DESIGNATED AGENT MR. HARRY JEWEL
ADDRESS PO BOX 387 ADDRESS PO BOX 460
DUFFIELD, VA 24244-0387 RAVENCLIFF, WV 25913

FEB 23 2001

6-6 248

Charleston, WV

WYO 1993C

State of West Virginia
Division of Environmental Protection
Section of Oil and Gas

Reviewed ARB

Well Operator's Report of Well Work

Farm name: Pocahontas Land Corp Operator Well No.: LC-72C

LOCATION: Elevation: 2895 Quadrangle: Matheny WV 7.5

District: Oceana County: Wyoming

Latitude: 1850 Feet South of 37 Deg. 45 Min. 00 Sec.

Longitude 3400 Feet West of 81 Deg. 32 Min. 30 Sec.

Company:

Penn Virginia Oil & Gas Corporation

	Casing & Tubing	Used in drilling	Left in well	Cement fill up Cu. Ft.
Address: P.O. Box 387	13 3/8"	30'	30'	0
Duffield, VA 24244	9 5/8"	534'	534'	169
Agent: Harry Jewell	7"	1085'	1085'	230
Inspector: Ofie Helmick	4 1/2"	2662'	2662'	428
Date Permit Issued: 2-20-01				
Date Well Work Commenced: 2-28-01				
Date Well Work Completed: 4-4-01				
Verbal Plugging:				
Date Permission granted on:				
Rotary X Cable Rig				
Total Depth (feet): 2720				
Fresh Water Depth (ft.): Damp @ 50' and 810' & 2375'				
Salt Water Depth (ft.):				
Is coal being mined in area (N/Y) N				
Coal Depths (ft.): 45-47', 186-189', 410-414', 498-503' (open), 571-574', 671-673', 715-717',				

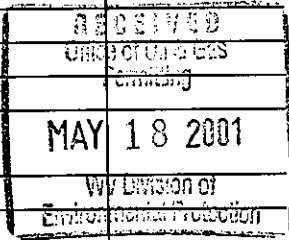

OPEN FLOW DATA

Producing formation Beckley & Lower Fire Creek Coals Pay zone depth (ft) 2339-2400'

Gas: Initial open flow _____ MCF/d Oil: Initial open flow _____ Bbl/d

Final open flow Show MCF/d Final open flow _____ Bbl/d

Time of open flow between initial and final tests _____ Hours

Static rock Pressure Not Taken psig (surface pressure) after _____ Hours

Second producing formation _____ Pay zone depth (ft) _____

Gas: Initial open flow _____ MCF/d Oil: Initial open flow _____ Bbl/d

Final open flow _____ MCF/d Final open flow _____ Bbl/d

Time of open flow between initial and final tests _____ Hours

Static rock Pressure _____ psig (surface pressure) after _____ Hours

NOTE: ON BACK OF THIS FORM PUT THE FOLLOWING: 1). DETAILS OF PERFORATED INTERVALS, FRACTURING OR STIMULATING, PHYSICAL CHANGE, ETC. 2). THE WELL LOG WHICH IS A SYSTEMATIC DETAILED GEOLOGICAL RECORD OF ALL FORMATIONS, INCLUDING COAL ENCOUNTERED BY THE WELLBORE.

Signed:

By: William M. Ryan
Date: 5/16/01

MAY 25 2001

WYOM. 1993 C

FORM WR-35R
(REVERSE)

PERMIT #: 47-109-01993C
WELL #: LC-72C

DETAILS OF PERFORATIONS, FRACTURING, OR PHYSICAL CHANGE, ETC.

Stage 1 – Lower Fire Creek Coal – Perforated from 2397' to 2400' with 12 holes. Breakdown with 250 gallons 7.5% HCL acid and water. Treated with 284 bbls water and 5298 lbs 20/40 sand. ISIP: 1181 psi. ATP: 2781 psi. ATR: 20 BPM.

Stage 2 – Lower Beckley Coal – Perforated from 2334' to 2339' with 20 holes. Breakdown with 250 gallons 15% HCL acid and water. Treated with 523 bbls water and 20799 lbs 20/40 sand. ISIP: 1964 psi. ATP: 2300 psi.

<u>FORMATIONS</u>	<u>TOP</u>	<u>BOTTOM</u>	<u>REMARKS</u>
Sand, Shale & Coal	0	717	
Sand & Shale	717	1138	
Shale & Coal	1138	1230	
Sand	1230	1255	
Sand & Shale	1255	1303	
Sand	1303	1327	
Coal	1327	1330	
Sand & Shale	1330	1510	
Sand	1510	1650	
Shale	1650	1892	
Sand	1892	2115	
Sand & Shale	2115	2236	
Upper Beckley Coal	2236	2239	
Sand	2239	2312	
Shale	2312	2331	
Beckley Coal	2331	2340	
Sand & Shale	2340	2356	
Upper Fire Creek Coal	2356	2357	
Sand	2357	2397	
Lower Fire Creek Coal	2397	2400	
Sand	2400	2438	
Poca 6 Coal	2438	2439	
Sand & Shale	2439	2720	