

FILE NO. _____
 DRAWING NO. _____
 SCALE 1"=2000'
 MINIMUM DEGREE OF ACCURACY 1/5000
 PROVEN SOURCE OF ELEVATION COPPER PLUG IN ROCK
 ELEVATION 2754.83

I THE UNDERSIGNED, HEREBY CERTIFY THAT THIS PLAT IS CORRECT TO THE BEST OF MY KNOWLEDGE AND BELIEF AND SHOWS ALL THE INFORMATION REQUIRED BY LAW AND THE REGULATIONS ISSUED AND PRESCRIBED BY THE DEPARTMENT OF MINES.

(SIGNED) *Ryan D. Bowman*
 R.P.E. _____ L.L.S. 736

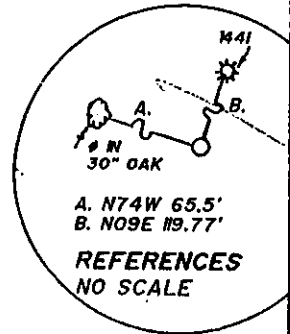

PLACE SEAL HERE

(+) DENOTES LOCATION OF WELL ON UNITED STATES TOPOGRAPHIC MAPS
 FORM IV-6
 (8-78)



DATE MARCH 29 2001
 OPERATOR'S WELL NO. LC-35C-27
 API WELL NO. _____
47 - 109 - 02030C
 STATE COUNTY PERMIT

Division of Environmental Protection
 Office of Oil & Gas

WELL TYPE: OIL _____ GAS LIQUID INJECTION _____ WASTE DISPOSAL _____
 (IF "GAS", PRODUCTION STORAGE _____ DEEP _____ SHALLOW _____)
 LOCATION: ELEVATION 2976 WATER SHED CLEAR FORK & TONEY FORK
 DISTRICT OCEANA COUNTY WYOMING
 QUADRANGLE MATHENY, WV 7.5'
 SURFACE OWNER POCAHONTAS LAND CORPORATION ACREAGE 29500±
 OIL & GAS ROYALTY OWNER POCAHONTAS LAND CORPORATION LEASE ACREAGE 29500±
 LEASE NO. _____
 PROPOSED WORK: DRILL CONVERT _____ DRILL DEEPER _____ REDRILL _____ FRACTURE OR
 STIMULATE _____ PLUG OFF OLD FORMATION _____ PERFORATE NEW
 FORMATION _____ OTHER PHYSICAL CHANGE IN WELL (SPECIFY) _____

PLUG AND ABANDON _____ CLEAN OUT AND REPLUG _____
 TARGET FORMATION Becky Fire Creek POCALCO, #4 ESTIMATED DEPTH 2700
 WELL OPERATOR PENN VIRGINIA OIL & GAS CORP DESIGNATED AGENT MR. HARRY JEWEL
 ADDRESS PO BOX 387 ADDRESS PO BOX 460
DUFFIELD, VA 24244-0387 RAVENCLIFF, WV 25913

MAY 25 2001

WYOM. 2030 C

State of West Virginia
Division of Environmental Production
Section of Oil and Gas

File *As D*

Well Operator's Report of Well Work

Farm Name Pocahontas Land Corporation

Operator Well No.: LC-35C-27

LOCATION Elevation: 2988

Quadrangle: Matheny 7 1/2'

District: Oceana County: Wyoming
Latitude: 3570 Feet South of 37 Deg. 45 Min. 00 Sec.
Longitude: 4450 Feet West of 81 Deg. 32 Min. 30 Sec.

Company:

Penn Virginia Oil & Gas Corporation

	Casing and Tubing	Used in drilling	Left in well	Cement fill up Cu. Ft.
Address: P.O. Box 387	9 5/8"	40'	40'	0
Duffield, VA 24244	7"	526'	526'	121
Agent: Harry Jewell	4 1/2"	2615'	2615'	378
Inspector: Ofie Helmick				
Date Permit Issued:				
Date Well Work Commenced:				
Date Well Work Completed: 09/11/2001				
Verbal Plugging:				
Date Permission granted on:				
Rotary X Cable Rig				
Total Depth (feet): 2,660				
Fresh Water Depth (ft):				
Damp @ 2265'				
Salt Water Depth (ft):				
Is coal being mined in area (N/Y)?				
Coal Depths (ft): 34'-37', 365'-370', 504'-506', 575'-580, 858'-830'				

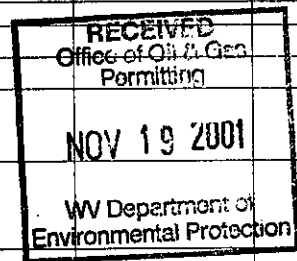

OPEN FLOW DATA

Producing formation Beckley Coal & Lower Fire Creek Coal Pay zone depth (ft) _____
 Gas: Initial open flow _____ MCF/d Oil: Initial open flow _____ Bbl/d
 Final open flow Not Taken MCF/d Final open flow _____ Bbl/d
 Time of open flow between initial and final tests: _____ Hours
 Static rock pressure Not Taken psig (surface pressure) after _____ Hours

Second producing formation _____ Pay zone depth (ft) _____
 Gas: Initial open flow _____ MCF/d Oil: Initial open flow _____ Bbl/d
 Final open flow _____ MCF/d Final open flow _____ Bbl/d
 Time of open flow between initial and final tests: _____ Hours
 Static rock pressure _____ psig (surface pressure) after _____ Hours

NOTE: ON BACK OF THIS FORM PUT THE FOLLOWING: 1). DETAILS OF PERFORATED INTERVALS, FRACTURING OR STIMULATING, PHYSICAL CHANE, TEC. 2). THE WELL LOG WHICH IS A SYSTEMATIC DETAILED GEOLOGICAL RECORD OF ALL FORMATIONS, INCLUDING COAL ENCOUNTERED BY THE WELLBORE.

Signed:

By: William M. Ryan
Date: 11/16/01

NOV 30 2001

WV 2030 C

DETAILS OF PERFORATIONS, FRACTURING, OR PHYSICAL CHANGE, ETC.

PERFORATIONS AND FRACTURING

Stage 1- Lower Fire Creek Coal- Perforated from 2503' to 2506' with 12 holes. Breakdown with 250 gallons 15% HCL acid and water. Treated with 265 bbls water and 550 lbs 20/40 sand. ISIP: 1584 psi. ATP: 3360 psi. ATR: 17 BPM.

Stage 2-Lower Beckley Coal- Perforated from 2409'-2415' with 24 holes. Breakdown wit 250 gallons 15% HCL acid and water. Treated with 615 bbls water and 258200 lbs 20/40 sand. ISIP: 1822 psi. ATP: 3260 psi. ATR: 20 BPM.

<u>FORMATIONS</u>	<u>TOP</u>	<u>BOTTOM</u>	<u>REMARKS</u>
Sand, shale, & coal	0	830	
Sand & shale	830	1080	
Coal	1080	1082	
Sand & shale	1082	1420	
Coal	1420	1422	
Sand & shale	1422	1730	
Coal	1730	1732	
Shale	1732	1950	
Sand	1950	2203	
Sand & shale	2203	2282	
Sand	2282	2330	
Sand & shale	2330	2409	
Beckley Coal	2409	2417	
Sand & shale	2417	2452	
Sand	2452	2502	
Lower Fire Creek Coal	2502	2505	
Sand & shale	2505	2660	No shows reported