

West Virginia State Plane Coordinates
 NAD 27 SOUTH
 N 213,956.20
 E 1,857,165.00
 Pocahontas Land Corp. Conversion
 N 80,049.71
 E 16,719.92

10000'
 Lat. 37° 37' 30"

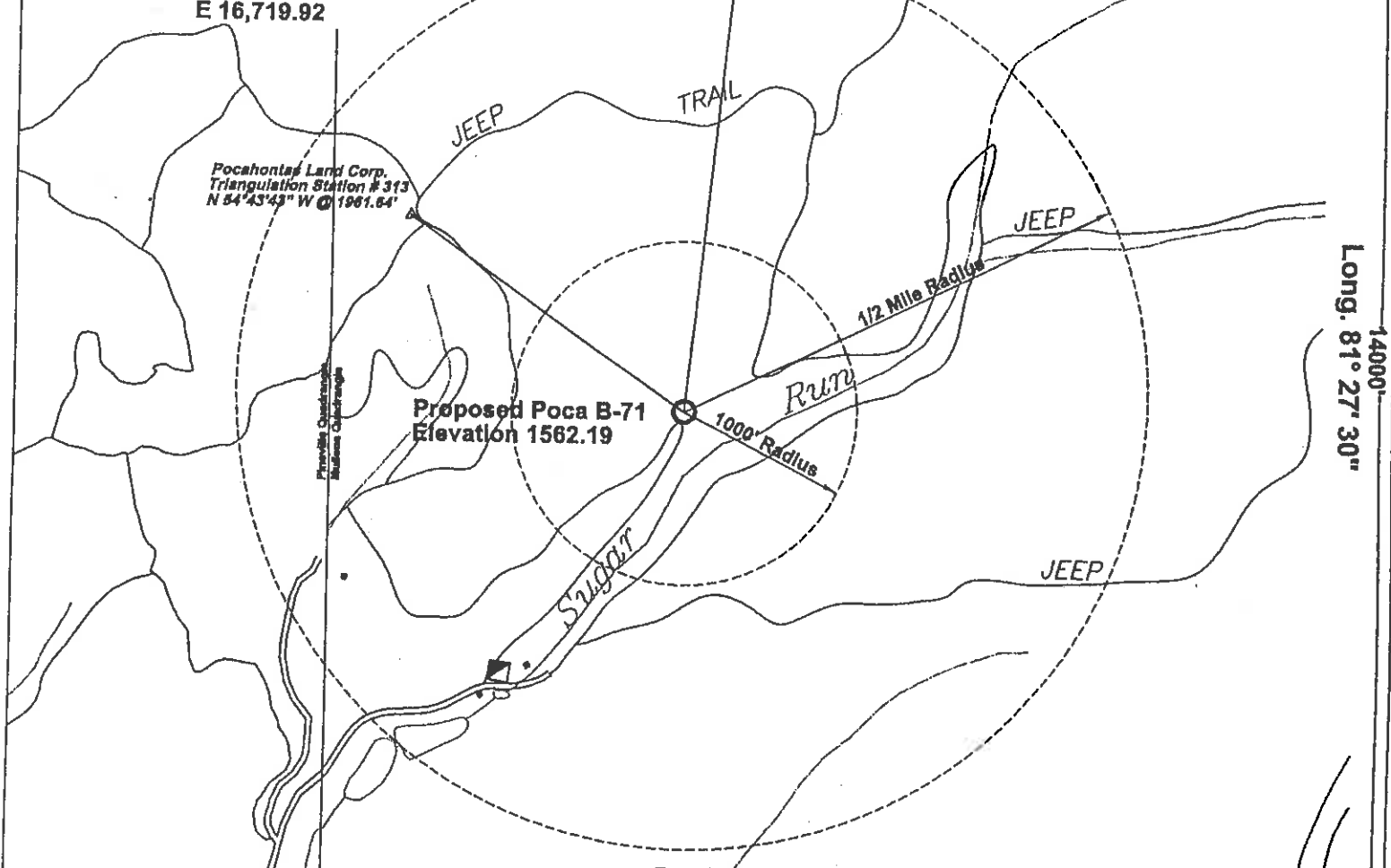

14000'
 Long. 81° 27' 30"

Proposed Poca B-71
 Elevation 1562.19

Pocahontas Land Corporation - Surface and Mineral
 Tract # S.S. 343 F.P. Roach 296 Acres
 Penn Virginia Oil and Gas Corporation - Oil and Gas

Jims JEEP

REFERENCES

Not to scale

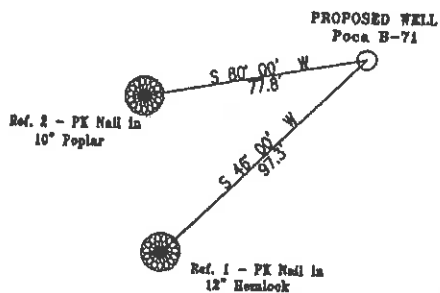

Topo
 Location

Notes:

- No dwellings exist within 200 feet of Poca B-71
- No Domestic Wells within 1000' of Poca B-71
- (+) Denotes location of well on USGS map.

Information taken from Wyoming County Tax Records.

FILE No. CABOT OIL & GAS 2002
 DIRECTORY C:\Cabot2002\B-71
 DRAWING NAME PlatB-71
 SCALE 1" = 1000'
 MINIMUM DEGREE OF
 ACCURACY 1 : 2500
 PROVEN SOURCE OF
 ELEVATION GPS
Global Positioning System

I THE UNDERSIGNED, HEREBY CERTIFY THAT
 THIS PLAT IS CORRECT TO THE BEST OF MY
 KNOWLEDGE AND BELIEF AND SHOWS ALL THE
 INFORMATION REQUIRED BY LAW AND THE REGU-
 LATIONS ISSUED AND PRESCRIBED BY THE
 DEPARTMENT OF MINES.

(SIGNED)

W. Claude Banner, Jr.
 R.P.E. 2430 R.P.S.

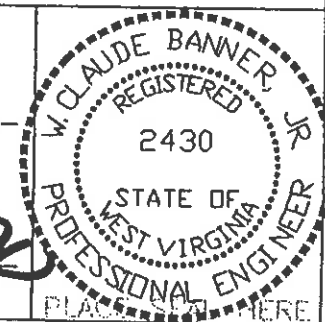

STATE OF WEST VIRGINIA
 DIVISION OF ENVIRONMENTAL PROTECTION
 OFFICE OF OIL AND GAS
 CHARLESTON, WV



DATE NOVEMBER 18, 2002
 OPERATOR'S WELL No. POCA B-71

WELL TYPE: OIL GAS X LIQUID INJECTION WASTE DISPOSAL STATE COUNTY PERMIT
 (IF "GAS") PRODUCTION X STORAGE DEEP SHALLOW

LOCATION: ELEVATION 1562.19' WATER SHED SUGAR RUN OF THE GUYANDOTTE RIVER
 DISTRICT CENTER COUNTY WYOMING
 QUADRANGLE MULLENS, WV

SURFACE OWNER POCAHONTAS LAND CORPORATION ACREAGE 5,650.67 (Tax Map 118, Parcel 9)
 ROYALTY OWNER PENN VIRGINIA OIL & GAS CORPORATION LEASE ACREAGE 22,348 Total Acres

LEASE No. 47-0369

PROPOSED WORK: DRILL X CONVERT DRILL DEEPER REDRILL FRACTURE OR
 STIMULATE PLUG OFF OLD FORMATION PERFORATE NEW
 FORMATION OTHER PHYSICAL CHANGE IN WELL (SPECIFY)

PLUG AND ABANDON CLEAN OUT AND REPLUG

TARGET FORMATION LIME GORDON
 WELL OPERATOR CABOT OIL & GAS CORP.
 ADDRESS 900 LEE ST. EAST SUITE 500
CHARLESTON, WV 25301

ESTIMATED DEPTH 3850
 DESIGNATED AGENT THOMAS S. LIBERATORE
 ADDRESS 900 LEE ST. EAST SUITE 500
CHARLESTON, WV 25301

Unnamed 66 (U)

WYO 2219

JAN 03 2003

WR-35

Date January 13, 2009
API # 47 - 109 - 02219

State of West Virginia
Division of Environmental Protection
Section of Oil and Gas
Well Operator's Report of Well Work

18

Farm Name: Pocahontas Land Corp Operator Well No.: Pocahontas Land B-71

LOCATION: Elevation: 1562' Quadrangle: Mullens
District: Center County: Wyoming
Latitude: 14,000' feet South of 37° DEG. 37' MIN. 30" SEC.
Longitude: 10,000' feet West of 81° DEG. 27' MIN. 30" SEC.

Company: Cabot Oil & Gas Corporation
900 Lee Street East, Suite 500
Charleston, WV 25301

Casing & Tubing Size	Used in Drilling	Left In Well	Cement Fill Up Cu. Ft.
16"	38'	38'	N/A
9 5/8"	585'	585'	135.7
Grouted in two stages			336, 504
7"	1034'	1034'	234
4 1/2"	3842'	3842'	224
RECEIVED Office of Oil & Gas JAN 16 2009			

Agent: Thomas S. Liberatore
Inspector: Barry Stollings
Permit Issued: 12/23/2002
Well Work Commenced: July 12, 2003
Well Work Completed: October 12, 2003
Verbal Plugging: _____
Permission granted on: _____
Rotary X Cable _____
Total Depth (feet) 3855
Fresh Water Depths (ft) 137, 750
Salt Water Depths (ft) None Reported
Is coal being mined in area (Y/N)? Y
Coal Depths (ft) 484, 572

WV Department of
Environmental Protection

OPEN FLOW DATA

Producing Formation Gordon Pay Zone 3714-3726
Pocono Depth (ft) 3116-3128

Gas: Initial Open Flow TSTM MCF/d Oil: Initial Open Flow 0 Bbl/d
Final Open Flow 2800 (comingled) MCF/d Final Open Flow 0 Bbl/d
Time of open flow between initial and final tests 5 Hours
Static rock pressure 650 psig surface pressure after 43 Hours

Second Producing Formation Big Lime (1) Pay Zone 2860-2870
Big Lime (2) Depth (ft) 2520-2532

Gas: Initial Open Flow TSTM MCF/d Oil: Initial Open Flow 0 Bbl/d
Final Open Flow 2800 (comingled) MCF/d Final Open Flow 0 Bbl/d
Time of open flow between initial and final tests 5 Hours
Static rock pressure 650 psig surface pressure after 43 Hours

NOTE: ON BACK OF THIS FORM PUT THE FOLLOWING: 1.) DETAILS OF PERFORATED INTERVALS, FRACTURING OR STIMULATING, PHYSICAL CHANGE, ETC. 2.) THE WELL LOG WHICH IS SYSTEMATIC DETAILED GEOLOGICAL RECORD OF ALL FORMATIONS, INCLUDING COAL ENCOUNTERED BY THE WELLBORE

For: CABOT OIL & GAS CORPORATION

By: [Signature] Drilling Superintendent
Date: 1/13/09

JAN 23 2009

WV/D 2219

STAGE	PERFS	ACID		SAND (lbs)	NITROGEN (scf)	BDP	ATP	MTP	ISIP
		15% HCl	FOAM						
1-Gordon	3714-3726 (48)	500 gal	75Q	60000	461,600	1736	1460	1674	1674
2-Pocono	3116-3128 (48)	500 gal	75Q	40000	308,000	1730	1260	1355	1149
3-Big Lime (1)	2860-2870 (40)	500 gal	75Q	30400	444,900	2766	2410	2444	2008
4-Big Lime (2)	2520-2532 (48)	7000 gal			52,600	1652	1460	1736	1332

FORMATION	TOP	BOTTOM	REMARKS
Silt/Shale	Surface	1032	
Shale	1032	1270	
Ravenclyff	1270	1328	
Shale	1328	1365	
Avis	1365	1410	
Silt/Shale	1410	2200	
Shale	2200	2290	
Little Lime	2290	2387	
Lime/Shale	2387	2497	
Big Lime	2497	2945	
Injun	2945	3000	
Pocono	3000	3152	
Weir Siltstone	3152	3244	
Shale	3244	3590	
Berea	3590	3596	
Shale	3596	3715	
Gordon	3715	3764	
Shale	3764	3855	TD

01/31/08

PERFORMED 5 STAGE FRAC.

L. HURON (1) 4954'- 4976' (16 HOLES)- 75 Q FOAM FRAC - 14,900# 20/40 SAND, 261 BBL CLEAN FLUID, 366,400 SCF N2, BDP 3211#, ATP 2504#, AIR 25.3 BPM, PUMPED 500 GAL 15% HCL, (DROPPED 3 1/4" FRAC BALL) ON FOAM FLUSH.
 U. HURON (2) 4550'- 4560' (20 HOLES) - 75Q FOAM FRAC - 10,300# 20/40 SAND, 122 BBL CLEAN FLUID, 212,000 SCF N2, BDP 1951#, ATP 2045#, AIR 21.5 BPM, PUMPED 500 GAL 15% HCL, (DROPPED 3-3/8" FRAC BALL) ON FOAM FLUSH.
 U. HURON (3) 4498'- 4506' (20 HOLES) - 75 Q FOAM FRAC - 10,400# 20/40 SAND, XX BBL CLEAN FLUID, 194,800 SCF N2, BDP 1981#, ATP 1911#, AIR 20.8 BPM, PUMPED 500 GAL 15% HCL, (DROPPED 3-1/2" FRAC BALL) ON FOAM FLUSH.
 PRICE (4) 2984'- 2994' (21 HOLES) - 75 Q FOAM FRAC - 15,500# 20/40 SAND, 112 BBL CLEAN FLUID, 184,100 SCF N2, BDP 1720#, ATP 1698#, AIR 25.7 BPM, PUMPED 500 GAL 15% HCL, (DROPPED 3-3/4" FRAC BALL) ON FOAM FLUSH.
 RAVENCLIFF (5) 1612'- 1622' (20 HOLES) - LOST IN GUN HOLE.

Fill	0	15
Shale	15	65
Shale	65	180
Sand Shale	180	210
Shale	210	230
Sandstone	230	300
Shale	300	320
Coal	320	363
Shale	363	500
Sandstone	500	690
Shale	690	780
Sandstone	780	940
Shale	940	1030
Sandstone	1030	1390
Princeton	1390	

GAMMA RAY / FORMATION TOPS					
DEPI # 6052		047-109-02919			
			TOP	BASE	
RAVENCLIFF SAND			1480	1624	
AVIS LIME			1626	1665	
UPPER MAXTON			1884	2054	
MIDDLE MAXTON			2102	2124	
LOWER MAXTON			2202	2250	
LITTLE LIME			2296	2478	
BIG LIME			2478	2796	
PRICE FORMATION			2796	3370	
WEIR SAND			3006	3022	
SUNBURY SHALE			3320	3370	
BEREA			3370	3404	
GORDON			3538	3600	
UPPER HURON			4458	4830	
LOWER HURON			4830	5040	
LTD				5130	

WR-35
Rev (5-01)

DATE: 03/17/2008
API #: 47 109 02919

State of West Virginia
Department of Environmental Protection
Office of Oil and Gas

Well Operator's Report of Well Work

Farm name: Crouch, Edgar M. - Heirs Operator Well No.: 6052

LOCATION: Elevation: 1380' Quadrangle: Oceana 7.5'

District: Oceana County: Wyoming
Latitude: 11,080 Feet South of 37 Deg. 42 Min. 30 Sec.
Longitude 4,020 Feet West of 81 Deg. 37 Min. 30 Sec.

Company: Dominion Exploration & Production, Inc

	Casing & Tubing	Used in drilling	Left in well	Cement fill up Cu. Ft.
Address: P O Box 1248 Jane Lew, WV 26378				
Agent: Rodney J. Biggs				
Inspector: Barry Stollings				
Date Permit Issued: 09/20/2007				
Date Well Work Commenced: 01/17/2007 <u>2008</u>	12 3/4"	22'	22'	Sand In
Date Well Work Completed: 01/31/2008				
Verbal Plugging N/A	9 5/8"	397'	397'	180 sks
Date Permission granted on: N/A				
Rotary X Cable Rig	7"	1326'	1326'	235 sks
Total Depth (feet): 5126'				
Fresh Water Depth (ft.):	4 1/2"	5058'	5058'	380 sks
Salt Water Depth (ft.): N/A				
Is coal being mined in area (N/Y)? N				
Coal Depths (ft.): 320-363'				

OPEN FLOW DATA

L. HURON 4954'- 4976'
U. HURON 4550'- 4560'
Producing formation U. HURON Pay zone depth (ft) 4498'- 4506'
Gas: Initial open flow 133 MCF/d Oil: Initial open flow 0 Bbl/d
Final open flow 119 MCF/d Final open flow 0 Bbl/d
Time of open flow between initial and final tests 12 Hours
Static rock Pressure 515 psig (surface pressure) after 12 Hours
PRICE 2984'- 2994'
Second producing formation RAVENCLIFF Pay zone depth (ft) 1612'- 1622'
Gas: Initial open flow * MCF/d Oil: Initial open flow * Bbl/d
Final open flow * MCF/d Final open flow * Bbl/d
Time of open flow between initial and final tests * Hours
Static rock Pressure * psig (surface pressure) after * Hours

*Commingled with previous formations

NOTE: ON BACK OF THIS FORM PUT THE FOLLOWING: 1). DETAILS OF PERFORATED INTERVALS, FRACTURING OR STIMULATING, PHYSICAL CHANGE, ETC. 2). THE WELL LOG WHICH IS A SYSTEMATIC DETAILED GEOLOGICAL RECORD OF ALL FORMATIONS INCLUDING COAL ENCOUNTERED BY THE WELLBORE.

Signed: _____

By: Rodney J. Biggs

Date: 8/11/08

RECEIVED
Office of Oil & Gas

AUG 13 2008

WV Department of Environmental Protection

JAN 23 2009

WYO 2019
616Z 01M