

10990.00'

LATITUDE 37°45'00"

PROPOSED WELL COORDINATES

N:259044.35
E:1844362.68
WV SOUTH ZONE
NAD 27

Rebar with aluminum cap stamped "Georgia Pacific"

PARDEE RESOURCES GROUP INC.
Mineral TM. 130 par. 20

BETTY JANE LEWIS
LOT A mineral
TM. 137 par. 5.1
LOT B fee
TM. 137 par. 5
LOT C surface
TM. 137 par. 6

Rebar with aluminum cap stamped "Georgia Pacific"

PLUM CREEK TIMBER LANDS LP.
surface TM. 107 par. 1
WYOMING LAND, LLC
mineral TM. 107 par. 1

PROPOSED WELL
WPHC-008A
SEE DETAIL

REFERENCES

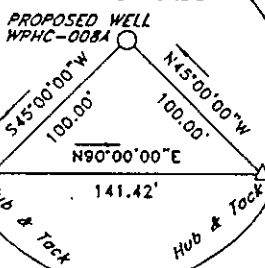

TOPO LOCATION
7.5'
MATHENY, QUAD

DETAIL

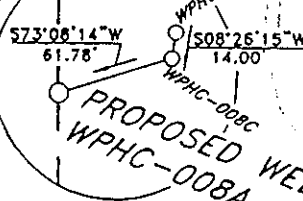

(+) DENOTES LOCATION OF WELL ON UNITED STATES TOPOGRAPHIC MAPS

FILE NO. _____
DRAWING NO. _____
SCALE 1"=1000'
MINIMUM DEGREE OF ACCURACY 1:20000
PROVEN SOURCE OF ELEVATION GPS DISK NO. 1
ELEVATION 2347.149

I THE UNDERSIGNED, HEREBY CERTIFY THAT THIS PLAT IS CORRECT TO THE BEST OF MY KNOWLEDGE AND BELIEF AND SHOWS ALL THE INFORMATION REQUIRED BY LAW AND THE REGULATIONS ISSUED AND PRESCRIBED BY THE DEPARTMENT OF ENVIRONMENTAL PROTECTION.

(SIGNED) Bryant W. Bowman
R.P.E. _____ L.L.S. 736

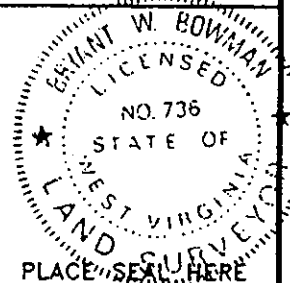

STATE OF WEST VIRGINIA
DEPARTMENT OF ENVIRONMENTAL PROTECTION
OIL AND GAS DIVISION



DATE JULY 24, 2003
OPERATOR'S WELL NO. WPHC-008A
API WELL NO. _____

47 - 109 - 02311C
STATE COUNTY PERMIT

WELL TYPE: OIL ___ GAS ___ LIQUID INJECTION ___ WASTE DISPOSAL ___
(IF "GAS.") PRODUCTION ___ STORAGE ___ DEEP ___ SHALLOW ___
LOCATION: ELEVATION 2390.65 WATERSHED SOW BRANCH OF LAUREL FORK
DISTRICT SLAB FORK COUNTY WYOMING
QUADRANGLE MATHENY, WV

SURFACE OWNER PLUM CREEK TIMBER LANDS LP. ACREAGE 30000±
OIL & GAS ROYALTY OWNER PENN VIRGINIA OIL & GAS CORPORATION LEASE ACREAGE 30000±
LEASE NO. _____

PROPOSED WORK: DRILL CONVERT ___ DRILL DEEPER ___ REDRILL ___ FRACTURE OR
STIMULATE ___ PLUG OFF OLD FORMATION ___ PERFORATE NEW
FORMATION ___ OTHER PHYSICAL CHANGE IN WELL (SPECIFY) _____

PLUG AND ABANDON ___ CLEAN OUT AND REPLUG ___
TARGET FORMATION Barry + Poca Coals ESTIMATED DEPTH 1850'
WELL OPERATOR PENN VIRGINIA OIL & GAS CORPORATION DESIGNATED AGENT MR. HARRY JEWEL
ADDRESS 2550 EAST STONE DRIVE SUITE 110 ADDRESS PO BOX 460
KINGSPORT, TN 37660 RAVENCLIFF, WV 25913

WYO COUNTY NAME PERMIT 2311C

SEP 05 2003

State of West Virginia
Division of Environmental Production
Section of Oil and Gas
Well Operator's Report of Well Work

Farm Name Plum Creek Timber Company

Operator Well No.: WPHC-008A

LOCATION: Elevation: 2390.65

Quadrangle: Matheny 7 1/2'

District: Slab Fork County: Wyoming
Latitude: 14520 Feet South of 37 Deg. 45 Min. 00 Sec.
Longitude: 10990 Feet West of 81 Deg. 30 Min. 00 Sec.

Company:

Penn Virginia Oil & Gas Corporation

| | Casing and Tubing | Used in drilling | Left in well | Cement fill up Cu. Ft. |
|---|-------------------|------------------|--------------|------------------------|
| Address: 2550 East Stone Drive, Suite 110 | 13 3/8" | 31' | 31' | 0 |
| Kingsport, TN 37660 | 9 5/8" | 258' | 258' | 95 |
| Agent: Harry Jewell | 7" | 1375' | 1375' | 235 |
| Inspector: Ralph Triplett | | | | |
| Date Permit Issued: 09/04/2003 | | | | |
| Date Well Work Commenced: 09/04/2003 | | | | |
| Date Well Work Completed: 12/04/2003 | | | | |
| Verbal Plugging: | | | | |
| Date Permission granted on: | | | | |
| Rotary X Cable Rig | | | | |
| Total Depth (feet): 1,385 | | | | |
| Fresh Water Depth (ft): | | | | |
| Salt Water Depth (ft): | | | | |
| Is coal being mined in area (N/Y)? | | | | |
| Coal Depths (ft): | | | | |

OPEN FLOW DATA

Pocahontas #6

Producing formation Lower Beckley & Penn 6 Coals (Production via 008B & C) Pay zone depth (ft) _____

Gas: Initial open flow _____ MCF/d Oil: Initial open flow _____ Bbl/d
 Final open flow _____ MCF/d Final open flow _____ Bbl/d
 Time of open flow between initial and final tests: _____ Hours
 Static rock pressure _____ psig (surface pressure) after _____ Hours

Second producing formation _____ Pay zone depth (ft) _____

Gas: Initial open flow _____ MCF/d Oil: Initial open flow _____ Bbl/d
 Final open flow _____ MCF/d Final open flow _____ Bbl/d
 Time of open flow between initial and final tests: _____ Hours
 Static rock pressure _____ psig (surface pressure) after _____ Hours

NOTE: ON BACK OF THIS FORM PUT THE FOLLOWING: 1). DETAILS OF PERFORATED INTERVALS, FRACTURING OR STIMULATING, PHYSICAL CHANE, TEC. 2). THE WELL LOG WHICH IS A SYSTEMATIC DETAILED GEOLOGICAL RECORD OF ALL FORMATIONS, INCLUDING COAL ENCOUNTERED BY THE WELLBORE.

Signed: _____
By: Michael S. Dampier
Date: 12/09/2004

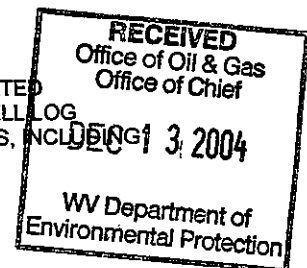

DEC 30 2004

WYO 2311 C

DETAILS OF PERFORATIONS, FRACTURING, OR PHYSICAL CHANGE, ETC.

| <u>FORMATIONS</u> | <u>TOP (TVD)</u> | <u>BOTTOM (TVD)</u> | <u>REMARKS</u> |
|-------------------------|------------------|---------------------|--------------------|
| Sandstone, Shale & Coal | 0 | 1622.06 | |
| Lower Beckley Coal | 1622.06 | 1625.06 | Drilled Horizontal |
| Sand & Shale | 1625.06 | 1780.46 | |
| Pocahontas #6 Coal | 1780.46 | 1785.46 | Drilled Horizontal |