

**CNX Gas Company LLC**  
Well No. PHL13AHS

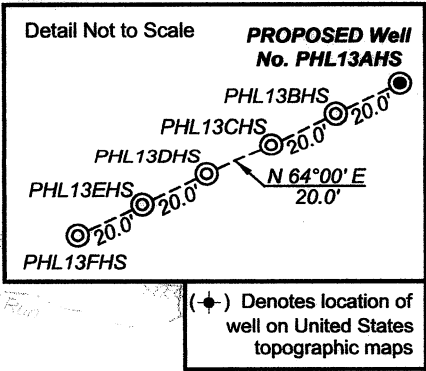

**Notes:**  
West Virginia Coordinate System of 1927, North Zone based upon Differential GPS Measurements.  
Well PHL13AHS Top Hole coordinates are  
N: 261,730.68 Latitude: 39-13-02.89  
E: 1,854,811.32 Longitude: 80-00-44.77  
Landing coordinates are  
N: 261,455.00 Latitude: 39-13-00.24  
E: 1,856,190.48 Longitude: 80-00-27.22  
Bottom Hole coordinates are  
N: 256,356.42 Latitude: 39-12-09.99  
E: 1,858,873.06 Longitude: 79-59-52.78  
**UTM Zone 17, NAD 1983**  
Top Hole Coord: Landing Coord: Btm Hole Coord:  
N: 4,341,385.19m N: 4,341,308.18m N: 4,339,768.38m  
E: 585,270.43m E: 585,692.02m E: 586,535.14m  
Plat orientation and corner and well references are based upon the grid north meridian.  
Well location references are based upon the magnetic meridian.



**Legend**

- Proposed gas well
- Found monument, as noted
- Tax Map / Parcel
- Existing Well
- Existing Road
- Surface boundary (approx.)
- Creek or Drain

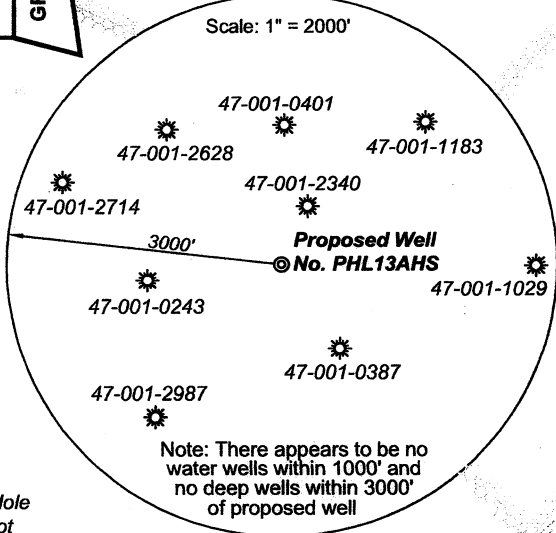

	Bearing	Distance
L1	S 22°28' W	744.6'
L2	N 84°31' E	1467.9'
L3	N 31°26' W	693.1'
L4	S 87°43' E	684.5'

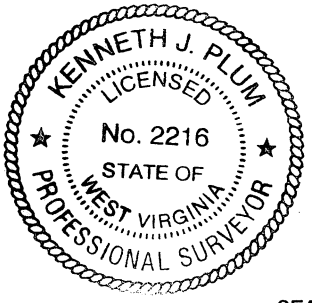
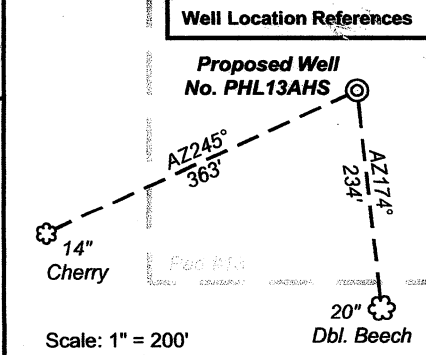

Bottom Hole 7.5' Spot

*I, the undersigned, hereby certify that this plat is correct to the best of my knowledge and belief and shows all the information required by law and the regulations issued and prescribed by the Department of Environmental Protection.*

*Kenneth J. Plum*  
Kenneth J. Plum, P.S. 2216

FILE NO: 156-10-P-10  
DRAWING #: 156-10 PHL13AHS Well Plat  
SCALE: 1" = 1000'  
MINIMUM DEGREE OF ACCURACY: Submeter  
PROVEN SOURCE OF ELEVATION: CORS Glenville, WV

**STATE OF WEST VIRGINIA**  
DEPARTMENT OF ENVIRONMENTAL PROTECTION  
**OFFICE OF OIL AND GAS**

DATE: September 30 20 11  
OPERATOR'S WELL NO. PHL13AHS  
API WELL NO:  
47 - 001 - 03220  
STATE COUNTY PERMIT

WELL TYPE:  OIL  GAS  LIQUID INJECTION  WASTE DISPOSAL  
(IF GAS) PRODUCTION:  STORAGE  DEEP  SHALLOW  
LOCATION: ELEVATION: 1520' WATERSHED Mitchell Run  
QUADRANGLE: Philippi DISTRICT: Pleasant COUNTY: Barbour  
SURFACE OWNER: Randall McCauley Peggy Chesser Sjoberg, et al; DV014571 ACREAGE: 20 170  
Oil and Gas Royalty Owner: Gary McCauley, et al; Roger Scott Mitchell; Ralph Plum, et ux Pristine Resources, Inc.; Claris McDaniel, et al; 071053; 070676 63; 200; 35  
LEASE NO: 70667; 70641; 70644, ACREAGE: 92; 86.81  
PROPOSED WORK:  DRILL  CONVERT  DRILL DEEPER  FRACTURE OR STIMULATE  PLUG OFF OLD FORMATION  
 PERFORATE NEW FORMATION  OTHER PHYSICAL CHANGE IN WELL (SPECIFY)  
 PLUG AND ABANDON  CLEAN OUT AND REPLUG TARGET FORMATION: Marcellus Shale ESTIMATED DEPTH: 7,970' TVD 15,260' TMD

WELL OPERATOR: CNX Gas Company LLC DESIGNATED AGENT: Kent Wright  
ADDRESS: P.O. Box 1248 ADDRESS: P.O. Box 1248  
Jane Lew, WV 26378 Jane Lew, WV 26378

12/23/2011