

SURFACE OWNERS		
A	MELVIN AND RENEE HOWDERSHOLT	TM 19 PAR. 41
B	MELVIN AND RENEE HOWDERSHOLT	TM 19 PAR. 40
C	IRA G. AND CAROL HOVATTER	TM 19 PAR. 38
D	NEW HOPE VALLEY CHURCH	TM 19 PAR. 42
E	NEW HOPE VALLEY U.M. CHURCH	TM 19 PAR. 38.1
F	CHURCH LOT	
G	IRA G. AND CAROL HOVATTER	TM 19 PAR. 43
H	BETTY L. KELLEY ET AL	TM 19 PAR. 47
I	RONALD AUVIL	TM 19 PAR. 50
J	ELWOOD AND PENNY CANFIELD	TM 19 PAR. 41.5
K	ELWOOD CANFIELD	TM 19 PAR. 41.2
L	ERIC AND LISA EVIX	TM 19 PAR. 41.3
M	ERIC HOWDERSHOLT	TM 19 PAR. 41.4
N	MELVIN AND RENEE HOWDERSHOLT	TM 19 PAR. 41.1
O	LORETHA M. ANNON LEGACY TRUST ET AL	TM 19 PAR. 51
P	GLEN MOORE ET UX	TM 18 PAR. 08
Q	DORSEY AND MAUDIE POLING ET AL	TM 18 PAR. 07
R	THOMAS W. OWENS	TM 18 PAR. 10
S	THOMAS W. OWENS	TM 18 PAR. 09
T	ELBERT McLEAN ET UX	TM 18 PAR. 39
U	MARK AND ELOISE HOLLEN	TM 18 PAR. 30
V	THOMAS AND RAMILE POLING	TM 18 PAR. 32
W	PAUL AND JOHN ADAMS	TM 18 PAR. 31
X	TRACY JO MARSH KNOTTTS	TM 18 PAR. 28
Y	CARL DAUGHERTY HRS	TM 18 PAR. 33
Z	JAMES B. ANCELL	TM 26 PAR. 01
AA	JAMES B. ANCELL	TM 26 PAR. 02
BB	ROMMELL FAMILY TRUST	TM 26 PAR. 05
CC	ROMMELL FAMILY TRUST	TM 26 PAR. 05.1
DD	KEVIN KLINGENSMITH ET UX	TM 26 PAR. 06
EE	JOHN SHAFFER ET AL	TM 26 PAR. 03.1
FF	HARRY T. SHAFFER ET AL	TM 26 PAR. 03
GG	GERTRUDE HALLER	TM 26 PAR. 04
HH	MARY MOCCIO	TM 04 PAR. 05
II	MARY MOCCIO	TM 04 PAR. 06
JJ	BRIAN PURKEY ET AL	TM 04 PAR. 01
KK	JERRY D. HALLER ET UX	TM 26 PAR. 4.1
LL	GLEN MOORE ET UX	TM 16 PAR. 13

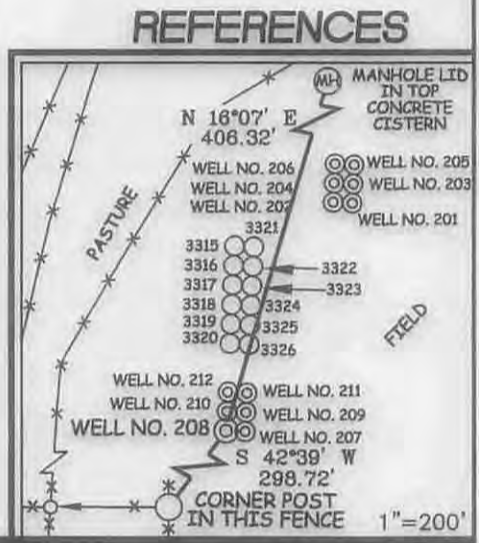

LATERAL ROYALTY OWNERS		
1	MELVIN HOWDERSHOLT ET UX	158.94 AC±
2	PAUL ADAMS	109 AC±
3	JOHN ADAMS ET UX	174 AC±
4	THOMAS POLING	179.02 AC±



I THE UNDERSIGNED, HEREBY CERTIFY THAT THIS PLAT IS CORRECT TO THE BEST OF MY KNOWLEDGE AND BELIEF AND SHOWS ALL THE INFORMATION REQUIRED BY LAW AND THE REGULATIONS ISSUED AND PRESCRIBED BY THE DIVISION OF ENVIRONMENTAL PROTECTION.

P.S. *C. Victor Moyers*
 849



(+) DENOTES LOCATION OF WELL ON UNITED STATES TOPOGRAPHIC MAPS.
 DATE JULY 14, 20 14
 REVISED _____, 20 _____
 OPERATORS WELL NO. 208
 API WELL NO. 47-001-0322
 STATE COUNTY PERMIT

MINIMUM DEGREE OF ACCURACY 1/2500 FILE NO. 7962P208R5
 HORIZONTAL & VERTICAL CONTROL DETERMINED BY DGPS (SURVEY GRADE TIE TO CORS NETWORK) SCALE 1" = 2000'

STATE OF WEST VIRGINIA
 DIVISION OF ENVIRONMENTAL PROTECTION
 OFFICE OF OIL AND GAS

WELL TYPE: OIL _____ GAS X LIQUID INJECTION _____ WASTE DISPOSAL _____ IF "GAS" PRODUCTION X STORAGE _____ DEEP _____ SHALLOW X

LOCATION:
 ELEVATION 1,568' (GROUND) 1,557' (PROPOSED) WATERSHED BRUSHY FORK OF TETER CREEK
 DISTRICT COVE COUNTY BARBOUR QUADRANGLE NESTORVILLE 7.5'

SURFACE OWNER MELVIN AND RENEE HOWDERSHOLT ACREAGE 158.94±
 ROYALTY OWNER MELVIN AND RENEE HOWDERSHOLT ACREAGE 158.94±

PROPOSED WORK:
 DRILL X CONVERT _____ DRILL DEEPER _____ REDRILL _____ FRACTURE OR STIMULATE X PLUG OFF OLD FORMATION _____ PERFORATE NEW FORMATION _____ PLUG AND ABANDON _____ CLEAN OUT AND REPLUG _____ OTHER _____

PHYSICAL CHANGE IN WELL (SPECIFY) _____ TARGET FORMATION MARCELLUS
 ESTIMATED DEPTH TVD 7,845' / TMD 15,244'

WELL OPERATOR MOUNTAINEER KEYSTONE LLC DESIGNATED AGENT NATHAN SKEEN
 ADDRESS 1111 VAN VOORHIS ROAD, SUITE G ADDRESS 1111 VAN VOORHIS ROAD, SUITE G
MORGANTOWN, WV 26505 MORGANTOWN, WV 26505

12/12/14

COUNTY NAME PERMIT