

506734 P

WW-7
8-30-06



West Virginia Department of Environmental Protection
Office of Oil and Gas
WELL LOCATION FORM: GPS

API: 47-005-00734 WELL NO.: WV 460601 (Moore W-9045)

FARM NAME: Moore

RESPONSIBLE PARTY NAME: EQT Production Company

COUNTY: Boone DISTRICT: Scott

QUADRANGLE: Julian 7.5'

SURFACE OWNER: Robin Land Company

ROYALTY OWNER: Sonny Joe Harvey et. al.

UTM GPS NORTHING: 4223525

UTM GPS EASTING: 426398 GPS ELEVATION: 314 m (1032 ft)

The Responsible Party named above has chosen to submit GPS coordinates in lieu of preparing a new well location plat for a plugging permit or assigned API number on the above well. The Office of Oil and Gas will not accept GPS coordinates that do not meet the following requirements:

1. Datum: NAD 1983, Zone: 17 North, Coordinate Units: meters, Altitude: height above mean sea level (MSL) – meters.
2. Accuracy to Datum – 3.05 meters
3. Data Collection Method:

Survey grade GPS : Post Processed Differential
Real-Time Differential

Mapping Grade GPS X: Post Processed Differential X
Real-Time Differential

RECEIVED
Office of Oil and Gas

APR 26 2013

WV Department of Environmental Protection

4. Letter size copy of the topography map showing the well location.

I the undersigned, hereby certify this data is correct to the best of my knowledge and belief and shows all the information required by law and the regulations issued and prescribed by the Office of Oil and Gas.

Ben Singleton
Signature
4-9-2013
Date

P.S. 2092
Title

05/17/2013

500734P

Topo Quad: Julian 7.5'

Scale: 1" = 2000'

County: Boone

Date: April 8, 2013

District: Scott

Project No: 140-16-00-07

Moore W-9045 WV 460601 (47-005-00734)

Topo

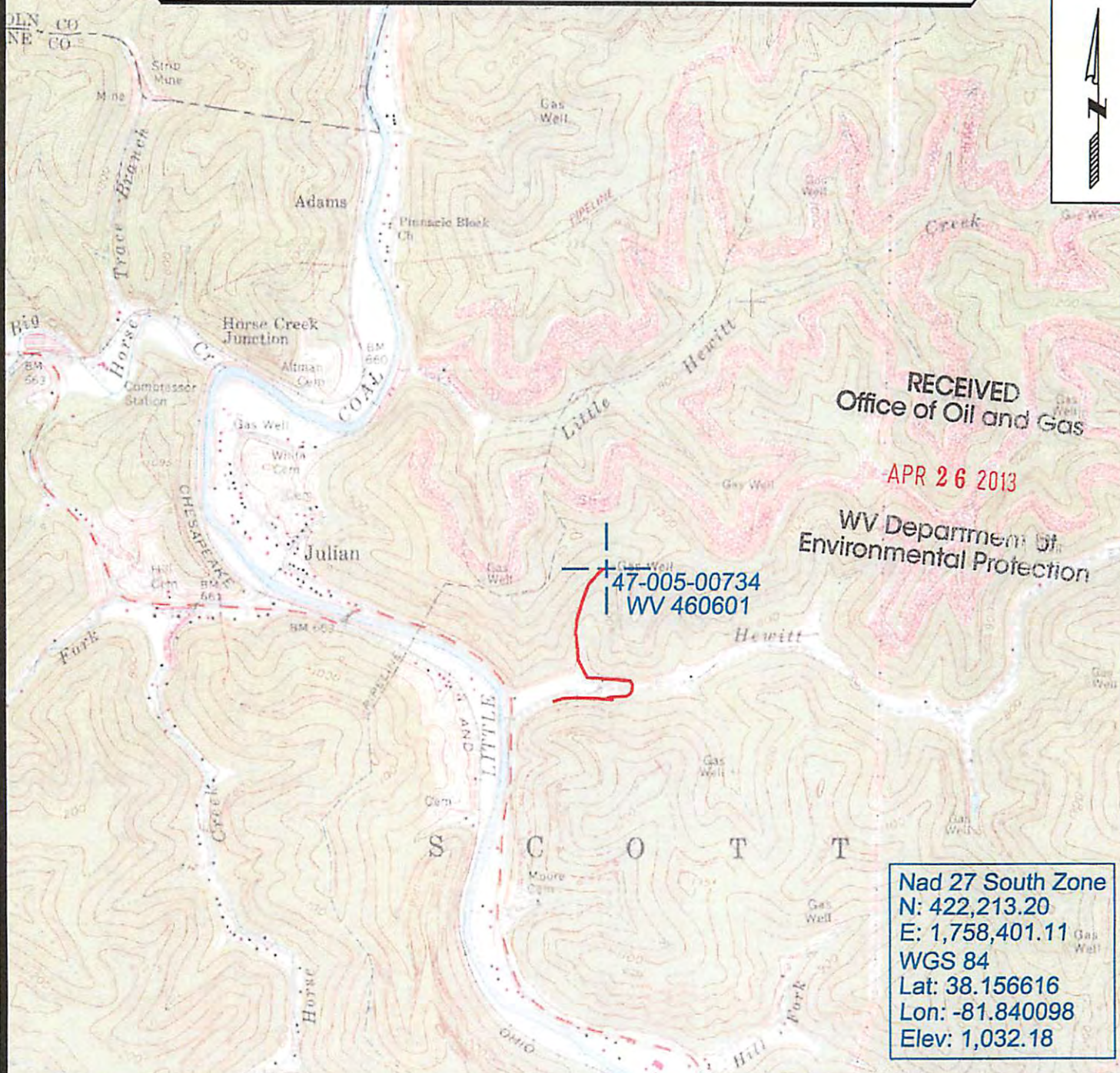

SURVEYING AND MAPPING SERVICES PERFORMED BY:
ALLEGHENY SURVEYS, INC.

1-800-482-8606
P.O. BOX 438
BIRCH RIVER, WV 26610
PH: (304) 649-8606
FAX: (304) 649-8608

PREPARED FOR:

EQT Production Company

1710 Pennsylvania Ave.
Charleston, WV 25302

05/17/2013