

WELL SITE	
STATE PLANE WV SOUTH ZONE NAD 1927	
N - 404,131.542 : E - 1,741,175.858	
LATITUDE: (N) 38.1064190°	
LONGITUDE: (W) 82.8995435°	
UTM NAD83	
17 - 84W TO 78W, METERS	
N - 4,218,015.447 : E - 421,149.369	

FILE NO.	802599P&A.DGN
DRAWING NO.	802599P&A
SCALE	1" = 1000'
MINIMUM DEGREE OF ACCURACY	1:200
PROVEN SOURCE OF ELEVATION	MAPPING GRADE GPS

I THE UNDERSIGNED, HEREBY CERTIFY THAT THIS PLAT IS CORRECT TO THE BEST OF MY KNOWLEDGE AND BELIEF AND SHOWS ALL THE INFORMATION REQUIRED BY LAW AND THE REGULATIONS ISSUED AND PRESCRIBED BY THE DEPARTMENT OF ENVIRONMENTAL PROTECTION.

(SIGNED) *Paul E. Miller*

R.P.E. \_\_\_\_\_ L.L.S. 647

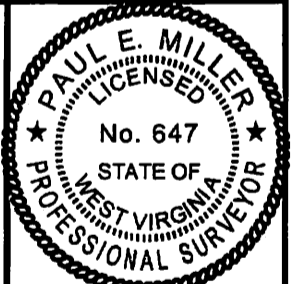

STATE OF WEST VIRGINIA  
DIVISION OF ENVIRONMENTAL PROTECTION  
OIL AND GAS DIVISION

DATE JANUARY 4, 2016

OPERATOR'S WELL NO. 802599

API WELL NO. \_\_\_\_\_

47 005 00789 P  
STATE COUNTY PERMIT

WELL TYPE: OIL  GAS  LIQUID INJECTION  WASTE DISPOSAL   
(IF "GAS,") PRODUCTION  STORAGE  DEEP  SHALLOW

LOCATION: ELEVATION 1,205' WATER SHED BIG HORSE CREEK OF LITTLE COAL RIVER  
DISTRICT SCOTT COUNTY BOONE  
QUADRANGLE MUD. WV 7.5'

SURFACE OWNER RUSSELL W. & TERESA P. SILVA ACREAGE 40.30  
OIL & GAS ROYALTY OWNER STEPHEN A. BALL, et. al. LEASE ACREAGE 40.30 LEASE NO. 1-020108 **02/05/2016**

PROPOSED WORK: DRILL  CONVERT  DRILL DEEPER  REDRILL  FRACTURE OR STIMULATE  PLUG OFF OLD FORMATION  PERFORATE NEW FORMATION  OTHER PHYSICAL CHANGE IN WELL (SPECIFY) \_\_\_\_\_

PLUG AND ABANDON  CLEAN OUT AND REPLUG

TARGET FORMATION \_\_\_\_\_ ESTIMATED DEPTH \_\_\_\_\_

WELL OPERATOR CHESAPEAKE APPALACHIA, L.L.C. DESIGNATED AGENT JESSICA GREATHOUSE  
ADDRESS P.O. BOX 18496, OKLAHOMA CITY, OK 73154-0496 ADDRESS CHESAPEAKE APPALACHIA, L.L.C. PO BOX 6070, CHARLESTON, WV 25362

FORM WW-6

COUNTY NAME  
PERMIT

500789P

CHESAPEAKE APPALACHIA, L.L.C.

TOPOGRAPHICAL MAP OF ACCESS AND  
WELL LOCATION 802599

API 47-005-00789

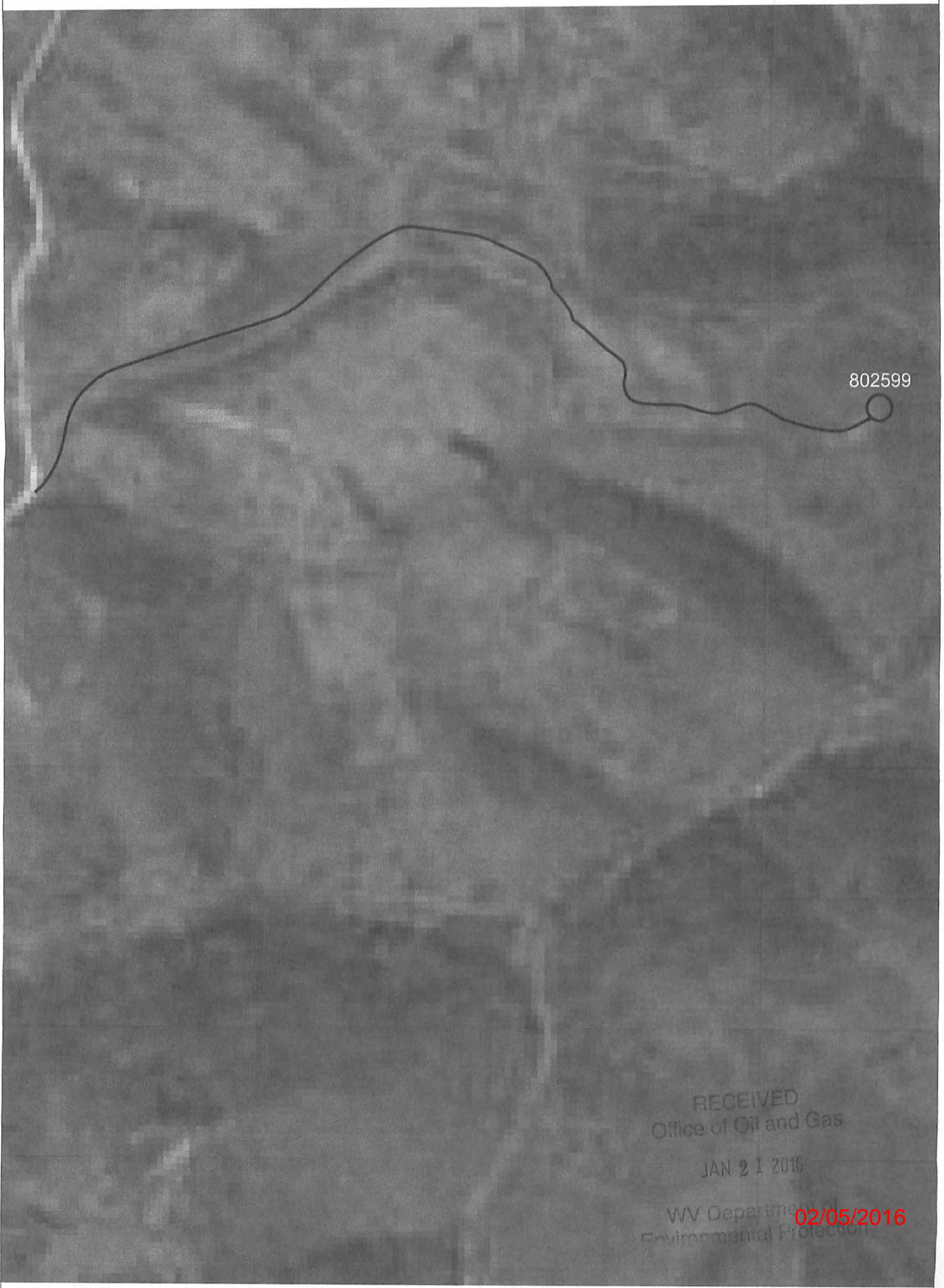

802599

RECEIVED  
Office of Oil and Gas

JAN 21 2016

WV Department of  
Environmental Protection 02/05/2016