

CO: 005 PMT: 794
Loc Digitized from OGIS 7.5' Mylar
QUAD: 325 DATE: 9-FEB-90
LAT: 38 00.0 Miles South: 0.92
LONG: 81 30.0 Miles West : 0.011

195
4.5W

81 27 30
31 25

COAL RIVER MINING AND LUMBER CO.

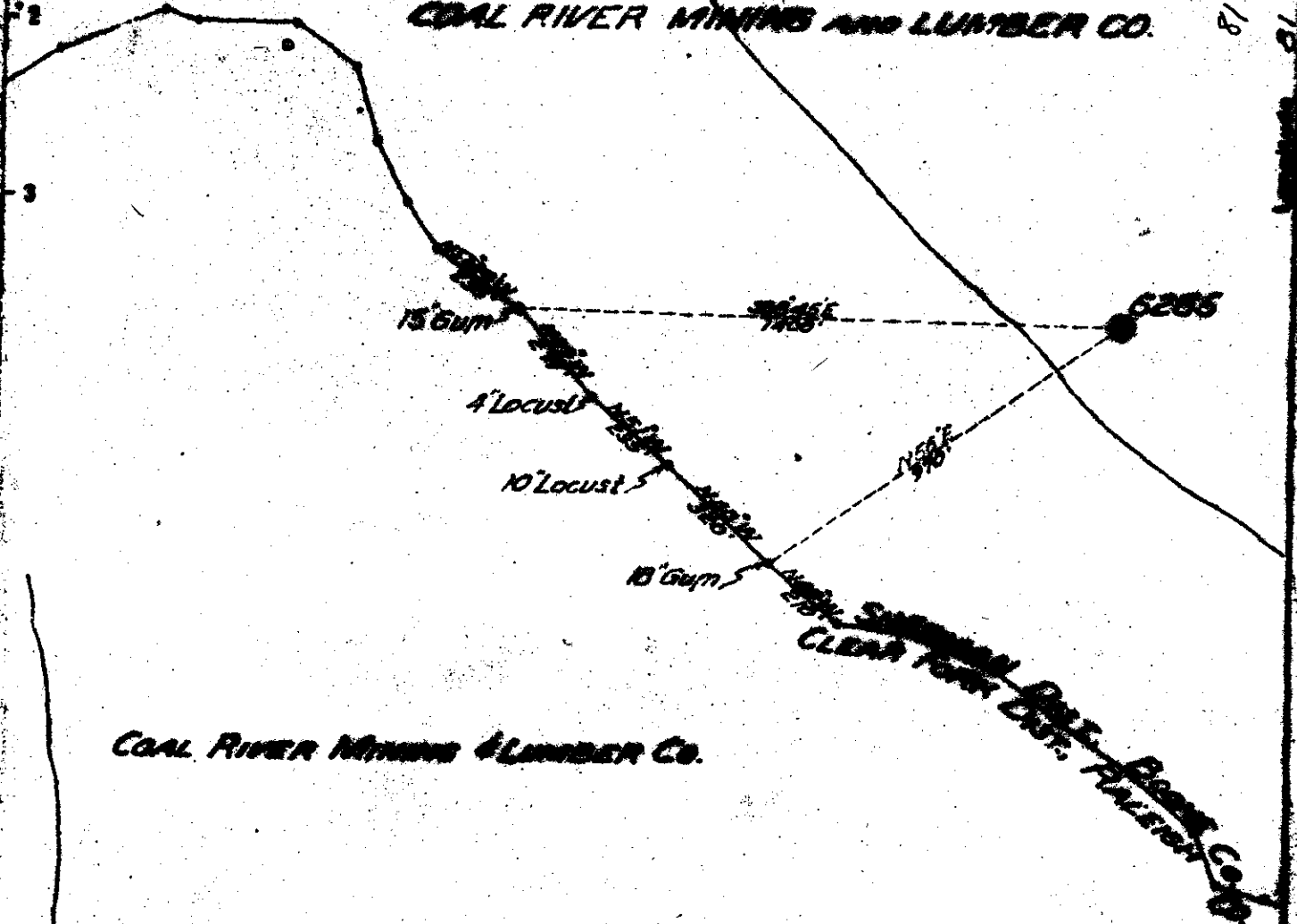

New Location
Drill Bore
Abandoned

Company UNITED FUEL GAS CO
 Address CHARLESTON, W. VA
 From COAL RIVER MINING LUMBER CO
 Tract Area 2000 Lease No. 17120
 Well (Form) No. 3 Serial No. 6285
 Elevation (Spirit Level) 1878.00'
 Quadrangle ECCLES Doc 75
 County BOONE District SANDWELL
 Engineer H
 Engineer's Registration No. 582
 File No. 62-22 Drawing No.
 Sheet 1 of 1

STATE OF WEST VIRGINIA
DEPARTMENT OF MINES
OIL AND GAS DIVISION
CHARLESTON

WELL LOCATION MAP
FILE NO. 600-794

• Denotes location of well on United States
Topographic Map, sects 1 to 36, lat-
itude and longitude lines being represented
by double lines as shown.
• Denotes one inch spaces on border line
of original map.

WEST VIRGINIA DEPARTMENT OF MINES
OIL & GAS DIVISION
W E L L R E C O R D

Permit No. Boo 794
Eccles Quad.
Company
Address
Farm
Location
Well No.
District
Surface
Mineral

Gas Well
CASING & TUBING

United Fuel Gas Co.
P.O. Box 1273, Charleston 25, W.Va.
Coal River Mining and Lumber Co. A 3000
Sang Cr. 10 1/2 1127 1127
6265 Elev. 1870.6 Gr. 8 5/8 2337 2337
Sherman Boone County 7 2927 2927

Coal River Mining and Lumber Co.
Cumberland, Maryland

Commenced 5-6-48 Coal at 19' 12"; 105'
Completed 9-15-48 24"; 314' 48"; ~~164' 60"~~; 618' 24"
Date shot 9-20-48 Depth 3235 to 3343 with 1000# Det.
Open flow 10/10ths W in 2" 661' 36"; 865' 36"
Volume 133 M Weir
Rock Pressure 446 lbs. 48 hrs.
Fresh Water 318'
Salt Water 1750'

JUN - 7 1949

Soil.	0	6	Lime	2238	2282
Sand	6	19	Sand	2282	2317
Coal	19	20	Lime	2317	2343
Sand	20	96	Red Rock	2343	2368
Slate	96	105	Lime	2368	2409
Coal	105	107	Slate & Shells	2409	2520
Sand	107	164	Red Rock	2520	2562
Coal	164	169	Slate & Shells	2562	2713
Slate	169	189	Sand	2713	2732
Lime	189	220	Slate	2732	2752
Sand	220	292	Pencil Cave	2752	2758
Slate	292	314	L. Lime	2758	2821
Coal	314	318	Slate	2821	2826
Slate & Shells	318	340	L. Lime Black	2826	2900
Sand	340	404	Black Lime	2900	3136
Slate	404	459	Injun Sand	3136	3173
Lime	459	498	Slate	3173	3235
Slate & Shells	498	597	W. Sand	3235	3337
Sand	597	618	Slate	3337	3343
Coal	618	820	Total Depth		3343
Slate	620	642	Gas 1890' show - no test		
Lime	642	661	Gas 2912' show. no test		
Coal	661	664	Gas 3059' show		
Slate	664	680	Gas 3303-3312 18/10 W 1" 45 M		
Sand	680	707			
Slate & Shells	707	739	Test B.S. 16/10 W 1" 42 M		
Sand	739	790	Shot 9-20-48 with 1000# Det. 3235-3343		
Slate	790	841	Test when shut in 10/10 W 2" 133 M		
Lime	841	860			
Sand	860	865	Open flow 133 M Weir		
Coal	865	868	48 hr. R.P. 446#		
Sand	868	902	Shut in 10-11-48 in 7" casing		
Lime	902	942			
Slate	942	1055			
Sand	1055	1084			
Slate & Shells	1084	1215			
Sandy Lime	1215	1254			
Sand	1254	1299			
Slate & Shells	1299	1309			
Sand	1309	1535			
Lime	1535	1551			
Salt Sand	1551	1827			
Slate	1827	1834			
Salt Sand	1834	1955			
Slate	1955	1966			
Lime	1966	2012			
Slate	2012	2019			
Sand	2019	2069			
Sandy Lime	2069	2177			
Slate & Shells	2177	2238			
Red Rock	2238	2238			