

REVISED
4-13-62

NOTE -
Coal Leased to Armco Steel.
Location is on 189.57th Tract
which is not operated.

New Location
Drill Deeper
Abandonment

new plots coming

Company	<i>Boone East Dev.</i> UNITED FUEL GAS CO.
Address	CHARLESTON, W.VA.
Farm	E. J. BERWIND
Tract	Acres <i>4,236</i> Lease No. <i>16903</i>
Well (Farm) No.	<i>8</i> Serial No. <i>9169</i>
Elevation (Spirit Level)	<i>1672.34</i>
Quadrangle	<i>BALE KNOS</i> Whitesville
County	BOONE District <i>CROOK</i>
Engineer	<i>Seybert R. Howell</i>
Engineer's Registration No.	<i>2529</i>
File No.	<i>09-29</i> Drawing No.
Date	<i>2-12-62</i> Scale <i>1" = 800'</i>

STATE OF WEST VIRGINIA
DEPARTMENT OF MINES
OIL AND GAS DIVISION
CHARLESTON

WELL LOCATION MAP
FILE NO. *Boo-940 P*

+ Denotes location of well on United States
Topographic Maps, scale 1 to 62,500, lat-
itude and longitude lines being represented
by border lines as shown.
- Denotes one inch spaces on border line
of original tracing.

DEC 21 1960

Boo-940 P

7m

Latitude 38° 00'

Longitude 81° 35'

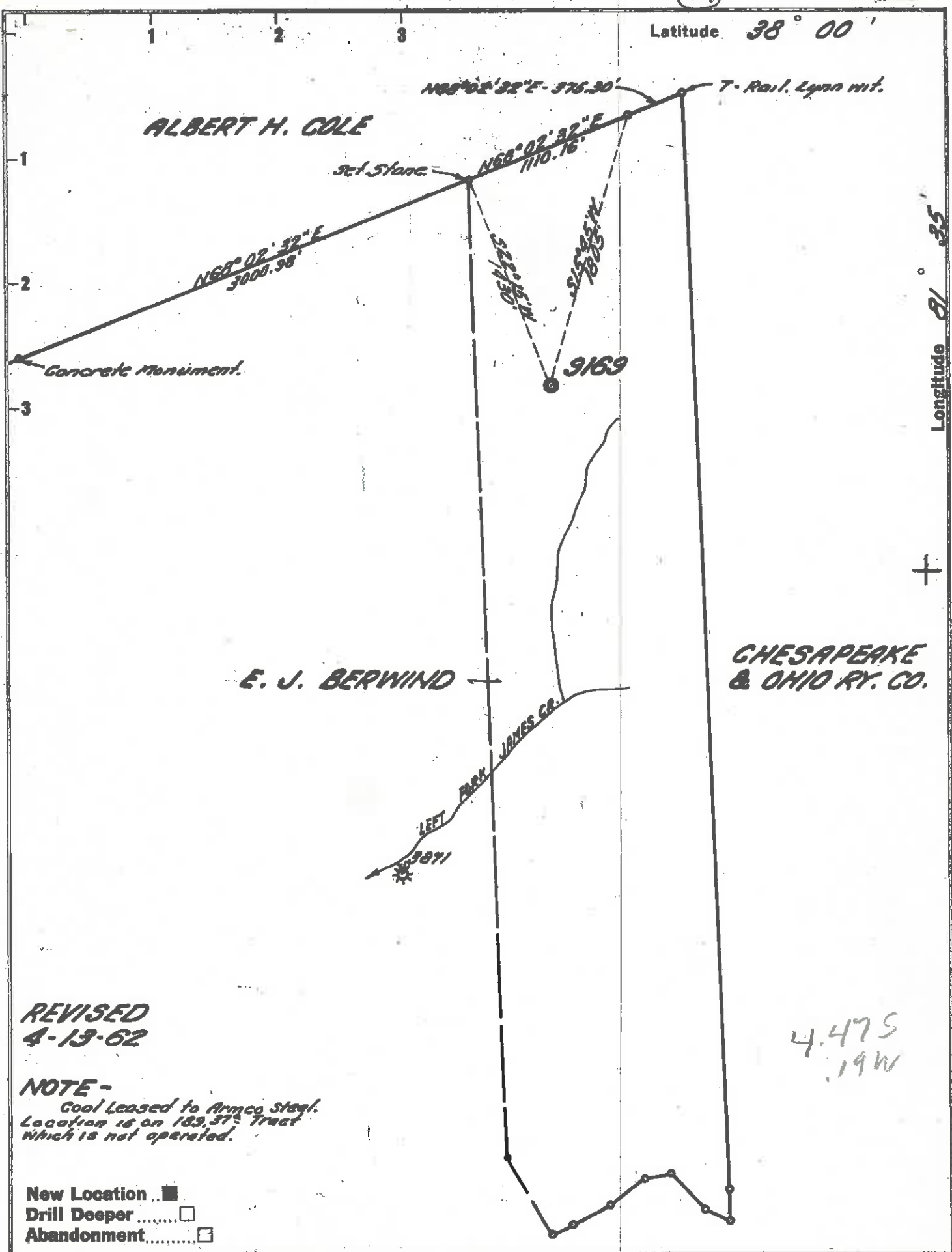

REVISED
4-13-62

NOTE -
Coal Leased to Armco Steel.
Location is on 189.37² Tract
which is not operated.

New Location

Drill Deeper

Abandonment

4.475
19W

Company	UNITED FUEL GAS CO.
Address	CHARLESTON, W.VA.
Farm	E. J. BERWIND
Tract	Acres 4,236.7 Lease No. 16203
Well (Farm) No.	8 Serial No. 9169
Elevation (Spirit Level)	1572.34'
Quadrangle	BALD KNOB NC
County	BOONE District CROOK
Engineer	Seybert R. Russell
Engineer's Registration No.	2529
File No.	84-29 Drawing No.
Date	3-13-62 Scale 1" = 800'

STATE OF WEST VIRGINIA
DEPARTMENT OF MINES
OIL AND GAS DIVISION
CHARLESTON

WELL LOCATION MAP
FILE NO. 800-940

+ Denotes location of well on United States Topographic Maps, scale 1 to 62,500, latitude and longitude lines being represented by border lines as shown.

— Denotes one inch spaces on border line of original tracing.

SAMPLES - 3224 to 3222'

6-6 ~~247~~
247



STATE OF WEST VIRGINIA
DEPARTMENT OF MINES
OIL AND GAS DIVISION /

Quadrangle Bald Knob

Permit No. B00-940

WELL RECORD

Oil or Gas Well Gas
(KIND)

Company United Fuel Gas Company
Address P.O. Box 1273 Charleston 25, W. Va.
Farm E. J. Berwind #8 Acres 4,236.5
Location (waters) James Creek
Well No. 9169 Elev. 1672.34'
District Crook County Boone
The surface of tract is owned in fee by _____
Address _____

Casing and Tubing	Used in Drilling	Left in Well	Packers
Size			Kind of Packer
16			
18 3/8		24'	
10 3/4		540	Size of
8 5/8	2218'	Pulled	
			Depth set
2 1/2	Cemented	3224'	Perf. top
2			Perf. bottom
Liners Used			Perf. top
			Perf. bottom

Mineral rights are owned by New River & Pocahontas Consolidated Coal Co.
Suite 600 Two Penn Center Plaza Philadelphia 2, Pa. 19106

Drilling commenced 8-4-62
Drilling completed 11-6-62
Date Shot _____ From _____ To _____
With _____
Open Flow 130 /10ths Water in _____ Inch
4" /10ths Merc. in _____ Inch
Volume 7,060,000 - Weir _____ Cu. Ft.
Rock Pressure 900 lbs. 48 hrs.
Oil _____ bbls., 1st 24 hrs.

CASING CEMENTED _____ SIZE _____ No. Ft. _____ Date _____

COAL WAS ENCOUNTERED AT 14 FEET 36 INCHES
92 FEET 48 INCHES 108 FEET 48 INCHES
299 FEET 48 INCHES 374 FEET 36 INCHES

WELL ACIDIZED _____

WELL FRACTURED _____

RESULT AFTER TREATMENT _____

ROCK PRESSURE AFTER TREATMENT _____

Fresh Water 112 165 Feet 655 770 1504; Salt Water _____ Feet

Formation	Color	Hard or Soft	Top	Bottom	Oil, Gas or Water	Depth	Remarks
Rock & Dirt			0	14	Water	112' 1	bailer per hour
Coal			14	17			
Slate			17	25	Water	165' 2	bailers per hour
Sand			25	88			
Slate			88	92	Water	655' 1	bailer per hour
Coal			92	96			
Slate			96	108	Water	770' 2	bailers per hour
Coal			108	112			
Slate			112	122	Hole full water	1504'	
Sand			122	145			
Slate			145	160	Show oil	1900	
Sand			160	206			
Slate			206	214	Show gas	2301-2306'	
Sand			214	252			
Slate & Shells			252	282	Gas	2785-2791'	6/10 W 2" 103 M
Sand			282	299			
Coal			299	303	Gas	3155-3163'	42/10 W 2" 273 M
Sand			303	374			
Coal			374	377	Perforated 4 1/2" casing from	3136-3140',	
Sand			377	401		3146-3155' and 3158-3162'	
Slate			401	422			
Lime			422	439	Test before fracture	10/10 W 2" 133 M	
Slate			439	482	Fractured Weir 11-13-62 with	.85,000# sand,	
Sand			482	535		824 bbls. water and 500 gallons mud acid.	
Slate			535	548	Test 24 hours after fracture	130/10 Merc.	
Sand			548	558		4" 7,060 M	
Slate & Shells			558	580			
Sand			580	595	Shut in 11-15-62 in 4 1/2" casing.		
Slate & Shells			595	622			
Sand			622	745			



Formation	Color	Hard or Soft	Top /	Bottom	Oil, Gas or Water	Depth Found	Remarks
Slate			745	758			
Lime			758	776	LOGS RUN: Gamma Ray Density Induction		
Sand			776	832			
Slate			832	847			
Gritty Lime			847	895			
Slate & Shells			895	909			
Lime Shell			909	989			
Slate & Shells			989	1154			
Sand			1154	1180			
Slate			1180	1210			
Sand			1210	1400			
Slate			1400	1445			
Sand			1445	1475			
Slate			1475	1485			
Hard Sand			1485	1799			
Lime			1799	1835			
Sand			1835	1990			
Lime			1990	2040			
Sand			2040	2096			
Lime			2096	2105			
Red Rock			2105	2114			
Black Lime			2114	2210			
Red Rock			2210	2220			
Black Lime			2220	2230			
Sand			2230	2270			
Red Rock			2270	2280			
Mason Sand			2280	2368			
Slate & Shells			2368	2384			
Red Rock & Shells			2384	2425			
Sand			2425	2450			
Lime			2450	2460			
Sand			2460	2610			
Slate & Shells			2610	2640			
Pencil Cave			2640	2657			
Little Lime			2657	2740			
Big Lime			2740	3010			
Red Injun			3010	3050			
Weir Shells			3050	3128			
Weir Sand			3128	3180			
Weir Shells			3180	3227			
Total Depth			3227'				

Date January 17, 19 63

APPROVED UNITED FUEL GAS COMPANY, Owner

By S. R. Furell
(Title)

Supt., Civil Engr. Dept.

STATE OF WEST VIRGINIA
DIVISION OF ENVIRONMENTAL PROTECTION
SECTION OF OIL AND GAS

5.00940P

AFFIDAVIT OF PLUGGING AND FILLING WELL

AFFIDAVIT SHOULD BE IN TRIPLICATE, 1 copy mailed to the Division, 1 copy to be retained by the Well Operator & the third copy (and extra copies if required) should be mailed to each coal operator at their respective addresses

Farm name: Berwind Land Co. Operator Well No.: Berwind Land 9169

LOCATION: Elevation: 1660.39 Quadrangle: WHITESVILLE
District: Crook County Boone
Latitude: 8370 Feet South of 37 Deg. 57 Min. 30 Sec. FEB 1999
Longitude: 1360 Feet West of 81 Deg. 35 Min. 00 Sec. Received Health Safety & Training

Well Type: OIL _____ Gas X

Company: Boone East Development Co.
P.O. Box 750
Charleston, WV 25064-0931

Coal Operator or Owner

Agent: Tim Comer

Coal Operator or Owner Performance Coal Co.
P.O. Box 69
Naoma, WV 25140

Permit Issued: 12/3/98

AFFIDAVIT

STATE OF WEST VIRGINIA,
County of Boone

ss:

Terry Hamrick and Ben Parson

bein

first duly sworn according to law depose and say that they are experienced in the work of plugging and filling oil and gas wells and were employed by the above named well operator, and participated in the work of plugging and

filling the above well, and Rick Campbell Oil and Gas Inspector representing the Director, say that said work was commenced on the 22 day of Dec 19 98 and that the well was plugged and filled in the following manner:

TYPE	FROM	TO	PIPE REMOVED	LEFT
Class "A" 21 Sks	3200'	3000'		24' (13 3/8")
GEL			= 2218' (8 5/8")	540' (10 3/4")
Class "A" 32 Sks	1394'	1344'	= 1394' (4 1/2")	1830' (4 1/2")
GEL				
CIB P	932'	932'		
RFC 239 Sks	932'	482'		
GEL				
Class "A" 216 Sks	400'	0		

* 6% GEL spacers between plugs

Description of monument: 4 1/2" x 8' w API No. welded on and that
the work of plugging and filling said well was completed on the 31 day of Dec, 19 98

And further deponents saith not.

Terry Hamrick

Sworn and subscribe before me this

27 day of FEBRUARY, 19 99

My commission expires NOVEMBER 27, 2006

John D. Dunlap
Notary Public

Oil and Gas Inspector:

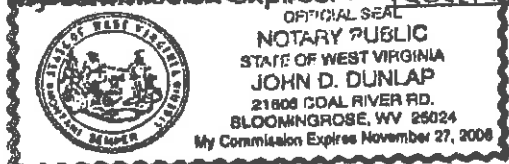

1014 2067

5.00940P