

Coordinates - A Sta.  
 354 - N 105,177.51  
 W 106,701.27  
 365 - N 170,974.75  
 W 108,869.84

Note:  
 This survey is tied into the  
 coordinate system of Eastern  
 Associated Coal Corp. (Harris Oper.)

COAL OPERATOR:  
 EASTERN ASSOCIATED COAL CORP.  
 Koppers Building  
 Pittsburgh, PA 15219

Note:  
 With the exception of stone "s"  
 all ties to property corners are  
 approximate.

7.5' 0.615 topog loc  
 0.21 S  
 0.74 W  
 15.102  
 3.09 S  
 0.14 W

New Location   
 Drill Deeper   
 Abandonment

Minimum Error of Closure:  $1'/10,000'$   
 Source of Elevation U.S.G.S. Bench Mark No. 56 AFK. el. 1440.147

"I, the undersigned, hereby certify that this map is correct to the best of my knowledge and belief and shows all the information required by paragraph 6 of the rules and regulations of the oil and gas section of the mining laws of West Virginia."

*J. H. Sturgill*

Company **TIPCO TEXAS INTERNATIONAL PETROLEUM CORPORATION**  
 Address **SUITE 740 - ONE VALLEY SQUARE CHARLESTON, WEST VIRGINIA**  
 Farm **WESTERN POCAHONTAS CORP.**  
 Tract \_\_\_\_\_ Acres 2,390 Lease No. 8087  
 Well (Farm) No. 2 Serial No. \_\_\_\_\_  
 Elevation (Spirit Level) 1445.20  
 Quadrangle 25' Pilot Knob / 15' Bald Knob  
 County Boone District Crook  
 Engineer W.V.A. SURVEYING & MAPPING, INC. - L.G. Sturgill, LLS  
 Engineer's Registration No. 412  
 File No. W75-2 W.Q.179-R Drawing No. D-224  
 Date 12-7-77 Scale 1" = 2000'

STATE OF WEST VIRGINIA  
 DEPARTMENT OF MINES  
 OIL AND GAS DIVISION  
 CHARLESTON

WELL LOCATION MAP  
 FILE NO. 005-1315 REV

+ Denotes location of well on United States Topographic Maps, scale 1 to 62,500 latitude and longitude lines being represented by border lines as shown.  
 - Denotes one inch spaces on border line of original tracing.

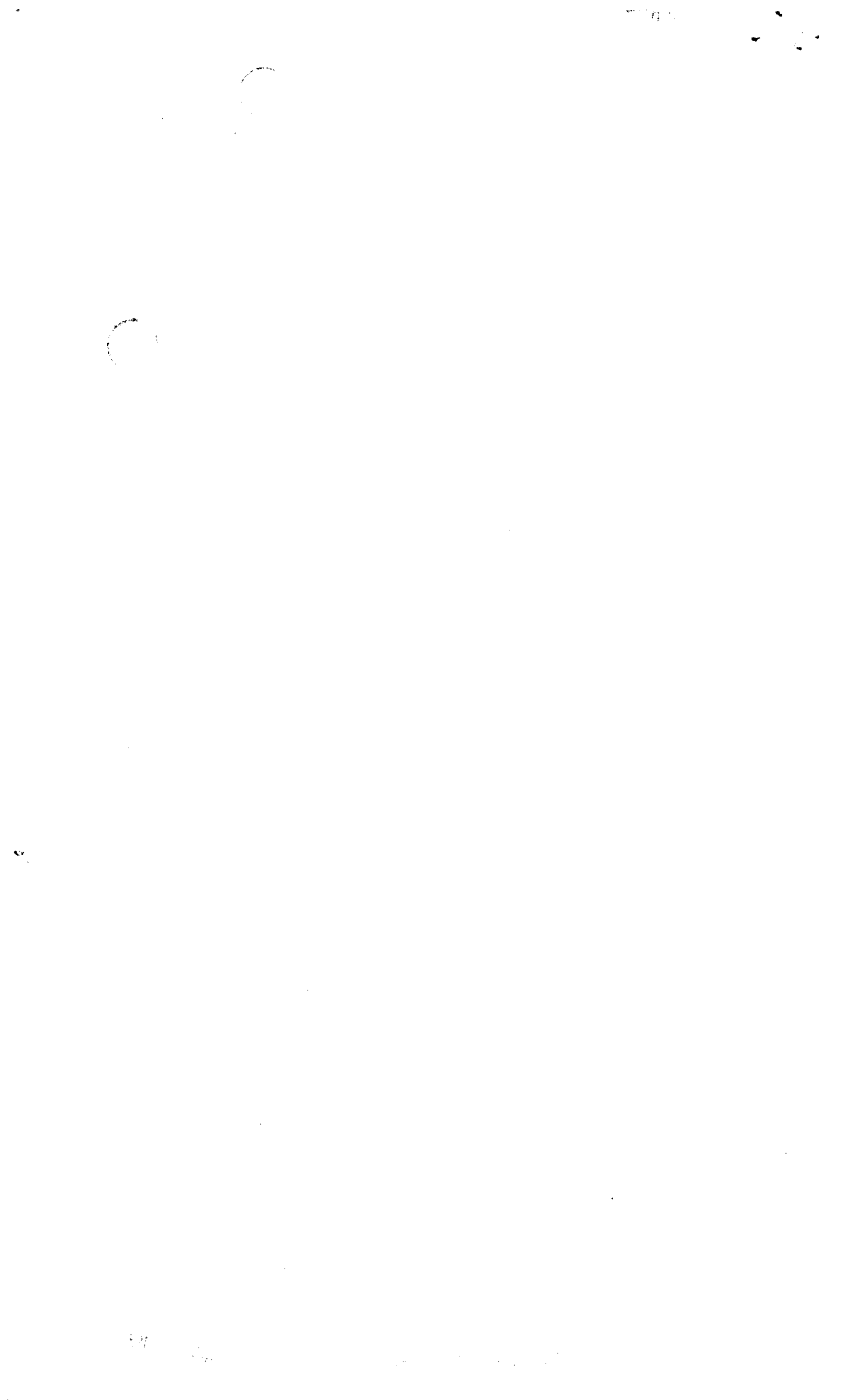

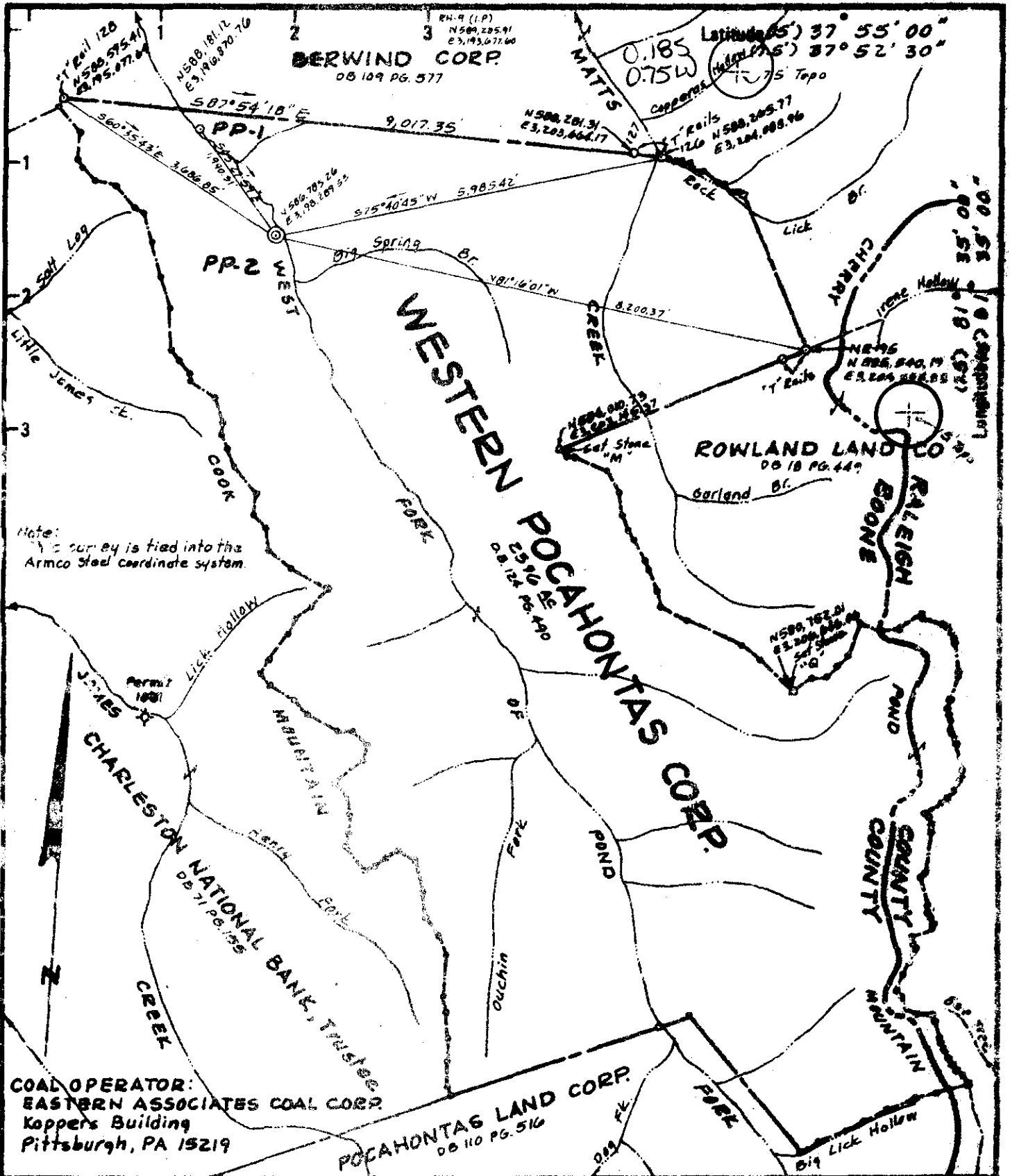

Minimum Error of Closure  $1/5000'$   
 Source of Elevation *U.S.G.S. Bench Mark No. 60 A.F.K. located on West Fork approx. 1250' downstream from Big Spring Br. El. 1440.147*  
 "I, the undersigned, hereby certify that this map is correct to the best of my knowledge and belief and shows all the information required by paragraph 6 of the rules and regulations of the oil and gas section of the mining laws of West Virginia."  
*L.S. Sturgill*

Company **TIPCO TEXAS INTERNATIONAL PETROLEUM CORPORATION**  
 Address **SUITE 740 - ONE VALLEY SQUARE CHARLESTON, WEST VIRGINIA**  
 From **WESTERN POCAHONTAS CORP.**  
 Tract \_\_\_\_\_ Acres **2.396** Lease No. **8087**  
 Well (Farm) No. **2** Serial No. \_\_\_\_\_  
 Elevation (Spirit Level) **1445.20**  
 Quadrangle **7.5' Pilot Knob / 15' Bald Knob C**  
 Section **3000E** District **Crook**  
 Engineer **MAPPING, INC. - L.S. Sturgill, LLS**  
 Engineer's Registration No. **412**  
 File No. **WVS-2 W.D. 179** Drawing No. **D-116**  
 Date **Dec. 7, 1977** Scale **1" = 2000'**

**STATE OF WEST VIRGINIA**  
 DEPARTMENT OF MINES  
 OIL AND GAS DIVISION  
 CHARLESTON

**WELL LOCATION MAP**  
 FILE NO. **B00-1315**

+ Denotes location of well on United States Topographic Maps, scale 1 to 62,500 latitude and longitude lines being represented by border lines as shown.  
 - Denotes one inch spaces on border lines of original tracing.

FB 5 PG 14





RECEIVED

JUL 28 1980

STATE OF WEST VIRGINIA  
DEPARTMENT OF MINES  
Oil and Gas Division

OIL & GAS DIVISION  
DEPT. OF MINES

WELL RECORD

7.5' Pilot Knob  
Quadrangle 15' Bald Knob  
Permit No. 47-005-1315

Rotary  Oil \_\_\_\_\_  
Cable \_\_\_\_\_ Gas   
Recycling \_\_\_\_\_ Comb. \_\_\_\_\_  
Water Flood \_\_\_\_\_ Storage \_\_\_\_\_  
Disposal \_\_\_\_\_ (Kind)

Company Texas International Petroleum Corp.  
Address 740 One Valley Sq., Chas., W. Va.  
Farm Western Pocahontas Corp. Acres 2396  
Location (waters) West Fork of Pond Creek  
Well No. 2 Elev. 1445.20'  
District Crook County Boone  
The surface of tract is owned in fee by Western Pocahontas Corporation  
Address Huntington, West Virginia  
Mineral rights are owned by Western Pocahontas Corp. Address Huntington, W. Va.  
Drilling Commenced May 25, 1980  
Drilling Completed June 4, 1980  
Initial open flow N/M cu. ft. N/M bbls.  
Final production 3710 M cu. ft. per day N/A bbls.  
Well open 4 hrs. before test 825 RP.

Casing and Tubing	Used in Drilling	Left in Well	Cement fill up Cu. ft. (Sks.)
Size 20-16			
Cond. 16"	25'	25'	None
<del>11-3/4"</del>	84'	84'	75 sk
9 5/8			
8 5/8	1346'	1346'	200 sk
7			
5 1/2			
4 1/2	3252'	3252'	100 sk
3			
2			
Liners Used			

Well treatment details:

Attach copy of cementing record.

Perforated 3164'-3170', 1 shot per foot, total of 7 shots. Spotted 500 gal. 15% HCl.  
Loaded hole. Broke formation w/1800 PSI. Fraced w/30,000# 80/100 sand, 50,000# 10/20 sand, 680 bbls. fluid. AIR-18 BPM. AIP-2000 PSI. ISIP-600 PSI, 5 minutes-400 PSI, 15 minutes-300 PSI.

3,710 MCF

Coal was encountered at 82'-85', 153'-158', 130'-336' Feet \_\_\_\_\_ Inches  
Fresh water 500' Feet \_\_\_\_\_ Salt Water \_\_\_\_\_ Feet \_\_\_\_\_  
Producing Sand Weir Depth 3165'-85'

Formation	Color	Hard or Soft	Top Feet	Bottom Feet	Oil, Gas or Water	* Remarks
Sand	White	Hard	0	82		
Coal	Black	Soft	82	85	Coal.	
Sand	Gray	Hard	85	153		
Coal	Black	Soft	153	158	Coal.	
Sand	Brown	Hard	158	330		
Coal	Black	Soft	330	336	Coal.	
Sand	White	Hard	336	465		
Sand & Shale	Gray	Medium	465	1017	H <sub>2</sub> O @ 500'.	
Salt Sand	White	Hard	1017	1515	Gas @ 1505'.	
Shale	Brown	Soft	1515	1685		
Princeton Sd.	White-Gray	Hard	1685	1727		Smell of gas @ 1723'.
Shale	Brown-Blk	Soft	1727	1770		
Ravencliff Sd.	White	Hard	1770	1805		
Shale	Brown	Medium	1805	1870		Smell of gas @ 1817'.
Avis Lime	White	Hard	1870	1910		
Sand & Shale	Gray	Soft	1910	2070		
Shale	Brown	Soft	2070	2085		
Sand & Shale	Gray	Medium	2085	2189		
Maxton Sand	White	Hard	2189	2316		Smell of gas.
Shale			2316	2365		
Sand	White	Hard	2365	2379		
Sand & Shale		Medium	2379	2390		
Lower Maxton			2390	2405		
Little Lime	White	Hard	2405	2455		
Shale	Gray	Soft	2455	2505		

AUG 11 1980

Formation	Color	Hard or Soft	Top Feet	Bottom Feet	Oil, Gas or Water	Remarks
Big Lime	White	Hard	2505	2944		
Shale			2944	2998		
Upper Weir			2998	3015		
Shale			3015	3165		
Lower Weir ✓			3165	3185		
Shale			3185	3305	T.D.	

Date July 21, 19 80

Texas International Petroleum Corporation

APPROVED Robert L. Dodd Owner

Robert L. Dodd



STATE OF WEST VIRGINIA  
DEPARTMENT OF MINES

RECEIVED

MAR 27 1980

Oil and Gas Division  
OIL AND GAS WELL PERMIT APPLICATION

OIL & GAS DIVISION  
DEPT. OF MINES

TO THE DEPARTMENT OF MINES,  
Charleston, W. Va.

DATE March 26, 1980

Surface Owner Western Pocahontas Corporation  
Address Huntington, West Virginia 25718  
Mineral Owner Western Pocahontas Corporation  
Address Huntington, West Virginia 25718  
Coal Owner Western Pocahontas Corporation  
Address Huntington, West Virginia 25718  
Coal Operator Eastern Associated Coal Corp.  
Address Koopers Bldg., Pittsburgh, Pa 15219

Company Texas International Petroleum Corp.  
Address Suite 740 - One Valley Square  
Farm Western Pocahontas Corp Acres 2396  
Location (waters) West Fork of Pond Creek  
Well No. 2 Elevation 1445.20'  
District Crook County Boone  
Quadrangle 7.5' Pilot Knob, 15' Bald Knob

THIS PERMIT MUST BE POSTED AT THE WELL SITE

All provisions being in accordance with Chapter 22, of the W. Va. Code, the location is hereby approved for drilling. This permit shall expire if operations have not commenced by 12-11-80

INSPECTOR  
TO BE NOTIFIED Arthur St. Clair  
ADDRESS P. O. Box 157, Brenton, W. Va. 24818  
PHONE 732-6227

  
Deputy Director - Oil & Gas Division

GENTLEMEN:

The undersigned well operator is entitled to drill upon the above named farm or tract of land for oil and gas, having fee title thereto, (or as the case may be) under grant or lease dated January 1 1973 by Western Pocahontas Corp. made to Patrick Petroleum Corp. and recorded on the 6th day of August 1973, in Boone County, Book 20 Page 601

NEW WELL  DRILL DEEPER  REDRILL  FRACTURE OR STIMULATE  
OIL AND GAS WELL ORIGINALLY DRILLED BEFORE JUNE 5, 1969.

The enclosed plat was prepared by a registered engineer or licensed land surveyor and all coal owners and/or operators have been notified as of the above date.

The above named coal owners and/or operator are hereby notified that any objection they wish to make, or are required to make by Section 3 of the Code, must be received by, or filed with the Department of Mines within ten (10) days. \*

Copies of this notice and the enclosed plat were mailed by registered mail, or delivered to the above named coal operators or coal owners at their above shown respective address day before, or on the same day with the mailing or delivery of this copy to the Department of Mines at Charleston, West Virginia.

Very truly yours,   
(Sign Name) Texas International Petroleum Corp.  
Well Operator

PLEASE SUBMIT COPIES OF ALL  
GEOPHYSICAL LOGS DIRECTLY TO:

WEST VIRGINIA GEOLOGICAL AND  
ECONOMIC SURVEY  
P. O. BOX 879  
MORGANTOWN, WEST VIRGINIA 26505  
AC-304 - 292-6331

Address  
of  
Well Operator

Suite 740 - One Valley Square  
Street  
Charleston  
City or Town  
West Virginia 25301  
State

\*SECTION 3 . . . . If no objections are filed or found by the Department of mines, within said period of ten days from the receipt of notice and plat by the department of mines, to said proposed location, the department shall forthwith issue to the well operator a permit reciting the filing of such plat, that no objections have been made by the coal operators or found thereto by the department and that the same is approved and the well operator authorized to proceed.

BLANKET BOND

47-005-1315

PERMIT NUMBER

**THIS IS AN ESTIMATE ONLY**  
**ACTUAL INFORMATION WILL BE SUBMITTED ON OG-10 UPON COMPLETION**

PROPOSED WORK ORDER TO   X   DRILL \_\_\_\_\_ DEEPEN \_\_\_\_\_ FRACTURE-STIMULATE \_\_\_\_\_  
 DRILLING CONTRACTOR: (If Known) \_\_\_\_\_ RESPONSIBLE AGENT: \_\_\_\_\_  
 NAME Falcon Drilling Company NAME James M. Blanton  
 ADDRESS 2030 Kanawha Blvd., Chas., W. Va. ADDRESS Suite 740 - One Valley Square  
 TELEPHONE 343-0542 TELEPHONE 304/345-3430  
 ESTIMATED DEPTH OF COMPLETED WELL: 3265' ROTARY   X   CABLE TOOLS \_\_\_\_\_  
 PROPOSED GEOLOGICAL FORMATION: Weir  
 TYPE OF WELL: OIL \_\_\_\_\_ GAS   X   COMB. \_\_\_\_\_ STORAGE \_\_\_\_\_ DISPOSAL \_\_\_\_\_  
 RECYCLING \_\_\_\_\_ WATER FLOOD \_\_\_\_\_ OTHER \_\_\_\_\_

TENTATIVE CASING PROGRAM:

CASING AND TUBING SIZE	USED FOR DRILLING	LEFT IN WELL	CEMENT FILL UP OR SACKS - CUBIC FT.
20 - 16	34'	34'	None
13 - 10			
9 - 5/8			
8 - 5/8	1450'	1450'	Cement to surface.
7			
5 1/2			
4 1/2	3265'	3265'	Cement w/100-200 sx.
3			Perf. Top
2			Perf. Bottom
Liners			Perf. Top
			Perf. Bottom

APPROXIMATE FRESH WATER DEPTHS 100 FEET \_\_\_\_\_ SALT WATER \_\_\_\_\_ FEET \_\_\_\_\_  
 APPROXIMATE COAL DEPTHS 795-799  
 IS COAL BEING MINED IN THE AREA? Yes BY WHOM? Eastern Associated Coal Co.

TO DRILL:

SUBMIT FIVE (5) COPIES OF OG - 1, \$100.00 PERMIT FEE, PERFORMANCE BOND AND PERMANENT COPY OF PLAT.

TO DRILL DEEPER OR REDRILL:

SUBMIT FIVE (5) COPIES OF OG - 1, SHOWING ORIGINAL PERMIT NUMBER AND PERFORMANCE BOND. ON WELLS DRILLED PRIOR TO 1929, A PERMANENT COPY OF THE PLAT AND THE ORIGINAL WELL RECORD MUST ALSO BE SUBMITTED.

TO FRACTURE - STIMULATE:

OIL AND/OR GAS WELL ORIGINALLY DRILLED BEFORE JUNE 5, 1929, FIVE (5) COPIES OG - 1, PERFORMANCE BOND, PERMANENT PLAT AND ORIGINAL WELL RECORD.

OIL AND/OR GAS WELL ORIGINALLY DRILLED ON AND/OR AFTER JUNE 5, 1929, FIVE COPIES OG - 1, SHOWING ORIGINAL PERMIT NUMBER, AND PERFORMANCE BOND.

Required forms must be filed within ninety (90) days of completion for bond release. Inspector to be notified twenty-four (24) hours in advance.

The following waiver must be completed by the coal operator if the permit is to be issued within ten days of receipt thereof.

WAIVER: I the undersigned, Agent for Eastern Associated Coal Company, Owner or Operator of the coal under this lease have examined and place on our mine maps this proposed well location.

We the Eastern Associated Coal Company have no objections to said well being drilled at this location, providing operator has complied with all rules and regulations in Articles 4, 5, and 7, Chapter 22 of the West Virginia Code.

\_\_\_\_\_  
 For Coal Company

\_\_\_\_\_  
 Official Title

08. 1998