

Latitude 38° 05'

Longitude 81° 50'

JOHN W. KESSINGER

Laurel Br.

R.B. ALLEN

J.M. HOPKINS, MIN.

S12°E
600

S32°E
230

S40°E
490

S72°E
570

N42°15'E
2015

N23°45'E
2230

LOW GAP BR.

P.K. MILLER

B.S. BALLARD
200 Ac.
LEASE # 119

COLE & CRANE, MIN.

C.B.O.
R.R.
Spruce Fork

C.L. VICKERS



3.715
0.26
W

- New Location
- Drill Deeper
- Abandonment

NOV 29 1959

0.28 W
3.78 P

Company	PACK & JACKSON
Address	HAMLIN, W. VA.
Farm	B. S. BALLARD
Tract	1
Acres	200
Lease No.	119
Well (Farm) No.	2
Serial No.	350-F10289
Elevation (Spirit Level)	817.8
Quadrangle	MADISON
County	BOONE
District	WASHINGTON
Engineer	PAUL E. JOACHIM
Engineer's Registration No.	669
File No.	50-37
Drawing No.	
Date	SEPT. 15, 1959
Scale	1" = 1000'

STATE OF WEST VIRGINIA
DEPARTMENT OF MINES
OIL AND GAS DIVISION
CHARLESTON

WELL LOCATION MAP

FILE NO. 800-349-A

+ Denotes location of well on United States Topographic Maps, scale 1 to 62,500, latitude and longitude lines being represented by border lines as shown.

- Denotes one inch spaces on border line of original tracing.

Latitude 38° 05'

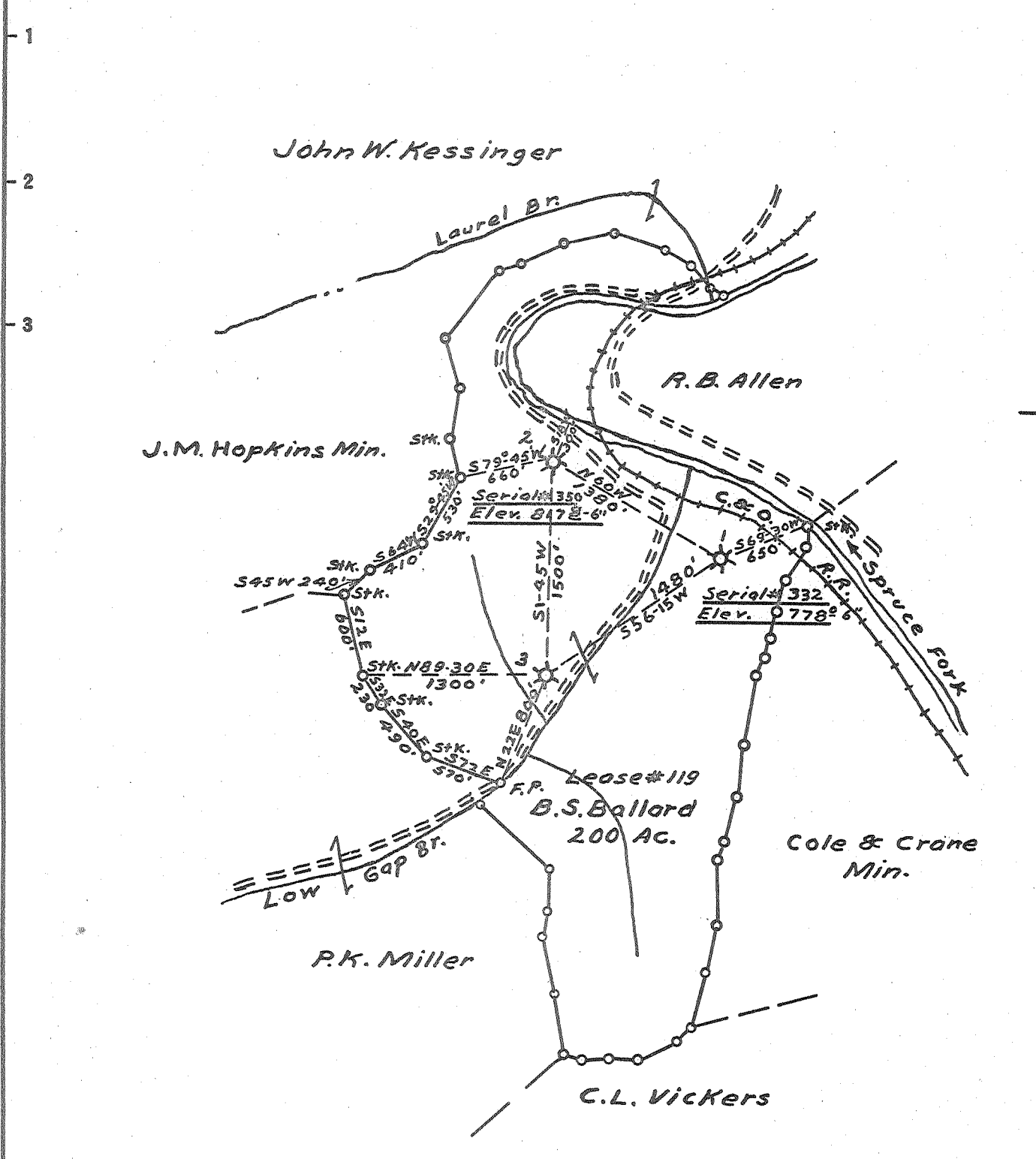

Longitude 81° 50'

- New Location...
- Drill Deeper.....
- Abandonment.....

Company Owens, Libbey-Owens Gas Dept.
 Address Box 4158 Charleston W.Va.
 Farm B.S. Ballard
 Tract _____ Acres 200 Lease No. 119
 Well (Farm) No. 1 & 2 Serial No. 332 & 350
 Elevation (Spirit Level) #1-778.6 Top 6"
#2-817.6 Top 6"
 Quadrangle Madison #2-8-53.79" W 0.30"
#1-8-54.00" W 0.01"
 County Boone District Washington
 Engineer T.S. Flournoy
 Engineer's Registration No. 269
 File No. _____ Drawing No. _____
 Date Nov 17, 1949 Scale 1"=1000'

STATE OF WEST VIRGINIA
 DEPARTMENT OF MINES
 OIL AND GAS DIVISION
 CHARLESTON

WELL LOCATION MAP

FILE NO. 300-151-A #1
300-327-A-#2 now 349-A

+ Denotes location of well on United States Topographic Maps, scale 1 to 62,500, latitude and longitude lines being represented by border lines as shown.

- Denotes one inch spaces on border line of original tracing.



STATE OF WEST VIRGINIA
DEPARTMENT OF MINES
OIL AND GAS DIVISION

761 ✓

Now 349-A
327A

WELL RECORD

Permit No. 327A Oil or Gas Well Gas (KIND)

Company Owens, Libbey-Owens Gas Department
Address P. O. Box 4158, Charleston, W. Va.
Farm B. S. Ballard Acres 200
Location (waters) Low Gap Branch of Spruce Fork
Well No. 2(O.L.O. #350) Elev. 817.8
District Washington County Boone

Casing and Tubing	Used in Drilling	Left in Well	Packers
Size			Kind of Packer
16			
13	15	15	Spang
10			Size of
8 1/4	1089	1089	3 x 6-5/8
6 5/8			Depth set
5 3/16			1698 - 1701
3	1807	1807	Perf. top 1763
2			Perf. bottom 1768
Liners Used			Perf. top 1790
			Perf. bottom 1795

The surface of tract is owned in fee by _____

Coal rights are owned by J. E. Ballard et al.
Address Jeffrey, W. Va.

Drilling commenced 1/29/29
Drilling completed 3/7/29

Date Shot 3/7/29 From 1744 To 1769
With 115 lbs.

Open Flow /10ths Water in _____ Inch
/10ths Merc. in _____ Inch

Volume B.L. 196 M; Berea 235 M. Total 432 Cu. Ft.

Rock Pressure 435 lbs. 24 hrs.

Oil _____ bbls., 1st 24 hrs.

Fresh water _____ feet _____ feet

Salt water _____ feet _____ feet

CASING CEMENTED _____ SIZE _____ No. Ft. _____ Date _____

COAL WAS ENCOUNTERED AT _____ FEET _____ INCHES

_____ FEET _____ INCHES _____ FEET _____ INCHES

_____ FEET _____ INCHES _____ FEET _____ INCHES

Formation	Color	Hard or Soft	Top	Bottom	Oil, Gas or Water	Depth Found	Remarks
Clay	Yellow	soft	0	15			
Slate	Gray	soft	15	35			
Sand	Gray	---	35	45			
Slate	gray	soft	45	70			
Sand	gray	hard	70	90			
Slate	brown	soft	90	105			
Sand	gray	hard	105	171			
Slate	gray	soft	171	187			
Lime	gray	hard	187	197			
Sand	white	hard	197	258			
Slate	blue	soft	258	261			
Sand	white	hard	261	325			
Slate	brown	soft	325	326			
Sand	white	hard	326	374			
Coal	--	soft	374	376			
Slate & shells	gray	---	376	395			
Sand	white	hard	395	410			
Slate	gray	soft	410	415			
Sand	gray	hard	415	685			
Slate	brown	soft	685	692			
Sand	white	hard	692	699			
Slate & Shells	gray	soft	699	721			
Sand	white	hard	721	729			
Slate	gray	soft	729	734			
Sand	white	hard	734	790			
Red rock	red	soft	790	795			
Slate & Shells	gray	---	795	808			
Rock	red	soft	808	813			
Slate & Shells	gray	soft & hard	813	900			
Rock	red	soft	900	907			
Slate & Shells	gray	soft & hard	907	989			
Little Lime	gray	hard	989	1039			
Slate	gray	soft	1039	1041			
Big Lime	White & gray	hard	1041	1234	Gas, test	1098	158 M
Injun Sand	red	hard	1234	1292	Gas, test	1105	236 M
Slate & Shells	--	---	1292	1686			Dec. to 128 M.
Lime	dark	Hard	1686	1706	Gas, test	1214	210 M.
Slate	--	---	1706	1727	Gas, test	1224,	230 M.
Shale	brown	soft	1727	1742			

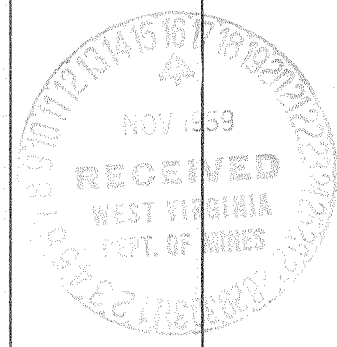

(Over)

JAN 3 1961

Formation	Color	Hard or Soft	Top	Bottom	Oil, Gas or Water	Depth Found	Remarks
Berea Sand Lime	gray black	hard hard	1742 1772	1772 1803			Dec. to 196 M when top of Berea was reached 322M
Total depth				1803	Gas, test	1750	
							NOTE: cleaned out after shot

Date _____, 19____

APPROVED Owens, Libbey-Owens Gas Dept., Owner

By A. H. McClain, Geologist
(Title)