

WW-7  
8-30-06



West Virginia Department of Environmental Protection  
Office of Oil and Gas  
**WELL LOCATION FORM: GPS**

API: 47-007-00087 WELL NO.: WV 607672 (Philip C. Taylor #7672)

FARM NAME: Philip C. Taylor

RESPONSIBLE PARTY NAME: EQT Production Company

COUNTY: Braxton DISTRICT: Birch

QUADRANGLE: Rosedale 7.5'

SURFACE OWNER: Tara S. & Raben L. McCourt (Janette McCourt Life Estate)

ROYALTY OWNER: I. L. Morris, et al.

UTM GPS NORTHING: 4281289

UTM GPS EASTING: 506109 GPS ELEVATION: 279 m (917 ft)

The Responsible Party named above has chosen to submit GPS coordinates in lieu of preparing a new well location plat for a plugging permit or assigned API number on the above well. The Office of Oil and Gas will not accept GPS coordinates that do not meet the following requirements:

1. Datum: NAD 1983, Zone: 17 North, Coordinate Units: meters, Altitude: height above mean sea level (MSL) – meters.
2. Accuracy to Datum – 3.05 meters
3. Data Collection Method:

Survey grade GPS \_\_\_\_\_ : Post Processed Differential \_\_\_\_\_  
Real-Time Differential \_\_\_\_\_

Mapping Grade GPS X : Post Processed Differential X  
Real-Time Differential \_\_\_\_\_

4. **Letter size copy of the topography map showing the well location.**

I the undersigned, hereby certify this data is correct to the best of my knowledge and belief and shows all the information required by law and the regulations issued and prescribed by the Office of Oil and Gas.

*Steve Ober*  
Signature

PS# 2180  
Title

RECEIVED  
Office of Oil and Gas  
NOV 21 2016  
11/4/16  
Date  
WV Department of  
Environmental Protection

01/27/2017

Topo Quad: Rosedale 7.5'

Scale: 1" = 2000'

County: Braxton

Date: October 31, 2016

District: Birch

Project No: 40-02-00-07

# 47-007-00087 WV 607672 (Philip C. Taylor #7672)

Topo

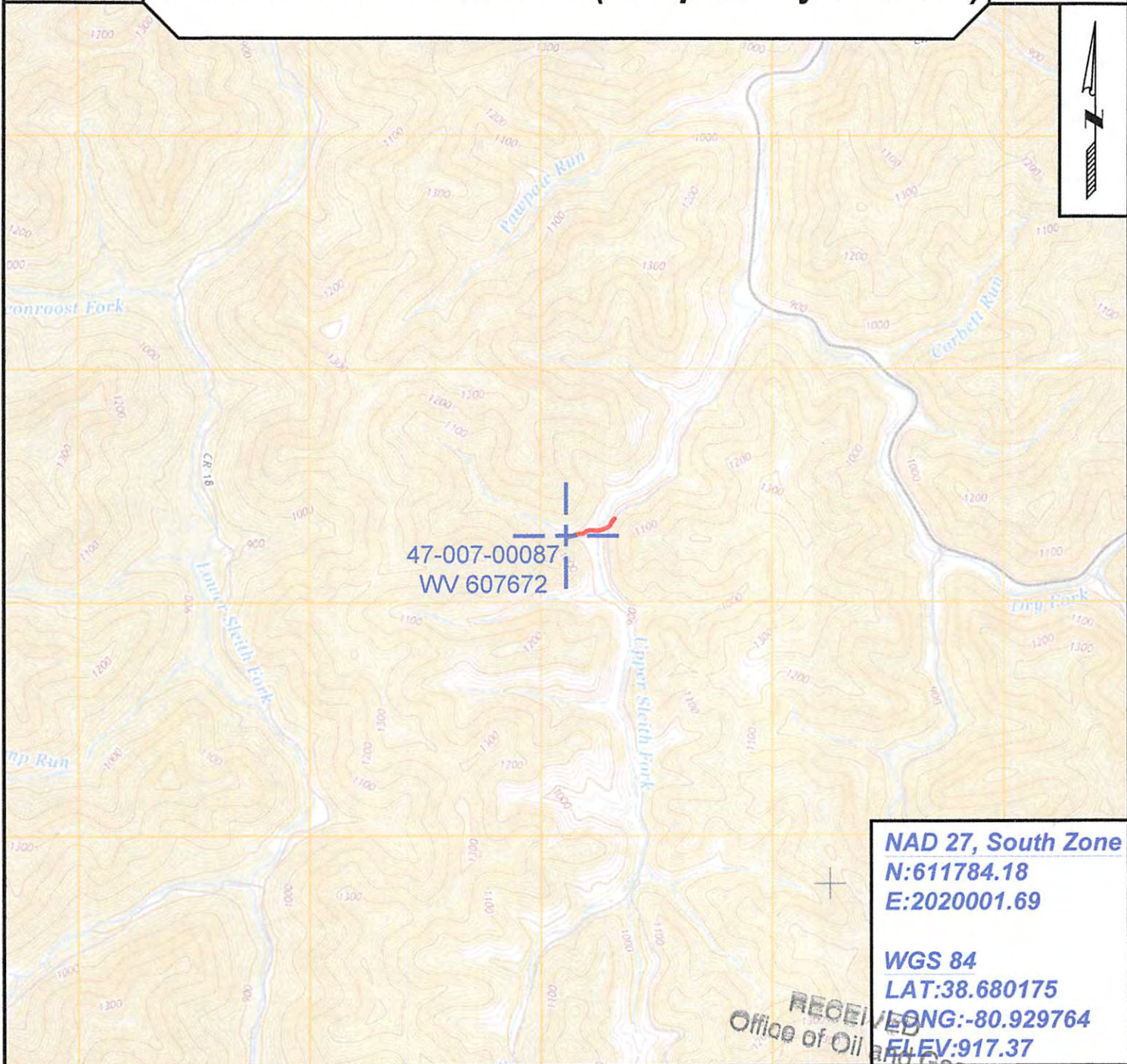

**NAD 27, South Zone**  
**N:611784.18**  
**E:2020001.69**

**WGS 84**  
**LAT:38.680175**  
**LONG:-80.929764**  
**ELEV:917.37**

RECEIVED  
 Office of Oil and Gas



SURVEYING AND MAPPING SERVICES PERFORMED BY:  
**ALLEGHENY SURVEYS, INC.**  
 1-800-482-8606  
 237 Birch River Road  
 Birch River, WV 26610  
 PH: (304) 649-8606  
 FAX: (304) 649-8608

PREPARED FOR: **EQT Production Company**  
 NOV 21 2016  
 P.O. Box 280  
 Bridgeport, WV 26330  
 Environmental Protection  
**01/27/2017**