

40°22'30"

Latitude

80°35'00"

Longitude

2.47s
.56w

Topo Location

7.5' Loc. _____ 15' Loc. _____
 _____ (calc.) _____

Company Wheeling Steel Corp.

Farm Wheeling Steel Corp #110

15' Quad _____
(sec.)

7.5' Quad Staubemillo East

District Cross Creek

WELL LOCATION PLAT

County 009 Permit 25

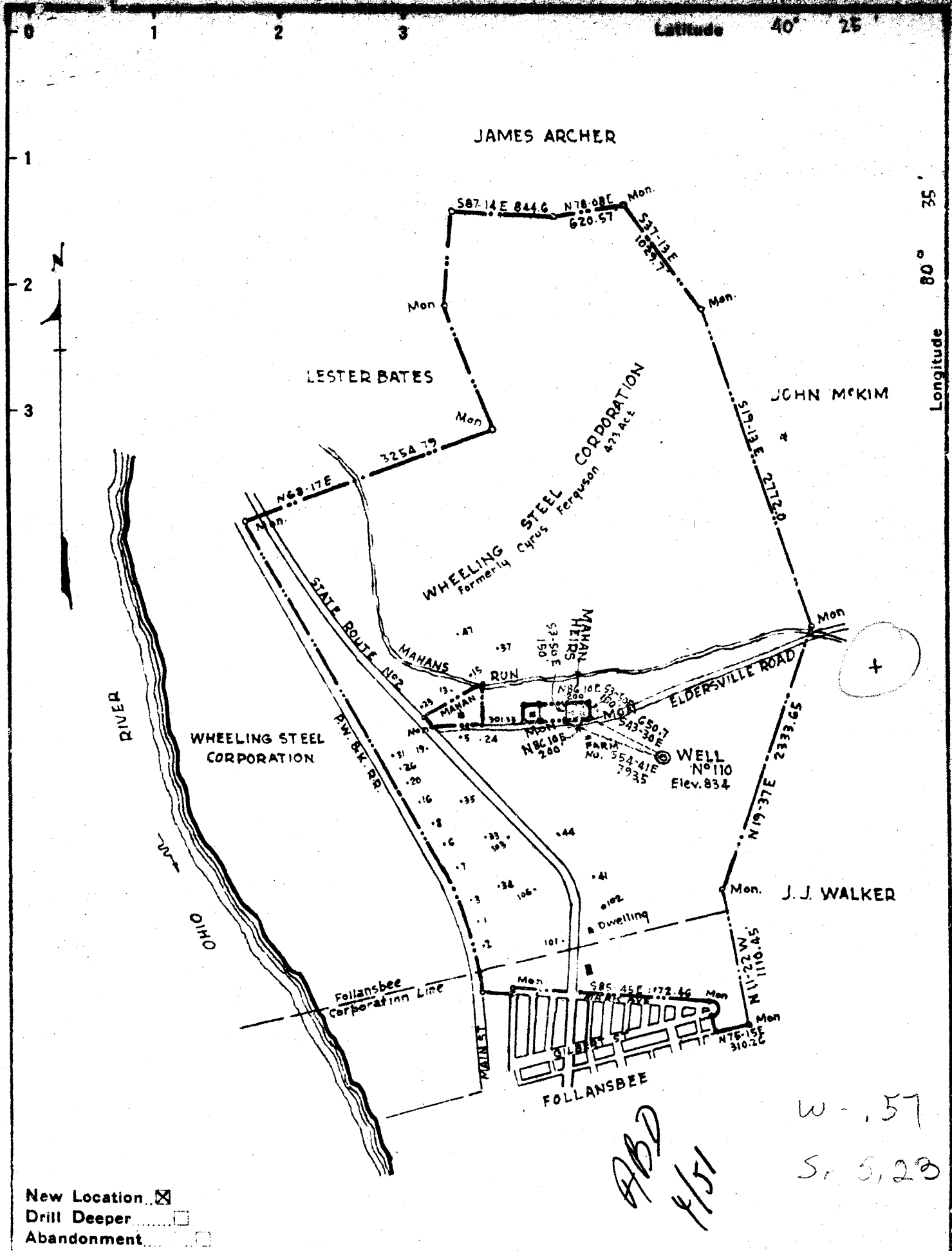

New Location
 Drill Deeper
 Abandonment

Company WHEELING STEEL CORPORATION
 Address (General Office) Wheeling, W. Va
 Farm Wheeling Steel Corporation { Formerly Cyrus Ferguison }
 Tract Acres 423 Lease No.
 Well (Farm) No. 110 Serial No.
 Elevation (Spirit Level) 834.0
 Quadrangle Steubenville
 County Brooke District Cross Creek
 Engineer Eugene M. Smith - C.C. Smith's Sons
 Engineer's Registration No. 290
 File No. Drawing No.
 Date Nov. 25, 1940 Scale 1" = 1000'

STATE OF WEST VIRGINIA
 DEPARTMENT OF MINES
 OIL AND GAS DIVISION
 CHARLESTON

WELL LOCATION MAP
 FILE NO. BRO-25

+ Denotes location of well on United States Topographic Maps, scale 1 to 62,500, latitude and longitude lines being represented by border lines as shown.

- Denotes one inch spaces on border line of original tracing.

6-0 11

WEST VIRGINIA DEPARTMENT OF MINES
OIL & GAS DIVISION
W E L L R E C O R D

Permit No. Bro-25
- Quad.

Oil Well

Company	Wheeling Steel Corp.	CASING & TUBING	13	56	56
Address	Wheeling, W. Va.		10	135	135
Farm	Corporation		8-1/4	470	470
Location	ACRES 423		6-5/8	842	Out
Well No.	One Mile East of Ohio River		5-3/16	1085	1085
District	110 ELEV. 834				
Surface & Mineral	<u>Cross Creek - Brooke County</u>				
Commenced	Wheeling, Steel Corp., Wheeling, W. Va.	Packer - B.H.			
Shot	2/11/41 - completed 5/7/41	Size - 6-5/8			
Gas	5/8/41 - depth 1418-1431	Depth set - 845			
Oil	None	Perf. - No			
Fresh Water	one-half barrel				
Salt Water	surface to 560	Coal at 327'	36"		
	560 and 1438	391	48		

Clay	yl	s	0	50	
Shale	bl	s	50	60	
Shale	grn	s	60	65	
Red Rock	rd	h	65	100	
Shale	gr	m	100	155	
Red Rock	rd	h	155	159	
Shale	gr	m	159	190	
Sand	lt	s	190	229	Gas 195
					small quantity
Shale	bk	s	229	246	
Shale	lt	gr	m	246	297
Lime	wh	m	297	315	
Shale	gr	m	315	320	
Slate	lt	m	320	327	
Coal	bk	m	327	330	U. Freeport
Slate	gr	m	330	340	
Slate	bk	m	340	370	
Shale	gr	m	370	375	
Shale	bk	m	375	387	
Shale & Slate	bk	m	387	391	
Coal	bk	m	391	395	L. Freeport
Slate	bk	m	395	400	
Shale	gr	h	400	420	
Slate	bk	h	420	455	
Coal & Slate	bk	m	455	460	
Shale	gr	m	460	475	
Lime	gr	h	475	480	
Sand	lt	h	480	568	W 480 Gritty
Shale	gr	m	568	620	
Shale	bk	m	620	628	
Shale	bn	m	628	655	
Sand	wh	m	655	695	Salt Sand
Shale	gr	h	695	763	
Lime	dk	h	763	900	
Shale	gr	m	900	930	
Sand	gr	h	930	1083	B. Injun
Shale	lt	gr	m	1083	1095
Shale	dk	gr	m	1095	1129
Shale & Shells	gr	h	1129	1243	
Shale	dk	gr	m	1243	1300
Shale & Shells	dk	gr	m	1300	1320
Shale	gr	m	1320	1350	
Lime	bl	h	1350	1352	
Lime & Shale	bl	m	1352	1393	
Shale	bk	s	1393	1418	
Sand	bn	s	1418	1427	Oil Berea
Sand	bn	h	1427	1438	Well bottomed at 1438 feet -

Shot with 30 qts. glycerine at depth 1418-1431, using 13 ft. shell and 7 ft. anchor. Made one bailer oil with vacuum on over night, prior to shot. Shot again June 10, 1941, with 35 qts. glycerine.