

40°22'30"

Latitude

80°35'00"

Longitude

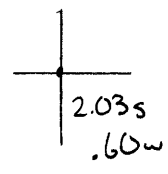

Topo Location

7.5' Loc. _____ 15' Loc. _____
 _____ (calc.) _____

Company Wheeling Steel Corp

Farm Wheeling Steel Corp # 114

15' Quad _____
(sec.)

7.5' Quad Steubenville East

District Cross Creek

WELL LOCATION PLAT

County 009 **Permit** 31

M

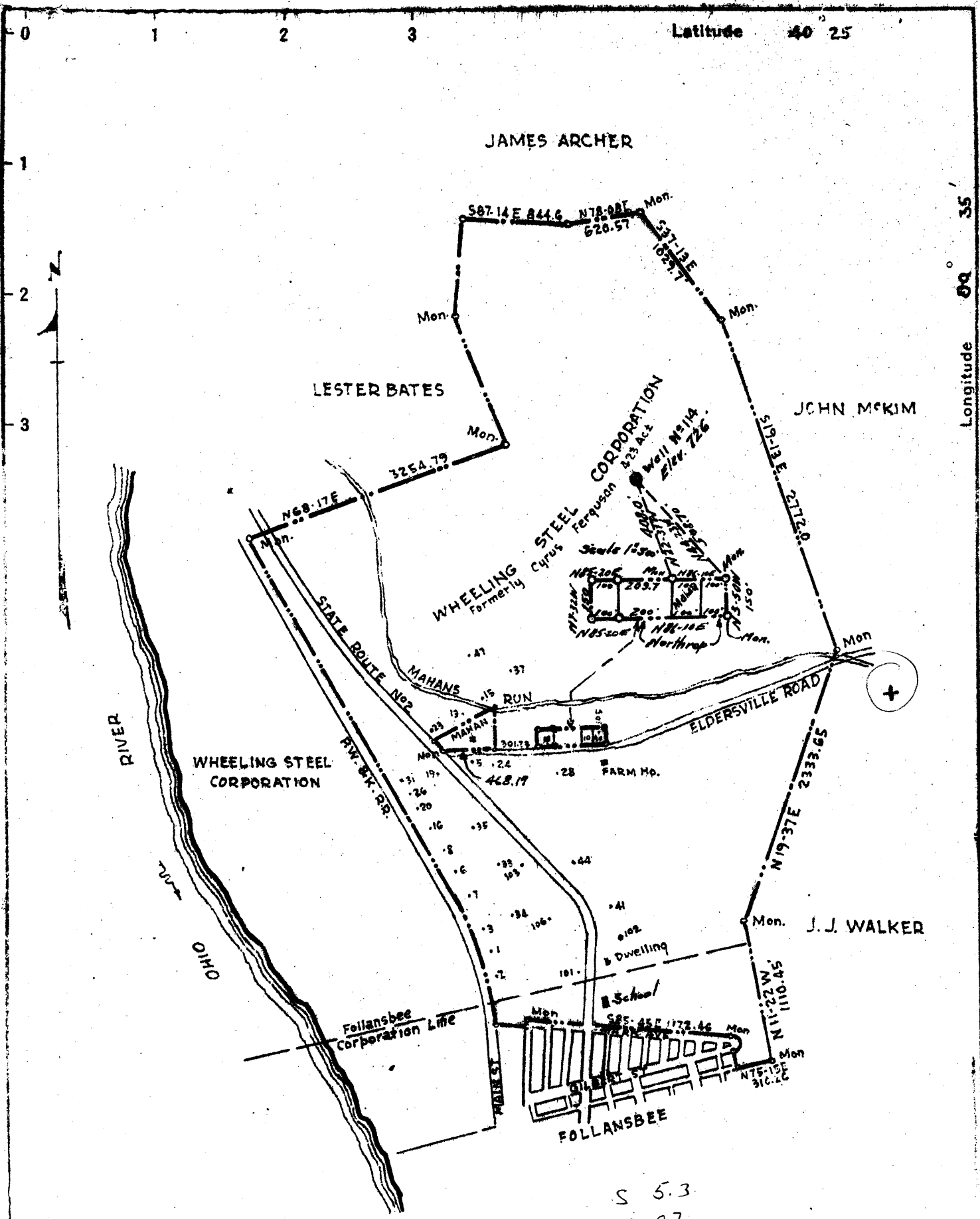

New Location X
 Drill Deeper
 Abandonment

S 5.3
 W 0.7

Company	WHEELING STEEL CORPORATION
Address	(General Office) Wheeling, W. Va.
From	Wheel Steel Corporation (Formerly Cyrus Fergusson)
Lease No.	223
Serial No.	114
Well No.	726
Location	Stuebenville
District	Cross Creek
Owner	C. Smith - C.C. Smith's Sons
No.	240
Drawing No.	
Scale	1" = 1000'

STATE OF WEST VIRGINIA
 DEPARTMENT OF MINES
 OIL AND GAS DIVISION
 CHARLESTON

WELL LOCATION MAP
 FILE NO. BRO-31

+ Denotes location of well on United States Topographic Maps, scale 1 to 62,500, latitude and longitude lines being represented by border lines as shown.

- Denotes one inch spaces on border line of original tracing.

WEST VIRGINIA DEPARTMENT OF MINES
OIL & GAS DIVISION
W E L L R E C O R D

Permit No. 31031
Steubenville Quad.

Oil Well
CASING & TUBING

Company	Wheeling Steel Corporation			
Address	Wheeling, W.Va.	10	69	69
Farm	Corporation Acres 423	8 1/2	311	311
Location	Mahans Run	6 5/8	690	690
Well No	114 Elev. 726	5 3/16	960	960
District	Cross Creek Brooke County	2		1330
Surface	Wheeling Steel Corp., Wheeling, W.Va.			
Mineral	Same		No liners used	
Commenced	May 1, 1944			
Completed	Nov. 23, 1944			No Packer
Date shot	Nov. 24, 1944	Depth 1316-1332'		Perf. top- no
No record Open flow				
Rock Pressure	No record			Casing not cemented
Oil	One (1) bbls., 1st 24 hrs.			Coal at 125' 24";
Fresh Water	From surface to 360'			201' 48"; 340' 48"
Salt Water	360' to 1332'			

Sandy Shale	Br	S	0	20	
Sand	Wh	S	20	30	
Lime	Bl	H	30	50	
Clay	R	S	50	60	
Lime	Bl	H	60	80	
Shale	Gr	M	80	100	
Sand	Br	H	100	120	
Lime	Wh	H	120	125	
Coal	Bk	S	125	127	Gas small quantity
Shale	Bl	S	127	135	
Lime	Wh	H	135	140	
Fire Clay	Wh	S	140	180	
Slate	Bk	M	180	201	
Coal	Bk	S	201	205	Gas small quantity
Lime	Wh	M	205	210	
Shale	Gr	M	210	260	
Shale	Bk	M	260	290	Gas small quantity
Shells	Bk	M	290	300	
Shale	Bk	M	300	340	
Coal	Bk	S	340	344	Gas considerable
Slate	Bk	M	344	360	
Sand-Cow Run	Lt	M	360	400	
Sand "	Lt	M	400	405	
Sand "	Lt	M	405	425	
Sand	Lt	M	425	440	Gas small quantity
Slate	Bk	M	440	475	
Slate	Gr	M	475	495	
Slate	Bk	M	495	540	
Sand	Wh	M	540	555	
Sand	Wh	M	555	660	
Lime	Wh	H	660	810	Gas 750' Considerable
Sand	Wh & Br	H	810	960	
Shale	Gr & Bk	M	960	1232	
Sand - Wier	Gr	M	1232	1254	
Shale	Bk	M	1254	1295	
Shale	Br	M	1295	1312	
Sand- Berea	Gr to Br	S	1312	1332	Oil 1316-1332