

REFERENCES TO PROPOSED HORIZONTAL WELLS SURFACE LOCATIONS

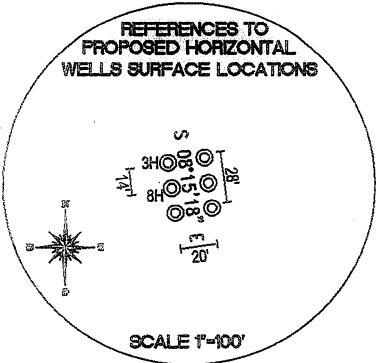

SCALE 1"=100'

N 66°14'23" W
1,341'

BROOKE COUNTY PARK
BRK 8H

BROOKE COUNTY COURT
135.5 ACRES
LEASE NUMBERS
1-329177-000
1-324062-001
1-324062-002
1-324062-003
PARCEL ID
B28-65

BROOKE COUNTY PARK COMMISSION
135 ACRES
LEASE NUMBERS
1-324062-001
1-324062-002
1-324062-003
PARCEL ID
B28-64

BROOKE COUNTY PARK COMMISSION
LEASE NUMBER
1-329491-000
101.61 ACRES
PARCEL ID
B28-60

BROOKE COUNTY COURT
LEASE NUMBER
1-329491-000
51.55 ACRES
PARCEL ID
B28-61

BROOKE COUNTY PARK COMMISSION
4.71 ACRES
PARCEL ID
B33-117

SURFACE HOLE

BOTTOM HOLE

REFERENCES

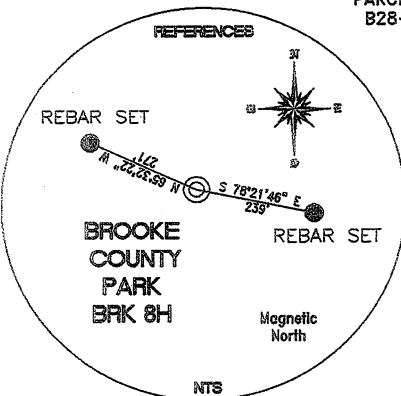

BROOKE COUNTY PARK
BRK 8H

Magnetic North

NTS

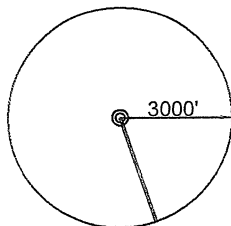

REFERENCE NOTES

Boundaries as shown taken from deeds, tax maps and field locations. A full boundary survey is not expressed nor implied. All bearings are based on true north. Ownership taken from public records Brooke County, West Virginia MARCH 2011 State Plane Coordinates & NAD 83 Lat/Long by differential submeter mapping grade GPS Drafted by: E.A.M.

<p>TOP HOLE (NAD 83)</p> <p>N) 642972.7 E) 1676048.0 LAT.) 40°15'38.0" LONG.) 80°32'52.4" DEC. LAT.) 40.260547 DEC. LONG.) 80.547879</p>	<p>BOTTOM HOLE (NAD 83)</p> <p>N) 638215.9 E) 1677689.8 LAT.) 40°14'51.2" LONG.) 80°32'30.5" DEC. LAT.) 40.247543 DEC. LONG.) 80.541799</p>
<p>TOP HOLE (NAD 27)</p> <p>N) 642935.5 E) 1707482.2 LAT.) 40°15'37.7" LONG.) 80°32'53.1" DEC. LAT.) 40.260476 DEC. LONG.) 80.548086</p>	<p>BOTTOM HOLE (NAD 27)</p> <p>N) 638178.8 E) 1709124.1 LAT.) 40°14'50.9" LONG.) 80°32'31.2" DEC. LAT.) 40.247472 DEC. LONG.) 80.542006</p>

FILE #: CHE 073

DRAWING #: 1801

SCALE: 1"=1200'

MINIMUM DEGREE OF ACCURACY: 1/200

PROVEN SOURCE OF ELEVATION: SUBMETER MAPPING GRADE GPS

I, THE UNDERSIGNED, HEREBY CERTIFY THAT THIS PLAT IS CORRECT TO THE BEST OF MY KNOWLEDGE AND BELIEF AND SHOWS ALL THE INFORMATION REQUIRED BY LAW AND THE REGULATIONS ISSUED AND PRESCRIBED BY THE DEPARTMENT OF ENVIRONMENTAL PROTECTION.

Signed:

L.L.S. #2124: Ernest J. Benchek III

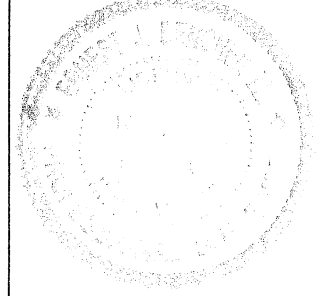

(+) DENOTES LOCATION OF WELL ON UNITED STATES TOPOGRAPHIC MAPS WVDEP

OFFICE OF OIL & GAS
601 57TH STREET
CHARLESTON, WV 25304

Well Type: Oil Waste Diposal Production Deep Gas Liquid Injection Storage Shallow

WATERSHED: UPPER OHIO SOUTH ELEVATION: 1,206'

COUNTY/DISTRICT: BROOKE/BUFFALO QUADRANGLE: STUEBENVILLE EAST.

SURFACE OWNER: BROOKE COUNTY PARK COMMISSION ACREAGE: 135.00 +/-

OIL & GAS ROYALTY OWNER: BROOKE COUNTY PARK COMMISSION ACREAGE: 288.16 +/-

LEASE NUMBERS:

DRILL CONVERT DRILL DEEPER REDRILL FRACTURE OR STIMULATE
 PLUG OFF FORMATION PERFORATE NEW FORMATION PLUG & ABANDON
 CLEAN OUT & REPLUG OTHER CHANGE (SPECIFY):

TARGET FORMATION: MARCELLUS ESTIMATED DEPTH: TVD: 6,250' TMD: 11,282'

WELL OPERATOR: CHESAPEAKE APPALACHIA, LLC. DESIGNATED AGENT: ERIC B. GILLESPIE

ADDRESS: PO BOX 18496 ADDRESS: Po Box 6070

CITY: OKLAHOMA CITY STATE: OK ZIP CODE: 73154-0496 CITY: CHARLESTON STATE: WV ZIP CODE: 25301

DATE: AUGUST 23, 2011

OPERATOR'S WELL #: BROOKE COUNTY PARK BRK 8H

API WELL #: 47 09 00111H
STATE COUNTY PERMIT

