

TOP HOLE (NAD 83) N) 632158.8 E) 1683059.6 LAT.) 40°13'51.9" LONG.) 80°31'20.3" DEC. LAT.) 40.231086 DEC. LONG.) 80.522317	BOTTOM HOLE (NAD 83) N) 635784.1 E) 1680315.7 LAT.) 40°14'27.4" LONG.) 80°31'56.3" DEC. LAT.) 40.240950 DEC. LONG.) 80.532292
TOP HOLE (NAD 27) N) 632121.7 E) 1714493.7 LAT.) 40°13'51.7" LONG.) 80°31'21.1" DEC. LAT.) 40.231015 DEC. LONG.) 80.522525	BOTTOM HOLE (NAD 27) N) 635746.9 E) 1711749.9 LAT.) 40°14'27.2" LONG.) 80°31'57.0" DEC. LAT.) 40.240880 DEC. LONG.) 80.532499

REFERENCE LINES

RL #1
 S 48°24'49" W 966'

DONALD E. &
 VERA M. BRADY
 25 ACRES
 LEASE NUMBER
 1-292230-000
 PARCEL ID
 B34-48

KOP (NAD 83) N) 631066.1 E) 1682551.5 LAT.) 40°13'41.1" LONG.) 80°31'26.7" DEC. LAT.) 40.228071 DEC. LONG.) 80.524092
KOP (NAD 27) N) 631028.9 E) 1713985.6 LAT.) 40°13'40.8" LONG.) 80°31'27.5" DEC. LAT.) 40.228000 DEC. LONG.) 80.524300
TP (NAD 83) N) 631517.9 E) 1682337.3 LAT.) 40°13'45.5" LONG.) 80°31'29.6" DEC. LAT.) 40.229304 DEC. LONG.) 80.524877
TP (NAD 27) N) 631480.7 E) 1713771.5 LAT.) 40°13'45.2" LONG.) 80°31'30.3" DEC. LAT.) 40.229233 DEC. LONG.) 80.525085

KEVIN L. & RULETTA R. MINOR
 5.917 ACRES
 LEASE NUMBER
 1-325741-000
 PARCEL ID
 B34-50.1

NORMA J. SHIDOCK
 195.2 ACRES
 LEASE NUMBER
 1-325740-000
 PARCEL ID
 B34-50

MARGARET H. CORBIN
 183.13 ACRES
 LEASE NUMBER
 1-324445-000
 PARCEL ID
 B34-57

MARGARET
 CORBIN
 BRK 1H

BEALLS RIDGE ROAD

SURFACE HOLE

CAMP RUN ROAD

S. 48°47'28" E
 1,208'

S 05°19'25" E
 1,126'

RL #1 1/16'

500'

KOP

TP

N 35°21'17" W
 4,121'

N 88°18'44" E
 282'

S 48°36'56" W
 744'

REBAR SET

15" DOUBLE MAPLE

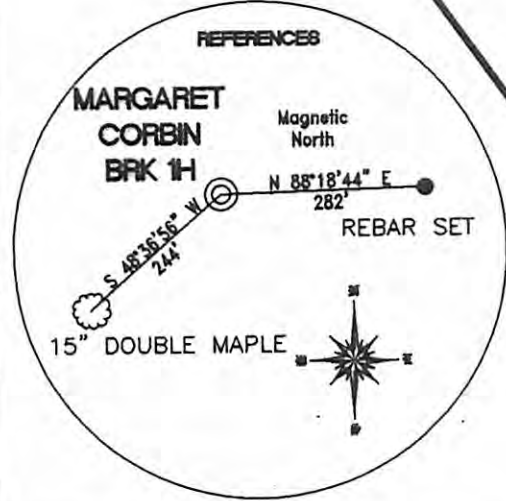
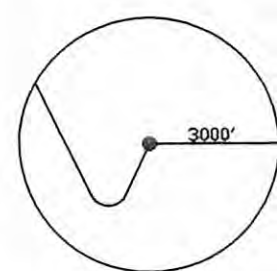
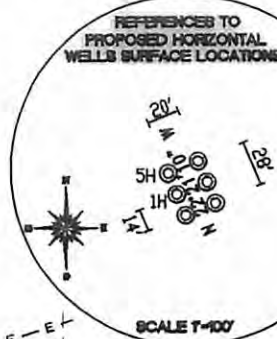

REFERENCE NOTES
 Boundaries as shown taken from deeds, tax maps and field locations. A full boundary survey is not expressed nor implied. All bearings are based on true north. Ownership taken from public records Brooke County, West Virginia JANUARY 2011
 State Plane Coordinates & NAD 83 Lat/Long by differential submeter mapping grade GPS
 Drafted by: E.A.M.

FILE #: CHE 037
 DRAWING #: 1811
 SCALE: 1" = 1200'
 MINIMUM DEGREE OF ACCURACY: 1/200
 PROVEN SOURCE OF ELEVATION: SUBMETER MAPPING GRADE GPS

I, THE UNDERSIGNED, HEREBY CERTIFY THAT THIS PLAT IS CORRECT TO THE BEST OF MY KNOWLEDGE AND BELIEF AND SHOWS ALL THE INFORMATION REQUIRED BY LAW AND THE REGULATIONS ISSUED AND PRESCRIBED BY THE DEPARTMENT OF ENVIRONMENTAL PROTECTION.
 Signed:
 L.L.S. #2124 : Ernest J. Benchek III

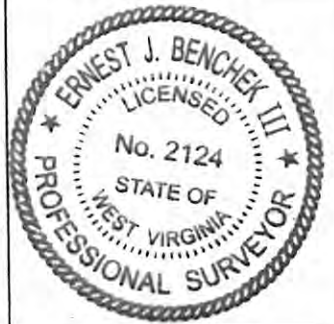

(+) DENOTES LOCATION OF WELL ON UNITED STATES TOPOGRAPHIC MAPS
WVDEP

OFFICE OF OIL & GAS
 601 57TH STREET
 CHARLESTON, WV 25304

Well Type: Oil Waste Diposal Production Deep
 Gas Liquid Injection Storage Shallow

WATERSHED: UPPER OHIO SOUTH

COUNTY/DISTRICT: BROOKE / BUFFALO

SURFACE OWNER: MARGARET H. CORBIN

OIL & GAS ROYALTY OWNER: MARGARET H. CORBIN

LEASE NUMBERS:

DRILL CONVERT DRILL DEEPER REDRILL FRACTURE OR STIMULATE
 PLUG OFF FORMATION PERFORATE NEW FORMATION PLUG & ABANDON
 CLEAN OUT & REPLUG OTHER CHANGE (SPECIFY):

TARGET FORMATION: MARCELLUS

WELL OPERATOR: CHESAPEAKE APPALACHIA, LLC.

ADDRESS: PO BOX 18496

CITY: OKLAHOMA CITY STATE: OK ZIP CODE: 73154-0496

DATE: OCTOBER 14, 2011

OPERATOR'S WELL #: MARGARET CORBIN BRK 1H

API WELL #: 47 09 00/26H
 STATE COUNTY PERMIT

CANCELLED

ELEVATION: 1,150'

QUADRANGLE: BETHANY, WV.

ACREAGE: 183.13 +/-

ACREAGE: 403.33 +/-

ESTIMATED DEPTH: TVD: 6,065 TMD: 11,243

DESIGNATED AGENT: ERIC GILLESPIE

ADDRESS: PO BOX 6070

CITY: CHARLESTON STATE: WV ZIP CODE: 25362

06/27/2014