

# THRASHER

THE THRASHER GROUP, INC.  
600 WHITE OAKS BLVD.  
BRIDGEPORT, WV 26330  
PHONE 304-624-4108

### NOTES ON SURVEY

- COORDINATES SYSTEM IS UTM, NAD 83 DATUM, ZONE 17, U.S. FOOT AND WELL COORDINATES ESTABLISHED USING SURVEY GRADE GPS.
- SURFACE AND ROYALTY OWNER INFORMATION AND THEIR BOUNDARIES SHOWN HEREON WERE PLOTTED FROM DEEDS AND/OR TAX PARCEL MAPS PROVIDED BY CLIENT AND FIELD LOCATIONS.
- THIS PLAT DOES NOT REPRESENT A BOUNDARY SURVEY OF THE PARCELS SHOWN HEREON.
- NO DWELLINGS AND BUILDINGS WITHIN 625 FEET OF PROPOSED OF CENTER OF PAD.
- NO WATER WELLS OR DEVELOPED SPRINGS WITHIN 250 FEET OF PROPOSED WELL.
- NO PERENNIAL STREAMS, LAKES, PONDS, RESERVOIRS OR WETLANDS WITHIN 100 FEET OF THE LIMITS OF DISTURBANCE.
- NO NATURALLY PRODUCING TROUT STREAM WITHIN 300 FEET OF LIMITS OF DISTURBANCE.

TRACT	SURFACE OWNER (S) / ROYALTY OWNER (R)	TAX PARCEL	ACRES
1	(S) BROOKE COUNTY PARK COMMISSION (R) RICHARD P. GIST (R) VIRGINIA GIST ABLITT (R) ANN GIST LEVIN	05-03-028-0084-0000	135.00
2	(S) STARBUCK INDUSTRIES	05-03-038-0083-0000	15.25
3	(S) BROOKE COUNTY PARK AND RECREATION COMMISSION (R) JAMES ROBERT HERVEY & KAREN L. HERVEY (R) WILLIAM JUDSON HERVEY II & TERESA J. HERVEY (R) FRED L. HERVEY & CARY J. HERVEY (R) MARY KATHERYN HERVEY DECARNO & ALAN H. DECARNO (R) RUSSELL D. HERVEY & LISA K. HERVEY	05-03-028-0080-0000	101.61
4	(S) PHOENIX-GREENLAWN PARTNERS LIMITED PARTNERSHIP (R) USA INC (R) JAMES ROBERT HERVEY & KAREN L. HERVEY (R) WILLIAM JUDSON HERVEY II & TERESA J. HERVEY (R) FRED L. HERVEY & CARY J. HERVEY (R) MARY KATHERYN HERVEY DECARNO & ALAN H. DECARNO (R) RUSSELL D. HERVEY & LISA K. HERVEY	05-03-033-0113-0000	101.35
5	(S) JOHN C. WILES SR & BARBARA A. WILES	05-03-034-0017-0000	170.40

LINE	BEARING	DISTANCE	DESCRIPTION	MONUMENT
L1	N 09°12'43" W	27.99'	SHL TO REF. PNT.	BRK 6H #09-00111
L2	S 14°07'52" W	297.10'	SHL TO REF. PNT.	REBAR SET
L3	N 04°11'50" E	2005.89'	SHL TO REF. PNT.	REBAR SET
L4	N 31°52'10" E	3941.40'	SHL TO REF. PNT.	REBAR FOUND
LINE	BEARING	DISTANCE	CURVE LENGTH	DESCRIPTION
L5	S 35°22'03" W	878.72'		SHL TO LP
L6	S 21°26'12" E	7902.58'		LP TO BHL



SURFACE HOLE LOCATION (SHL):	SURFACE HOLE LOCATION (SHL):
UTM (NAD83, ZONE 17, METERS): NORTHING: 4,456,765.570 EASTING: 538,447.276	UTM (NAD83, ZONE 17, METERS): NORTHING: 4,456,765.533 EASTING: 538,447.303
LANDING POINT LOCATION (LPL):	LANDING POINT LOCATION (LPL):
UTM (NAD83, ZONE 17, METERS): NORTHING: 4,456,457.162 EASTING: 538,292.248	UTM (NAD83, ZONE 17, METERS): NORTHING: 4,456,558.209 EASTING: 538,287.413
BOTTOM HOLE LOCATION (BHL):	BOTTOM HOLE LOCATION (BHL):
UTM (NAD83, ZONE 17, METERS): NORTHING: 4,454,305.079 EASTING: 539,172.561	UTM (NAD83, ZONE 17, METERS): NORTHING: 4,454,290.933 EASTING: 539,177.956

2000 0 2000

GRAPHIC SCALE IN FEET

I, THE UNDERSIGNED, HEREBY CERTIFY THAT THIS PLAT IS CORRECT TO THE BEST OF MY KNOWLEDGE AND BELIEF AND SHOWS ALL THE INFORMATION REQUIRED BY LAW AND REGULATIONS ISSUED AND PRESCRIBED BY THE DEPARTMENT OF ENVIRONMENTAL PROTECTION.

P.S. 2270

*Michael S. Wolf* 5/12/17



(+) DENOTES LOCATION OF WELL ON UNITED STATES TOPOGRAPHIC MAPS  
BHL  
WVDEP  
OFFICE OF OIL & GAS  
601 57TH STREET  
CHARLESTON, WV 25034

MINIMUM DEGREE OF ACCURACY: 1/200  
PROVEN SURVEY SOURCE OF GRADE GPS ELEVATION: (NAVD 88, US FT)



COMPANY:

**SWN**

**SWN** *RE-VI*

Production Company, LLC Production Company™

BROOKE COUNTY PARKS

OPERATOR'S WELL #: BRK 6H

API WELL #: 47 009 00167  
STATE COUNTY PERMIT

WELL TYPE: OIL  WASTE DISPOSAL  PRODUCTION  DEEP  GAS  LIQUID INJECTION  STORAGE  SHALLOW   
WATERSHED: BUFFALO CREEK ELEVATION: 1205.60'  
DISTRICT: BUFFALO COUNTY: BROOKE QUADRANGLE: STEUBENVILLE EAST & BETHANY  
SURFACE OWNER: BROOKE COUNTY PARKS COMMISSION ACREAGE: ±135.00  
OIL & GAS ROYALTY OWNER: RICHARD P. GIST, VIRGINIA GIST ABLITT, ANN GIST LEVIN ACREAGE: ±523.81  
DRILL  DRILL DEEPER  REDRILL  FRACTURE OR STIMULATE  PLUG OFF OLD FORMATION  PERFORATE NEW FORMATION   
CONVERT  PLUG & ABANDON  CLEAN OUT & REPLUG  OTHER CHANGE  (SPECIFY) AS-DRILLED  
TARGET FORMATION: MARCELLUS ESTIMATED DEPTH: 5,947' TVD 14,335' TMD

WELL OPERATOR: SWN PRODUCTION COMPANY, LLC DESIGNATED AGENT: DEE SOUTHALL  
ADDRESS: P.O. BOX 1300 ADDRESS: P.O. BOX 1300  
CITY: JANE LEW STATE: WV ZIP CODE: 26378 CITY: JANE LEW STATE: WV ZIP CODE: 26378

LEGEND:	REVISIONS:	DATE:
○ PROPOSED SURFACE HOLE / BOTTOM HOLE	----- LEASE BOUNDARY	05-11-2017
★ EXISTING / PRODUCING WELLHEAD	----- PROPOSED PATH	SHEET 1 OF 3
✘ ABANDONED WELL	----- AS-DRILLED PATH	DRAWN BY: K. POTH
✘ PLUGGED & ABANDONED WELL	----- ABANDONED PATH	SCALE: 1" = 2000'
△ CUT CONDUCTOR		DRAWING NO: 050-5525
		WELL LOCATION PLAT



10,990' BHL  
Latitude: 40°17'30"  
SWN PRODUCTION COMPANY, LLC  
"BROOKE COUNTY PARKS BRK 6H"  
SURFACE HOLE  
ELEV: 1205.6'

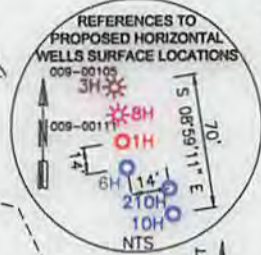

Longitude: 80°30'00"  
19,432' BHL  
11,366' SHL

GRID NORTH  
UTM, NAD83 DATUM, ZONE 17, US FT



# THRASHER

THE THRASHER GROUP, INC.  
600 WHITE OAKS BLVD.  
BRIDGEPORT, WV 26330  
PHONE 304-624-4108

TRACT	ADJOINER	TAX PARCEL
A	MARK OWEN WEAVER & VIRGINIA BEALL KREUTZ	05-03-B34-0049-0000
B	DENZIL & MARY LOU CONLEY	05-03-B33-0108-0000
C	MARLENE K. HUKILL	05-03-B33-0109-0000
D	JOHN C WALES SR & BARBARA A WALES	05-03-B33-0110-0000
E	JAMES H. STEWART & PAMELA JO STEWART	05-03-B33-0031-0000
F	STARVAGGI INDUSTRIES INC.	05-03-B33-0026-0000
G	STARVAGGI INDUSTRIES INC.	05-03-B33-0025-0000
H	STARVAGGI INDUSTRIES INC.	05-03-B28-0062-0000
I	RUSSELL D. HERVEY	05-03-B28-0045-0000
J	BERNARD J. KNORR III & NICHOLE C. KNORR	05-03-B28-0059-0000
K	RUBY FAYE KNORR & BERNARD JOHN KNORR JR	05-03-B28-0058-0000
L	BERNARD J. KNORR JR & RUBY F KNORR	05-03-B28-0057-0001
M	COUNTY COURT OF BROOKE COUNTY	05-03-B28-0066-0000
N	COUNTY COURT OF BROOKE COUNTY	05-03-B28-0065-0000
O	COUNTY COURT OF BROOKE COUNTY	05-03-B28-0061-0000
P	KEITH SMITH & KATHY SMITH	05-03-B34-0001-0000
Q	BROOKE COUNTY PARK & RECREATION COMMISSION	05-03-B33-0117-0000
R	KEITH SMITH & KATHY SMITH	05-03-B34-0016-0001
S	KEITH R. SMITH & KATHY J. SMITH	05-03-B33-0114-0000
T	BRIAN SMITH	05-03-B33-0114-0001
U	DAVID L. RAGAN	05-03-B34-0016-0003
V	DAVID RAGAN	05-03-B34-0016-0000
W	DAVID RAGAN	05-03-B34-0015-0000
X	NANCY J AMBROSE	05-03-B34-0014-0000
Y	CARMAN FANASE	05-03-B34-0018-0000
Z	JAMES L. & LAURA INMAN	05-03-B34-0019-0000
AA	BRIAN E. & JENNIFER B. PLANTS	05-03-B34-0048-0000

01/05/2018

COMPANY:  
**SWN** **SWN** <sup>R<sub>1</sub>-V<sup>+</sup></sup>  
Production Company, LLC Production Company™

REVISIONS:	DATE: 05-11-2017
	SHEET 2 OF 3
	DRAWN BY: K. POTH
	SCALE: 1" = 2000'
	DRAWING NO: 050-5525
	WELL LOCATION PLAT