

RETTEW

RETTEW Associates, Inc.
27 Travato Street, Suite 101
Bridgeport, WV 26330
Phone (800) 738-8395
Email: rettew@rettew.com
Website: www.rettew.com

GRID NORTH
UTM, NAD83 DATUM, ZONE 17, US FT

LINE	BEARING	DISTANCE	DESCRIPTION	MONUMENT
L1	N 29°14'41" E	270.40'	SHL TO REF. PNT.	1/2" REBAR SET
L2	S 47°03'29" W	283.48'	SHL TO REF. PNT.	1/2" REBAR SET
L3	S 42°17'41" E	766.90'	SHL TO GIS CORNER	
L4	S 74°39'03" W	1490.18'	SHL TO GIS CORNER	
L5	S 77°58'36" E	480.05'	SHL TO LP	
L6	S 23°00'00" E	7221.72'	LP TO BHL	

BHL

SURFACE HOLE LOCATION (SHL): UTM (NAD83, ZONE 17, METERS): NORTHING: 4,452,333.879 EASTING: 539,870.262
KICKOFF POINT LOCATION (KOP): UTM (NAD83, ZONE 17, METERS): NORTHING: 4,452,457.960 EASTING: 539,931.597
LANDING POINT LOCATION (LPL): UTM (NAD83, ZONE 17, METERS): NORTHING: 4,452,303.399 EASTING: 540,013.372
BOTTOM HOLE LOCATION (BHL): UTM (NAD83, ZONE 17, METERS): NORTHING: 4,450,277.197 EASTING: 540,873.443

TRACT	SURFACE OWNER	TAX PARCEL	ACRES
1	JAMES K. SEABRIGHT AND MARTHA MAY SEABRIGHT, HUSBAND AND WIFE, LIFE INTEREST, JAMES H. SEABRIGHT, REMAINDER	03-B39-0008-0000	173.00±
2	JAMES B. CALDWELL	03-B39-0009-0000	182.63±
3	LINDA REEVES GREATHOUSE AND JAMES RUSSELL GREATHOUSE, HER HUSBAND	03-B39-0012-0000	202.41±
4	LINDA REEVES GREATHOUSE AND JAMES RUSSELL GREATHOUSE, HER HUSBAND	03-B44-0003-0000	73.57±
5	MILDRED MAIN	03-B44-0004-0000	19.58±
6	FORNEY AND SONS HOLDING CO., LLC	03-B44-0005-0000	180.00±

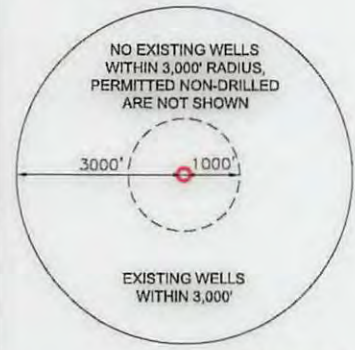
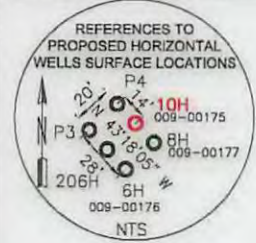
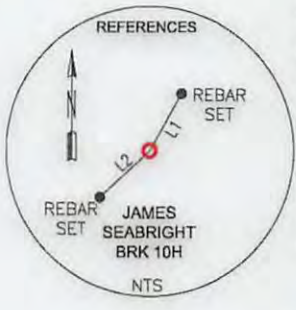

NOTES ON SURVEY

- COORDINATES SYSTEM IS UTM, NAD 83 DATUM, ZONE 17, U.S. FOOT AND WELL COORDINATES ESTABLISHED USING SURVEY GRADE GPS.
- SURFACE AND ROYALTY OWNER INFORMATION AND THEIR BOUNDARIES SHOWN HEREON WERE PLOTTED FROM DEEDS AND/OR TAX PARCEL MAPS PROVIDED BY CLIENT AND FIELD LOCATIONS.
- THIS PLAT DOES NOT REPRESENT A BOUNDARY SURVEY OF THE PARCELS SHOWN HEREON.
- NO DWELLINGS AND BUILDINGS WITHIN 625 FEET OF PROPOSED OF CENTER OF PAD.
- NO WATER WELLS OR DEVELOPED SPRINGS WITHIN 250 FEET OF PROPOSED WELL.
- NO PERENNIAL STREAMS, LAKES, PONDS, RESERVOIRS OR WETLANDS WITHIN 100 FEET OF THE LIMITS OF DISTURBANCE.
- NO NATURALLY PRODUCING TROUT STREAM WITHIN 300 FEET OF LIMITS OF DISTURBANCE.

I, THE UNDERSIGNED, HEREBY CERTIFY THAT THIS PLAT IS CORRECT TO THE BEST OF MY KNOWLEDGE AND BELIEF AND SHOWS ALL THE INFORMATION REQUIRED BY LAW AND REGULATIONS ISSUED AND PRESCRIBED BY THE DEPARTMENT OF ENVIRONMENTAL PROTECTION.

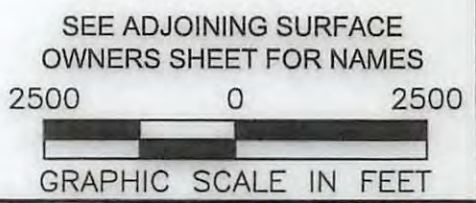

P.S. 2313

COMPANY: **SWN** Production Company, LLC

(+) DENOTES LOCATION OF WELL ON UNITED STATES TOPOGRAPHIC MAPS
WVDEP
OFFICE OF OIL & GAS
601 57TH STREET
CHARLESTON, WV 25034

MINIMUM DEGREE OF ACCURACY: 1/200
PROVEN SOURCE OF SURVEY GRADE GPS ELEVATION: (NAVD 88, US FT)

JAMES SEABRIGHT BRK
OPERATOR'S WELL #: 10H
API WELL #: 47 9 00175 MOD
STATE COUNTY PERMIT

WELL TYPE: OIL WASTE DISPOSAL PRODUCTION DEEP GAS LIQUID INJECTION STORAGE SHALLOW

WATERSHED: SUGARCAMP RUN, BUFFALO CREEK ELEVATION: 1129.0' (DESIGN)±

DISTRICT: BUFFALO COUNTY: BROOKE QUADRANGLE: BETHANY, WV-PA

SURFACE OWNER: JAMES K. & MARTHA MAY SEABRIGHT; LIFE ESTATE & JAMES H. SEABRIGHT ACREAGE: 173.00±

OIL & GAS ROYALTY OWNER: MARTHA MAY SEABRIGHT, LE, & JAMES H. SEABRIGHT ACREAGE: 173.00±

DRILL DRILL DEEPER REDRILL FRACTURE OR STIMULATE PLUG OFF OLD FORMATION PERFORATE NEW FORMATION

CONVERT PLUG & ABANDON CLEAN OUT & REPLUG OTHER CHANGE (SPECIFY) **01/06/2017**

TARGET FORMATION: MARCELLUS ESTIMATED DEPTH: 6,064' TVD 13,638' TMD

WELL OPERATOR: SWN PRODUCTION COMPANY, LLC DESIGNATED AGENT: DEE SOUTHALL
ADDRESS: P.O. BOX 1300 ADDRESS: P.O. BOX 1300
CITY: JANE LEW STATE: WV ZIP CODE: 26378 CITY: JANE LEW STATE: WV ZIP CODE: 26378

LEGEND:	REVISIONS:	DATE: 10-17-2016
○ PROPOSED SURFACE HOLE / BOTTOM HOLE		
⊙ EXISTING / PRODUCING WELLHEAD	— TIE LINE	
⊗ ABANDONED WELL	--- LEASE BOUNDARY	
⊕ PLUGGED & ABANDONED WELL	— MARCELLUS DHP	
△ CUT CONDUCTOR	--- ABANDONED PATH	
		DRAWN BY: B. HERMAN
		SCALE: 1" = 2500'
		DRAWING NO: 087569036
		WELL LOCATION PLAT

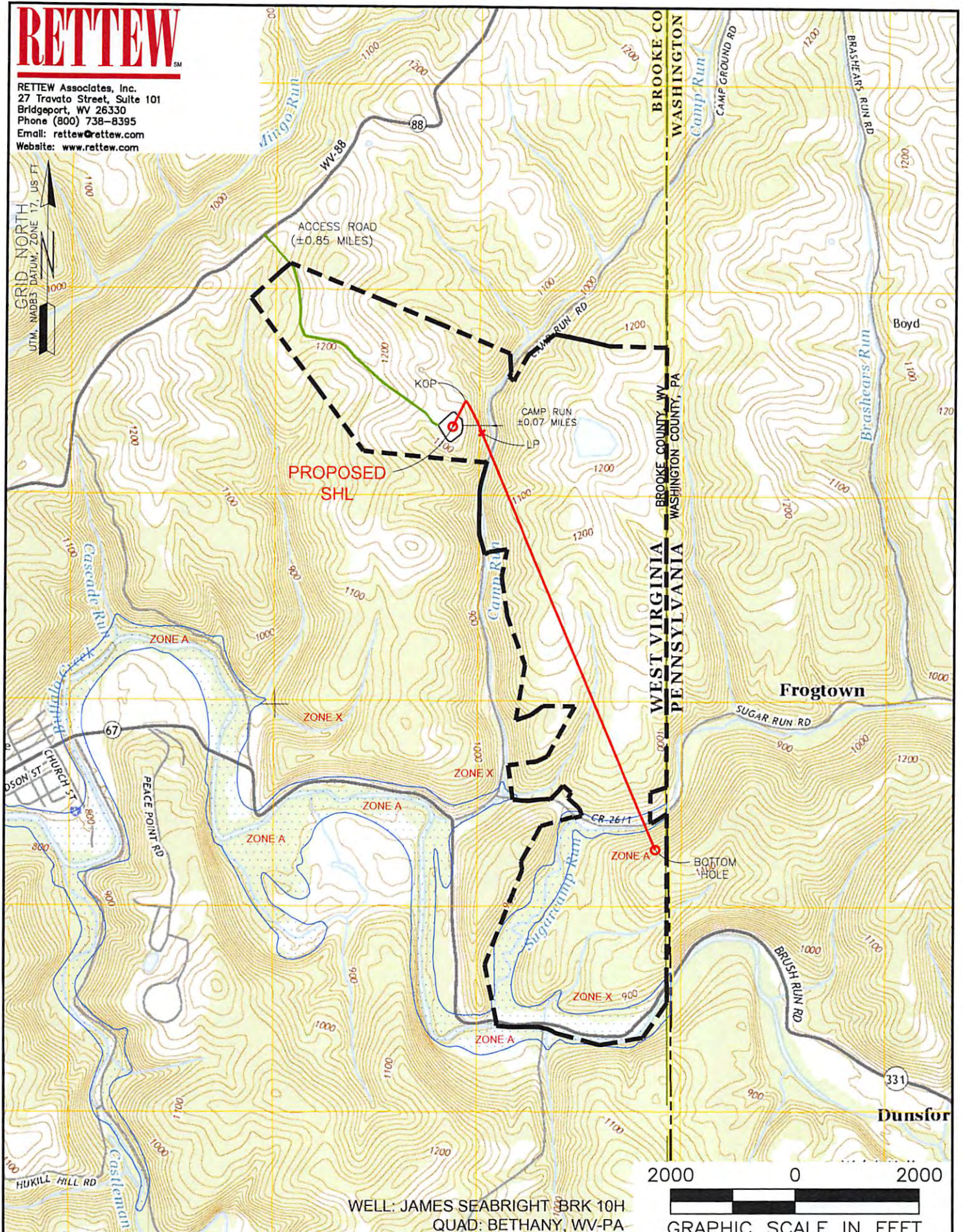

WELL: JAMES SEABRIGHT BRK 10H
QUAD: BETHANY, WV-PA

GRAPHIC SCALE IN FEET

NAME AND DISTANCE TO THE NEAREST STREAM:
CAMP RUN IS LOCATED ±0.07 MILES EAST OF THE CENTER OF THE DRILL PAD.

STREAM CROSSING COORDINATES (NAD 83):
NO NEW CROSSINGS.

COMPANY:

SWN
Production Company, LLC

SWN ^{R-V}_A
Production Company™

WELL RESTRICTIONS:

WELL PAD, LOD, & E & S CONTROL FEATURES TO PERENNIAL STREAM, LAKE, POND, RESERVOIR OR WETLAND: >100 FEET
WELL PAD, LOD, & E & S CONTROL FEATURES TO NATURALLY PRODUCING TROUT STREAM: >300 FEET
WELL PAD, LOD, & E & S CONTROL FEATURES TO GROUNDWATER INTAKE OR PUBLIC WATER SUPPLY: >1000 FEET
WELL SHL TO EXISTING WATER WELL OR DEVELOPED SPRING: >250 FEET
CENTER OF PAD TO OCCUPIED DWELLING STRUCTURE: >625 FEET
CENTER OF PAD TO AGRICULTURAL BUILDINGS LAGER THAN 2500 SQ FT: >625 FEET

OPERATOR'S JAMES SEABRIGHT BRK
WELL #: 10H 9-00175400

LOCATION: BUFFALO DISTRICT,
BROOKE COUNTY, WEST VIRGINIA

FEMA FLOOD INFORMATION:
BY GRAPHIC PLOTTING ONLY FEMA FIRM INCORPORATED AREA OF BROOKE COUNTY, WEST VIRGINIA; MAP NUMBER 54009C0135D; EFFECTIVE DATE: APRIL 19, 2010.

SURFACE HOLE LOCATION:

GEOGRAPHIC (NAD83):
LATITUDE: 40.220478'
LONGITUDE: -80.531405'

Office of Oil & Gas

FLOOD ZONES A & X ARE SITUATED WITHIN THE UNIT.

BOTTOM HOLE LOCATION:

GEOGRAPHIC (NAD83):
LATITUDE: 40.201901'
LONGITUDE: -80.519746'

LEGEND:

- PROPOSED SURFACE HOLE / BOTTOM HOLE
- ⊙ EXISTING / PRODUCING WELLHEAD
- ⊗ ABANDONED WELL
- ⊗ PLUGGED & ABANDONED WELL
- △ CUT CONDUCTOR
- LEASE BOUNDARY
- MARCELLUS DHP
- ACCESS ROAD
- ACCESS ROAD TO PREV. SITE
- HIGHWAY/INTERSTATE
- COUNTY ROAD

REVISIONS:

DATE: 10-17-2016

DRAWN BY: B. HERMAN
SCALE: 1" = 2000'
DRAWING NO: 087569036
TOPOGRAPHIC MAP