

# RETTEW

RETTEW Associates, Inc.  
27 Travato Street, Suite 101  
Bridgeport, WV 26330  
Phone (800) 738-8395  
Email: rettew@rettew.com  
Website: www.rettew.com

<b>SURFACE HOLE LOCATION (SHL):</b>
UTM (NAD83, ZONE 17, METERS): NORTHING: 4,452,333.866 EASTING: 539,870.249
<b>LANDING POINT LOCATION (LP):</b>
UTM (NAD83, ZONE 17, METERS): NORTHING: 4,452,303.060 EASTING: 540,012.494
<b>BOTTOM HOLE LOCATION (BHL):</b>
UTM (NAD83, ZONE 17, METERS): NORTHING: 4,450,282.695 EASTING: 540,869.671
<b>SURFACE HOLE LOCATION (SHL):</b>
UTM (NAD83, ZONE 17, METERS): NORTHING: 4,452,333.879 EASTING: 539,870.262
<b>LANDING POINT LOCATION (LPL):</b>
UTM (NAD83, ZONE 17, METERS): NORTHING: 4,452,303.399 EASTING: 540,013.372
<b>BOTTOM HOLE LOCATION (BHL):</b>
UTM (NAD83, ZONE 17, METERS): NORTHING: 4,450,277.197 EASTING: 540,873.443

GRID NORTH  
UTM, NAD83 DATUM, ZONE 17, US FT

Latitude: 40°15'00" L 8767'  
BHL Latitude: 40°12'30" 5526'

LINE	BEARING	DISTANCE	DESCRIPTION	MONUMENT
L1	N 29°14'55" E	270.45'	SHL TO REF. PNT.	1/2" REBAR SET
L2	S 47°03'29" W	283.42'	SHL TO REF. PNT.	1/2" REBAR SET
L3	S 42°17'57" E	766.90'	SHL TO GIS CORNER	
L4	S 74°39'07" W	1490.12'	SHL TO GIS CORNER	
L5	S 77°58'56" E	480.09'	SHL TO LP	
L6	S 22°59'24" E	7200.39'	LP TO BHL	

TRACT	SURFACE OWNER	TAX PARCEL	ACRES
1	JAMES K. SEABRIGHT AND MARTHA MAY SEABRIGHT, HUSBAND AND WIFE, LIFE INTEREST, JAMES H. SEABRIGHT, REMAINDER	03-B39-0008-0000	173.00±
2	JAMES B. CALDWELL	03-B39-0009-0000	182.63±
3	LINDA REEVES GREATHOUSE AND JAMES RUSSELL GREATHOUSE, HER HUSBAND	03-B39-0012-0000	202.41±
4	LINDA REEVES GREATHOUSE AND JAMES RUSSELL GREATHOUSE, HER HUSBAND	03-B44-0003-0000	73.57±
5	MILDRED MAIN	03-B44-0004-0000	19.58±
6	FORNEY AND SONS HOLDING CO., LLC	03-B44-0005-0000	180.00±

## AS-DRILLED

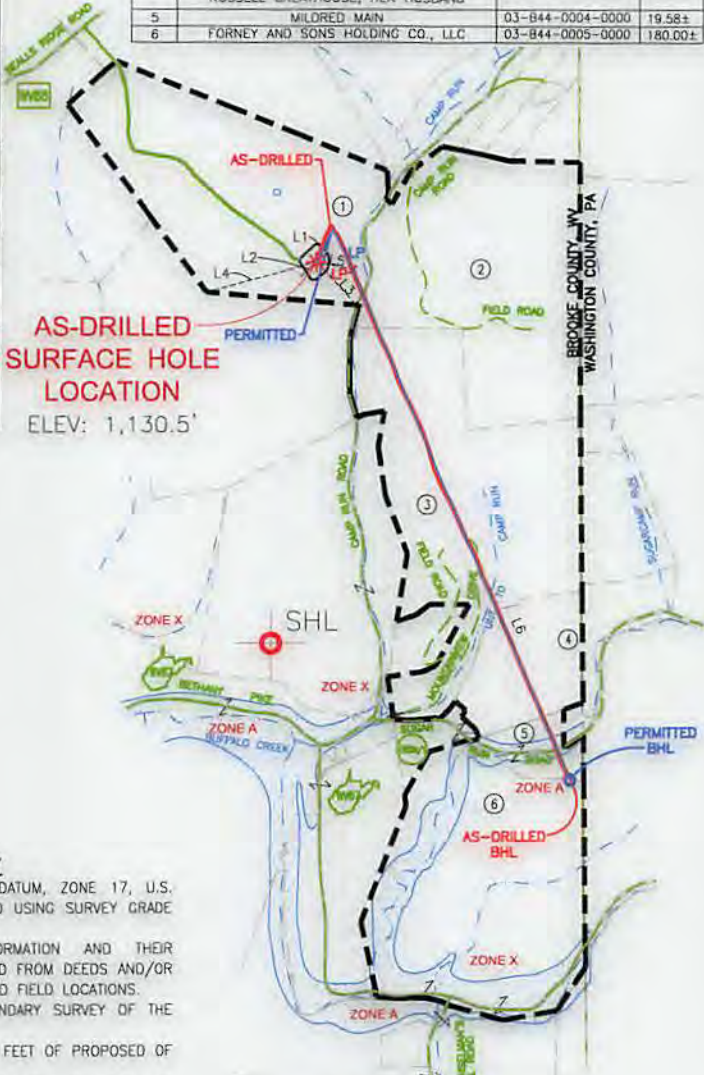
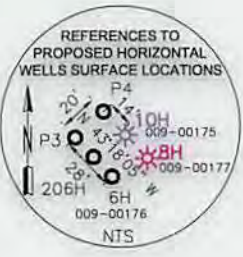
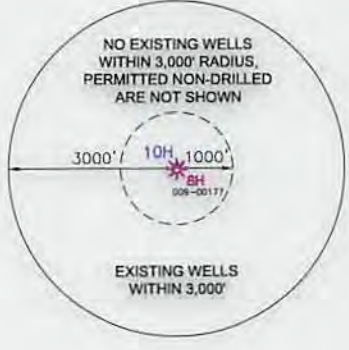
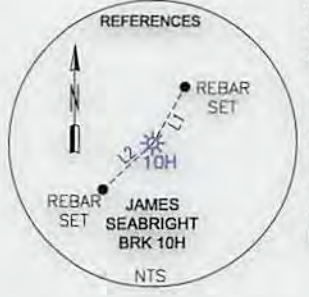

AS-DRILLED SURFACE HOLE LOCATION  
ELEV: 1,130.5'

### NOTES ON SURVEY

- COORDINATES SYSTEM IS UTM, NAD 83 DATUM, ZONE 17, U.S. FOOT AND WELL COORDINATES ESTABLISHED USING SURVEY GRADE GPS.
- SURFACE AND ROYALTY OWNER INFORMATION AND THEIR BOUNDARIES SHOWN HEREON WERE PLOTTED FROM DEEDS AND/OR TAX PARCEL MAPS PROVIDED BY CLIENT AND FIELD LOCATIONS.
- THIS PLAT DOES NOT REPRESENT A BOUNDARY SURVEY OF THE PARCELS SHOWN HEREON.
- NO DWELLINGS AND BUILDINGS WITHIN 625 FEET OF PROPOSED OF CENTER OF PAD.
- NO WATER WELLS OR DEVELOPED SPRINGS WITHIN 250 FEET OF PROPOSED WELL.
- NO PERENNIAL STREAMS, LAKES, PONDS, RESERVOIRS OR WETLANDS WITHIN 100 FEET OF THE LIMITS OF DISTURBANCE.
- NO NATURALLY PRODUCING TROUT STREAM WITHIN 300 FEET OF LIMITS OF DISTURBANCE.

I, THE UNDERSIGNED, HEREBY CERTIFY THAT THIS PLAT IS CORRECT TO THE BEST OF MY KNOWLEDGE AND BELIEF AND SHOWS ALL THE INFORMATION REQUIRED BY LAW AND REGULATIONS ISSUED AND PRESCRIBED BY THE DEPARTMENT OF ENVIRONMENTAL PROTECTION.

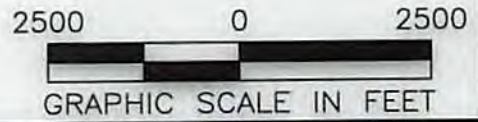

P.S. 2241

<p>(+) DENOTES LOCATION OF WELL ON UNITED STATES TOPOGRAPHIC MAPS</p> <p>WVDEP OFFICE OF OIL &amp; GAS 601 57TH STREET CHARLESTON, WV 25034</p>	<p>MINIMUM DEGREE OF ACCURACY: 1/200</p> <p>PROVEN SOURCE OF ELEVATION: SURVEY GRADE GPS (NAVD 88, US FT)</p>	<p>COMPANY: <b>SWN</b> Production Company, LLC</p> <p>JAMES SEABRIGHT BRK</p> <p>OPERATOR'S WELL #: 10H</p> <p>API WELL #: <b>47 009 00175</b></p> <p>STATE COUNTY PERMIT</p>
	<p>WELL TYPE: OIL <input type="checkbox"/> WASTE DISPOSAL <input type="checkbox"/> PRODUCTION <input checked="" type="checkbox"/> DEEP <input type="checkbox"/> GAS <input checked="" type="checkbox"/> LIQUID INJECTION <input type="checkbox"/> STORAGE <input type="checkbox"/> SHALLOW <input checked="" type="checkbox"/></p> <p>WATERSHED: SUGARCAMP RUN, BUFFALO CREEK</p> <p>DISTRICT: BUFFALO COUNTY: BROOKE</p> <p>SURFACE OWNER: JAMES K. &amp; MARTHA MAY SEABRIGHT; LIFE ESTATE &amp; JAMES H. SEABRIGHT</p> <p>OIL &amp; GAS ROYALTY OWNER: MARTHA MAY SEABRIGHT, LE, &amp; JAMES H. SEABRIGHT</p> <p>DRILL <input type="checkbox"/> DRILL DEEPER <input type="checkbox"/> REDRILL <input type="checkbox"/> FRACTURE OR STIMULATE <input type="checkbox"/> PLUG OFF OLD FORMATION <input type="checkbox"/> PERFORATE NEW FORMATION <input type="checkbox"/></p> <p>CONVERT <input type="checkbox"/> PLUG &amp; ABANDON <input type="checkbox"/> CLEAN OUT &amp; REPLUG <input type="checkbox"/> OTHER CHANGE <input checked="" type="checkbox"/> (SPECIFY) <b>As-Drilled</b></p> <p>TARGET FORMATION: MARCELLUS ESTIMATED DEPTH: 6,198' TVD 13,672' TMD</p>	<p>ELEVATION: 1130.5'</p> <p>QUADRANGLE: BETHANY, WV-PA</p> <p>ACREAGE: 173.00±</p> <p>ACREAGE: 173.00±</p> <p>DESIGNATED AGENT: DEE SOUTHALL</p> <p>ADDRESS: P.O. BOX 1300</p> <p>CITY: JANE LEW STATE: WV ZIP CODE: 26378</p>
<p>LEGEND:</p> <ul style="list-style-type: none"> <li>PROPOSED SURFACE HOLE / BOTTOM HOLE</li> <li>EXISTING / PRODUCING WELLHEAD</li> <li>ABANDONED WELL</li> <li>PLUGGED &amp; ABANDONED WELL</li> <li>CUT CONDUCTOR</li> <li>TIE LINE</li> <li>LEASE BOUNDARY</li> <li>ASDRILLED WELLPATH</li> <li>PERMITTED WELLPATH</li> <li>STREAM</li> </ul>	<p>REVISIONS:</p> <p>DATE: 08-22-2017</p> <p>DRAWN BY: G.FLORES</p> <p>SCALE: 1" = 2500'</p> <p>DRAWING NO: 087569036</p> <p>AS-DRILLED PLAT</p>	